

WELL SCHEDULE

U. S. DEPT. OF THE INTERIOR

GEOLOGICAL SURVEY

WATER RESOURCES DIVISION

MASTER CARD

Record by E. J. Harvey Source of data ? Date ? Map _____

State 28 County Georgia (or town) 20

Latitude: 30 deg 49 min 13 sec N Longitude: 088 degrees 40 min 06 sec W Sequential number: 1

Lat-long accuracy: 2 T. 3 S. 7 E. Sec 3, SE & NE & NE

Local well number: K001A0303507W Other number: _____ B & M

Local use: 102 Owner or name: _____

Owner or name: RALPH FATPLEY Address: _____

Ownership: County, Fed Gov't, City, Corp or Co, Private, State Agency, Water Dist 7

Use of water: (A) Air cond, (B) Bottling, (C) Comm, (D) Dewater, (E) Power, (F) Fire, (G) Dom, (H) Irr, (I) Med, (J) Ind, (K) P S, (L) Rec, (M) Stock, (N) Instit, (O) Unused, (P) Repressure, (Q) Recharge, (R) Desal-P-S, (S) Desal-other, (T) Other H

Use of well: (A) Anode, (B) Drain, (C) Seismic, (D) Heat Res, (E) Obs, (F) Oil-gas, (G) Recharge, (H) Test, (I) Unused, (J) Withdraw, (K) Waste, (L) Destroyed W

DATA AVAILABLE: Well data Freq. W/L meas.: Field aquifer char.

Hyd. lab. data: _____

Qual. water data; type: _____

Freq. sampling: _____ Pumpage inventory: yes, no, period: _____

Aperture cards: _____

Log data: _____

WELL-DESCRIPTION CARD

SAME AS ON MASTER CARD Depth well: _____ ft 40 Meas. accuracy 6

Depth cased; (first perf.): _____ ft _____ Casing type: G.I.; Diam. 2 1/4 in 2

Finish: (C) porous concrete, (F) gravel w. (perf.), (G) gravel w. (screen), (H) horiz. gallery, (I) open end, (J) perf., (K) screen, (L) sd. pt., (M) shored, (N) open hole, (O) other 7

Method Drilled: (A) air rot, (B) bored, (C) cable, (D) dug, (E) hyd rot., (F) jetted, (G) air percussion, (H) reverse, (I) rotary, (J) trenching, (K) driven, (L) drive wash, (M) other V

Date Drilled: 3/59 9:59 Pump intake setting: _____ ft _____

Driller: Jim Purice name _____ address _____

Lift (type): (A) air, (B) bucket, (C) cent, (D) jet, (E) multiple, (F) multiple, (G) none, (H) piston, (I) rot, (J) submerg, (K) turb, (L) other 7 Deep Shallow

Power (type): (A) diesel, (B) elec, (C) gas, (D) gasoline, (E) hand, (F) gas, (G) wind, (H) H.P., (I) LP, (J) Trans. or meter no. 5

Descrip. MP _____ ft above _____ below LSD, Alt. MP _____

Alt. LSD: _____ Accuracy: topo.

Water Level _____ ft above _____ below MP; _____ ft above _____ below LSD Accuracy: _____

Date meas: _____ Yield: _____ gpm Method determined _____

Drawdown: _____ ft Accuracy: _____ Pumping period _____ hrs

QUALITY OF WATER DATA: Iron _____ ppm Sulfate _____ ppm Chloride _____ ppm Hard. _____ ppm

Sp. Conduct _____ K x 10⁶ Temp. _____ °F Date sampled _____

Taste, color, etc. _____

Well No. K1

Well No. K1

Latitude-longitude _____
N
S
d m s d m s

HYDROGEOLOGIC CARD

SAME AS ON MASTER CARD Physiographic Province: 03 Section: _____

Drainage Basin: 130 Subbasin: _____

Topo of well site: (D) depression, stream channel, dunes, flat, hilltop, sink, swamp, (E) (F) (H) (K) (L) (O) (P) (S) (T) (U) (V) offshore, pediment, hillside, terrace, undulating, valley flat _____ 27

MAJOR AQUIFER: _____ system, _____ series TP _____ aquifer, formation, group 07

Lithology: US Origin: 2 Aquifer Thickness: _____ ft

Length of well open to: _____ ft Depth to top of: _____ ft

MINOR AQUIFER: _____ system, _____ series _____ aquifer, formation, group _____

Lithology: _____ Origin: _____ Aquifer Thickness: _____ ft

Length of well open to: _____ ft Depth to top of: _____ ft

Intervals Screened: _____

Depth to consolidated rock: _____ ft Source of data: _____

Depth to basement: _____ ft Source of data: _____

Surficial material: _____ Infiltration characteristics: _____

Coefficient Trans: _____ gpd/ft Coefficient Storage: _____

Coefficient Perm: _____ gpd/ft²; Spec cap: _____ gpm/ft; Number of geologic cards: _____

Well next door is 40 ft. deep. Changed sand point once 10 yrs. ago. Great water after hot water tank.

N
↑

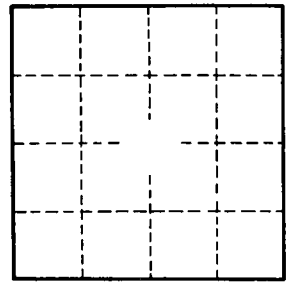
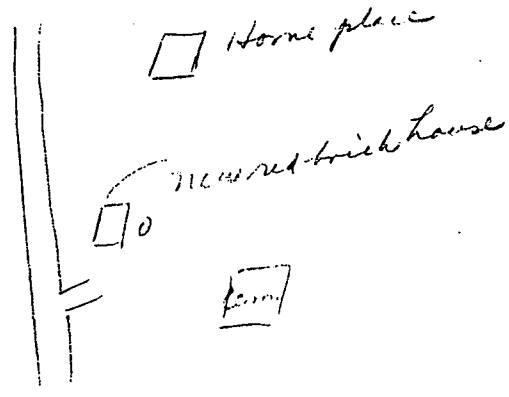

Well No. K1