

312810090503001
FORM 9-1642
(1-68)

306B
Well No. J38
APR 1 1975

WELL SCHEDULE

Elog #107

U. S. DEPT. OF THE INTERIOR GEOLOGICAL SURVEY WATER RESOURCES DIVISION

PUNCHED
MAR 18 1974

MASTER CARD

Record by WTO Source of data Bowc Date 10/72 Map _____
 State MISS 28 County (or town) FRANKLIN 19
 Latitude: 31 28 18 N Longitude: 09 04 59 W Sequential number: 1
 Lat-long accuracy: 20 60 40 20 NW NW SW
 Local well number: J038 B0C2006 N04E Other number: Well #2
 Local use: 184107 Owner or name: _____
 Owner or name: BUDE Address: _____
 Ownership: County, Fed Gov't, City, Corp or Co, Private, State Agency, Water Dist M
 Use of water: (A) Air cond, (B) Bottling, (C) Comm, (D) Dewater, (E) Power, (F) Fire, (G) Dom, (H) Irr, (I) Med, (J) P S, (K) Rec, (L) Stock, (M) Instit, (N) Unused, (O) Repressure, (P) Recharge, (Q) Desal-P S, (R) Desal-other, (S) Other P
 Use of well: (A) Anode, (B) Drain, (C) Seismic, (D) Heat Res, (E) Obs, (F) Oil-gas, (G) Recharge, (H) Test, (I) Unused, (J) Withdraw, (K) Waste, (L) Destroyed W
 DATA AVAILABLE: Well data Freq. W/L meas.: Field aquifer char.
 Hyd. lab. data: _____
 Qual. water data; type: _____
 Freq. sampling: _____ Pumpage inventory: yes no, period: _____
 Aperture cards: _____ yes no
 Log data: Elog 10' - 504' D.F

WELL-DESCRIPTION CARD

SAME AS ON MASTER CARD Depth well: 254 ft Meas. rept. accuracy 3
 Depth cased (first perf.): Split Screen ft 183 Casing type: _____; Diam. 16x8 in 16
 Finish: (C) porous concrete, (F) gravel w. (perf.), (G) gravel w. (perf.), (H) horiz. gallery, (I) open end, (J) screen, (K) sd. pt., (L) shored, (M) open hole, (N) other S
 Method Drilled: (A) air rot, (B) bored, (C) cable, (D) dug, (E) hyd rot., (F) jetted, (G) air percuss, (H) rotary, (I) reverse, (J) trenching, (K) driven, (L) wash, (M) other H
 Date Drilled: 9-21-72 972 Pump intake setting: _____ ft _____
 Driller: Griner Drlg Serv.
 Lift (type): (A) air, (B) bucket, (C) cent, (D) jet, (E) multiple, (F) multiple, (G) none, (H) piston, (I) rot, (J) submerg, (K) turb, (L) other T Deep Shallow
 Power (type): (A) diesel, (B) elec, (C) gas, (D) gasoline, (E) hand, (F) gas, (G) wind; H.P. 50 V Trans. or meter no. _____
 Descrip. MP _____ above ft below LSD, Alt. MP _____
 Alt. LSD: 270 Accuracy: (source) topo 4
 Water Level: _____ ft above MP; _____ ft below LSD 64 Accuracy: _____ D
 Date meas: 972 Yield: _____ gpm 500 Method determined
 Drawdown: _____ ft Accuracy: _____ Pumping period _____ hrs _____
 QUALITY OF WATER DATA: Iron _____ ppm Sulfate _____ ppm Chloride _____ ppm Hard. _____ ppm
 Sp. Conduct _____ K x 10 6 Temp. _____ °F Date sampled _____
 Taste, color, etc. _____

11/5/81
90
1325
6675
319
6175
470
205

Well No.

HYDROGEOLOGIC CARD

SAME AS ON MASTER CARD Province: 03 Section: _____

Drainage Basin: 14A Subbasin: _____

Topo of well site: (C) (R) (F) (H) (K) (L) (U) (V)
depression, stream channel, dunes, flat, hilltop, sink, swamp, offshore, pediment, hillside, terrace, undulating, valley flat

MAJOR AQUIFER: system _____ series TM aquifer, formation, group MZ

Lithology: US Origin: 3 **Aquifer Thickness:** 120 ft

Length of well open to: 120 ft **Depth to top of:** 130 ft

MINOR AQUIFER: system _____ series _____ aquifer, formation, group _____

Lithology: _____ Origin: _____ **Aquifer Thickness:** _____ ft

Length of well open to: _____ ft **Depth to top of:** _____ ft

Intervals Screened:

Depth to consolidated rock: _____ ft **Source of data:** _____

Depth to basement: _____ ft **Source of data:** _____

Surficial material: _____ **Infiltration characteristics:** _____

Coefficient Trans: _____ gpd/ft **Coefficient Storage:** _____

Coefficient Perm: _____ gpd/ft²; **Spec cap:** _____ **gpm/ft; Number of geologic cards:** _____

See J3 rated

Water level measured easily
Well has Flometer (inoperative)
150,000 gal Stand pipe

- Miocene Red sd+gr. 0-10
- Clay 10-20
- Sl+St Clay 20-42
- Clay 42-65
- blue Clay 65-145
- Clay Str ls sl 145-178
- Sl 178-246
- Shy clay 246-268
- Clay 268-359

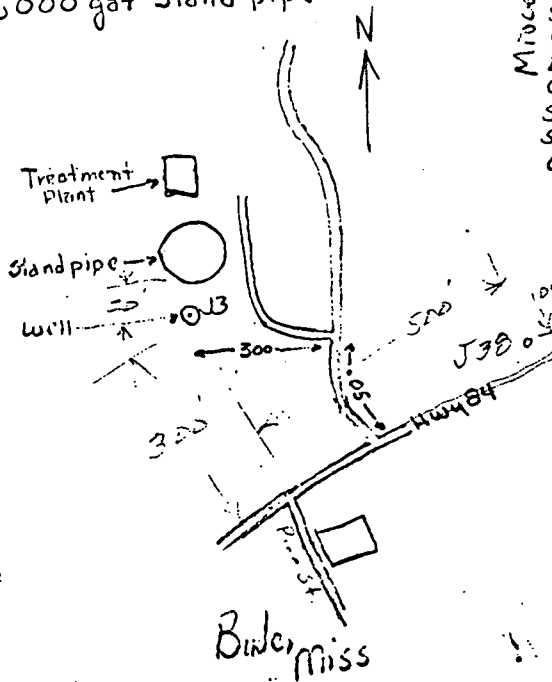
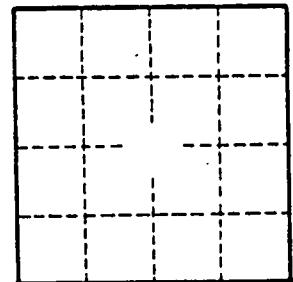

Time	dd.	4x3 Orifice	GPM
7:00 AM	16'	30"	230
8:00	16'		
9:00	16'		
10:00	16'	30"	230
11:00	18'	36"	254
12:00	18'		
1:00	18'		
2:00	18'	36"	254

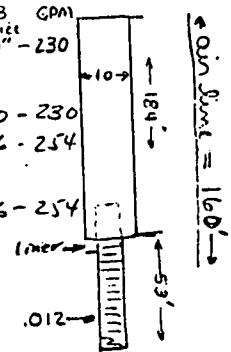

*1/2" of 10"
1/2" of 8" lap pipe
L84 1/3/43*

Pump
1/2" DWT, 6 stages, 160' col., 20' of 8" suction pipe.

TELEPHONE 736-6347
 P. O. BOX 309
 COLUMBIA, MISS. 39429

LOG FORM

NAME Town Of Bude, Well No. 2
 LOCATION Bude, Mississippi
N/WL, NW/L. Sec/ 20, T6N, R4E
 ENGINEER McMullen & Associates
 DRILLER John Smith LOG. NO. J 1
 COMPLETED 12-2- 1972 ACCEPTED _____
 Sales Engineer Thad Shows Field Supervisor Thomas Powell

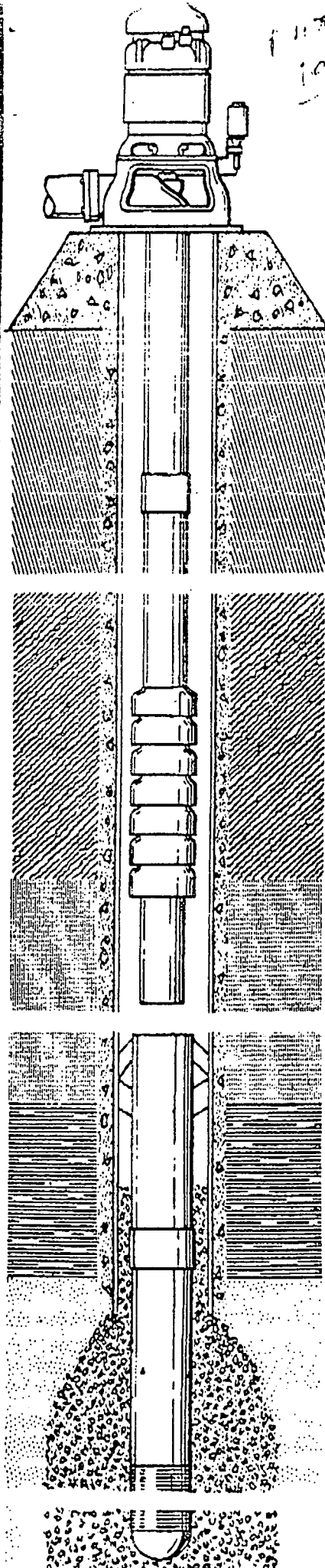

WELL DATA

Length surface casing N/A; size surface casing N/A
 Cemented N/A No. Sacks N/A Size Drilled Hole 21"
 Depth drilled hole 175' Size well casing 16" Type Welded
 Length well casing 172' cemented Yes No. Sacks 220
 Size underreamed hole 32" length underreamed hole 88'
 Size screen 8" type Gravel Guard mfg. by Doerr
 Slot size .031 material 304 S. S. length screen 63.79'
 Lap pipe size 8 lap pipe length _____ type _____
 Type gravel Georgia No. yds. 16 Distance to lap 131.5'
 Distance to screen top 183.21 (183-203-213-233) Distance to gravel 133'
 Distance to screen bottom 233' type bottom Back Wash Valve
 Connection top of lap 8" L&R Coupling static water level 64'

PUMP DATA

Type Turbine make Floway Serial No. N/A
 Size bowls 12" No. stages 11 Curve No. 12LKI Length bowls 10'3"
 Length column 130' size column 6" type column Threaded
 Size oil tube 2" size shaft 1 1/2" length suction 20'
 Size suction 6" size discharge 8" Head No. 8x16 1/2" C"
 Overall pump length 150'-3" Length headshaft 48"
 Type lubrication Oil type oiler Solenoid length air line N/A
 Rated capacity 500 GPM Total Head @ 264'
 RPM 1170 Size foundation 2'x2' Height 2'

ELECTRIC MOTOR DATA

Type VHS Make G. E. Serial No. N/A
 HP 50 Voltage 230 RPM 1170 Frame B365 TP
 Style P Phase 3 Cycle 60 AMPS 61
 Height motor 31 3 Dia. base 16 1/2" Clutch bore 1.188" Clutch No. N/A
 Top bearing No. N/A Lower bearing No. N/A Lubrication Oil

SWITCH DATA

Type Pumping Plant Panel Make Square "D"
 Catalog No. 8940 Size 4 Rating 100 Amps
 Volts 230 Phase 3 Cycles 60
 HP rating 50 Size relays 61 Relay type Quick Trip
 Entrance switch 100 Amps
 Fuse size & type 100 Amps Size wire # 2

