

WRD Exp. (GW)  
April 1966

Well No. M10

### WELL SCHEDULE

U. S. DEPT. OF THE INTERIOR

GEOLOGICAL SURVEY

WATER RESOURCES DIVISION

#### MASTER CARD

Record by Joe Source of data \_\_\_\_\_ Date \_\_\_\_\_ Map \_\_\_\_\_

State 28 County (or town) 18

Latitude: 305917N Longitude: 0891525 Sequential number: 1

Lat-long accuracy: 3 T. 10 R. 13 Sec 2, NE, SE

Local well number: M010AD0201513W Other number: \_\_\_\_\_

Local use: 095 Owner or name: \_\_\_\_\_

Owner or name: MORRIS SER STA Address: \_\_\_\_\_

Ownership: County, Fed Gov't, City, Corp or Co, Private, State Agency, Water Dist P

Use of water: (A) Air cond, (B) Bottling, (C) Comm, (D) Dewater, (E) Power, (F) Fire, (G) Dom, (H) Irr, (I) Med, (J) P S, (K) Rec, (L) Stock, (M) Instit, (N) Unused, (O) Repressure, (P) Recharge, (Q) Desal-P S, (R) Other H

Use of well: (A) Anode, (B) Drain, (C) Seismic, (D) Heat Res, (E) Obs, (F) Oil-gas, (G) Recharge, (H) Test, (I) Unused, (J) Withdraw, (K) Waste, (L) Destroyed W

DATA AVAILABLE: Well data  Freq. W/L meas.:  Field aquifer char.

Hyd. lab. data: \_\_\_\_\_

Qual. water data; type: \_\_\_\_\_

Freq. sampling: \_\_\_\_\_ Pumpage inventory:  yes,  no, period: \_\_\_\_\_

Aperture cards: \_\_\_\_\_

Log data: \_\_\_\_\_

#### WELL-DESCRIPTION CARD

SAME AS ON MASTER CARD Depth well: 75 Meas. rept accuracy 6

Depth cased: \_\_\_\_\_ Casing type: \_\_\_\_\_; Diam. in 2

Finish: (C) porous concrete, (F) gravel w. (parf.), (G) gravel w. (screen), (H) horiz. gallery, (I) open end, (J) perf., (K) screen, (L) sd. pt., (M) shored, (N) open hole, (O) other 7

Method Drilled: (A) air rot., (B) bored, (C) cable, (D) dug, (E) hyd jettied, (F) air rot., (G) percussion, (H) rotary, (I) reverse trenching, (J) driven, (K) drive wash, (L) other H

Date Drilled: 950 Pump intake setting: \_\_\_\_\_ ft 38

Driller: Leo Ladner address \_\_\_\_\_

Lift (type): (A) air, (B) bucket, (C) cent, (D) jet, (E) multiple, (F) multiple, (G) none, (H) piston, (I) rot, (J) submerg, (K) turb, (L) other J Deep  Shallow

Power (type): (A) diesel, (B) elec, (C) gas, (D) gasoline, (E) hand, (F) gas, (G) wind, (H) H.P. 1/4 5 Trans. or meter no. 5

Descrip. MP \_\_\_\_\_ ft above \_\_\_\_\_ ft below LSD, Alt. MP \_\_\_\_\_

Alt. LSD: \_\_\_\_\_ Accuracy: (source) \_\_\_\_\_

Water Level: \_\_\_\_\_ ft above \_\_\_\_\_ ft below MP; \_\_\_\_\_ ft above \_\_\_\_\_ ft below LSD 44 Accuracy: \_\_\_\_\_

Date meas: \_\_\_\_\_ Yield: \_\_\_\_\_ gpm \_\_\_\_\_ Method determined \_\_\_\_\_

Drawdown: \_\_\_\_\_ ft \_\_\_\_\_ Accuracy: \_\_\_\_\_ Pumping period \_\_\_\_\_ hrs \_\_\_\_\_

QUALITY OF WATER DATA: Iron \_\_\_\_\_ ppm \_\_\_\_\_ Sulfate \_\_\_\_\_ ppm \_\_\_\_\_ Chloride \_\_\_\_\_ ppm \_\_\_\_\_ Hard. \_\_\_\_\_ ppm

Sp. Conduct \_\_\_\_\_ K x 10<sup>6</sup> \_\_\_\_\_ Temp. \_\_\_\_\_ °F \_\_\_\_\_ Date sampled \_\_\_\_\_

Taste, color, etc. \_\_\_\_\_

Well No. M10

Well No. 1710Latitude-longitude N  
S  
d m s d m s

## HYDROGEOLOGIC CARD

SAME AS ON MASTER CARD

Physiographic  
Province: 03

Section: \_\_\_\_\_

DDrainage  
Basin: \_\_\_\_\_139

Subbasin: \_\_\_\_\_

Topo of well site: (D) (C) (E) (F) (H) (K) (L)  
depression, stream channel, dunes, flat, hilltop, sink, swamp,  
(O) (P) (S) (T) (U) (V)  
offshore, pediment, hillside, terrace, undulating, valley flat

MAJOR

AQUIFER: \_\_\_\_\_

system

series

TM

aquifer, formation, group

HA

Lithology: \_\_\_\_\_

S

Origin: \_\_\_\_\_

3

Aquifer

Thickness: \_\_\_\_\_ ft

Length of  
well open to: \_\_\_\_\_ ft

\_\_\_\_\_ ft

Depth to  
top of: \_\_\_\_\_ ft

\_\_\_\_\_ ft

MINOR  
AQUIFER: \_\_\_\_\_

system

series

\_\_\_\_\_

aquifer, formation, group

\_\_\_\_\_

Lithology: \_\_\_\_\_

\_\_\_\_\_

Origin: \_\_\_\_\_

\_\_\_\_\_

Aquifer

Thickness: \_\_\_\_\_ ft

Length of  
well open to: \_\_\_\_\_ ft

\_\_\_\_\_ ft

Depth to  
top of: \_\_\_\_\_ ft

\_\_\_\_\_ ft

Intervals  
Screened: \_\_\_\_\_Depth to  
consolidated rock: \_\_\_\_\_ ft

\_\_\_\_\_ ft

Source of data: \_\_\_\_\_

\_\_\_\_\_

Depth to  
basement: \_\_\_\_\_ ft

\_\_\_\_\_ ft

Source of data: \_\_\_\_\_

\_\_\_\_\_

Surficial  
material: \_\_\_\_\_

\_\_\_\_\_

Infiltration  
characteristics: \_\_\_\_\_

\_\_\_\_\_

Coefficient  
Trans: \_\_\_\_\_

\_\_\_\_\_ gpd/ft

Coefficient  
Storage: \_\_\_\_\_

\_\_\_\_\_

Coefficient  
Perm: \_\_\_\_\_\_\_\_\_\_ gpd/ft<sup>2</sup>; Spec cap: \_\_\_\_\_

\_\_\_\_\_ gpm/ft; Number of geologic cards: \_\_\_\_\_

\_\_\_\_\_

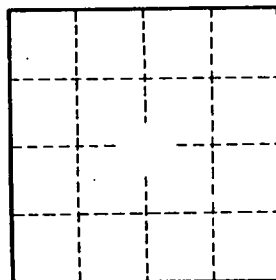
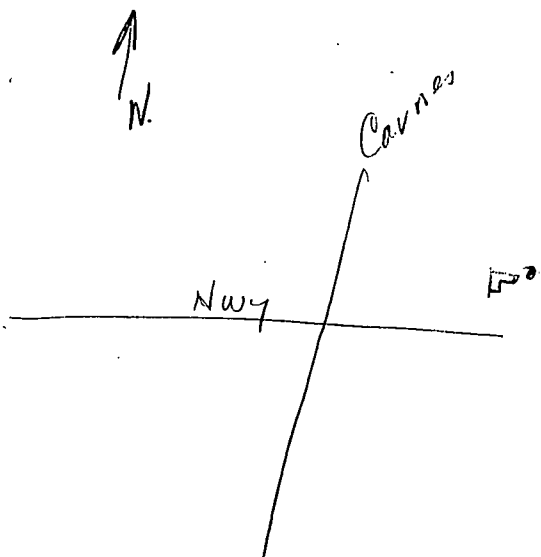
Well No. 1710