

WRD Exp. (GW)
April 1966

Well No. L13

WELL SCHEDULE

U. S. DEPT. OF THE INTERIOR

GEOLOGICAL SURVEY

WATER RESOURCES DIVISION

FIELD VERIFIED
WELL REGISTRATION BRANCH

MASTER CARD

Record by Jac Source of data _____ Date _____ Map _____

State 28 County (or town) 18

Latitude: 310413N Longitude: 0891240 Sequential number: 1

Lat-long accuracy: 3 T. 1 S, R 12 W Sec 4, SW $\frac{1}{4}$, SW $\frac{1}{4}$

Local well number: L01300401W124 Other number: _____

Local use: _____ Owner or name: _____

Owner or name: J E O P M Address: _____

Ownership: County, Fed Gov't, City, Corp or Co, Private, State Agency, Water Dist P

Use of water: (A) Air cond, Bottling, Comm, Dewater, Power, Fire, Dom, Irr, Med, Ind, P S, Rec, (S) Stock, Inatit, Unused, Repressure, Recharge, Desal-P S, Desal-other, Other H

Use of well: (A) Anode, Drain, Seismic, Heat Res, Obs, Oil-gas, Recharge, Test, Unused, Withdraw, Waste, Destroyed W

DATA AVAILABLE: Well data Freq. W/L meas.: 0 Field aquifer char.

Hyd. lab. data: _____

Qual. water data; type: _____

Freq. sampling: _____ Pumpage inventory: yes no; period: _____

Aperture cards: _____

Log data: _____

WELL-DESCRIPTION CARD

SAME AS ON MASTER CARD Depth well: 97 ft Meas. rept. accuracy 6

Depth cased; (first perf.): 85 ft Casing type: _____; Diam. in 2

Finish: (C) porous concrete, (F) gravel w. (perf.), (G) gravel w. (screen), (H) horiz. gallery, (P) open end, (S) perf., (T) screen, (W) sd. pt., (X) shored, (Z) open hole, other S

Method Drilled: (A) air rot, (B) bored, (C) cable, (D) dug, (H) hyd jetted, (J) air rot., (P) percussion, (R) rotary, (T) reverse trenching, (V) driven, (W) drive wash, other H

Date Drilled: 962 Pump intake setting: _____ ft 38

Driller: Hartfield name _____ address _____

Lift (type): (A) air, (B) bucket, (C) tent, (J) jet, (L) multiple, (M) multiple, (N) none, (P) piston, (R) rot, (S) submerg, (T) turb, other J Deep Shallow

Power (type): (nat) diesel, (elec) gas, gasoline, hand, gas, wind; H.P. 1 Trans. or meter no. S

Descrip. MP _____ ft above _____ ft below LSD. Alt. MP _____

Alt. LSD: 278 Accuracy: (source) 4

Water Level: _____ ft above _____ ft below MP; F _____ ft above _____ ft below LSD Accuracy: 30 Method determined G

Date meas: 862 Yield: _____ gpm Pumping period: _____ hrs 68

Drawdown: _____ ft Accuracy: _____

QUALITY OF WATER DATA: Iron _____ ppm Sulfate _____ ppm Chloride _____ ppm Hard. _____ ppm

Sp. Conduct _____ K x 10 6 Temp. _____ °F Date sampled _____

Taste, color, etc. _____

Well No. L13

Latitude-longitude d m s N S d m s

HYDROGEOLOGIC CARD

SAME AS ON MASTER CARD Physiographic Province: _____ Section: 03

D Drainage Basin: 113Q Subbasin: _____

Topo of well site: (D) depression, stream channel, dunes, flat, hilltop, sink, swamp, (K) (L) offshore, pediment, hillside, terrace, undulating, valley flat (P) (S) (T) (U) (V) #

MAJOR AQUIFER: _____ system, _____ series TP aquifer, formation, group C1

Lithology: _____ Origin: 2 Aquifer Thickness: _____ ft

Length of well open to: _____ ft Depth to top of: _____ ft

MINOR AQUIFER: _____ system, _____ series _____ aquifer, formation, group _____

Lithology: _____ Origin: _____ Aquifer Thickness: _____ ft

Length of well open to: _____ ft Depth to top of: _____ ft

Intervals Screened: _____ Depth to consolidated rock: _____ ft Source of data: _____

Depth to basement: _____ ft Source of data: _____

Surficial material: _____ Infiltration characteristics: _____

Coefficient Trans: _____ gpd/ft Coefficient Storage: _____

Coefficient Perm: _____ gpd/ft²; Spec cap: _____ gpm/ft; Number of geologic cards: _____

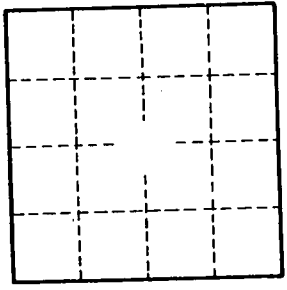
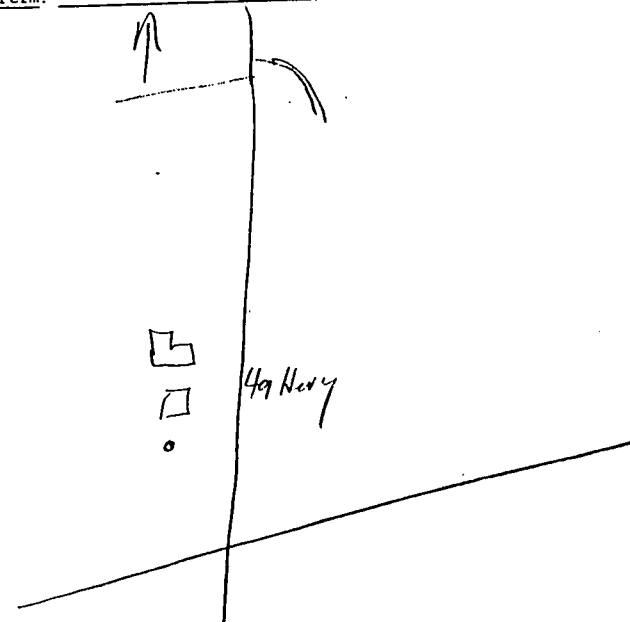

Well No. 413