

U.S. GEOLOGICAL SURVEY
WATER RESOURCES DIVISION
MISSISSIPPI DISTRICT
Checked by: *[Signature]*
Entered by: *[Signature]*
Date: 3/97

WELL RECORD

Agency Code
VICIS

Site ID
13111020891101011

Project No.
54

Station Name
12604th Camp Shelby

Latitude
33.111021

Longitude
90.1811101

Location Map
165 MISSISSIPPI

Altitude
1238

NE Land Net
15

Hydrologic Unit
20 = 1031101010171

Agency Use
Date inventoried
7/11/11

Station Type
906

Remarks
SE C.M. 01

Date of Construction
2/9/12

Well Use
Water Use Primary

Well Depth
403

Water Level
375

Method
375

CONSTRUCTION DATA
Construction Date
9/10/1996

CONSTRUCTION CASING DATA
Top/Casing
77.1

CONSTRUCTION OPENINGS DATA
Top/Depth
77.1

CONSTRUCTION LEFT DATA
Life Type
437T

WELL NO. 647

E-Log No. 217

Agency
LOYALIST

Agency

County

State

Country

Disc

Lat/Long

Location Map

Altitude

NE Land Net

Hydrologic Unit

Agency Use

Station Type

Remarks

Date of Construction

Well Use

Well Depth

Water Level

Method

CONSTRUCTION DATA

CONSTRUCTION CASING DATA

CONSTRUCTION OPENINGS DATA

CONSTRUCTION LEFT DATA

WELL NO. 647

E-Log No. 217

Agency
LOYALIST

Agency

County

State

Country

Disc

Lat/Long

Location Map

Altitude

NE Land Net

Hydrologic Unit

Agency Use

Station Type

Remarks

Date of Construction

Well Use

Well Depth

Water Level

Method

CONSTRUCTION DATA

CONSTRUCTION CASING DATA

CONSTRUCTION OPENINGS DATA

CONSTRUCTION LEFT DATA

WELL NO. 647

E-Log No. 217

Agency
LOYALIST

Agency

County

State

Country

Disc

Lat/Long

Location Map

Altitude

NE Land Net

Hydrologic Unit

Agency Use

Station Type

Remarks

Date of Construction

Well Use

Well Depth

Water Level

Method

CONSTRUCTION DATA

CONSTRUCTION CASING DATA

CONSTRUCTION OPENINGS DATA

CONSTRUCTION LEFT DATA

WELL NO. 647

E-Log No. 217

Agency
LOYALIST

Agency

County

State

Country

Disc

Lat/Long

Location Map

Altitude

NE Land Net

Hydrologic Unit

Agency Use

Station Type

Remarks

Date of Construction

Well Use

Well Depth

Water Level

Method

CONSTRUCTION DATA

CONSTRUCTION CASING DATA

CONSTRUCTION OPENINGS DATA

CONSTRUCTION LEFT DATA

MISCELLANEOUS JW DATA

R=192	T=A	738#1	Date of Measurement	Aquifer Sampled	Temp	Value
			1934 / /	1954	196700010	1974
R=192	T=A	738#2	Date of Measurement	Aquifer Sampled	So Cond	Value
			1934 / /	1954	196700095	1974
R=192	T=A	738#3	Date of Measurement	Aquifer Sampled	pH	Value
			1934 / /	1954	196700000	1974

MISCELLANEOUS LOGS DATA

R=192	T=A	739#1	Log Type	Sec. Depth	End Depth
			199#1	200#	201#
R=192	T=A	739#2	Log Type	Sec. Depth	End Depth
			199#1	200#	201#

MISCELLANEOUS NETWORK DATA 706 = GW WL WD *

R=114	T=A	730#1	Sec. Year	End Year	Agency Source	Free
			1154	1164	120#	116#
R=121	T=A	730#2	Sec. Year	End Year	Agency Source	Free
			1154	1164	117#	116#

MISCELLANEOUS REMARKS DATA

R=133	T=A	311#1	Date of Remarks	Remarks
			184# / /	185#

DISCHARGE DATA

R=146	T=A	Pump/Flow	Date	Type	Discharge	Sp. Capacity
		147#1	148# 09 / 10 / 11 996	703# P	150#	272#

GEOHYDROLOGIC DATA

R=90	T=A	721#1	Depth Top	Depth Bot.	Unit Id	304#
			91# 305	92#	93# 1212HBRK	304#

HYDRAULIC DATA

R=78	T=A	790#1	Unit Tested
			100# 105#

- Tank Wash Well -

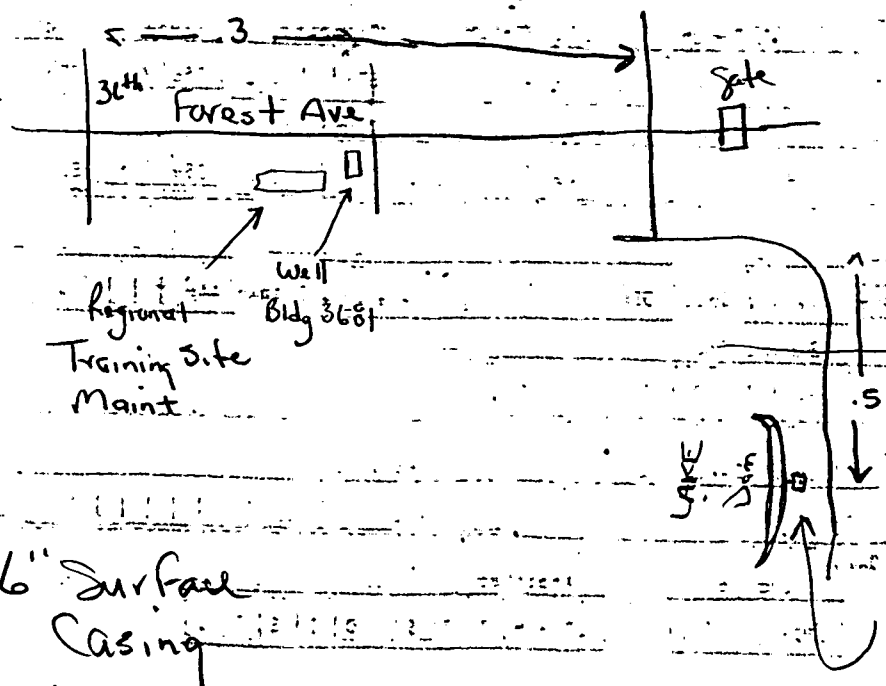

140' of 16" Surface Casing