

WRD Exp. (GW)  
April 1966

Well No. D11

### WELL SCHEDULE

U. S. DEPT. OF THE INTERIOR

GEOLOGICAL SURVEY

WATER RESOURCES DIVISION

PUNCHED and VERIFIED  
ROLLA COMPUTATION BRANCH

#### MASTER CARD

Record by Jal Source of data \_\_\_\_\_ Date \_\_\_\_\_ Map \_\_\_\_\_

State 28 County (or town) 18

Latitude: 311723 N 0891607 S Longitude: 0891607 Sequential number: 1

Lat-long accuracy: 3 T 4 N 130 S, R 23 Sec NW SE B & M

Local well number: D011R02304N13W Other number: \_\_\_\_\_

Local use: 009 Owner or name: DIXIE PINE PROD Address: \_\_\_\_\_

Ownership: County, Fed Gov't, City, Corp or Co, Private, State Agency, Water Dist N

Use of Air cond, Bottling, Comm, Dewater, Power, Fire, Dom, Irr, Med, Ind, P S, Rec, Water: N

Use of (A) (D) (G) (H) (I) (J) (K) (L) (M) (N) (O) (P) (Q) (R) (S) (T) (U) (V) (W) (X) (Y) (Z) W

Well: Anode, Drain, Seismic, Heat Res, Obs, Oil-gas, Recharge, Test, Unused, Withdraw, Waste, Destroyed.

DATA AVAILABLE: Well data  Freq. W/L meas:  Field aquifer char.

Hyd. lab. data:

Qual. water data; type:

Freq. sampling:  Pumpage inventory:  period:

Aperture cards:

Log data:

#### WELL-DESCRIPTION CARD

SAME AS ON MASTER CARD Depth well: 740 ft Meas. rept. accuracy 3

Depth cased; (first perf.) 695 ft Casing type: Steel; Diam. 20X12X10 20

Finish: G (C) porous concrete, (F) gravel w. (perf.), (G) gravel w. (screen), (H) horiz. gallery, end, (I) open hole, (J) other

Method: H (A) air bored, (B) cable, (C) dug, (D) rot., (E) hyd jetted, (F) air percussion, (G) rotary, (H) reverse, (I) trenching, (J) driven, (K) drive wash, (L) other

Date Drilled: 10/50 950 Pump intake setting: 80 ft 80

Driller: Carlson well co. address \_\_\_\_\_

Lift (type): 7 (A) air, (B) bucket, (C) cent., (D) jet, (E) multiple, (F) multiple, (G) none, (H) piston, (I) rot., (J) submerg, (K) turb, (L) other Deep  Shallow

Power (type): 75 (A) diesel, (B) elec, (C) gas, (D) gasoline, (E) hand, (F) gas, (G) wind; H.P. 75 Trans. or meter no.

Descrip. MP \_\_\_\_\_ ft above \_\_\_\_\_ ft below LSD, Alt. MP \_\_\_\_\_

Alt. LSD: 148 Accuracy: 4

Water Level: 6 ft above MP; Ft below LSD 6 Accuracy: 3

Date meas: 050 Yield: 1000 gpm Method determined 150 hrs

Drawdown: \_\_\_\_\_ ft Accuracy: \_\_\_\_\_ Pumping period \_\_\_\_\_ hrs

QUALITY OF WATER DATA: Iron \_\_\_\_\_ ppm Sulfate \_\_\_\_\_ ppm Chloride \_\_\_\_\_ ppm Hard. \_\_\_\_\_ ppm

Sp. Conduct \_\_\_\_\_ K x 10 6 Temp. \_\_\_\_\_ °F Date sampled \_\_\_\_\_

Taste, color, etc. \_\_\_\_\_

Well No.

D11

Latitude-longitude N  
S  
d m s d m s

**HYDROGEOLOGIC CARD**

**SAME AS ON MASTER CARD** Province: 03 Section: \_\_\_\_\_  
Drainage Basin: D 130 Subbasin: \_\_\_\_\_

Topo of well site: (D) depression, stream channel, dunes, flat, hilltop, sink, swamp, (K) (L) (P) (S) (T) (U) (V) \_\_\_\_\_  
 offshore, pediment, hillside, terrace, undulating, valley flat \_\_\_\_\_

MAJOR AQUIFER: \_\_\_\_\_ system \_\_\_\_\_ series TM \_\_\_\_\_ aquifer, formation, group CA  
 Origin: \_\_\_\_\_ Aquifer Thickness: \_\_\_\_\_ ft

Lithology: \_\_\_\_\_ Length of well open to: \_\_\_\_\_ ft 55 Depth to top of: \_\_\_\_\_ ft

MINOR AQUIFER: \_\_\_\_\_ system \_\_\_\_\_ series \_\_\_\_\_ aquifer, formation, group \_\_\_\_\_  
 Origin: \_\_\_\_\_ Aquifer Thickness: \_\_\_\_\_ ft

Lithology: \_\_\_\_\_ Length of well open to: \_\_\_\_\_ ft \_\_\_\_\_ Depth to top of: \_\_\_\_\_ ft

Intervals Screened: 55' Cook. 145 to 1st. 695-740

Depth to consolidated rock: \_\_\_\_\_ ft \_\_\_\_\_ Source of data: \_\_\_\_\_

Depth to basement: \_\_\_\_\_ ft \_\_\_\_\_ Source of data: \_\_\_\_\_

Surficial material: \_\_\_\_\_ Infiltration characteristics: \_\_\_\_\_

Coefficient Trans: \_\_\_\_\_ gpd/ft \_\_\_\_\_ Coefficient Storage: \_\_\_\_\_

Coefficient Perm: \_\_\_\_\_ gpd/ft<sup>2</sup>; Spec cap: \_\_\_\_\_ gpm/ft; Number of geologic cards: \_\_\_\_\_

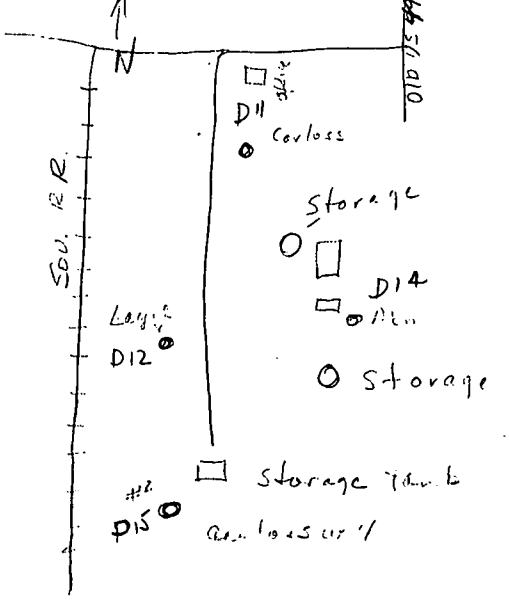

- 0-7. Sand & clay
- 7-42. Sand & Gravel
- 42-163. Sand & clay s&ls
- 163-192. Sand.
- 192-226. Sandy clay
- 226-361. coarse sand
- 361-378. Clay
- 378-510. Sand
- 510-586. - clay & s&ls of sh. &c.
- 586-650. Sp. s&ls of sh. &c.
- 650-740. Peat & sand

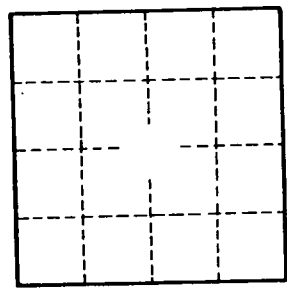

Well No. D11