

GW03242

DOM # 180008-10

WRD Exp. (GW)
April 1966

Well No. D7

WELL SCHEDULE

U. S. DEPT. OF THE INTERIOR

GEOLOGICAL SURVEY

WATER RESOURCES DIVISION

MASTER CARD

PUNCHED AND VERIFIED
GULLA CORRECTION DIVISION

Record by Jae Source of data _____ Date _____ Map Hattiesburg

State 28 County (or town) 28

Latitude: 31° 18' 03" N Longitude: 089° 16' 44" W Sequential number: 7

Lat-long accuracy: 3° T 4 S, R 13 E, Sec 15, SE 1/4, NE 1/4

Local well number: 01007DA1504N13W Other number: #4 B & M

Local use: 064 Owner or name: HATTIESBURG Address: _____

Ownership: County, Fed Gov't, City, Corp or Co, Private, State Agency, Water Dist M

Use of water: (A) Air cond, (B) Bottling, (C) Comm, (D) Dewater, (E) Power, (F) Fire, (H) Dom, (I) Irr, (M) Med, (N) Ind, (P) P S, (R) Rec, (S) Stock, (T) Instlt, (U) Unused, (V) Reppure, (W) Recharge, (X) Desal-P S, (Y) Desal-other, (Z) Other P

Use of well: (A) Anode, (D) Drain, (G) Seismic, (H) Heat Res, (I) Obs, (J) Oil-gas, (K) Recharge, (L) Test, (M) Unused, (N) Withdraw, (O) Waste, (P) Destroyed. U

DATA AVAILABLE: Well data Freq. W/L meas.: Field aquifer char.

Hyd. lab. data: _____

Qual. water data; type: MSBON Complete 6-8-61

Freq. sampling: Pumpage inventory: no, period: _____ yes

Aperture cards: _____ yes

Log data: _____ 78 79

WELL-DESCRIPTION CARD

SAME AS ON MASTER CARD Depth well: _____ ft 688 Meas. rept. accuracy 6

Depth cased: _____ ft 618 Casing type: _____; Diam 10x12x8 in 16

Finish: (C) concrete, (F) porous gravel w. (G) gravel w. (H) horiz. open (I) screen, (J) sd. pt., (K) shored, (L) open hole, (M) other B

Method: (A) air bored, (B) cable, (C) dug, (D) hyd jetted, (E) air reverse, (F) trenching, (G) driven, (H) drive wash, (I) other A

Date Drilled: 6/60 960 Pump intake setting: _____ ft _____

Driller: Layne Central name (L) (M) address _____ Deep Shallow

Lift (type): (A) air, (B) bucket, (C) cent, (D) jet, (E) multiple, (F) multiple, (G) none, (H) piston, (I) rot, (J) submerg, (K) turb, (L) other 7

Power (type): diesel nat gas, gasoline, hand, gas, wind; H.P. 75 Trans. or meter no. _____

Descrip. MP _____ ft above below LSD, Alt. MP _____

Alt. LSD: _____ Accuracy: (source) 1

Water Level: _____ ft above below MP; Ft below LSD 20 Accuracy: _____

Date meas: 664 Yield: _____ gpm 1207 Method determined _____

Drawdown: _____ ft 79 Accuracy: _____ Pumping period: _____ hrs 20

QUALITY OF WATER DATA: Iron 4 ppm Sulfate 16 ppm Chloride 4.0 ppm Hard. 32 ppm

Sp. Conduct K x 10⁶ _____ Temp. 72 °F 77 Date sampled 661

Taste, color, etc. _____

Well No. D7

Latitude-longitude _____
d m s N
d m s S

HYDROGEOLOGIC CARD

SAME AS ON MASTER CARD

Physiographic Province: _____ Section: 03

Drainage Basin: D _____ Subbasin: 130

Topo of well site: (D) depression, (C) stream channel, (E) dunes, (F) flat, (H) hilltop, (K) sink, (L) swamp, (P) offshore, (S) pediment, (T) hillside, (U) terrace, (V) undulating, valley flat

MAJOR AQUIFER: system _____ series TM _____ aquifer, formation, group CA

Lithology: _____ Origin: 3 _____ Aquifer Thickness: _____ ft

Length of well open to: _____ ft _____ Depth to top of: _____ ft

MINOR AQUIFER: system _____ series _____ aquifer, formation, group _____

Lithology: _____ Origin: _____ Aquifer Thickness: _____ ft

Length of well open to: _____ ft _____ Depth to top of: _____ ft

Intervals Screened: _____

Depth to consolidated rock: _____ ft _____ Source of data: _____

Depth to basement: _____ ft _____ Source of data: _____

Surficial material: _____ Infiltration characteristics: _____

Coefficient Trans: _____ gpd/ft _____ Coefficient Storage: _____

Coefficient Perm: _____ gpd/ft²; Spec cap: _____ gpm/ft; Number of geologic cards: _____

See D4 for LOC

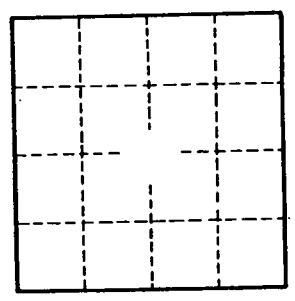

Well No. D7

APPLICATION FOR PERMIT TO DIVERT OR WITHDRAW WATER FROM PLANT #2 WELL #4 FOR BENEFICIAL USE THE PUBLIC WATERS OF THE STATE OF MISSISSIPPI

RECEIVED

APR 05 1996

DEPARTMENT OF ENVIRONMENTAL QUALITY, OFFICE OF LAND AND WATER RESOURCES
P.O. BOX 10631, JACKSON, MS 39289-0631; (601) 961-5202

This box is for office use only. 2-11-97 AGN.

| | | | |
|--------------------------|---------------------------|--------------------|--------------------|
| Issued: <u>8-26-86</u> | Expires: <u>8-26-2006</u> | Fee Paid: <u>X</u> | Permit No. _____ |
| Lat. <u>31-18-42</u> | Long. <u>89-16-52</u> | Elev. <u>145</u> | USGS No. <u>D7</u> |
| Quad. <u>Hattiesburg</u> | ASCS Farm No. _____ | STAC. _____ | MSDOH No. _____ |
| Aquifer: _____ | Tract No. _____ | _____ | Basin No. _____ |
| Remarks: _____ | _____ | _____ | Dam Inv. No. _____ |

THIS APPLICATION IS FOR (Circle one): RENEWAL - PERMIT NO. MS-GW-032 42

THIS APPLICATION IS FOR (Circle one): GROUNDWATER - COMPLETE A,B,E
SURFACE WATER - COMPLETE A,C,D,E

BENEFICIAL USE (Circle one or more):
 (1) Public Supply - Municipal, Rural Water, or Private Water
 (2) Irrigation
 (3) Industrial
 (4) Fish Culture
 (5) Recreation
 (6) Institutional (eg. Church, School)
 (7) Commercial (eg. Hotel, Casino, Restaurant)
 (8) Fire Protection
 (9) Livestock
 (10) Flood Protection
 (11) Other: _____

SECTION A (to be completed by ALL APPLICANTS)

LANDOWNER: City of Hattiesburg 64-6000432
 (Name) (SSN or Tax ID No.)
P.O. Box 1898
 (Address)
Hattiesburg, MS 39403-1898 (601) 545 4500
 (City) (State & Zip) (Telephone No.)

APPLICANT, AGENT, OR LESSEE (if different from Landowner):
SAME
 (Name) (SSN or Tax ID No.)
 (Address)
 (City) (State & Zip) (Telephone)

MAP SENT

Location of diversion/withdrawal point (A suitable map with location marked must accompany this application):
SE 1/4 of the NE 1/4 of Section 15, Township 04 N, Range 13W, County Forrest
 Does the land to which this application pertains have any source(s) of water other than that for which you are now applying (circle one)? YES NO If yes, describe the nature and amount of any additional supply and, if applicable, list permit number. MS-GW-03239, 03240, 03241, and 11694

SECTION B (to be completed for GROUNDWATER SOURCE)

1. AQUIFER: Catahoula MISSISSIPPI DEPARTMENT OF HEALTH NO.: 180008-10

2. Proposed work will begin on _____, 19____, and will be completed by _____, 19____.
 If well has already been drilled, when was well completed (date)? _____, 19 60. Under whose name was well originally drilled (if known)? City of Hattiesburg

3. Description of proposed or completed well:
 (a) DEPTH OF WELL: 688 feet. DRILLER: Layne Central Company
 (b) SURFACE CASING: Length 600 feet; Diameter 12 inches; Type Steel
 (c) SCREEN: Length 70 feet; Diameter 8 inches; Type Slotted
 (d) PUMP: Type Turbine; Size 12"; Capacity 1200 gallons per minute; Setting depth 140 feet
 (e) POWER UNIT: Type Electric; Size 75 horsepower

4. PERMITTED VOLUME:
 (a) _____ per year at a maximum rate of _____ gallons per minute
 (b) 1.7 million gallons per day at a maximum rate of 1200 gallons per minute

(CONTINUED ON BACK)

1200

SECTION C (to be completed for SURFACE WATER SOURCE)

1. Source of water is from _____ which drains into _____
which drains into _____
(major stream or river)
2. Discription of pump/diversion works:
Pump (size & type): _____ Power Unit (size & type): _____
Lift: _____ feet Maximum capacity: _____ gallons per minute
3. _____ acre-feet per year at a maximum rate of _____ gallons per minute

SECTION D (to be completed for SURFACE WATER IMPOUNDMENTS {DAMS} on continuously flowing streams)

1. Name of storage reservoir: _____ Dam Height: _____ feet
2. Surface area at normal pool: _____ Storage capacity at normal pool: _____ acre-feet

SECTION E WATER USE DATA (ALL APPLICATIONS - complete section related to beneficial use)

1. IRRIGATION: List the number of acres of each crop to be irrigated: Rice _____; Cotton _____; Oats _____; Corn _____; Soybeans _____; Pasture _____; Truck _____; Wheat _____; Grain Sorgum _____; Other (specify) _____ Acres _____

A. Method of Irrigation (circle one) - Center Pivot Flood Furrow

B. Land Condition (circle one) - Precision Land Formed Smoothed

C. ASCS Farm No. _____ Tract No. _____

2. FISH CULTURE: Explain how water will be used: _____
How often will reservoir (s) be emptied and refilled? _____
3. MUNICIPAL, WATER ASSOCIATION, or PRIVATE WATER SYSTEM
Chose "a" or "b". (a) The number of people served is _____ or (b) The number of connections is 15,300
What is the estimated average daily consumption during periods of maximum use at the end of each five-year period during the next twenty (20) years?

| | | | | | | | |
|----------|--------|----------|--------|----------|--------|----------|--------|
| 9.2 MGD | 2001 | 10.6 MGD | 2006 | 12.2 MGD | 2011 | 14.0 MGD | 2016 |
| (Volume) | (Year) | (Volume) | (Year) | (Volume) | (Year) | (Volume) | (Year) |

4. INDUSTRIAL : If the water is to be released into a watercourse, indicate the amount released each year _____;
Rate of release _____; NPDES Permit No. _____
Explain any changes in quality of water to be released: _____
Explain how water will be used: _____
How much groundwater will be used for once-through non-contact cooling? _____

5. RECREATION: Explain how water will be used: _____

6. OTHER USE: Explain in detail (if needed, attach another page): _____

7. REMARKS: _____

List below the person to be contacted for additional information if required.

Charles Henderson
(Name)
Water Plant #2, 900 James St.
(Address)
Hattiesburg, MS 39401
(City, State, Zip)
601-545-4530
(Telephone)

The accompanying map is hereby declared a part of this application. For irrigation and fish culture use, an ASCS photograph is required. The TEN DOLLAR (\$10.00) permit fee is enclosed herewith.



(Signature)

Subscribed and sworn to before me this 21st day of March, 19 96, at Hattiesburg County of Sorrent
My commission expires 8-23-96; Melinda M. Nixon Notary Public.

DEPARTMENT OF ENVIRONMENTAL QUALITY - OLWR

PUBLIC SUPPLY WELLS PROJECT

Hattiesburg
Quad.

GPS LOG

USER NAME(S): CA Hornbeak DATE: 6/28/94

UNIT DEQ #: 82555 FILE #: C062821B

HEALTH DEPT. #: 180008-10 ELEV. 145

USGS #: 2-118 D7 OLWR #: 3242

OWNER: City of Hattiesburg

LOCATION: ^{nw-}SE-NE S 15 T 4 N R 13 W COUNTY: Forest

LOCATION DESCRIPTION: Intersection of James St + Tipton St.
South of (Plant # 2) + South of City Bus Barn.

CASING DIA: 18" PUMP TYPE & SIZE: 60 HP Elec.

GPS FIELD LOCATION: LAT. 31° 18.730 LONG. 89° 16.873

GPS CORRECTED LOCATION: LAT. 31 18 ^{43.927} ~~51.013~~ LONG. 89 16 ^{51.685} ~~50.553~~
31.312206 89.2810204

REMARKS: GPS at well.

60-
3242
Renew

RECEIVED

APR 05 1996

Dept. of Environmental Quality
Office of Land & Water Resources

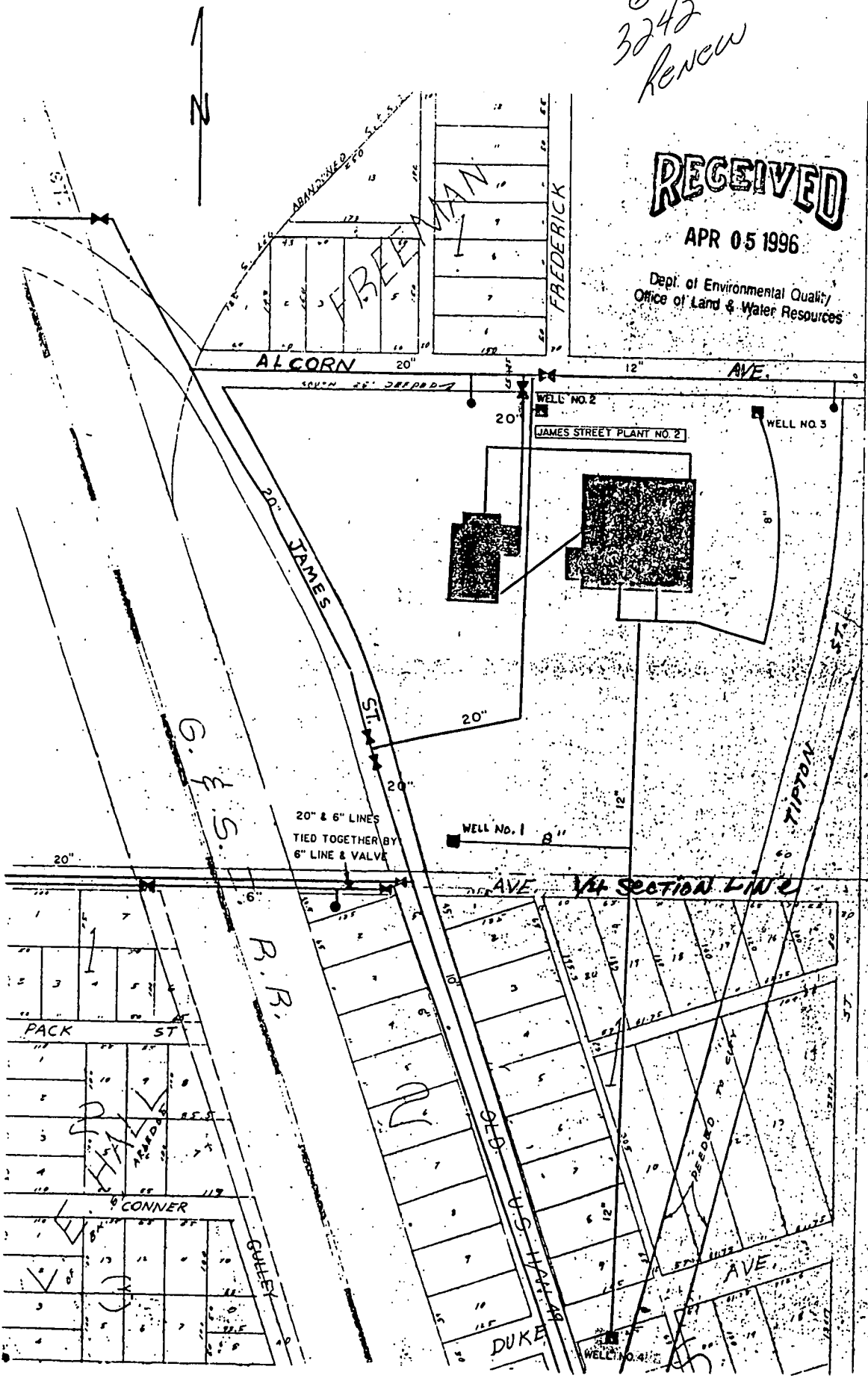

RECEIVED

APR 02 1996

Office of Land & Water Resources
Dept. of Environmental Quality

