

1/81 WTO

Recorded by WTO

Date 6/22/81

U.S. GEOLOGICAL SURVEY
WATER RESOURCES DIVISION
MISSISSIPPI DISTRICT
WELL RECORD

313
Carterville

Well No. 268 C69

E-Log No. 171

County Forrest

Site ID 312152089140703 R=0* T=A* 2=W*
5 19 Carterville Quad

GEN. SITE DATA

Data reliab. 3=C*^C Report. agency 4=USGS* Dist. 1407 6=28* 7=28* Co. 8=035*

Lat. Long. 9=312157* 10=089+352* Well No. 12=C068*

Location 13=NWSE S30 T05N R12W* Alt. 16=257.9

Hyd. Unit (OWDC) 20= Date 21=06/12/1981*

Well use 23=W* Water Use 24=P* Hole depth 27=734.* Well depth 28=722.*

WL 30=131.* Date 31=10/29/1981* Source 33=S*

Status 273= Project No. 5=

OWNER

R=158* T=A* Date 159#02/01/1982* Owner No. Supply well #2

Owner 161#PETAL

FIELD OR

R=192* T=A* Date 193#06/04/1982* Temp. 196#00010* 197=22.5*

R=192* T=A* Date 193# Cond. 196#00095* 197=

R=192* T=A* Date 193#06/04/1982* pH 196#00400* 197=7.4*

CONSTR.

R=58* T=A* 59#1* Date 60=02/01/1972* Remarks

Drlg. 63=184* Name Griner Method 65=H* Finish 66=5*

CASING

R=76* T=A* 59#1* Top csgn. 77#0.* Bot. csgn. 78=642.* Diam. 79#12.*

R=76* T=A* 59#1* Top csgn. 77#582.* Bot. csgn. 78=662.* Diam. 79#8.*

OPENINGS

R=82* T=A* 59#1* Top 83#662.* Bottom 84=722.*

Type 85=S* Diam. 87=8.* Size 88=.016*

R=82* T=A* 59#1* Top 83# Bottom 84=

Type 85= Diam. 87= Size 88=

YIELD

R=46* T=A* 147#1* Q 150=500.* Q/S 272=

R=42* T= A * Lift type 43# T* Intake 44= * Power type 45= E*

Date 38= 02/01/1982* H.P. 46= 60.*

LIFT

R=198* T= A * Log 199# E* Top 200= 10.* Bot 201= 734.*

R=198* T= A * Log 199# D* Top 200= 10.* Bot 201= 734.*

R=189* T= A * E Log No. 190# 171* 191= M I S S D I S T *

LOGS

R=114* T= A * Year 115# * 117= * 120= *

ANAL.

R=90* T= A * 256# 1 * Top 91= 665.* Bot 92= 720.*

Unit ID 93= 122# E N * Name of Unit _____

R=90* T= A * 256# 1 * Top 91= * Bot 92= *

Unit ID 93= * Name of Unit _____

AQUIFERS

R=98* T= A * 99# 1 * Unit tested 100= * 103= *

R=105* T= A * 99# 1 * Test No. 106# *

107= * Transmissivity (gal/d)/ft _____

108= * Hydraul. cond. (gal/d)/ft² _____

110= * Storage coeff. Boundaries _____

HYD. AULICS

R=121* T= A * Yr Begin 122# 1981 * Network 258# *

Water Level Data Collection (1)

43' dd @ 548 gpm

138.
5.21

132.79
- 2.00

130.79

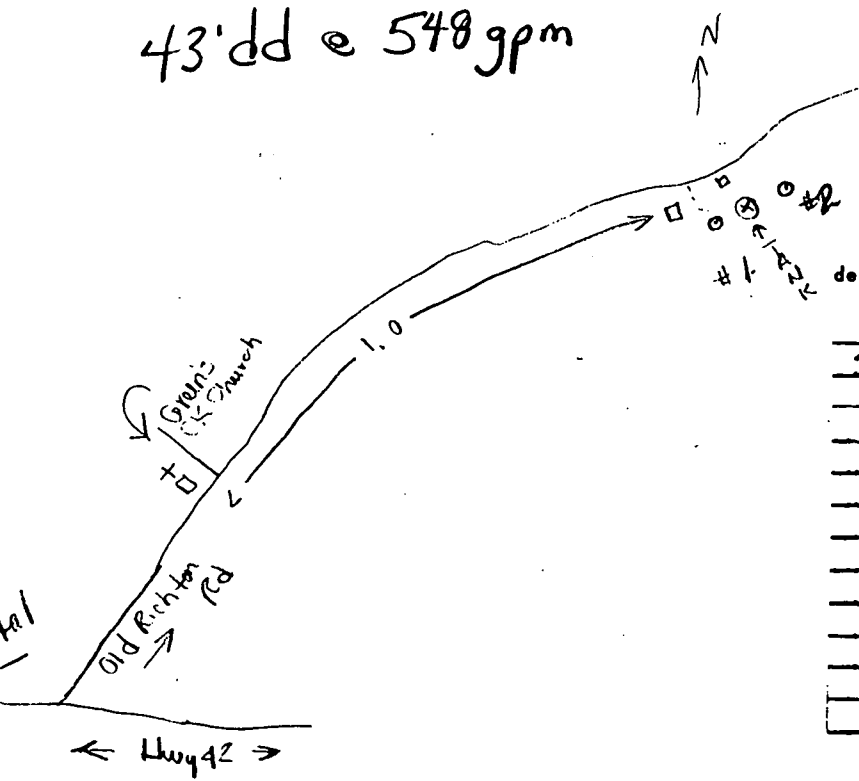

| description of formations encountered | from | to |
|---------------------------------------|------|-----|
| TOP SOIL | 0 | 4 |
| SAND + CLAY STRINGS | 4 | 12 |
| CLAY | 12 | 60 |
| SAND + GRAVEL | 60 | 220 |
| CLAY | 220 | 390 |
| SAND | 390 | 500 |
| CLAY | 500 | 584 |
| SAND | 584 | 610 |
| CLAY | 610 | 660 |
| SAND | 660 | 721 |
| CLAY | 721 | 734 |

MISSISSIPPI DEPARTMENT OF NATURAL RESOURCES

Bureau of Land and Water Resources

Southport Mall

P.O. Box 10631

Jackson, Mississippi 39209

WATER WELL DRILLERS LOG

CODED

| |
|------------|
| Forrest |
| C 698 |
| 2182 |
| GW 12 7000 |

state C5

Feb. 1982

PRINER DRILLING SER. FORREST

date well completed

firm name

county well located

LANDOWNER: CITY OF
PETAL - well no. 1
North of City
(mailing address)

WELL LOCATION: NW 1/4 SE 1/4 SEC 30 T 5 N R 12 E

(distance) miles (direction) of (nearest town)

WELL PURPOSE: (home, irrigation, municipal, industrial)

WELL COMPLETION DATA:

- (1) diameter (inches) 12 3/4"
- (2) total depth (feet) 722
- (3) static water level (feet) 164 below above top of ground.
- (4) casing Steel, 642' (material), (depth)
8 (size) if telescope see back.
- (5) screen 60, 660 (length), (depth to top)
8 (0.16), 304 S.S. (size), (material)
- (6) pump 60, 500 (HP), (yield gpm)
Elect. (type power)
- (7) electric log Yes (yes or no)
MGS (organization running log)
- (8) how well bottom plugged BACK
WASH VALVE

| description of formations encountered | from | to |
|---------------------------------------|------|-----|
| TOP SOIL | 0 | 4 |
| SAND & CLAY STRINGS | 4 | 12 |
| CLAY | 12 | 60 |
| SAND & GRAVEL | 60 | 220 |
| CLAY | 220 | 390 |
| SAND | 390 | 500 |
| CLAY | 500 | 584 |
| SAND | 584 | 610 |
| CLAY | 610 | 660 |
| SAND | 660 | 721 |
| CLAY | 721 | 734 |

CODED

DEPT. OF NATURAL RESOURCES
BUREAU OF LAND & WATER RESOURCES

FEB - 8 1982

RECEIVED

DRILLERS REMARKS:

**APPLICATION FOR PERMIT TO DIVERT OR WITHDRAW
FOR BENEFICIAL USE THE PUBLIC WATERS OF THE STATE OF MISSISSIPPI**

NOV 14 1995

DEPARTMENT OF ENVIRONMENTAL QUALITY, OFFICE OF LAND AND WATER RESOURCES
P.O. BOX 10631, JACKSON, MS 39289-0631; (601) 961-5202

This box is for office use only.

1-23-96 AGN.

FORM OLWR-AP-2 (REV. 9/94)

| | | | |
|---------------------------|--------------------------|---|----------------------------|
| Issued: <u>4-8-86</u> | Expires: <u>4-8-2006</u> | Fee Paid: <input checked="" type="checkbox"/> | Permit No. <u>GW-02000</u> |
| Lat. <u>31 21 53 OK</u> | Long. <u>89 14 00 OK</u> | Elev. <u>265 OK</u> | USGS No. |
| Quad. <u>CARTERSVILLE</u> | ASCS Farm No. | STAC. | MSDOH No. |
| Aquifer: | Tract No. | | Basin No. |
| Remarks: | | | Dam Inv. No. |

THIS APPLICATION IS FOR (Circle one): NEW PERMIT (RENEWAL -) PERMIT NO. MS-GW-02000

THIS APPLICATION IS FOR (Circle one): (GROUNDWATER) COMPLETE A,B,E

SURFACE WATER - COMPLETE A,C,D,E

BENEFICIAL USE (Circle one or more): 1) Public Supply - Municipal, Rural Water, or Private Water 2) Irrigation
3) Industrial 4) Fish Culture 5) Recreation 6) Institutional (eg. Church, School) 7) Commercial (eg. Hotel, Casino, Restaurant) 8) Fire Protection 9) Livestock 10) Flood Protection 11) Other: _____

SECTION A (to be completed by ALL APPLICANTS)

LANDOWNER: CITY OF PETAL (Name) 64-5653775 (SSN or Tax ID No.)
P O BOX 405 (107 WEST 8TH AVENUE) (Address)
PETAL MS 39465 (City) (State & Zip) (601) 544-6981 (Telephone No.)

APPLICANT, AGENT, OR LESSEE (if different from Landowner):

(Name) _____ (SSN or Tax ID No.) _____
(Address) _____
(City) _____ (State & Zip) _____ (Telephone) _____

Location of diversion/withdrawal point (A suitable map with location marked must accompany this application):

0.1 NE 1/4 of the SE 1/4 of Section 30, Township 5N, Range 12W, County FORREST

Does the land to which this application pertains have any source(s) of water other than that for which you are now applying (circle one)? YES (NO) If yes, describe the nature and amount of any additional supply and, if applicable, list permit number. _____

SECTION B (to be completed for GROUNDWATER SOURCE)

- AQUIFER: CATAHOULA MISSISSIPPI DEPARTMENT OF HEALTH NO.: 18001-02
- Proposed work will begin on _____, 19____, and will be completed by _____, 19____.
If well has already been drilled, when was well completed (date)? _____, 1982. Under whose name was well originally drilled (if known)? _____
- Description of proposed or completed well:
 - DEPTH OF WELL: 722 feet. DRILLER: GRINER DRILLING SERVICE
 - SURFACE CASING: Length 666 feet; Diameter _____ inches; Type STEEL
 - SCREEN: Length 54 feet; Diameter 8 inches; Type WIREWOUND STAINLESS
 - PUMP: Type TURBINE; Size 10"; Capacity 500 gallons per minute; Setting depth _____ feet
 - POWER UNIT: Type VHS; Size 60 horsepower
- PERMITTED VOLUME:
 - _____ acre-feet per year at a maximum rate of _____ gallons per minute
 - 10 million gallons per day at a maximum rate of: 500 gallons per minute

(CONTINUED ON BACK)

*CITY
MAP
SENT*

et
20
12-6-95

500

SECTION C (to be completed for **SURFACE WATER SOURCE**)

1. Source of water is from _____ which drains into _____
which drains into _____
(major stream or river)
2. Discription of pump/diversion works:
Pump (size & type): _____ Power Unit (size & type): _____
Lift: _____ feet Maximum capacity: _____ gallons per minute
3. _____ acre-feet per year at a maximum rate of _____ gallons per minute

SECTION D (to be completed for **SURFACE WATER IMPOUNDMENTS (DAMS)** on continuously flowing streams)

1. Name of storage reservoir: _____ Dam Height: _____ feet
2. Surface area at normal pool: _____ Storage capacity at normal pool: _____ acre-feet

SECTION E WATER USE DATA (ALL APPLICATIONS - complete section related to beneficial use)

1. **IRRIGATION:** List the number of acres of each crop to be irrigated: Rice _____; Cotton _____; Oats _____;
Corn _____; Soybeans _____; Pasture _____; Truck _____; Wheat _____; Grain Sorgum _____;
Other (specify) _____ Acres _____
A. Method of Irrigation (circle one) - Center Pivot Flood Furrow
B. Land Condition (circle one) - Precision Land Formed Smoothed
C. ASCS Farm No. _____ Tract No. _____
2. **FISH CULTURE:** Explain how water will be used: _____
How often will reservoir (s) be emptied and refilled? _____
3. **MUNICIPAL, WATER ASSOCIATION, or PRIVATE WATER SYSTEM**
Chose "a" or "b". (a) The number of people served is _____ or (b) The number of connections is 2750
What is the estimated average daily consumption during periods of maximum use at the end of each five-year period during the
next twenty (20) years? $\frac{.10}{(\text{Volume})}$ $\frac{2001}{(\text{Year})}$; $\frac{.15}{(\text{Volume})}$ $\frac{2006}{(\text{Year})}$; $\frac{.20}{(\text{Volume})}$ $\frac{2011}{(\text{Year})}$; $\frac{.25}{(\text{Volume})}$ $\frac{2016}{(\text{Year})}$
4. **INDUSTRIAL :** If the water is to be released into a watercourse, indicate the amount released each year _____;
Rate of release _____; NPDES Permit No. _____
Explain any changes in quality of water to be released: _____
Explain how water will be used: _____
How much groundwater will be used for once-through non-contact cooling? _____
5. **RECREATION:** Explain how water will be used: _____
6. **OTHER USE:** Explain in detail (if needed, attach another page): _____
7. **REMARKS:** _____

List below the person to be contacted for additional information if required.

JACK GAY
(Name)
P O BOX 564
(Address)
PETAL MS 39465
(City, State, Zip)
545-1776
(Telephone)

The accompanying map is hereby declared a part of this application.
For irrigation and fish culture use, an ASCS photograph is required.
The **TEN DOLLAR (\$10.00)** permit fee is enclosed herewith.

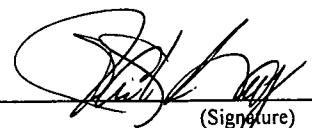

(Signature)

Subscribed and sworn to before me this 10 day of Nov, 1995, at Forest County of Mississippi
My Commission Expires August 13, 1998
My commission expires _____; Ava C. Pickett Notary Public.

DEPARTMENT OF ENVIRONMENTAL QUALITY - OLWR

PUBLIC SUPPLY WELLS PROJECT

Carterville
quad.

GPS LOG

USER NAME(S): CA. Hotwbeak DATE: 6/29/94

UNIT DEQ #: 82555 FILE #: C062921A

HEALTH DEPT. #: 180011-02 ELEV. 265

USGS #: 2-128 C69 OLWR #: 2000

OWNER: City of Petal

LOCATION: NW-SW-SE S 30 T 5N R 12W COUNTY: Forrest

LOCATION DESCRIPTION: AT Elev Tank on old RichYon Rd 2 mi. NE
of Hwy 42. (well is west of Tank)

CASING DIA: 12" PUMP TYPE & SIZE: 60 HP Elec

GPS FIELD LOCATION: LAT. 31° 21.879 LONG. 89° 13.997

GPS CORRECTED LOCATION: LAT. 31.2152.896 LONG. 89.13.59.528

REMARKS: GPS at well.
31.364693
89.233313

316 N NE
(EAST ABUCHIE)

Carterville
Quad

UNITED STATES
DEPARTMENT OF THE INTERIOR
GEOLOGICAL SURVEY

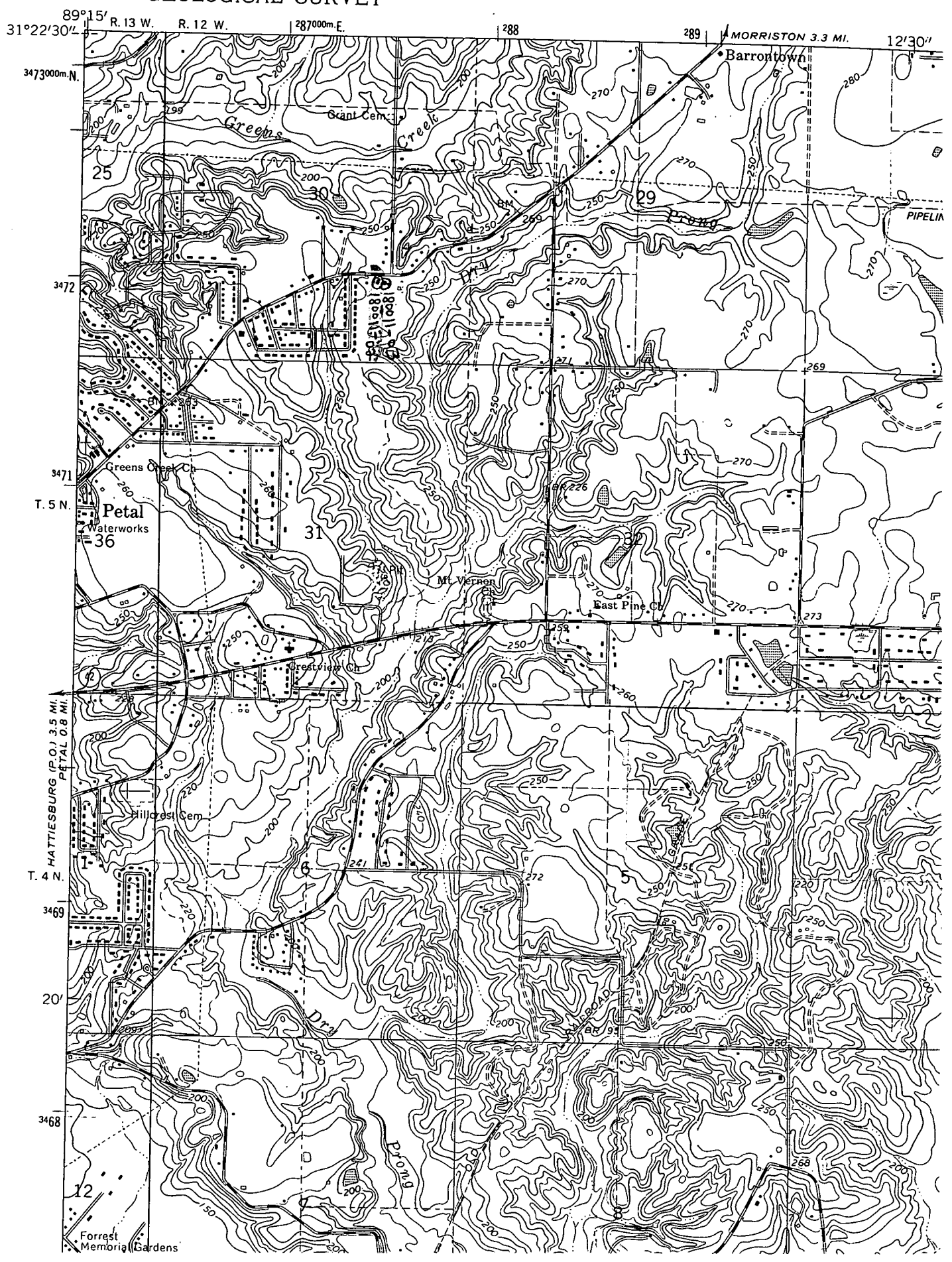

HATTIESBURG (P.O.) 3.5 MI.
PETAL 0.8 MI.

MORRISTON 3.3 MI.

T. 5 N.

T. 4 N.

20'

3468

3473000m.N.

31°22'30" N

89°15' W

R. 13 W.

R. 12 W.

287000m.E.

288

289

12'30" W