

Recorded by JAC WTO
Date 3/31/64 12/82

U.S. GEOLOGICAL SURVEY
WATER RESOURCES DIVISION
MISSISSIPPI DISTRICT
WELL RECORD

Well No. C34
E-Log No. _____
County Jones

TRANSMITTED FOR ADP 1/85

Site ID 314210089084401 R=0* T=A* 2=W*

GEN. SITE DATA

Data reliab. 3=C* Report. agency 4=USGS* Dist. 6=28* 7=28* Co. 8=0,6,7*
Lat. 9=314210* 10=0890844* Well No. 12=C034*
NW Location 13=SWSE, S 31 T 09 N R 11 W* Alt. 16=276.*
Hyd. Unit (OWDC) 20= Date 21=10/01/1945*
Well use 23= Water Use 24=U* Hole depth 27= Well depth 28=383.*
WL 30=196.* Date 31=10/27/1982* Source 33=S*
Status 273= Project No. 5=00200.*

OWNER

R=158* T=A* Date 159# 10/01/1945* Owner No. #5 Daphine Pk.
Owner 161# LAUREL

FIELD

R=192* T=A* Date 193# 06/13/1951* Temp. 196#00010* 197=22.0*
R=192* T=A* Date 193# / / * Cond. 196#00095* 197=
R=192* T=A* Date 193# / / * pH 196#00400* 197=

CONSTR.

R=58* T=A* 59# 1* Date 60=10/01/1945* Remarks _____
Drlg. 63=0,6,4* Name Laure Method 65=H* Finish 66=S*

CASING

R=76* T=A* 59# 1*
Top csgn. 77# 0.* Bot. csgn. 78=327.* Diam. 79# 18.* 12/18/83
186.64
Top csgn. 77# Bot. csgn. 78= Diam. 79#

OPENINGS

R=82* T=A* 59# 1* Top 83# 338.* Bottom 84=383.*
Type 85=S* Diam. 87=12.* Size 88=.007*
R=82* T=A* 59# 1* Top 83# Bottom 84=
Type 85= Diam. 87= Size 88=

YIELD

R= T=A* 147# 1* Q 150= Q/S 272=
134 flows 146 pumped

R=42* T= A * Lift type 43# * Intake 44= * Power type 45= *

LIFT Date 38= / / * H.P. 46= * *

R=198* T= A * Log 199# * Top 200= * Bot 201= *

R=198* T= A * Log 199# * Top 200= * Bot 201= *

R=189* T= A * E Log No. 190# * 191= M I S S D I S T *

ANAL. R=114* T= A * Year 115# 1951 * 117= USGS * 120= B *

R=90* T= A * 256# 1 * Top 91= * Bot 92= *

AQUIFERS Unit ID 93= 122CTHL * Name of Unit

R=90* T= A * 256# 1 * Top 91= * Bot 92= *

Unit ID 93= * Name of Unit

R=98* T= A * 99# 1 * Unit tested 100= * 103= *

R=105* T= A * 99# 1 * Test No. 106# *

HYDRAULICS 107= * Transmissivity (gal/d)/ft

108= * Hydraul. cond. (gal/d)/ft²

110= * Storage coeff. Boundaries

R=121* T= A * Yr Begin 122# 1945 * Network 258# *

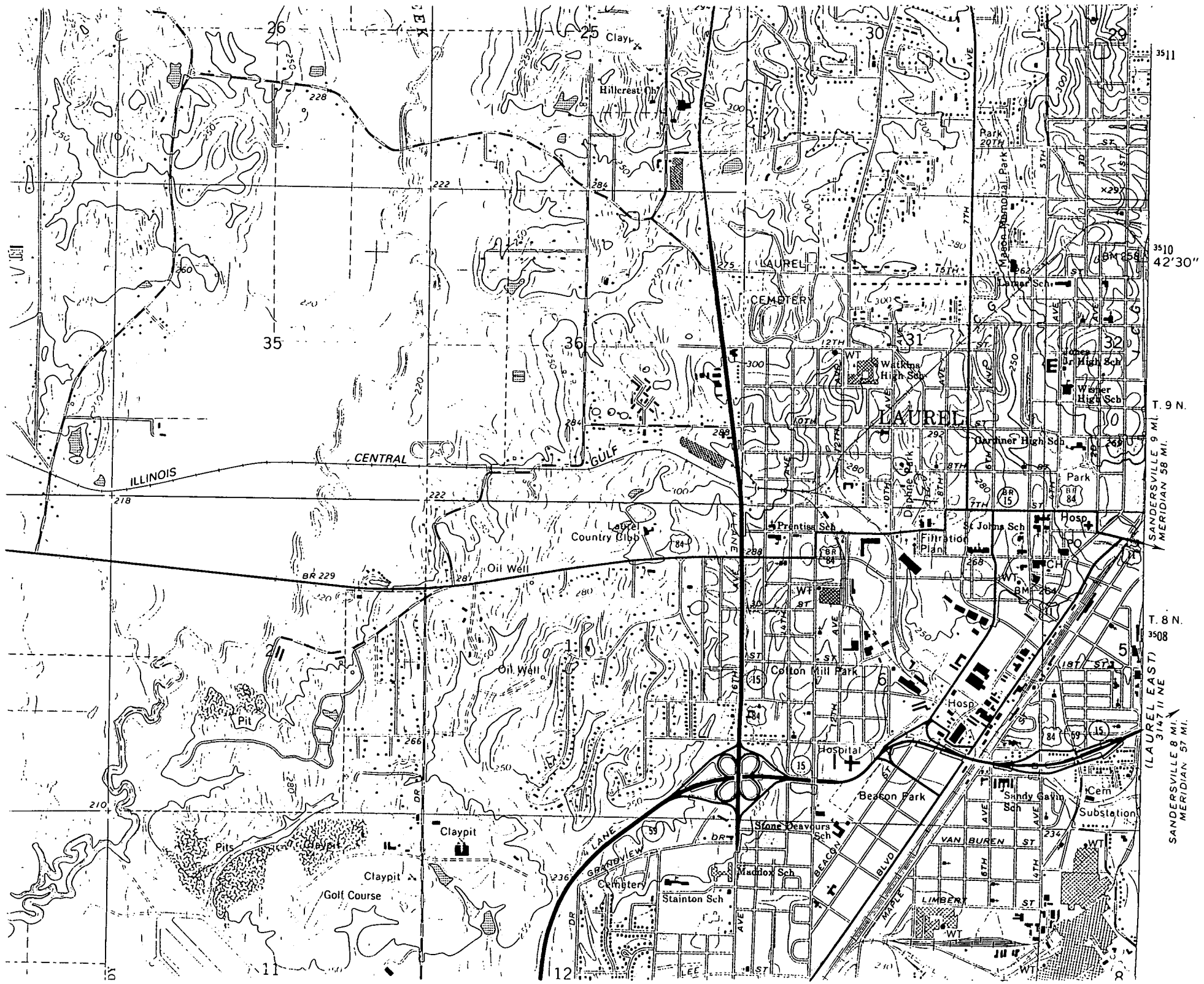

3511
3510 42'30"
T. 9 N.
SANDERSVILLE 9 MI.
MERIDIAN 58 MI.
T. 8 N.
3508
(LAUREL EAST)
3147 11 NE
SANDERSVILLE 8 MI.
MERIDIAN 57 MI.

034