

WRD Exp. (GW)
April 1966

UNCLASSIFIED AND UNREVIEWED
NATIONAL INFORMATION BUREAU

Well No. AS

WELL SCHEDULE

U. S. DEPT. OF THE INTERIOR

GEOLOGICAL SURVEY

WATER RESOURCES DIVISION

MASTER CARD

Record by Jac Source of data _____ Date _____ Map _____

State 28 County (or town) 18

Latitude: 312108N Longitude: 0892254 Sequential number: 1

Lat-long accuracy: 2 T. 50 S, R 14 E Sec 35, NW $\frac{1}{4}$, NW $\frac{1}{4}$, SW $\frac{1}{4}$

Local well number: 4005BLC3505N14W Other number: _____

Local use: _____ Owner or name: Hatterburg Country Club

Owner or name: HATTIESBURG CC Address: _____

Ownership: County, Fed Gov't, City, Corp or Co, Private State Agency, Water Dist _____

Use of water: (A) Air cond, (B) Bottling, (C) Comm, (D) Dewater, (E) Power, (F) Fire, (G) Dom, (H) Irr, (I) Med, (J) Ind, (K) P S, (L) Rec, (M) Stock, (N) Instit, (O) Unused, (P) Reppure, (Q) Recharge, (R) Desal-P S, (S) Desal-other, (T) Other _____

Use of well: (A) Anode, (B) Drain, (C) Seismic, (D) Heat Res, (E) Obs, (F) Oil-gas, (G) Recharge, (H) Test, (I) Unused, (J) Withdraw, (K) Waste, (L) Destroyed _____

DATA AVAILABLE: Well data Freq. W/L meas.: Field aquifer char.

Hyd. lab. data: _____

Qual. water data; type: USGS Partial 9-3-64

Freq. sampling: Pumpage inventory: no, period: _____

Aperture cards: _____

Log data: _____

WELL-DESCRIPTION CARD

SAME AS ON MASTER CARD Depth well: 174 Meas. rept. accuracy _____

Depth cased: 154 Casing type: Steel; Diam. 4 in _____

Finish: porous concrete, gravel w. concrete, (perf.), (screen), (gal), (end), (rot), (jetted), (air rot), (percussion), (rotary), (screen), (sd. pt.), (shored), (open hole), other _____

Method: (A) air bcred, (B) cable, (C) dug, (D) hyd rot, (E) jetted, (F) air rot, (G) reverse, (H) trenching, (I) driven, (J) drive wash, other _____

Date Drilled: 6/60 960 Pump intake setting: _____

Driller: RE Lewis, Hatterburg Ohio

Lift (type): (A) air, (B) bucket, (C) cent, (D) jet, (E) multiple, (F) multiple, (G) none, (H) piston, (I) rot, (J) sumps, (K) turb, (L) other _____

Power (type): diesel, elec, gas, gasoline, hand, gas, wind; H.P. 7 1/2 Trans. or meter no. _____

Descrip. MP _____ ft above _____ ft below LSD, Alt. MP _____

Alt. LSD: 255 Accuracy: (source) _____

Water Level _____ ft above _____ ft below MP; Ft below LSD _____ Accuracy: _____

Date meas: 8-5-64 Yield: 864 gpm _____ Method determined _____

Drawdown: _____ ft Accuracy: _____ Pumping period _____ hrs _____

QUALITY OF WATER DATA: Iron _____ Sulfate _____ Chloride _____ Hard. _____

Sp. Conduct 105 K x 10⁶ _____ Temp. _____ °F _____ Date sampled _____

Taste, color, etc. pk. 6.2

Well No.

AS

Well No. A5

Latitude-longitude _____
d m s d m s

HYDROGEOLOGIC CARD

SAME AS ON MASTER CARD Physiographic Province: 03 Section: _____

Drainage Basin: D 13N Subbasin: _____

Topo of well site: (D) depression, stream channel, dunes, flat, hilltop, sink, swamp, (S) hillside, terrace, undulating, valley flat _____

MAJOR AQUIFER: Tertiary system, Miocene series, 7M aquifer, formation, group, H.A.

Lithology: S Origin: S Aquifer Thickness: _____ ft

Length of well open to: _____ ft, Depth to top of: _____ ft

MINOR AQUIFER: _____ system, _____ series, _____ aquifer, formation, group

Lithology: _____ Origin: _____ Aquifer Thickness: _____ ft

Length of well open to: _____ ft, Depth to top of: _____ ft

Intervals Screened: 154-174 20' of bronze screen

Depth to consolidated rock: _____ ft, Source of data: _____

Depth to basement: _____ ft, Source of data: _____

Surficial material: _____ Infiltration characteristics: _____

Coefficient Trans: _____ gpd/ft, Coefficient Storage: _____

Coefficient Perm: _____ gpd/ft²; Spec cap: _____ gpm/ft; Number of geologic cards: _____

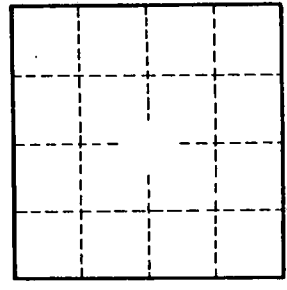
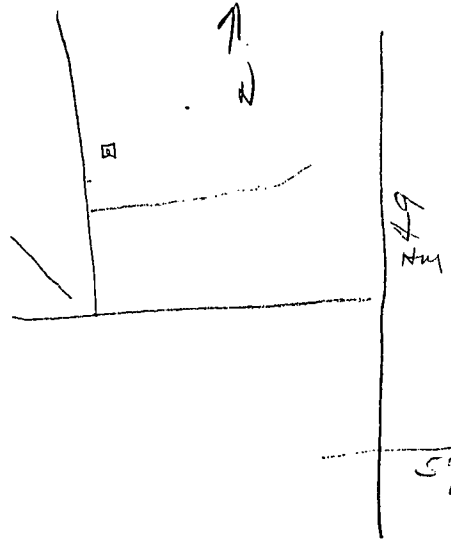

Well No. _____

A5