

Received
11/18/76
JAE

FORM 9-1642
(1-68)

Well No. J85

WELL SCHEDULE

U. S. DEPT. OF THE INTERIOR

GEOLOGICAL SURVEY

WATER RESOURCES DIVISION

MASTER CARD

Record by CJ Source of data MBWC Date 7-9-74 Map Banks **PUNCHED**

State 28 County (or town) De Soto 77

Latitude: 34^{deg} 50^{min} 05^{sec} N Longitude: 090^{deg} 01^{min} 37^{sec} W Sequential number: 1

Loc-long accuracy: 5⁷⁰ T 4⁸⁰ N 10⁹⁰ R 18¹⁰⁰ E Sec 18 SE SW NE

Local well number: 085AA1804510W Other well number: B & M

Local use: 009 Owner or name: TRINITY WATER CO. Walker Development

Owner or name: TRINITY WATER Address: 3120 S. Perkins - Mpls.

Ownership: County, Fed Gov't, City, Corp or Co, Private, State Agency, Water Dist W

Use of water: (A) Air cond, Bottling, Comm, Dewater, Power, Fire, Dom, Irr, Med, Ind, P S, Rec, (B) Stock, Instit, Unused, Repressure, Recharge, Desal-P S, Desal-other, Other STANDBY

Use of well: (A) Anode, Drain, Seismic, Heat Res, Obs, Oil gas, Recharge, Test, Unused, Withdraw, Waste, Destroyed. W

DATA AVAILABLE: Well data Freq. W/L meas: Field aquifer char.

Hyd. lab. data: SB

Qual. water data; type: SPRT

Freq. sampling: Pumpage inventory: no, period: SPRT yes

Aperture cards: SPRT yes

Log data: D

WELL-DESCRIPTION CARD

SAME AS ON MASTER CARD Depth well: 379 Meas. rept accuracy 3

Depth cased: (first perf.) 337 Casing type: Steel Diam. 8

Finish: (C) porous concrete, (F) gravel w. (perf.), (G) gravel w. (screen), (H) horiz. gallery, (I) open end, (J) other, (K) perf., (L) screen, (M) sd. pt., (N) shored, (O) open hole, (P) other

Method Drilled: (A) air rot, (B) bored, (C) cable, (D) dug, (E) hyd rot., (F) jetted, (G) air rot., (H) reverse percuss, (I) rotary, (J) driven, (K) drive wash, (L) other

Date Drilled: 6/74 9/74 Pump intake setting: 302 ft

Driller: Carless Well Supply

Lift (type): (A) air, (B) bucket, (C) cent, (D) jet, (E) multiple, (F) multiple, (G) none, (H) piston, (I) rot, (J) submerg, (K) turb, (L) other

Power (type): (A) diesel, (B) elec, (C) gas, (D) gasoline, (E) hand, (F) gas, (G) wind, (H) H.P., (I) LP, (J) Trans. or meter no.

Descrip. MP 302 ft above LSD, Alt. MP

Alt. LSD: 260 Accuracy: (source)

Water Level: 102 ft above MP; 102 ft below LSD Accuracy: D

Date meas: 674 Yield: 300 gpm Method determined

Drawdown: 302 ft Accuracy: 300 gpm Pumping period: 300 hrs

QUALITY OF WATER DATA: Iron 69 ppm Sulfate 70 ppm Chloride 71 ppm Hard. 72 ppm

Sp. Conduct 73 K x 10 Temp. 74 °F Date sampled 77 79

Taste, color, etc.

Well No. _____

Latitude-longitude _____
N
S
d m s d m s

HYDROGEOLOGIC CARD

SAME AS ON MASTER CARD Physiographic Province: 03 Section: _____

Drainage Basin: D Subbasin: 15E

Topo of well site: (D) depression, stream channel, dunes, flat, hilltop, sink, swamp, (E) (F) (H) (K) (L) (M) (P) (S) (T) (U) (V) offshore, pediment, hillside, terrace, undulating, valley flat _____

MAJOR AQUIFER: system _____ series TE aquifer, formation, group SS

Lithology: _____ Origin: 2 Aquifer Thickness: _____ ft
Length of well open to: _____ ft Depth to top of: _____ ft 289

MINOR AQUIFER: system _____ series _____ aquifer, formation, group _____

Lithology: _____ Origin: _____ Aquifer Thickness: _____ ft
Length of well open to: _____ ft Depth to top of: _____ ft

Intervals Screened: 337-379

Depth to consolidated rock: _____ ft Source of data: _____

Depth to basement: _____ ft Source of data: _____

Surficial material: _____ Infiltration characteristics: _____

Coefficient Trans: _____ gpd/ft Coefficient Storage: _____

Coefficient Perm: _____ gpd/ft²; Spec cap: _____ gpm/ft; Number of geologic cards: _____

See well J14 for location

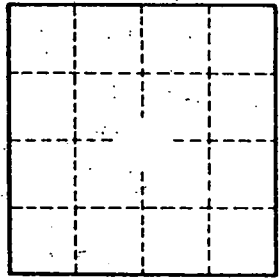

Well No. _____

**APPLICATION FOR PERMIT TO DIVERT OR WITHDRAW
FOR BENEFICIAL USE THE PUBLIC WATERS OF THE STATE OF MISSISSIPPI**

**DEPARTMENT OF ENVIRONMENTAL QUALITY, OFFICE OF LAND AND WATER RESOURCES
P.O. BOX 10631, JACKSON, MS 39289-0631; (601) 961-5202**

This box is for office use only.

FORM OLWR-AP-2 (REV. 9/94)

Issued: <u>4-8-97</u>	Expires: <u>4-8-2007</u>	Fee Paid: <u>X</u>	Permit No.
Lat. <u>34-49-38</u>	Long. <u>90-11-12</u>	Elev. <u>285</u>	USGS No. <u>J85</u>
Quad. <u>Banks</u>	ASCS Farm No.	STAC. <u>06</u>	MSDOH No. <u>170028-02</u>
Aquifer: <u>SPRT</u>	Tract No.		Basin No.
Remarks:			Dam Inv. No.

THIS APPLICATION IS FOR (Circle one): **NEW PERMIT** RENEWAL - PERMIT NO. NGW19100085
 THIS APPLICATION IS FOR (Circle one): **GROUNDWATER** COMPLETE A B E 600-15164

BENEFICIAL USE (Circle one or more): **1** Public Supply - Municipal, Rural Water, or **Private Water** 2) Irrigation
 3) Industrial 4) Fish Culture 5) Recreation 6) Institutional (eg. Church, School) 7) Commercial (eg. Hotel, Casino, Restaurant) 8) Fire Protection 9) Livestock 10) Flood Protection 11) Other: Dept. of Environmental Quality
 Office of Land & Water Resources

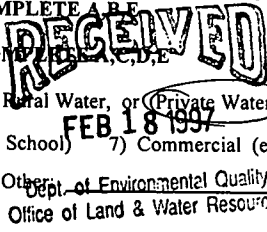

SECTION A (to be completed by ALL APPLICANTS)

LANDOWNER: NORTH MISSISSIPPI UTILITY COMPANY 64-0676172
 (Name) (SSN or Tax ID No.)
P O BOX 362, 1481 BYHALIA RD
 (Address)
HERNANDO MS 38632 (601) 429-9509
 (City) (State & Zip) (Telephone No.)

APPLICANT, AGENT, OR LESSEE (if different from Landowner):

(Name) _____ (SSN or Tax ID No.) _____
 (Address) _____
 (City) _____ (State & Zip) _____ (Telephone) _____

Location of diversion/withdrawal point (A suitable map with location marked must accompany this application):

NE SE 1/4 of the NE 1/4 of Section 18, Township 3S, Range 9W, County DESOTO

Does the land to which this application pertains have any source(s) of water other than that for which you are now applying (circle one)? YES **NO** If yes, describe the nature and amount of any additional supply and, if applicable, list permit number. _____

SECTION B (to be completed for GROUNDWATER SOURCE)

- AQUIFER: SPARTA MISSISSIPPI DEPARTMENT OF HEALTH NO.: 170028-02
- Proposed work will begin on _____, 19____, and will be completed by _____, 19____
 If well has already been drilled, when was well completed (date)? JUNE, 19 74. Under whose name was well originally drilled (if known)? _____
- Description of proposed or completed well:
 - DEPTH OF WELL: 260 feet. DRILLER: CARLOSS WELL SUPPLY
 - SURFACE CASING: Length 316 feet; Diameter 8 inches; Type STEEL
 - SCREEN: Length 20 feet; Diameter 6 inches; Type STAINLESS
 - PUMP: Type _____; Size 15 HP; Capacity 300 gallons per minute; Setting depth _____ feet
 - POWER UNIT: Type _____; Size _____ horsepower
- PERMITTED VOLUME:
 - _____ million gallons per year at a maximum rate of _____ gallons per minute
 - 0.068 million gallons per day at a maximum rate of 300 gallons per minute

(CONTINUED ON BACK)

SECTION C (to be completed for SURFACE WATER SOURCE)

1. Source of water is from _____ which drains into _____
which drains into _____
(major stream or river)
2. Description of pump/diversion works:
Pump (size & type): _____ Power Unit (size & type): _____
Lift: _____ feet Maximum capacity: _____ gallons per minute
3. _____ acre-feet per year at a maximum rate of _____ gallons per minute

SECTION D (to be completed for SURFACE WATER IMPOUNDMENTS {DAMS} on continuously flowing streams)

1. Name of storage reservoir: _____ Dam Height: _____ feet
2. Surface area at normal pool: _____ Storage capacity at normal pool: _____ acre-feet

SECTION E WATER USE DATA (ALL APPLICATIONS - complete section related to beneficial use)

1. **IRRIGATION:** List the number of acres of each crop to be irrigated: Rice _____; Cotton _____; Oats _____;
Corn _____; Soybeans _____; Pasture _____; Truck _____; Wheat _____; Grain Sorgum _____;
Other (specify) _____ Acres _____

A. Method of Irrigation (circle one) - Center Pivot Flood Furrow

B. Land Condition (circle one): Precision Land Formed Smoothed

C. ASCS Farm No. _____ Tract No. _____

2. **FISH CULTURE:** Explain how water will be used: _____
How often will reservoir (s) be emptied and refilled? _____

3. **MUNICIPAL, WATER ASSOCIATION, or PRIVATE WATER SYSTEM**

Chose "a" or "b". (a) The number of people served is 843 or (b) The number of connections is _____
What is the estimated average daily consumption during periods of maximum use at the end of each five-year period during the next twenty (20) years?

<u>70,000</u>	<u>2000</u>	<u>75,000</u>	<u>2005</u>	<u>78,000</u>	<u>2010</u>	<u>81,000</u>	<u>2015</u>
(Volume)	(Year)	(Volume)	(Year)	(Volume)	(Year)	(Volume)	(Year)

4. **INDUSTRIAL:** If the water is to be released into a watercourse, indicate the amount released each year _____;

Rate of release _____; NPDES Permit No. _____

Explain any changes in quality of water to be released: _____

Explain how water will be used: _____

How much groundwater will be used for once-through non-contact cooling? _____

5. **RECREATION:** Explain how water will be used: _____

6. **OTHER USE:** Explain in detail (if needed, attach another page): _____

7. **REMARKS:** THIS IS A STANDBY WELL

List below the person to be contacted for additional information if required.

BILL J ROBERSON
(Name)

P O BOX 362
(Address)

HERNANDO, MS 38632
(City, State, Zip)

601-429-9509
(Telephone)

The accompanying map is hereby declared a part of this application.
For irrigation and fish culture use, an ASCS photograph is required.
The TEN DOLLAR (\$10.00) permit fee is enclosed herewith.

Bill J. Roberson
(Signature)

Subscribed and sworn to before me this 13th day of Feb, 1997, at Hernando County of Mississippi

My commission expires March 23, 1998; Rhonda K. Allen Notary Public.

DEPARTMENT OF ENVIRONMENTAL QUALITY - OLWR
PUBLIC SUPPLY WELLS PROJECT

SHR + PEG GPS LOG

USER NAME(S): LIAN / DMS DATE: 8-21/96
7/26/94
UNIT DEQ #: 84090 FILE #: B072623C
HEALTH DEPT. #: 170028-02 ELEV. 245 ^{A082120A} _{same as .01}
USGS #: 512 J85 OLWR #: MS-GW-15764
OWNER: N. MS. UTL. / Chickasaw Bluff
LOCATION: SE1/4 NE S 18 T 35 R 9W COUNTY: De Soto
BANKS
LOCATION DESCRIPTION: Well in forest area between
pumphouse + airtor
CASING DIA: 16" PUMP TYPE & SIZE: Sub.
GPS FIELD LOCATION: LAT. 34-49-718 N LONG. 90-11-233 W
34° 49' .708° 90° 11' .205
GPS CORRECTED LOCATION: LAT. 34.82832401 LONG. 90.18725110
REMARKS: Take hd off Hwy 304 at

f

14000W

13500W

13000W

SEE PAGE 50

12500W

12000W

R 9 W

11500W

11000W

T 3 S

A

RECEIVED

FEB 18 1997

Dept of Environmental Quality
Office of Land & Water Resources

B

TUNICA COUNTY
DESOTO COUNTY

THIS AREA NOT MAPPED

D

E

- E. SECOND OAK CV.
- F. FIRST OAK CV.
- G. SECOND HICKORY NUT CV.
- H. FIRST HICKORY NUT CV.

SEE PAGE 70

Handwritten note: 4/26/97

304

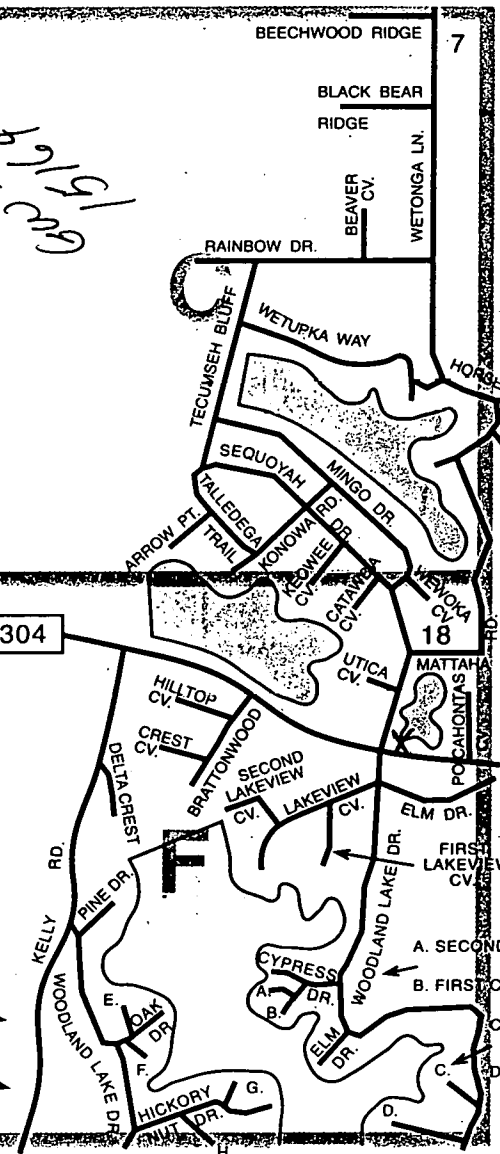

1000S

1500S

2000S

2500S

3000S

SEE PAGE 61

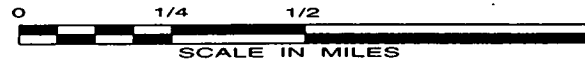

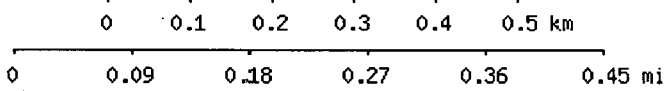
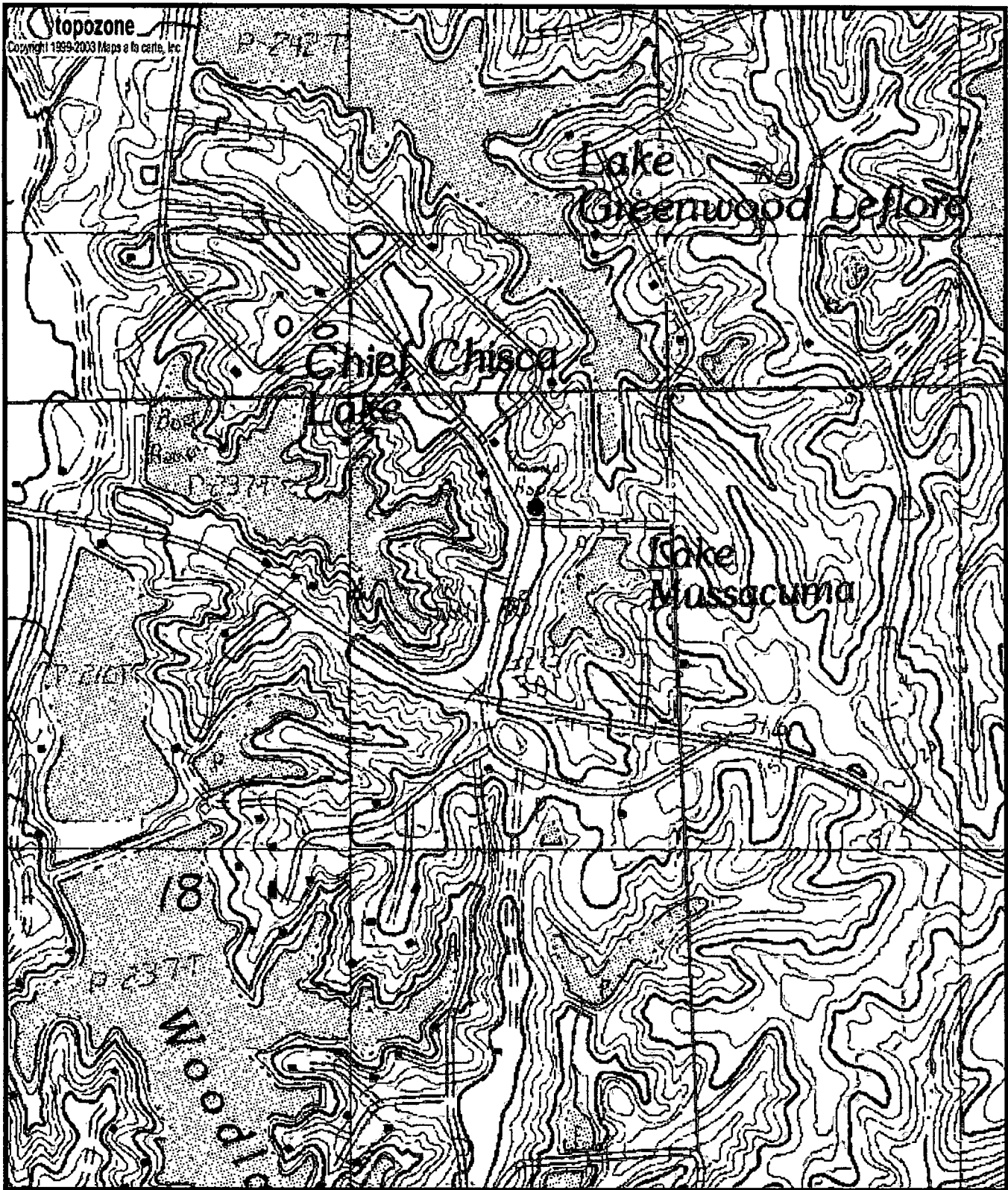

Map center is 34° 49' 42"N, 90° 11' 14"W (WGS84/NAD83)
Banks quadrangle
 Projection is UTM Zone 15 NAD83 Datum

M=0.139
 G=1.608