

WELL SCHEDULE
OFFICE OF LAND AND WATER RESOURCES

Fips 33

Well No. E 13

Log No. _____

Recorded by: pp Data Source: Charlotte Bryant Date: 6/3/97

County: De Soto Permit No.: _____ DOH No.: _____

^{SE}
1/4: NE 1/4: NW 1/4: SW Sec.: 34 TWN: 2S RNG: 10W

Quad: Robinsonville Elevation: 200

Plotted on quad?: In field? From drillers log? _____ From permit? _____

Latitude: _____ Longitude: _____ GPS? _____ From quad? _____

Primary Aquifer: MRVA Secondary Aquifer: _____

Use: Irrigation Well status: _____

Owner: Dr. Whitehurst (?)

Address: _____

Telephone: _____ Local Well Name: _____

Date drilled: 1954 Driller: _____

Well depth: 117 Well diameter: _____ Pump type: _____

Power type: _____ Pump capacity: _____

Screen interval(msl): _____ (land surface): _____

Type of logs: _____ Log interval: _____

Initial water level(lsl): _____ Date: _____

Measuring point description: _____

Water Quality Data? _____ Source: _____ Reliability: _____

Water Level Data? _____ Source: _____ Reliability: _____

Pump Test Data? _____ Source: _____ Reliability: _____

Water Use Data? _____ Source: _____ Reliability: _____

Water level data

This area for location map and notes

22
1.75

18.00
5.41

12.59

6.00
 4-29-65
 W 6.00
 MP TOP 10"

45' Clay

Discharge
 6.0' Above
 Surface

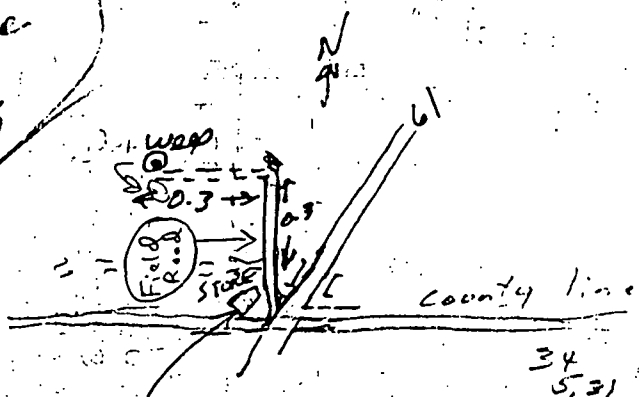

30
6.1
 23.9
 6.0
17.9

11-3-65

34
5.31
 28.69
 MP 10.0
18.69
 9/18/80

200
18.69
 181.31

9-14-81
 40-11.80-9.0=19.20

JKA

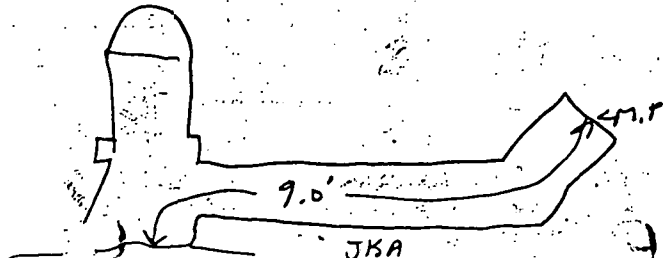

30-3.78-9.0=17.22

4-13-81
 JKA

E13:

What is casing
diameter?

Cannot get diam
of casing because well
head goes to ground.

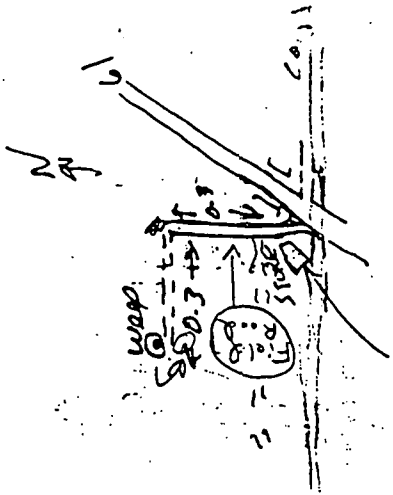

STORE
TORN DOWN

9-14-81
40-11.80-9.0=19.20
JKA

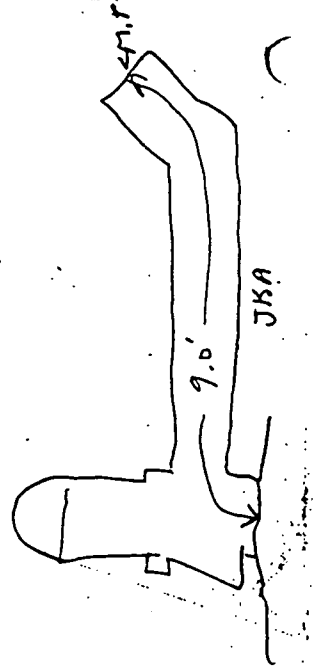

Robinsonville Quad

SE/4 HORSESHOE LAKE 15' QUADRANGLE

747

17°30"

748

R 10 W 749

520 000 FEET (MISS.)

LAKE CORMORANT 3.5 MI.

751

90°15'

34°52'30"

1 590 000 FEET (MISS.)

