

Well No. B 10

Latitude-longitude _____
d m s d m s

HYDROGEOLOGIC CARD

SAME AS ON MASTER CARD Physiographic Province: 03 Section: _____

D Drainage Basin: 16R Subbasin: _____

Topo of well site: (D) depression, stream channel, dunes, flat, hilltop, sink, swamp, (E) (F) (H) (K) (L) (P) (S) (T) (U) (V) offshore, pediment, hillside, terrace, undulating, valley flat _____

MAJOR AQUIFER: system _____ series TE aquifer, formation, group SS

Lithology: US Origin: 2 Aquifer Thickness: _____ ft
Length of well open to: _____ ft Depth to top of: _____ ft

MINOR AQUIFER: system _____ series _____ aquifer, formation, group _____

Lithology: _____ Origin: _____ Aquifer Thickness: _____ ft
Length of well open to: _____ ft Depth to top of: _____ ft

Intervals Screened: 6" SS

Depth to consolidated rock: _____ ft Source of data: _____

Depth to basement: _____ ft Source of data: _____

Surficial material: _____ Infiltration characteristics: _____

Coefficient Trans: _____ gpd/ft Coefficient Storage: _____

Coefficient Perm: _____ gpd/ft²; Spec cap: _____ gpm/ft; Number of geologic cards: _____

REPRODUCED FOR YOUR INFORMATION

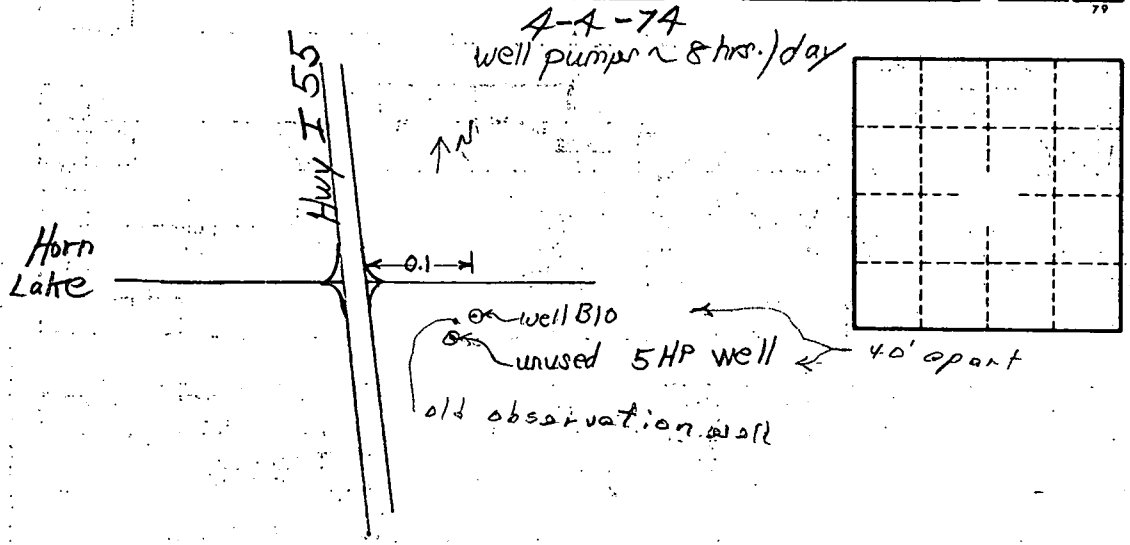

Well No.

B 10

WELL SCHEDULE

U. S. DEPT. OF THE INTERIOR

GEOLOGICAL SURVEY

WATER RESOURCES DIVISION

TRANSMITTED FOR ADP

MASTER CARD

Record by J. Shell Source of data Bowc Date 4/69 Map PLEASANT HILL 30A

State 741 28 County (or town) DeSoto 45 17

Latitude: 345800 N Longitude: 0895934 Sequential number: 1

Lat-long accuracy: 30 T. 1 S. R. 8 Sec 36 NW NE

Local well number: B010BA3601508W Other number: B & M

Local use: 058 Owner or name: J. COSCIA-OWNER

Owner or name: GAYOSO FARMS Address: Horn Lake, Miss

Ownership: County, Fed Gov't, City, Corp or Co, Private, State Agency, Water Dist P

10/31/89

142.49

121/88 RR.

B10 is destroyed

Use of water: (A) Air cond, Bottling, Comm, Dewater, Power, Fire, Dom, Irr, Med, Ind, P S, Rec, (S) Stock, Instit, Unused, Repressure, Recharge, Desal-P S, Desal-other, Other N

Use of well: (A) Anode, Drain, Seismic, Heat Res, Obs, Oil-gas, Recharge, Test, Unused, Withdraw, Waste, Destroyed, (D) W

DATA AVAILABLE: Well data Freq. W/L meas.: Field aquifer char.

Hyd. lab. data:

Qual. water data; type:

Freq. sampling: Pumpage inventory: no yes period:

Aperture cards: yes

Log data: D

WELL-DESCRIPTION CARD

SAME AS ON MASTER CARD Depth well: 313 ft Meas. rept accuracy 3

Depth cased: (first perf.) 281 ft Casing type: Steel Diam. 8 in

Finish: porous concrete, gravel w. (perf.), (screen), gravel w. (screen), horiz. gallery, open end, (P) perf., (S) screen, (T) sd. pt., (W) shored, (X) open hole, (Z) other S

Method: (A) air bored, (B) cable, (C) dug, (D) hyd jetted, (H) rot., (J) percussion, (P) reverse, (R) rotary, (T) trenching, (V) driven, (W) drive wash, (Z) other H

Date Drilled: 969 Pump intake setting: 30 ft

Driller: 335 name address 335

Lift (type): (A) air, (B) bucket, (C) cent, (J) jet, (L) multiple, (M) multiple, (N) none, (P) piston, (R) rot, (S) submerg, (T) turb, (Z) other T Deep Shallow

Power (type): diesel, elec gas, gasoline, hand, gas, wind; H.P. 30 Trans. or meter no. 41

Descrip. MP 335 ft above below LSD, Alt. MP 335

Alt. LSD: 360 Accuracy: (source) CI 20

Water Level: 126 ft above below MP; Ft above below LSD 126 Accuracy: D

Date meas: 369 Yield: 00 gpm 475 Method determined 61

Drawdown: 369 ft Accuracy: 475 Pumping period 68 hrs

QUALITY OF WATER DATA: Iron ppm 69 Sulfate ppm 70 Chloride ppm 71 Hard. ppm 72

Sp. Conduct 73 K x 10⁶ Temp. 74 °F 76 Date sampled 77 79

Taste, color, etc. 78

335
132
203

12/3/74

140

7.37

132.63

MP

131.63

Well No.

B 10

