

29 H / Lake Cormorant - 10

WRD Ex. (GW)
April 1966

Well No. A-10

WELL SCHEDULE **PUNCHED CODED**
GEOLOGICAL SURVEY WATER RESOURCES DIVISION
APR 23 1974

U. S. DEPT. OF THE INTERIOR

MASTER CARD

Record by BEWASSON JAG Source Father Jude Date 12/7/60 Map 114-170

State MISS. County Desoto (or town) 28 1,7

Latitude: 34° 57' 10" N Longitude: 090° 09' 10" W Sequential number: 1

Lat-long accuracy: 2 T. 1 N. 9 E. Sec 33, NW SE

Local well number: A0100D3301509W Other well number: B & M

Local use: SACRED HEART SH Owner or name: Sacred Heart School Address: Walls

Ownership: County, Fed Gov't, City, Corp or Co, Private, State Agency, Water Dist P

Use of water: (A) Air cond, Bottling, Comm, Dewater, Power, Fire, Dom, Irr, Med, Ind, P S, Rec, (S) Stock, Instit, Unused, Repressure, Recharge, Desal-P S, Desal-other, Other H

Use of well: (A) Anode, Drain, Seismic, Heat Res, Obs, Oil-gas, Recharge, Test, Unused, Withdraw, Waste, Destroyed W

DATA AVAILABLE: Well data 70 Freq. W/L meas.: 71 Field aquifer char. 72

Hyd. lab. data: 73

Qual. water data; type: U.S.G.S. A-11-60 74

Freq. sampling: 75 Pumpage inventory: yes 76 no: period: 77

Aperture cards: 78 79

Log data: 78 79

WELL-DESCRIPTION CARD

SAME AS ON MASTER CARD Depth well: 36 ft Meas. 24 6

Depth cased: (first perf.) 25 ft Casing type: 28 ; Diám. 3 in 29 30

Finish: porous concrete, gravel w. (perf.), gravel w. (screen), horiz. gallery, end, open perf., screen, sd. pt., shored, open hole, other 31

Method Drilled: (A) air rot, (B) bored, (C) cable, (D) dug, (H) hyd jettied, (J) air percussion, (P) reverse, (R) trenching, (T) driven, (V) drive wash, (W) other 32

Date Drilled: 956 Pump intake setting: 33 35 ft 36 38

Driller: C.B. Perry Memphis Tenn

Lift (type): (A) air, (B) bucket, (C) cent, (J) jet, (L) multiple, (M) multiple, (N) none, (P) piston, (R) rot, (S) submerg, (T) turb, other J Deep 39 Shallow 40

Power (type): nat, diesel, elec, gas, gasoline, hand, gas, wind; LP, H.P. 2 41 Trans. or meter no. T

Descrip. MP 42 ft above LSD. Alt. MP 43 ft below LSD. Alt. MP 47

Alt. LSD: 211 Accuracy: (source) 48 51

Water Level: above MP; Ft below LSD 48 51 Accuracy: 52

Date meas: 53 55 Yield: 56 gpm 59 Method determined 61

Drawdown: 62 ft 64 Accuracy: 65 Pumping period 66 hrs 68

QUALITY OF WATER DATA: Iron 69 ppm Sulfate 70 ppm Chloride 71 ppm Hard. 72

Sp. Conduct 73 K x 10⁶ Temp. 74 °F 76 Date sampled 77 79 7.60

Taste, color, etc.

Well No. A10

Well No. A10

03000

Latitude-longitude N
S
d m s d m s

HYDROGEOLOGIC CARD

SAME AS ON MASTER CARD Physiographic Province: _____ 03 Section: _____

E Drainage Basin: _____ 15E Subbasin: _____

(D) (C) (E) (F) (H) (K) (L)
 Topo of well site: depression, stream channel, dunes, flat, hilltop, sink, swamp,
 (Ø) (P) (S) (T) (U) (V)
 offshore, pediment, hillside, terrace, undulating, valley flat _____

MAJOR AQUIFER: _____ OG MIA
 system series aquifer, formation, group

Lithology: _____ S Origin: _____ 2 Aquifer Thickness: _____ ft

Length of well open to: _____ ft Depth to top of: _____ ft

MINOR AQUIFER: _____ Aquifer Thickness: _____ ft

system series aquifer, formation, group

Lithology: _____ Origin: _____ Aquifer Thickness: _____ ft

Length of well open to: _____ ft Depth to top of: _____ ft

Intervals Screened: _____

Depth to consolidated rock: _____ ft Source of data: _____

Depth to basement: _____ ft Source of data: _____

Surficial material: _____ Infiltration characteristics: _____

Coefficient Trans: _____ gpd/ft Coefficient Storage: _____

Coefficient Perm: _____ gpd/ft ; Spec cap: _____ gpm/ft; Number of geologic cards: _____

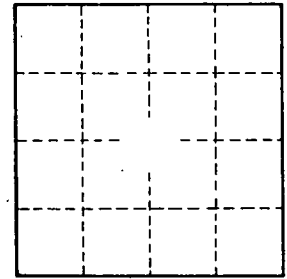
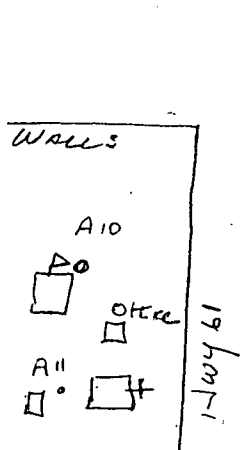

Well No.

A10