

WELL SCHEDULE
GEOLOGICAL SURVEY

E log # 63

U. S. DEPT. OF THE INTERIOR

WATER RESOURCES DIVISION

PUNCHED
MAR 18 1974

MASTER CARD

Record by WTO Source of data Bowc Date 9/73 Map 1/73

State MISS County (or town) COVINGTON

Latitude: 31° 33' 52" N Longitude: 091° 08' 24.3" W Sequential number: 1

Lat-long accuracy: 2 T 7 R 14 Sec 21 NW NE

Local well number: L0127A2107N14W Other number: W.A. TH #1 (Well #1)

Local use: 230063 Owner or name: SOUTHWEST JONES Address: _____

Ownership: County, Fed Gov't, City, Corp or Co, Private, State Agency, Water Dist N

Use of water: (A) Air cond, (B) Bottling, (C) Comm, (D) Dewater, (E) Power, (F) Fire, (G) Irr, (H) Med, (I) P S, (J) Rec, (K) Stock, (L) Instit, (M) Unused, (N) Recharge, (O) Desal-P S, (P) Desal-other, (Q) Other P

Use of well: (A) Anode, (B) Drain, (C) Seismic, (D) Heat Res, (E) Obs, (F) Oil-gas, (G) Recharge, (H) Test, (I) Unused, (J) Withdraw, (K) Waste, (L) Destroyed W

DATA AVAILABLE: Well data Freq. W/L meas.: Field aquifer char.

Hyd. lab. data: _____

Qual. water data; type: _____

Freq. sampling: _____ Pumpage inventory: no. period: _____

Aperture cards: _____ yes

Log data: F log 75'-463 838'-955' D E

WELL-DESCRIPTION CARD

SAME AS ON MASTER CARD Depth well: 6" to 740 ft 900 Meas. rept. 3

Depth cased; (first perf.): 850 ft Casing type: _____; Diam. 6x4 in

Finish: (A) porous concrete, (B) gravel w. (perf.), (C) gravel w. (screen), (D) horiz. open gallery, (E) open end, (F) perf., (G) screen, (H) sd. pt., (I) shored, (J) open hole, (K) other S

Method Drilled: (A) air rot, (B) bored, (C) cable, (D) dug, (E) hyd rot., (F) jetted, (G) air percusson, (H) rotary, (I) reverse, (J) trenching, (K) driven, (L) drive wash, (M) other H

Date Drilled: 12-14-72 Pump intake setting: _____ ft

Driller: Holland Well Co. address 3

Lift (type): (A) air, (B) bucket, (C) cent, (D) jet, (E) multiple, (F) multiple, (G) none, (H) piston, (I) rot, (J) submerg, (K) turb, (L) other T Deep Shallow

Power (type): (A) diesel, (B) elec, (C) gas, (D) gasoline, (E) hand, (F) gas, (G) wind; H.P. 30 Trans. or meter no. V

Descrip. MP _____ ft above LSD, Alt. MP _____

Alt. LSD: 433 Accuracy: 1 top 3

Water Level: _____ ft above below MP; Ft below LSD 205 Accuracy: 105

Date meas: 3-7-73 Yield: 46 gpm 220 Method determined

Drawdown: _____ ft Accuracy: _____ Pumping period _____ hrs

QUALITY OF WATER DATA: Iron _____ ppm Sulfate _____ ppm Chloride _____ ppm Hard. _____ ppm

Sp. Conduct _____ K x 10⁶ Temp. _____ °F Date sampled _____

Taste, color, etc. _____

03170004

12/1/81
could not
get tape in
well

HYDROGEOLOGIC CARD

SAME AS ON MASTER CARD Physiographic Province: 03 Section: _____

D Drainage Basin: 113N Subbasin: _____

Topo of well site: (D) depression, stream channel, dunes, flat, hilltop, sink, swamp, (E) offshore, pediment, hillside, terrace, undulating, valley flat (F) (G) (H) (I) (J) (K) (L) (M) (N) (O) (P) (Q) (R) (S) (T) (U) (V) _____

MAJOR AQUIFER: system _____ series TM aquifer, formation, group CA

Lithology: US Origin: 3 Aquifer Thickness: 50 ft

Length of well open to: _____ ft 50 Depth to top of: _____ ft 850

MINOR AQUIFER: system _____ series _____ aquifer, formation, group _____

Lithology: _____ Origin: _____ Aquifer Thickness: _____ ft

Length of well open to: _____ ft _____ Depth to top of: _____ ft _____

Intervals Screened: SS type 304 850' - 900' .008

Depth to consolidated rock: _____ ft _____ Source of data: _____

Depth to basement: _____ ft _____ Source of data: _____

Surficial material: _____ Infiltration characteristics: _____

Coefficient Trans: _____ gpd/ft _____ Coefficient Storage: _____

Coefficient Perm: _____ gpd/ft²; Spec cap: _____ gpm/ft; Number of geologic cards: _____

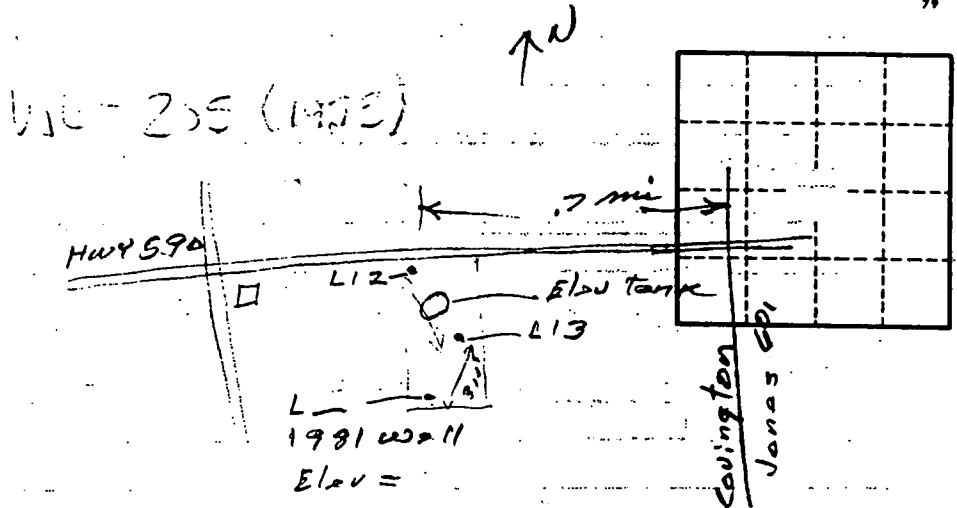

840' of 4"
820' to top of log

Water level 205' (1973) 185 gpm @ 46' measured 9/1/80
 water level 207' (?) (1980) (bad measurement)?
 water level 353.10 12/29/81 (pump off 4 hrs.)