

WELL SCHEDULE
GEOLOGICAL SURVEY

U. S. DEPT. OF THE INTERIOR

WATER RESOURCES DIVISION

PUNCHED AND VERIFIED
ROLLA COMPIGATION BRANCH

MASTER CARD

Record by B E W Source of data owner & driller Date 5-21-71 Map _____

State Miss County (or town) Copiah 15

Latitude: 34° 51' N Longitude: 090° 17' 22" W Sequential number: 1

Lat-long accuracy: 2 T, 9 S, R, 9 E, Sec 15, SW $\frac{1}{4}$, NE $\frac{1}{4}$, SW $\frac{1}{4}$ B & M

Local well number: W01TAC1509N09E Other number: _____

Local use: 222142 Owner or name: GC Harrington

Owner or name: G C HARRINGTON Address: Wasson Rt 3 Lot 36

Ownership: County, Fed Gov't, City, Corp or Co, Private, State Agency, Water Dist P

Use of Air cond, Bottling, Comm, Dewater, Power, Fire, Dom, Irr, Med, Ind, P S, Rec, water: (S) (T) (U) (V) (W) (X) (Y) (Z) H

Use of well: (A) (D) (G) (H) (I) (J) (K) (L) (M) (N) (O) (P) (R) (T) (U) (V) (W) (X) (Z) W

DATA AVAILABLE: Well data Freq. W/L meas.: Field aquifer char.

Hyd. lab. data: _____

Qual. water data; type: _____

Freq. sampling: _____ Pumpage inventory: yes no; period: _____

Aperture cards: _____

Log data: Elog D E

WELL-DESCRIPTION CARD

SAME AS ON MASTER CARD Depth well: 392 T.D. ft Meas. 380 accuracy 1

Depth cased; (first perf.) _____ ft Casing type: PVC; Diam. 2 in

Finish: (C) porous concrete, (F) grave w. (per.), (G) gravel w. (screen), (H) horiz. gallery, (I) open end, (J) perf., (K) screen, (L) sd. pt., (M) shored, (N) open hole, (O) other S

Method Drilled: (A) air rot, (B) bored, (C) cable, (D) dug, (E) hyd rot, (F) jetted, (G) air percussion, (H) rotary, (I) reverse, (J) trenching, (K) driven, (L) drive wash, (M) other H

Date Drilled: 5-21-71 571 Pump intake setting: _____ ft 200

Driller: Kenneth Thompson address _____

Lift (type): (A) air bucket, (B) bucket, (C) jet, (D) multiple, (E) multiple, (F) none, (G) piston, (H) rot, (I) submerg, (J) turb, (K) other A Deep Shallow

Power (type): diesel, elec, gas, gasoline, hand, gas, wind; H.P. 3 Trans. or meter no. T

Descrip. MP _____ ft above _____ ft below LSD, Alt. MP _____

Alt. LSD: 310 Accuracy: (source) 10' 4

Water Level: _____ ft above _____ ft below MP; Ft below LSD 25 Accuracy: _____ D

Date meas: 571 Yield: _____ gpm 40 Method determined _____

Drawdown: _____ ft Accuracy: _____ Pumping period _____ hrs _____

QUALITY OF WATER DATA: Iron _____ ppm Sulfate _____ ppm Chloride _____ ppm Hard. _____ ppm

Sp. Conduct _____ K x 10⁶ Temp. _____ °F Date sampled _____

Taste, color, etc. _____

Latitude-longitude

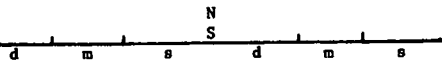

HYDROGEOLOGIC CARD

SAME AS ON MASTER CARD

Physiographic Province: _____

03 Section: _____

D Drainage Basin: _____

13V Subbasin: _____

Topo of well site: (D) depression, stream channel, dunes, flat, hilltop, sink, swamp, (P) offshore, pediment, hillside, terrace, undulating, valley flat

MAJOR AQUIFER: _____

Tm system _____

MZ aquifer, formation, group _____

Lithology: Sand

S Origin: _____

3 Aquifer Thickness: 60+ ft

60 Length of well open to: _____

15' ft _____

15 Depth to top of: _____

316 ft 316

MINOR AQUIFER: _____

Lithology: _____

Length of well open to: _____

ft _____

Depth to top of: _____

ft _____

Intervals Screened: .008 Ale

Depth to consolidated rock: _____ ft

60-63

Source of data: _____

Depth to basement: _____ ft

65-68

Source of data: _____

Surficial material: _____

70-71

Infiltration characteristics: _____

Coefficient Trans: _____

gpd/ft

73-75

Coefficient Storage: _____

76-78

Coefficient Perm: _____

gpd/ft²; Spec cap: _____

gpm/ft; Number of geologic cards: _____

79

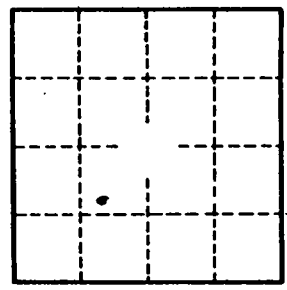
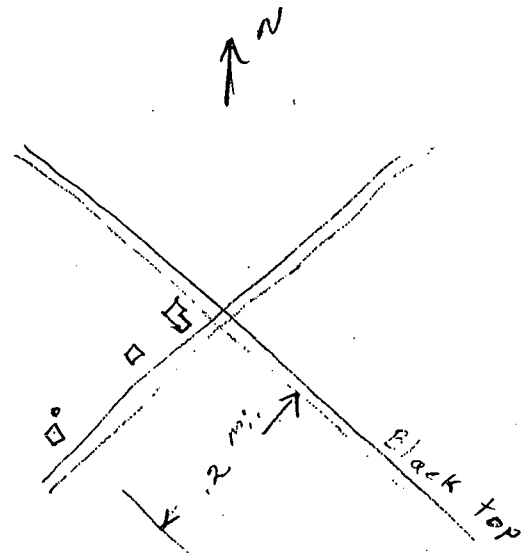

Well No. _____