

310

Well No. V12

WELL SCHEDULE

Elog #137

U. S. DEPT. OF THE INTERIOR

GEOLOGICAL SURVEY

WATER RESOURCES DIVISION

MASTER CARD

Record by WTO Source of data Obs driller Date 1/27/71 Map _____

State 28 County Copiah 15

Latitude: 31.4348 N Longitude: 0902503 Sequential number: 1

Lat-long accuracy: 20 T 9 S, R 8 W, Sec 20, SW 4, SE 4, SE 4

Local well number: Y012DD2009N08E Other number: _____

Local use: 222137 Owner or name: Troy Smith

Owner or name: TROY SMITH Address: Wesson Rt#4

Overship: County, Fed Gov't, City, Corp or Co, Private, State Agency, Water Dist P

Use of water: (A) Air cond, Bottling, Comm, Dewater, Power, Fire, Dom, Irr, Med, Ind, P S, Rec, (S) Stock, Instis, Unused, Repressure, Recharge, Desal-P S, Desal-other, Other N

Use of well: (A) Anode, Drain, Seismic, Heat Res, Obs, Oil-gas, Recharge, Test, Unused, Withdraw, Waste, Destroyed. W

DATA AVAILABLE: Well data Freq. W/L meas.: Field aquifer char.

Hyd. lab. data: _____

Qual. water data; type: _____

Freq. sampling: _____ Pumpage inventory: yes, no: _____

Aperture cards: _____

Log data: E log

WELL-DESCRIPTION CARD

SAME AS ON MASTER CARD Depth well: 507 ft Meas. 500 accuracy 3

Depth cased: (first perf.) _____ ft Casing type: PCV; Diam. _____ in 2

Finish: (C) porous concrete, (F) gravel w. 'perf.', (G) gravel w. (screen), (H) horiz. gallery, (O) open end, (P) perf., (S) screen, (T) sd. pt., (W) shored, (X) open hole, (Z) other S

Method: (A) air bored, (B) cable, (C) dug, (D) hyd rot., (H) jetted, (J) air percuss, (P) reverse, (R) trenching, (T) driven, (V) drive wash, (W) other H

Date Drilled: 970 Pump intake setting: _____ ft _____

Driller: KE Thompson address Mendenhall

Lift (type): (A) air, (B) bucket, (C) cent, (J) jet, (L) multiple, (M) multiple, (N) none, (P) piston, (R) rot, (S) submerg, (T) turb, (U) other A Deep Shallow

Power (type): nat, LP, diesel, elec, gas, gasoline, hand, gas, wind; H.P. _____ Trans. or meter no. _____

Descrip. MP _____ ft above _____ below LSD, Alt. MP _____

Alt. LSD: 470 Accuracy: T 4

Water Level: _____ ft above _____ below MP; _____ ft above _____ below LSD Accuracy: _____

Date meas: 2/7/71 Yield: _____ gpm 20 Method determined

Drawdown: _____ ft Accuracy: _____ Pumping period: _____ hrs _____

QUALITY OF WATER DATA: Iron _____ ppm Sulfate _____ ppm Chloride _____ ppm Hard. _____ ppm

Sp. Conduct _____ K x 10⁶ Temp. _____ °F Date sampled _____

Taste, color, etc. _____

Well No.

Latitude-longitude N
S
d m s d m s

HYDROGEOLOGIC CARD

SAME AS ON MASTER CARD

Physiographic Province: _____

03 Section: _____

D Drainage Basin: _____

15L Subbasin: _____

Topo of well site: (D) depression, stream channel, dunes, flat, hilltop, sink, swamp, (C) offshore, pediment, hillside, terrace, undulating, valley flat (E) (F) (H) (K) (L) (P) (S) (T) (U) (V) _____ 27 S

MAJOR AQUIFER:

system _____

series _____

TM

aquifer, formation, group _____

MZ

Lithology: _____

US Origin: _____

3 Aquifer Thickness: _____ ft

Length of well open to: _____ ft _____ 38 39 15 Depth to top of: _____ ft _____ 41 42

MINOR AQUIFER:

system _____

series _____

aquifer, formation, group _____

Aquifer Thickness: _____ ft

Lithology: _____

Origin: _____

Length of well open to: _____ ft _____ 34 35 36 Depth to top of: _____ ft _____ 37 38

Intervals Screened:

Depth to consolidated rock: _____ ft _____ 40 41 42 Source of data: _____ 44

Depth to basement: _____ ft _____ 43 44 45 Source of data: _____ 49

Surficial material: _____ Infiltration characteristics: _____ 70 71 72

Coefficient Trans: _____ gpd/ft _____ 73 74 75 Coefficient Storage: _____ 76 77

Coefficient Perm: _____ gpd/ft²; Spec cap: _____ gpm/ft; Number of geologic cards: _____ 79

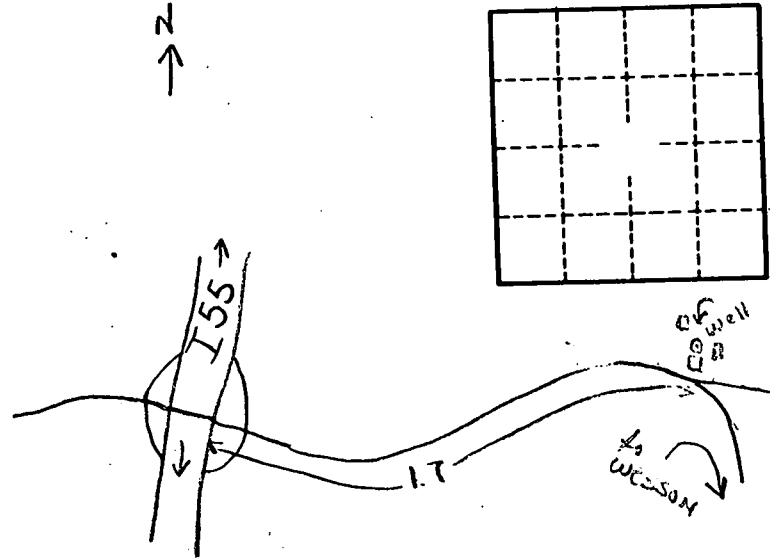

Well No. _____