

WRD Exp. (GW)
April 1966

Well No. R8

WELL SCHEDULE

U. S. DEPT. OF THE INTERIOR GEOLOGICAL SURVEY WATER RESOURCES DIVISION

MASTER CARD

Record by TS Source of data Maxwell Town Clerk Date 9/57 Map _____

State 28 County (or town) Copiah 15

Latitude: 31° 15' 20.00" N Longitude: 090° 09' 55" W Sequential number: 1

Lat-long accuracy: 3 T. 10 S, R 10 E, Sec 2, _____, _____, _____

Local well number: K008 0210 N10E Other number: _____

Local use: _____ Owner or name: _____ Address: _____

Ownership: County, Fed Gov't, City, Corp or Co, Private, State Agency, Water Dist M

Use of water: (A) Air cond, (B) Bottling, (C) Comm, (D) Dewater, (E) Power, (F) Fire, (H) Dom, (I) Irr, (M) Med, (N) Ind, (P) S, (R) Rec, (S) Stock, (T) Instit, (U) Unused, (V) Repr, (W) Recharge, (X) Desal-P S, (Y) Desal-other, (Z) Other U

Use of well: (A) Anode, (D) Drain, (G) Seismic, (H) Heat Res, (Φ) Obs, (P) Oil-gas, (R) Recharge, (T) Test, (U) Unused, (W) Withdraw, (X) Waste, (Z) Destroyed U

DATA AVAILABLE: Well data Freq. W/L meas.: N Field aquifer char.

Hyd. lab. data: _____

Qual. water data; type: M

Freq. sampling: _____ Pumpage inventory: yes, no, period: _____

Aperture cards: _____

Log data: _____

WELL-DESCRIPTION CARD

SAME AS ON MASTER CARD Depth well: 800 ft Meas. 6

Depth cased: _____ ft Casing type: _____; Diam. 8x4 in

Finish: (C) concrete, (F) porous gravel w. (perf.), (G) gravel w. (screen), (H) horiz. gallery, (Φ) open end, (P) perf., (S) screen, (T) sd. pt., (W) shored, (X) open hole, (Z) other U

Method: (A) air bored, (B) cable, (C) dug, (D) hyd rot., (H) jetted, (J) air percussion, (P) rotary, (R) reverse, (T) trenching, (V) driven, (W) drive wash, (Z) other U

Date Drilled: 9-2-6 Pump intake setting: _____ ft

Driller: Hartog address Columbia

Lift (type): (A) air, (B) bucket, (C) cent, (J) jet, (L) multiple, (M) multiple, (N) none, (P) piston, (R) rot, (S) submerg, (T) turb, other N Deep Shallow

Power (type): nat, LP, Trans. or meter no.

Descrip. MP _____ ft above LSD, Alt. MP _____

Alt. LSD: 236 Accuracy: (source) 3

Water Level: _____ ft above below MP; _____ ft above below LSD Accuracy: ±5

Date meas: 5-7-1 Yield: flows gpm 60 Method determined F

Drawdown: _____ ft Accuracy: _____ hrs _____

QUALITY OF WATER DATA: Iron _____ ppm Sulfate _____ ppm Chloride _____ ppm Hard. _____ ppm

Sp. Conduct 810 K x 10⁶ 1 Temp 23.5 °F 23.5 Date sampled _____

Taste, color, etc. _____

Well No.

R8

Latitude-longitude N
S
d m s d m s

HYDROGEOLOGIC CARD

SAME AS ON MASTER CARD Physiographic Province: 03 Section:

D Drainage Basin: 13V Subbasin:

Topo of well site: (D) depression, stream channel, dunes, flat, hilltop, sink, swamp, (K) (L) (Ø) (P) (S) (T) (U) (V) offshore, pediment, hillside, terrace, undulating, valley flat

MAJOR AQUIFER: system, series, TM aquifer, formation, group, CA

Lithology: Origin: 3 Aquifer Thickness: ft

Length of well open to: ft, Depth to top of: ft

MINOR AQUIFER: system, series, aquifer, formation, group,

Lithology: Origin: Aquifer Thickness: ft

Length of well open to: ft, Depth to top of: ft

Intervals Screened:

Depth to consolidated rock: ft, Source of data:

Depth to basement: ft, Source of data:

Surficial material: , Infiltration characteristics:

Coefficient Trans: gpd/ft, Coefficient Storage:

Coefficient Perm: gpd/ft²; Spec cap: gpm/ft; Number of geologic cards:

J.C LOWERY, Mayor 858-2205

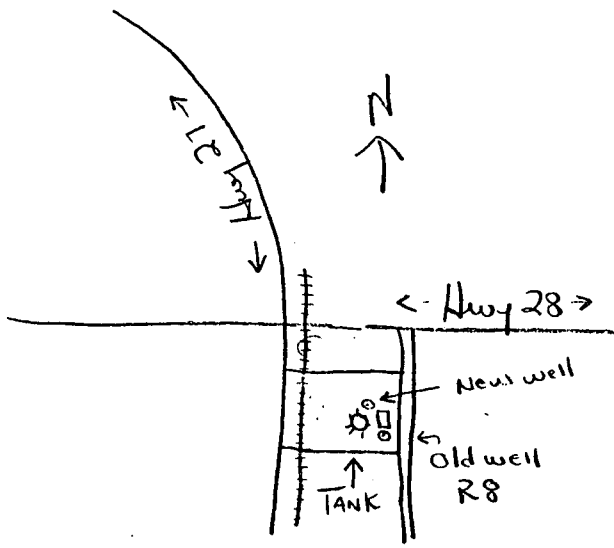
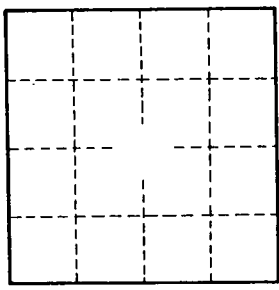

Well No.

R8