

WELL SCHEDULE

Log # 49

U. S. DEPT. OF THE INTERIOR

GEOLOGICAL SURVEY

WATER RESOURCES DIVISION

replaced by P75
MASTER CARD

health Dept well.

Record by JAC + JFW Source of data Obs. driller Date 6/59 Map Hazlehurst

State 22 County (or town) Copiah 115

Latitude: 31 51 31 N Longitude: 09 02 34 W Sequential number: 1

Lat-long accuracy: 10 T, 10 S, R 8 W, Sec 10, DE, NE, SW, SE/NW/NW/NW

Local well number: 9029 BB 1010 N08 E Other number: City Well # 4

Local use: 064 Owner or name: Tank hole # 3

Owner or name: HAZLEHURST Address: _____

Ownership: County, Fed Gov't, City, Corp or Co, Private, State Agency, Water Dist M

Use of Air cond, Bottling, Comm, Dewater, Power, Fire, Dom, Irr, Med, Ind, P S, Rec, AB-permit

water: (S) (T) (U) (V) (W) (X) (Y) (Z) DY

Use of (A) (D) (G) (H) (I) (J) (K) (L) (M) (N) (O) (P) (R) (T) (U) (W) (X) (Z) WZ

well: Anode, Drain, Seismic, Heat Res, Obs, Oil-gas, Recharge, Test, Unused, Withdraw, Waste, Destroyed

DATA AVAILABLE: Well data Freq. W/L meas.: Field aquifer char.

Hyd. lab. data: _____

Qual. water data; type: _____

Freq. sampling: _____ Pumpage inventory: yes no period: _____

Aperture cards: _____ yes

Log data: Log MOCN DE

WELL-DESCRIPTION CARD

SAME AS ON MASTER CARD Depth well: 326 ft Meas. rept 3 accuracy _____

Depth cased: 251 ft Casing type: _____; Diam. in 1.8

Finish: porous concrete, gravel w. (perf.), gravel w. (screen), horiz. gallery, open end, perf., screen, sd. pt., shored, open hole, other S

Method drilled: (A) (B) (C) (D) (H) (J) (P) (R) (T) (V) (W) (Z) H

Date drilled: 6/11/59 9:59 Pump intake setting: _____ ft

Driller: Layne Central

Lift (type): (A) (B) (C) (J) multiple, multiple, none, piston, rot, submerg, turb, other T Deep Shallow

Power (type): diesel, elec, gas, gasoline, hand, gas, wind; H.P. V Trans. or meter no. _____

Descrip. MP 460 Ft above LSD, Alt. MP _____

Alt. LSD: 456 Accuracy: 560 1

Water Level: _____ ft above MP; _____ ft below LSD 216 Accuracy: _____ D

Date meas: 9:59 Yield: 602 gpm Method determined 61

Drawdown: _____ ft Accuracy: _____ Pumping period _____ hrs _____

QUALITY OF WATER DATA: Iron _____ Sulfate _____ Chloride _____ Hard. _____

Sp. Conduct 120 K x 10⁶ Temp. 21.0 °C Date sampled _____

Taste, color, etc. _____

Well is gone;
location
under
generator

pump sealed
cannot be
measured.

destroyed
1/87
replace
with
well
P75

Well No.

029

Latitude-longitude N
S
d m s d m s

HYDROGEOLOGIC CARD

SAME AS ON MASTER CARD Physiographic Province: 03 Section: _____

D Drainage Basin: 13V Subbasin: _____

Topo of well site: (D) depression, stream channel, dunes, flat, hilltop, sink, swamp, (C) (E) (F) (H) (K) (L) (P) (S) (T) (U) (V) offshore, pediment, hillside, terrace, undulating, valley flat _____

MAJOR AQUIFER: TM system _____ series _____ aquifer, formation, group CA

Lithology: S Origin: 3 Aquifer Thickness: _____ ft

77 Length of well open to: _____ ft 55 Depth to top of: _____ ft 249

MINOR AQUIFER: _____ system _____ series _____ aquifer, formation, group _____

Lithology: _____ Origin: _____ Aquifer Thickness: _____ ft

 Length of well open to: _____ ft Depth to top of: _____ ft

Intervals Screened: 251-291' & 311-326'

Depth to consolidated rock: _____ ft _____ Source of data: _____

Depth to basement: _____ ft _____ Source of data: _____

Surficial material: _____ Infiltration characteristics: _____

Coefficient Trans: _____ gpd/ft _____ Coefficient Storage: _____

Coefficient Perm: _____ gpd/ft²; Spec cap: _____ gpm/ft; Number of geologic cards: _____

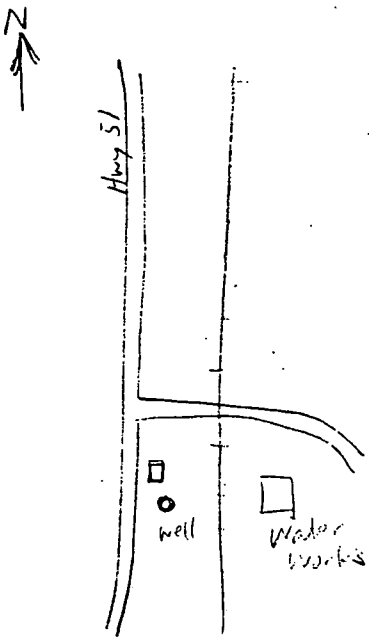

Casings
9' of 30" Surface
243' of 18"
68' of 12"
10" Screen
55' in 2 sections
251-291
311-326

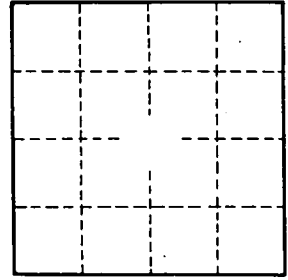

Well No. 129

Abraham
State of Mississippi



*M00
6-9-92*

Department of Natural Resources
Bureau of Land and Water Resources
P.O. Box 10631
Jackson, Mississippi 39209

Permit

TO DIVERT OR WITHDRAW FOR BENEFICIAL USE THE PUBLIC WATERS

This permit is issued to the landowner named below in accordance with the provisions of the Mississippi Water Laws (Section 51 - 3 - 1, et seq., Mississippi code of 1972, as amended) and the regulations and standards as promulgated thereunder. Authorization is hereby granted to proceed with the proposed beneficial use subject to the following terms, conditions and limitations:

PERMIT NUMBER: MS-GW-08204
LANDOWNER NAME: Hazlehurst, City of
LANDOWNER ADDRESS: P.O. Box 367, Hazlehurst MS 39083
SOURCE OF WATER: Miocene Aquifer System
BENEFICIAL USE: Municipal
DIVERSION/WITHDRAWAL LOCATION: NW 1/4 of the NW 1/4, Section 10, Township 10 North, Range 8 East
COUNTY: Copiah
MAXIMUM VOLUME: 0.3 Million Gallons per Day
MAXIMUM RATE: 500 Gallons per Minute
APPLICANT NAME: Hazlehurst, City of
APPLICANT ADDRESS: P.O. Box 367, Hazlehurst, MS 39083
DATE PERMIT ISSUED: March 8, 1988
DATE PERMIT EXPIRES: March 8, 1998
SPECIAL TERMS AND CONDITIONS: None
DATE MODIFIED:

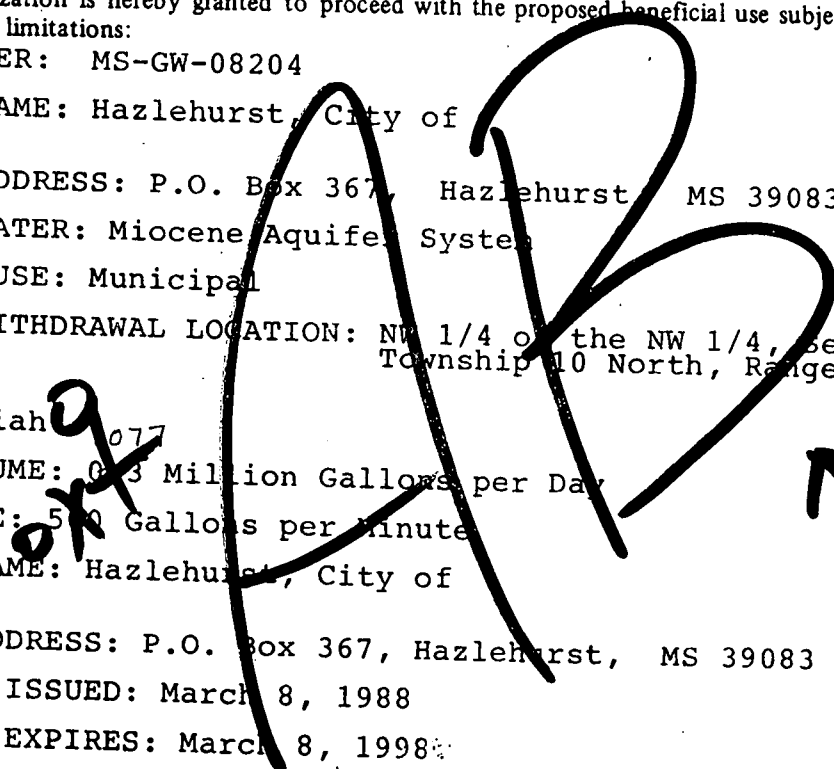

*per LAN
AND DAVID
HARNAI
8-4-97
JB*

DEPARTMENT OF NATURAL RESOURCES
J. I. Palmer, Jr.
J. I. Palmer, Jr.
Executive Director

3/20/21 1st-Exhibit, GW-8204, P029

3195876 / 90.39520

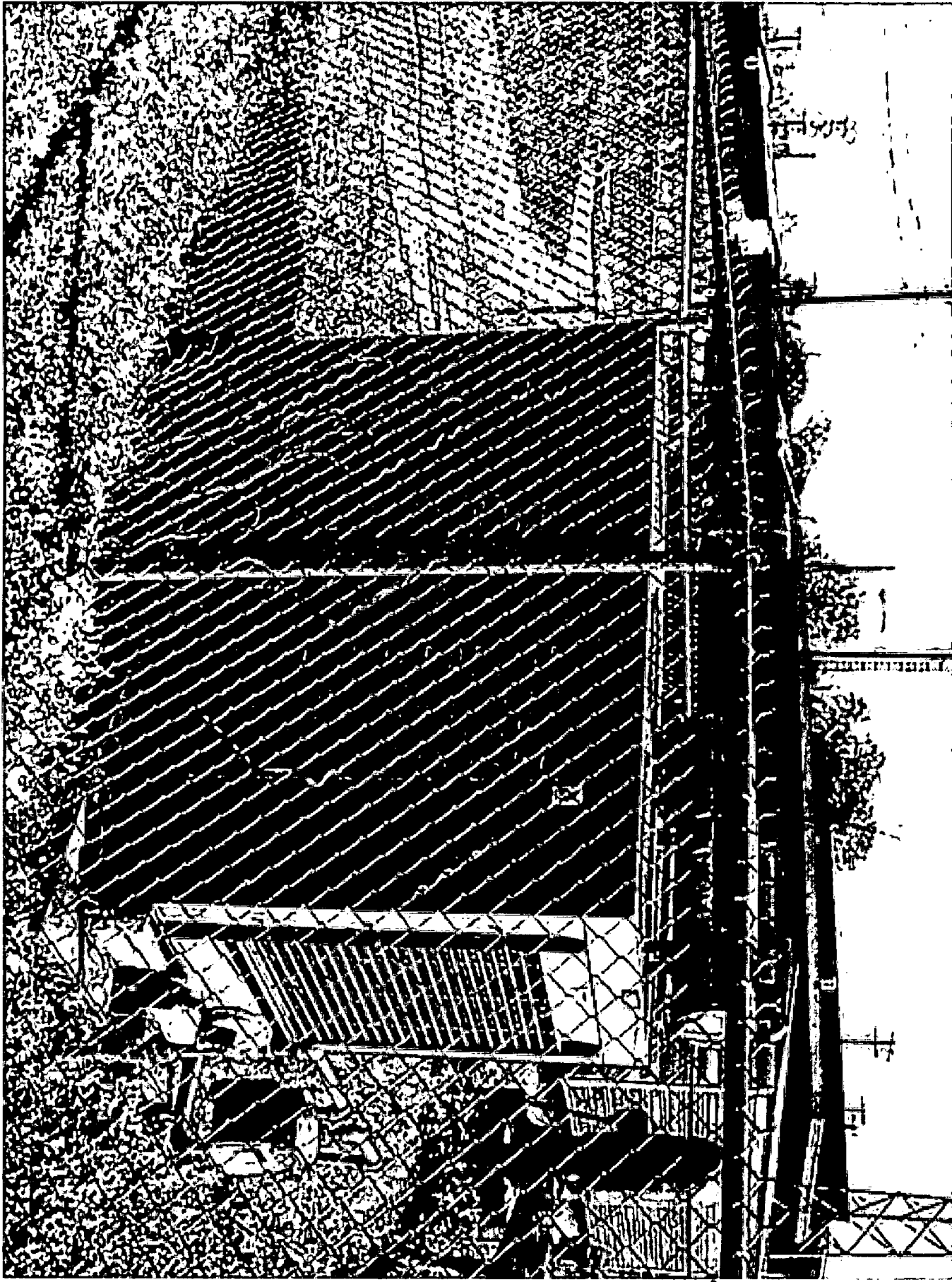

← GW
0534

old well under generator ↘

HAZLEHURST QUADRANGLE
MISSISSIPPI-COPIAH CO.
7.5 MINUTE SERIES (TOPOGRAPHIC)

2947 IV NE
(CRYSTAL SPRINGS)

743 744 25' 745 JACKSON 32 MI. GALLMAN 4.1 MI. 480000 FEET 747 748 90°22'30" 31°52'30"

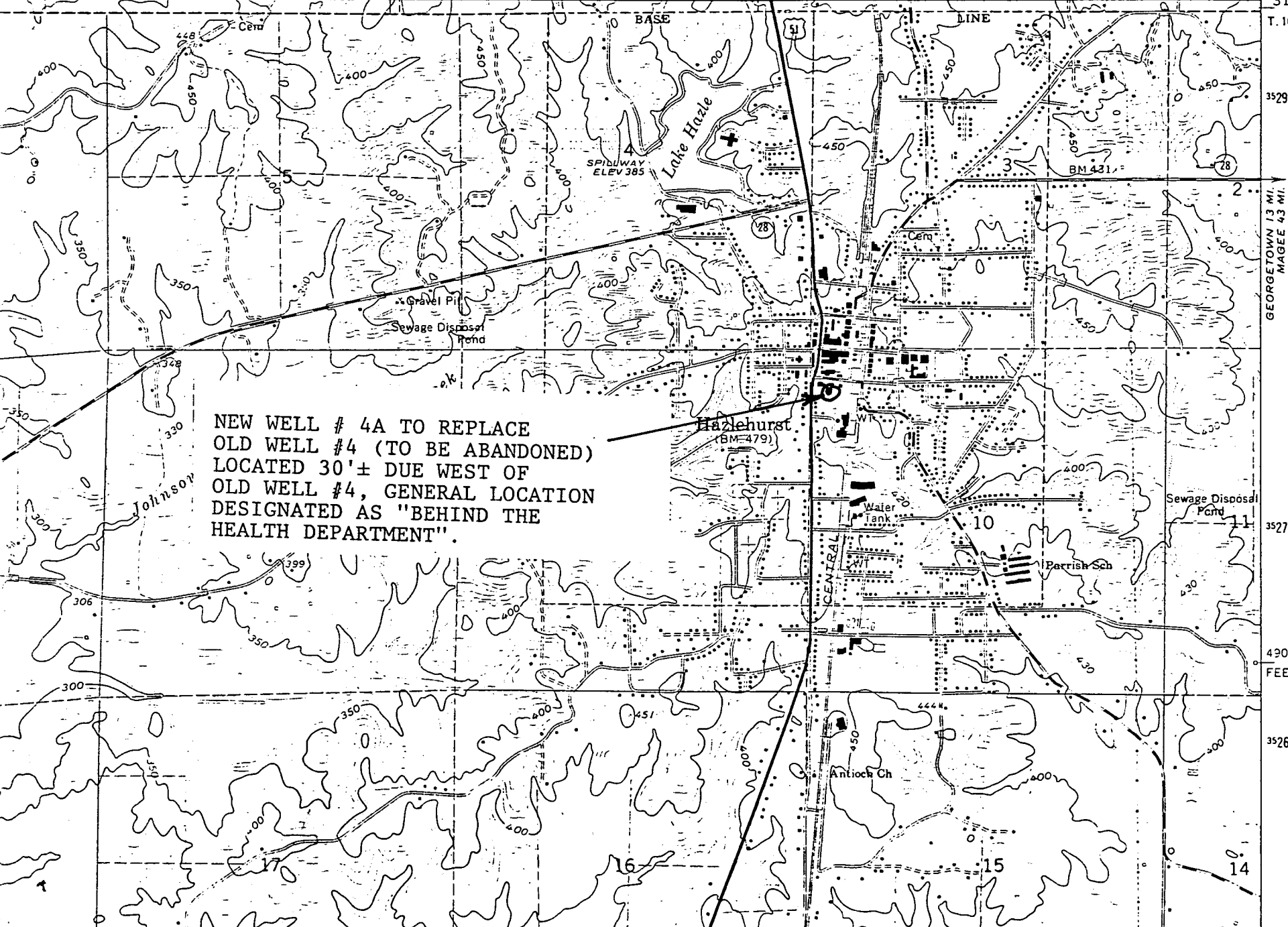

NEW WELL # 4A TO REPLACE
OLD WELL #4 (TO BE ABANDONED)
LOCATED 30'± DUE WEST OF
OLD WELL #4, GENERAL LOCATION
DESIGNATED AS "BEHIND THE
HEALTH DEPARTMENT".

3529
3527
490 000
FEET
3526
360

GEORGETOWN 13 MI.
MAGEE 43 MI.

T. 10 N.

490 000
FEET

HAZLEHURST QUADRANGLE
MISSISSIPPI-COPIAH CO.
7.5 MINUTE SERIES (TOPOGRAPHIC)

2947 N. NE
(CRYSTAL SPRINGS)

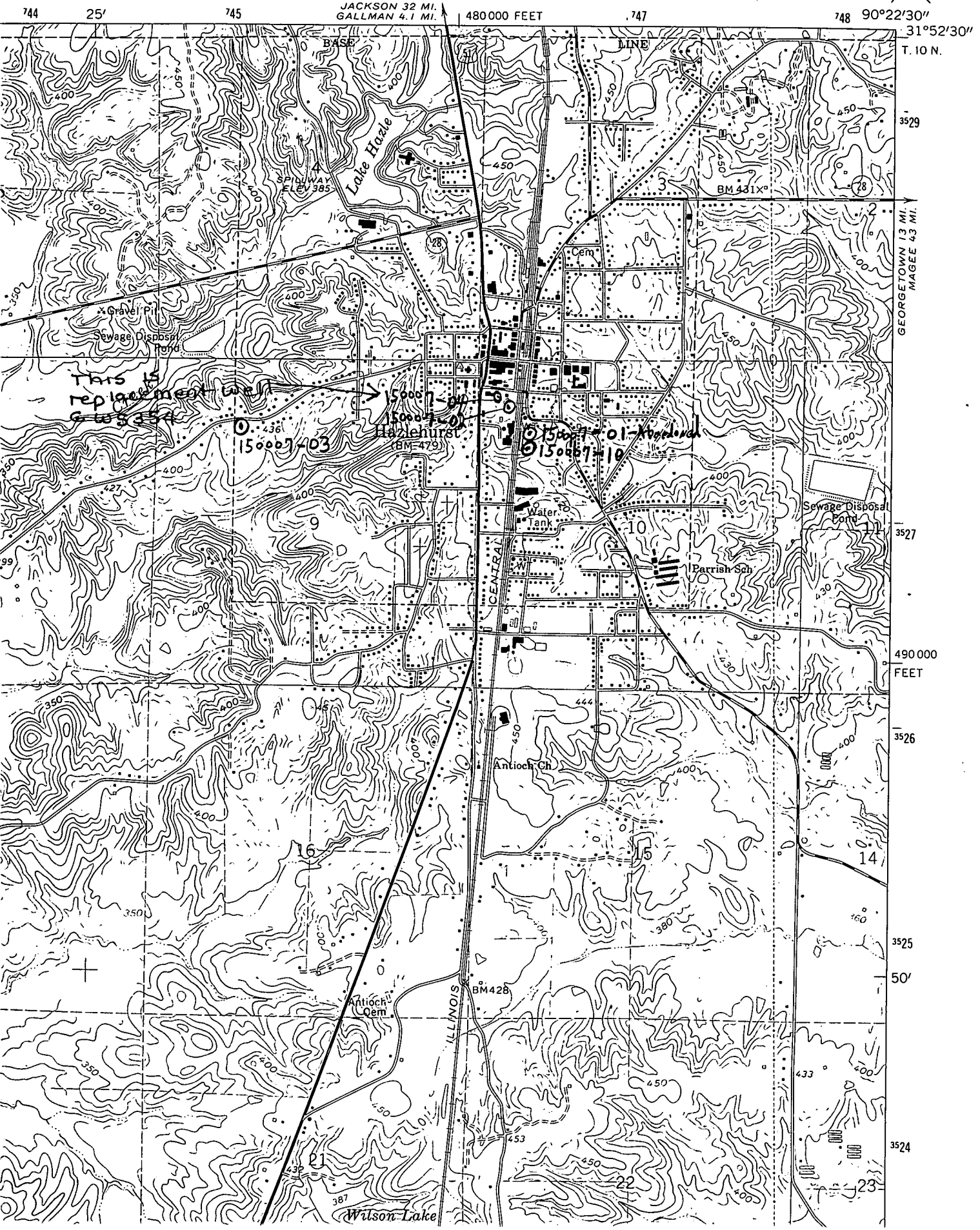

JACKSON 32 MI.
GALLMAN 4.1 MI.

480 000 FEET

748 90°22'30"

31°52'30"
T. 10 N.

GEORGETOWN 13 MI.
MAGEE 43 MI.

490 000
FEET

50'

3524