

# TRANSMITTED FOR ADP

Coded By BRR 6/89  
Checked By gpc  
Entered By SPHAR  
Date 7-14-89

U.S. GEOLOGICAL SURVEY  
WATER RESOURCES DIVISION  
MISSISSIPPI DISTRICT

E-Log No. \_\_\_\_\_  
County CORLAH  
Agency \_\_\_\_\_

Well No. L25  
2697

## WELL RECORD

Agency Code <u>U S G S</u>		Site Id <u>1311512311091010181231011</u>				Project No. <u>5111111111</u>			
Station Name <u>1241251 R11V1E1S1 E1 R1E1Y1W1O1K1D1S1111</u>						Latitude <u>93115123111</u>		Longitude <u>104091010181231</u>	
Lat/Long Ac. <u>113 S F 10</u>		Dist <u>6=28</u>	State <u>7=28</u>	County <u>8=291</u>	Land Net <u>135kdsks1s31111b1/W1R121E1</u>				
Location Map <u>14=11B1P1E1W1E1L111111111</u>				Altitude <u>16=21601</u>	Met/Meas <u>17= A L 0</u>	Accuracy <u>18= 1/101</u>	Hydrologic Unit <u>20= 01311810101021</u>		
Agency Use <u>803= A 1 0</u>		Date Inventoried <u>711= / /</u>		Station Type <u>Y</u>		Date Type <u>804= / /</u>			
Instru. <u>805=</u>	Remarks <u>806=</u>				Relia. <u>3= C L M 10</u>	<u>26 X</u>			
Date of Construction <u>21= 07/13/1191818</u>		Well Use <u>23= W</u>	Water Use <u>24= N</u>	Primary Aquifer <u>714= 122K1T1H14</u>		Hole Depth <u>27= 14214</u>			
Well Depth <u>28= 14214</u>	Water Level <u>30=</u>	Water Level Date <u>31= / /</u>			Method <u>34=</u>	Status <u>37=</u>	Source <u>33=</u> <i>SAWMILL</i>		

### CONSTRUCTION DATA

R=58	T=A	72301	Construction Date <u>60= 07/13/1191818</u>		Contractor <u>63= 4021</u>	Method <u>65= 1/1</u>	Finish <u>66= S1</u>	Name <u>Tom GRIFFITH</u>
------	-----	-------	---	--	-------------------------------	--------------------------	-------------------------	--------------------------

### CONSTRUCTION CASING DATA

R=76	T=A	72501	5901	Top/Casing <u>774</u>	Bot/Casing <u>781</u>	Diameter <u>794</u>
R=76	T=A	72502	5901	Top/Casing <u>774</u>	Bot/Casing <u>781</u>	Diameter <u>794</u>

### CONSTRUCTION OPENINGS DATA

R=82	T=A	72601	5901	Top/Depth <u>834</u>	Bot/Depth <u>841</u>	Diameter <u>874</u>	Type <u>85= S1</u>	Length <u>894</u>	Width <u>884</u>
R=82	T=A	72602	5901	Top/Depth <u>834</u>	Bot/Depth <u>841</u>	Diameter <u>874</u>	Type <u>85=</u>	Length <u>894</u>	Width <u>884</u>

### CONSTRUCTION LIFT DATA

R=42	T=A	25401	Lift Type <u>43= A</u>	Date <u>38= 07/13/1191818</u>	Intake <u>44= 1214101</u>
------	-----	-------	---------------------------	----------------------------------	------------------------------

Power <u>45=</u>	H.P. <u>46=</u>	Serial No. <u>49=</u>
---------------------	--------------------	--------------------------

### MISCELLANEOUS OWNER DATA

R=158	T=A	71801	Date of Ownership <u>159= 07/13/1191818</u>		Owner Name <u>161= R11V1E1S1 E1 R1E1Y1W1O1K1D1S1 1411181E1R11C101111</u>				
-------	-----	-------	--	--	---	--	--	--	--

### MISCELLANEOUS OTHER ID DATA

R=189	T=A	73601	E-Log No. <u>1904</u>	Assigner <u>191= M11S1S1D11S111</u>				
-------	-----	-------	--------------------------	--	--	--	--	--

MISCELLANEOUS QW DATA

R=192	T=A	73801	Date of Measurement 1934 / / / / / / / / / /	Aquifer Sampled 195 / / / / / / / / / /	Temp 196400010	Value 197 / / / /
R=192	T=A	73802	Date of Measurement 1934 / / / / / / / / / /	Aquifer Sampled 195 / / / / / / / / / /	Sp Cond 196400095	Value 197 / / / /
R=192	T=A	73803	Date of Measurement 1934 / / / / / / / / / /	Aquifer Sampled 195 / / / / / / / / / /	pH 1964000400	Value 197 / / / /

MISCELLANEOUS LOGS DATA

R=198	T=A	73901	Log Type 199 / / / /	Req. Depth 200 / / / / / /	End Depth 201 / / / / / /
R=198	T=A	73901	Log Type 199 / / / /	Req. Depth 200 / / / / / /	End Depth 201 / / / / / /

MISCELLANEOUS NETWORK DATA

R=114	T=A	73001	Req. Year 115 / / / /	End Year 116 / / / /	Agency Source 120-A / / / /	Freq. 118 / / /
R=121	T=A	73002	Req. Year 115 / / / /	End Year 116 / / / /	Agency Source 117 / / / /	Freq. 118 / / /

MISCELLANEOUS REMARKS DATA

R=183	T=A	31101	Date of Remarks 184 / / / / / / / / / /	Remarks 185 / / / / / / / / / /
-------	-----	-------	--	------------------------------------

DISCHARGE DATA

R=146	T=A	Pump/Flow 14701	Date 148 / / / / / / / / / /	Type 703 / / / /	Discharge 150 / / / / / /	Sp. Capacity 272 / / / / / /
-------	-----	--------------------	---------------------------------	---------------------	------------------------------	---------------------------------

GEOHYDROLOGIC DATA

R=90	T=A	72101	Depth Top 91 / / / / / / / / / /	Depth Bot. 92 / / / / / /	Unit Id 93 / / / / / / / / / /	304-P
------	-----	-------	-------------------------------------	------------------------------	-----------------------------------	-------

HYDRAULIC DATA

R=98	T=A	79001	Unit Tested 100 / / / / / / / / / /	103 / / / /
------	-----	-------	--	-------------

2 mi E OF GEORGETOWN

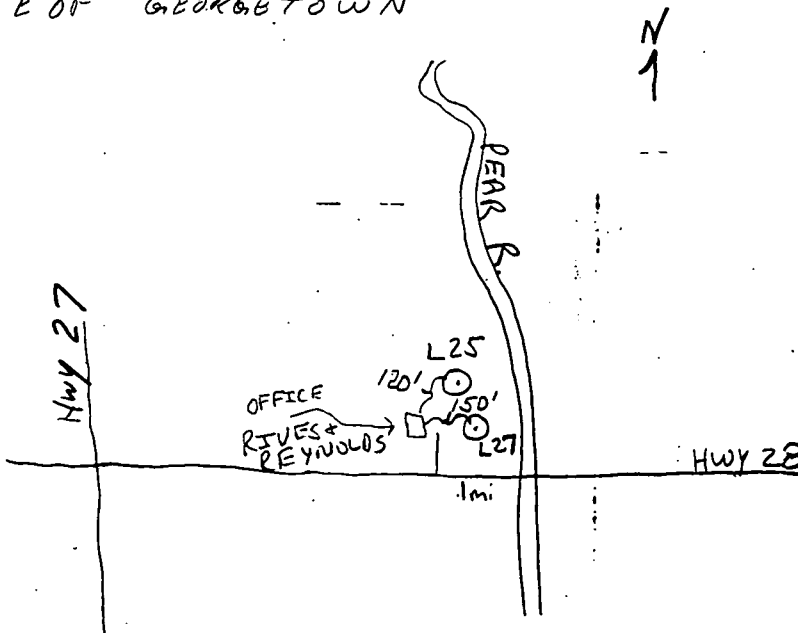

DESCRIPTION OF FORMATIONS ENCOUNTERED	FROM	TO
SAND	0	18
CLAY	18	29
ROCK	29	30
CLAY	30	32
ROCK	32	34
CLAY	34	43
ROCK	43	48
CLAY	48	56
ROCK	56	64
CLAY	64	67
ROCK	67	71
CLAY	71	88
ROCK	88	94
CLAY	94	101
ROCK	101	105
CLAY	105	125
ROCK	125	133
CLAY	133	150
SAND	150	151
CLAY	151	155
ROCK	155	158
ROCK	158	170
170-171	ROCK	
171-205	CLAY	
205-210	SAND	
210-225	CLAY	
225-230	SAND	
230-243	CLAY	
243-265	ROCK	
265-270	CLAY	
270-275	SAND	
275-277	ROCK	
277-284	CLAY + ROCK	
284-286	CLAY	
286-295	SAND	
295-318	ROCK + CLAY	
318-324	CLAY	
324-338	SAND	
338-339	CLAY	
339-342	SAND	
342-375	CLAY + ROCK	
375-382	CLAY	
382-408	SAND	
408-410	ROCK	
410-424	SAND	