

WELL SCHEDULE

U. S. DEPT. OF THE INTERIOR - GEOLOGICAL SURVEY - WATER RESOURCES DIVISION

MASTER CARD

Record by G. J. Dalsin Source of data Dr. Report Date 3-12-71 Map Dentville Quadrangle

State Miss. County Copiah (or town) 1.5

Latitude: 31° 53' 30" N Longitude: 090° 32' 30" W Sequential number: 1

Lat-long accuracy: 3' S. R. 4 Sec. 25 NW NW SE

Local well number: G0158D2501N04W Other well number: B & M

Local use: 222740 Owner or name: DON HAISER Address: Dentville, Miss.

Ownership: County, Fed Gov't, City, Corp or Co Private State Agency, Water Dist P

Use of water: Air cond, Bottling, Comm, Dewater, Power, Fire, Dom, Irr, Med, Ind, P S, Rec, Stock, Instit, Unused, Repressure, Recharge, Desal-P.S, Desal-other, Other W

Use of well: Anode, Drain, Seismic, Heat Res, Obs, Oil-gas, Recharge, Test, Unused, Withdraw, Waste, Destroyed. W

DATA AVAILABLE: Well data Freq. W/L meas. Field aquifer char.

Hyd. lab. data:

Qual. water data; type:

Freq. sampling: Pumpage inventory: no. period:

Aperture cards:

Log data: DE

WELL-DESCRIPTION CARD

SAME AS ON MASTER CARD

Depth well: 214 ft Meas. rept. 3

Depth cased (first perf.): 204 ft Casing type: PL Diam. 2 in

Finish: porous gravel w. concrete, (perf.), (screen), gallery, end, (F) gravel w. (G) horiz. (H) open (I) perf., (S) screen, (T) sd. pt., (W) shored, (X) open hole, (Z) other 3

Method Drilled: (A) air bored, (B) cable, (C) dug, (D) hyd rot., (E) jetted, (F) air percussion, (G) reverse, (H) trenching, (I) driven, (J) drive wash, (K) other H

Date Drilled: 971 Pump intake setting: 38 ft

Driller: H. E. Thompson Well Serv. Mendenhall, Miss.

Lift (type): (A) air, (B) bucket, (C) cent., (D) jet, (E) multiple, (F) multiple, (G) none, (H) piston, (I) rot., (J) submerg, (K) turb., (L) other J Deep Shallow

Power (type): diesel, elec, nat gas, gasoline, hand, gas, wind, H.P. 3/4 Trans. or meter no. S

Descrip. MP 345 ft above LSD, Alt. MP 4

Alt. LSD: 345 Accuracy: 4

Water Level: 123 ft above below MP; Ft. below LSD 123 Accuracy: D

Date meas.: 371 Yield: 6 gpm Method determined: 6

Drawdown: 6 ft Accuracy: 6 hrs

QUALITY OF WATER DATA: Iron ppm 69 Sulfate ppm 70 Chloride ppm 71 Hard. ppm 72

Sp. Conduct K x 10⁶ 73 Temp. °F 74 Date sampled 77

Taste, color, etc. 79

PUNCHED and VERIFIED
ROLLA COMPUTATION BRANCH

Well No.

615

Well No. G 15

FORM 1-63 (53-1)

WELL SCHEDULE

WATER RESOURCES DIVISION

Latitude-Longitude

HYDROGEOLOGIC CARD

Physiographic Province: 0.3 Section: 0.3

Drainage Basin: D **Subbasin:** 1.5-L

Topo of well site: (D) depression, (C) stream channel, (B) dunes, (F) flat, (H) hilltop, (K) sink, (L) swamp, (G) offshore, pediment, hillside, terrace, undulating, valley flat

MAJOR AQUIFER: U.S. T.M. **Origin:** 3 **Aquifer Thickness:** 20 ft

Lithology: U.S. **Length of well open to:** 70 ft **Depth to top of:** 199 ft

MINOR AQUIFER: U.S. **Origin:** 3 **Aquifer Thickness:** 20 ft

Lithology: U.S. **Length of well open to:** 70 ft **Depth to top of:** 199 ft

Intervals Screened: 2' P.R.

Depth to consolidated rock: 60 ft **Source of data:** 64

Depth to basement: 63 ft **Source of data:** 69

Surficial material: 70 **Infiltration characteristics:** 72

Coefficient Trans: 73 **Coefficient Storage:** 76

Perm: 77 **Spec cap:** 78 **Number of geologic cards:** 79

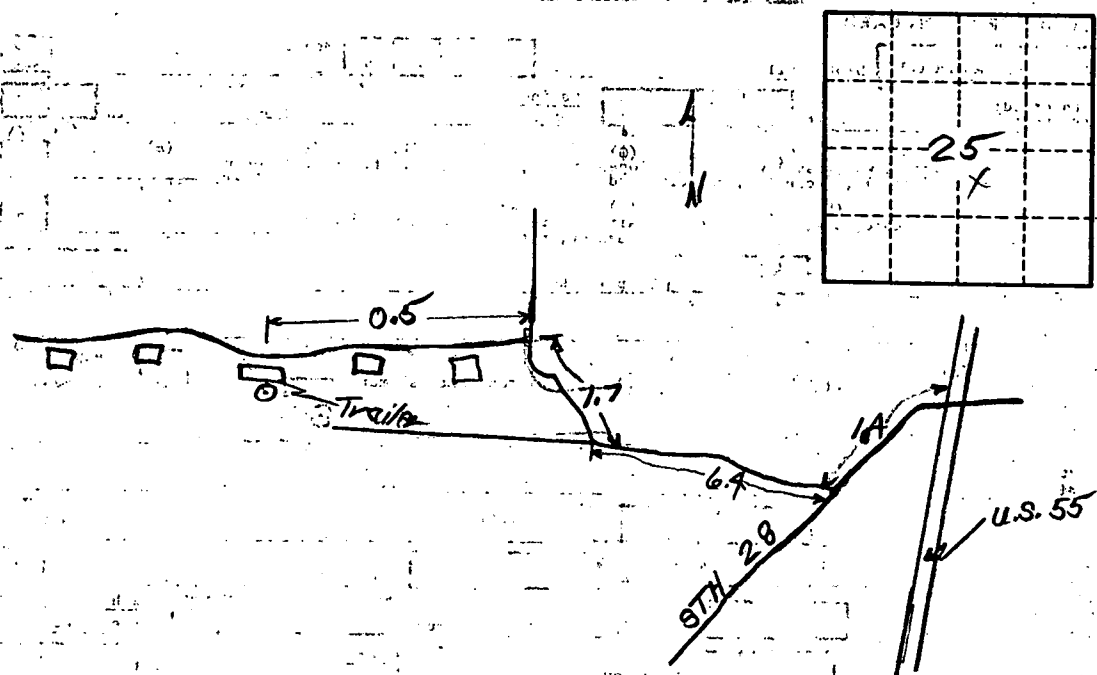

Well No.

G 15