

**MASTER CARD**

Record by WJB Source of data Obs. driller Date 4/27/71 Map Terry Quad.  
 State 28 County (or town) Copiah 15  
 Latitude: 32° 00' 28" N Longitude: 090° 21' 47" W Sequential number: 3  
 Lat-long accuracy: 2' 2' 2' 13' SE NW SW  
 Local well number: D060BC1302N02W Other number: B & H  
 Local use: 222141 Owner or name: T. Lockhart  
 Owner or name: T. Lockhart Address: Crystal Springs  
 Ownership: County, Fed Gov't, City, Corp or Co, Private, State Agency, Water Dist P  
 Use of Air cond, Bottling, Comm, Dewater, Power, Fire, Irr, Med, Ind, P S, Rec, water: (S) (T) (U) (V) (W) (X) (Y) (B) (H)  
 Stock, Instit, Unused, Recharge, Desal-P S, Desal-other, Other  
 Use of well: (A) (D) (G) (H) (I) (P) (R) (T) (U) (W) (X) (B) (W)  
 Anode, Drain, Seismic, Heat Res, Obs, Oil-gas, Recharge, Test, Unused, Withdraw, Waste, Destroyed  
 DATA AVAILABLE: Well data  Freq. W/L meas.:  Field aquifer char.   
 Hyd. lab. data:   
 Qual. water data; type:   
 Freq. sampling:  Pumpage inventory:  yes no; period:   
 Aperture cards:  yes   
 Log data: Elog 38' - 176' DE

**WELL-DESCRIPTION CARD**

SAME AS ON MASTER CARD Depth well: T.D. 176 ft 171 Meas. 3  
 Depth cased; (first perf.) 166 ft Casing type: Pcv; Diam. 2 in 2  
 Finish: porous concrete, gravel w. (perf.), gravel w. (screen), horiz. gallery, open end, perf., screen, ad. pt., shored, open hole, other S  
 Method: (A) (B) (C) (D) (H) (J) (P) (R) (T) (V) (W) (B) (H)  
 Drilled: air rot, bored, cable, dug, hyd rot., jetted, air percussion, rotary, reverse, driven, drive wash, other H  
 Date Drilled: 4/71 971 Pump intake setting: 0 ft 0  
 Driller: K.E. Thompson name (L) address  
 Lift (type): (A) (B) (C) (J) multiple, multiple, (cent.) none, piston, rot, submerg, turb, other J Deep  Shallow   
 Power (type): diesel, elec, gas, gasoline, hand, gas, wind; H.P. 2 T Trans. or meter no. 0  
 Descrip. MP 425 ft above below LSD, Alt. MP Accuracy: topo 4  
 Alt. LSD: 100 ft above below MP; Ft below LSD 120 Accuracy: 0  
 Date meas: 471 Yield: 6 gpm Method determined 0  
 Drawdown: 0 ft Accuracy: 0 Pumping period 0 hrs 0  
 QUALITY OF WATER DATA: Iron 0 ppm Sulfate 0 ppm Chloride 0 ppm Hard. 0 ppm  
 Sp. Conduct 0 K x 10<sup>6</sup> Temp. 0 °F Date sampled 0  
 Taste, color, etc.

PUNCHED and VERIFIED  
 ROLLA COMPUTATION BRANCH

Well No.

D60

Well No. D60

D60

WELL RECORD

WATER RESOURCES DIVISION

Latitude-longitude

**HYDROGEOLOGIC CARD**

**Physiographic Province:** 03 **Section:** \_\_\_\_\_

**Drainage Basin:** D **Subbasin:** 15L

**Topo of well site:** (D) depression, stream channel, dunes, flat, hilltop, sink, swamp; (E) offshore, pediment, hillside, terrace, undulating, valley flat

**MAJOR AQUIFER:** system \_\_\_\_\_ series Tm aquifer, formation, group CA

**Lithology:** ZS **Origin:** 3 **Aquifer Thickness:** 56 ft

**Length of well open to:** \_\_\_\_\_ ft **Depth to top of:** 149 ft

**MINOR AQUIFER:** system \_\_\_\_\_ series \_\_\_\_\_ aquifer, formation, group \_\_\_\_\_

**Lithology:** \_\_\_\_\_ **Origin:** \_\_\_\_\_ **Aquifer Thickness:** \_\_\_\_\_ ft

**Length of well open to:** \_\_\_\_\_ ft **Depth to top of:** \_\_\_\_\_ ft

**Intervals Screened:** 211 PL

**Depth to consolidated rock:** \_\_\_\_\_ ft **Source of data:** \_\_\_\_\_

**Depth to basement:** \_\_\_\_\_ ft **Source of data:** \_\_\_\_\_

**Surficial material:** \_\_\_\_\_ **Infiltration characteristics:** \_\_\_\_\_

**Coefficient Trans:** \_\_\_\_\_ gpd/ft **Coefficient Storage:** \_\_\_\_\_

**Coefficient Perm:** \_\_\_\_\_ gpd/ft<sup>2</sup>; Spec cap: \_\_\_\_\_ gpm/ft; Number of geologic cards: \_\_\_\_\_

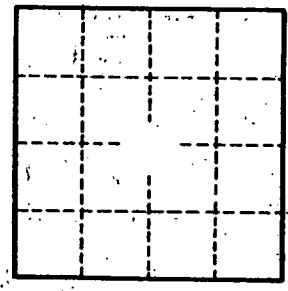
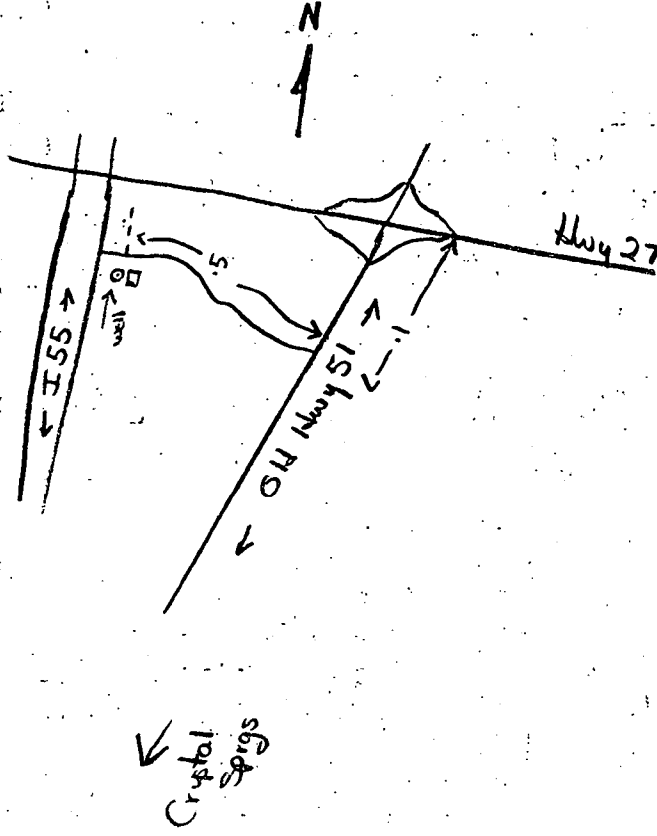

0 - 38 Citronelle

Well No.

D60