

GW4609

Mattson

1/81 WTO

Recorded by DRB.

U.S. GEOLOGICAL SURVEY  
WATER RESOURCES DIVISION  
MISSISSIPPI DISTRICT  
WELL RECORD

Well No. φ-74

E-Log No. \_\_\_\_\_

County COAHOMA

Site ID

3.4.0.053.09.03.1.03.0.1

R=0\*

T=A\*

2=W\*

Data reliab.

3=C\*<sup>C</sup><sub>U</sub>

Report. agency

4=USGS\*

Dist.

6=28\*

7=28\*

Co.

8=02.7\*

Lat.

Long. 1

9=3.4.0.05.3\*

10=0.9.0.3.0.3\*

Well No.

12=φ.0.7.4\*

Location

13=NWNW S 28 T 25 N R 0.3 W\*

Alt.

16=150.\* 151

Hyd. Unit (OWDC)

20= \_\_\_\_\_ \*

Date

21=04.1.28.1.19.83\*

Well use

23=W\*

Water use

24=I\*

Hole depth

27= \_\_\_\_\_ \*

Well depth

28=110.\*

WL

30=24.\*

Date

31=04.1.28.1.19.83\*

Source

33=S\*

Status

273= \_\_\_\_\_ \*

Project No.

5= \_\_\_\_\_ \*

R=158\*

T=A\*

Date

159# 04.1.28.1.19.83\*

Owner No.

Owner

161# U.N.K.N.O.W.N\*

From permit: Lucy S. Aiken

R=192\*

T=A\*

Date

193# 04.1.28.1.19.83\*

Temp.

196#00010\*

197= \_\_\_\_\_ \*

R=192\*

T=A\*

Date

193# / / \*

Cond.

196#00095\*

197= \_\_\_\_\_ \*

R=192\*

T=A\*

Date

193# / / \*

pH

196#00400\*

197= \_\_\_\_\_ \*

R=58\*

T=A\*

59# 1\*

Date

60=04.1.28.1.19.83\*

Remarks

Drig.

63= \_\_\_\_\_ \*

Name

Method

65=R\*

Finish

66=S\*

R=76\*

T=A\*

59# 1\*

Top csng.

77# 0.\*

Bot. csng.

78= \_\_\_\_\_ \*

Diam.

79# 8.\*

R=76\*

T=A\*

59# 1\*

Top csng

77# \_\_\_\_\_ \*

Bot. csng.

78= \_\_\_\_\_ \*

Diam.

79# \_\_\_\_\_ \*

R=82\*

T=A\*

59# 1\*

Top

83# \_\_\_\_\_ \*

Bottom

84= \_\_\_\_\_ \*

Type

85= \_\_\_\_\_ \*

Diam.

87= \_\_\_\_\_ \*

Size

88= \_\_\_\_\_ \*

R=82\*

T=A\*

59# 1\*

Top

83# \_\_\_\_\_ \*

Bottom

84= \_\_\_\_\_ \*

Type

85= \_\_\_\_\_ \*

Diam.

87= \_\_\_\_\_ \*

Size

88= \_\_\_\_\_ \*

R= \_\_\_\_\_ \*

T=A\*

147# 1\*

Q

150= \_\_\_\_\_ \*

Q/S

272= \_\_\_\_\_ \*

134 flows 146 pumped

GEN. SITE DATA

OWNER

FIELD OW

CONSTR.

CASING

OPENINGS

YIELD

LIFT

R=42\* T= A \* Lift type 43# 7\* Intake 44= \* Power type 45= D\*

Date 38= 4/28/1983\* H.P. 46= \*

LOGS

R=198\* T= A \* Log 199# \* Top 200= \* Bot 201= \*

R=198\* T= A \* Log 199# \* Top 200= \* Bot 201= \*

R=189\* T= A \* E Log No. 190# \* 191= M I S S D I S T \*

ANAL.

R=114\* T= A \* Year 115# \* 117= \* 120= \*

AQUIFERS

R=90\* T= A \* 256# 1 \* Top 91= \* Bot 92= \*

Unit ID 93= 112NRVA \* Name of Unit \_\_\_\_\_

R=90\* T= A \* 256# 1 \* Top 91= \* Bot 92= \*

Unit ID 93= \* Name of Unit \_\_\_\_\_

HYDRAULICS

R=98\* T= A \* 99# 1 \* Unit tested 100= \* 103= \*

R=105\* T= A \* 99# 1 \* Test No. 106# \*

107= \* Transmissivity (gal/d)/ft \_\_\_\_\_

108= \* Hydraul. cond. (gal/d)/ft<sup>2</sup> \_\_\_\_\_

110= \* Storage coeff. Boundaries \_\_\_\_\_

R=121\* T= A \* Yr Begin 122# 1983 \* Network 258# \*

Water Level Data Collection (1)

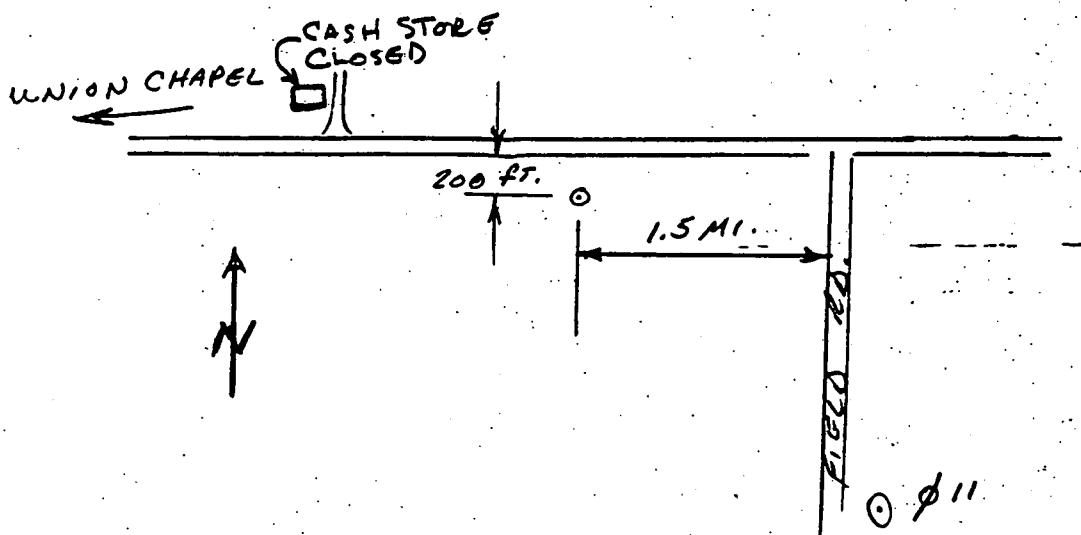



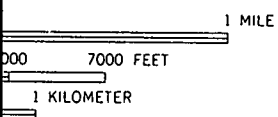
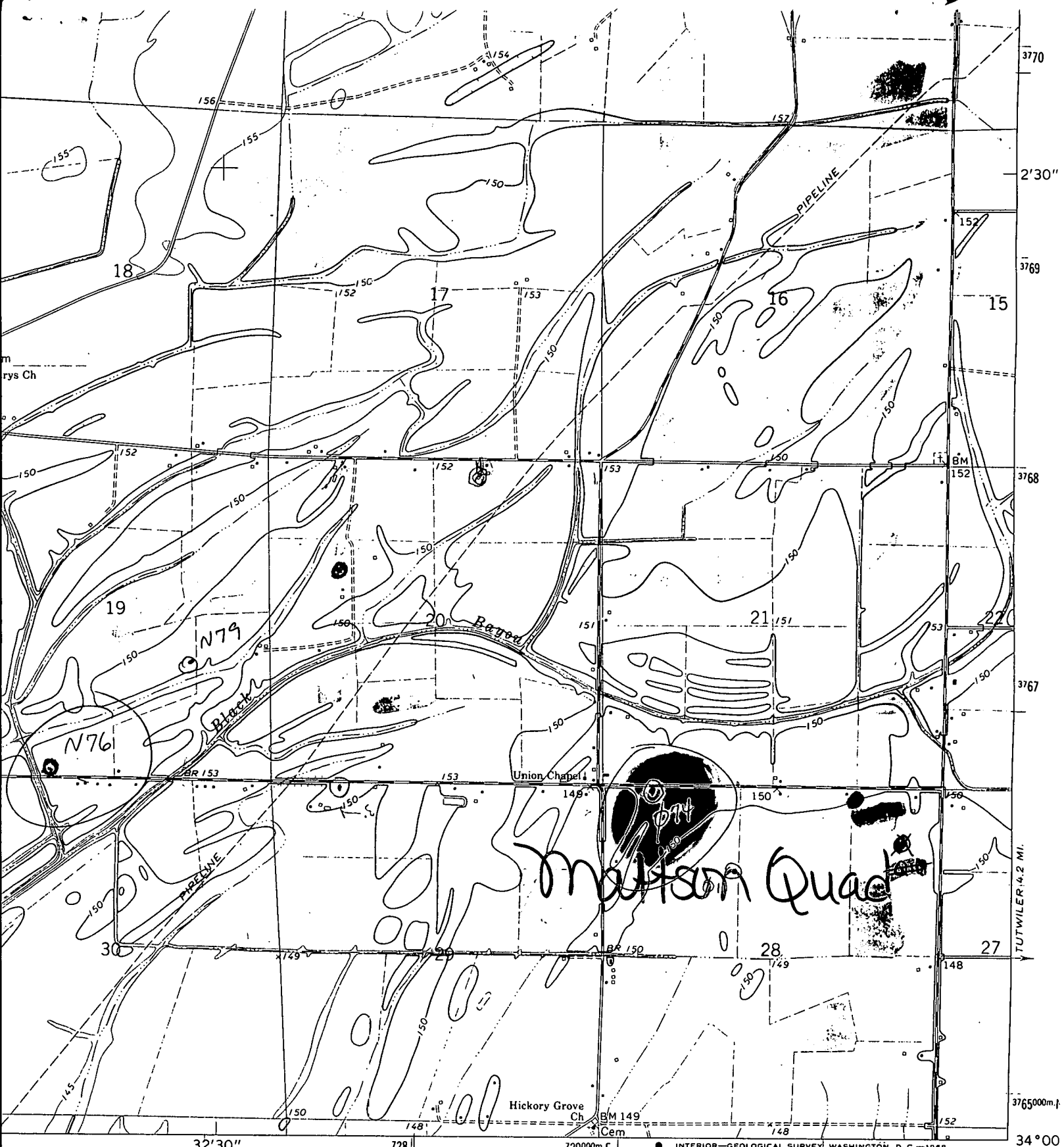

ROAD CLASSIFICATION

- Heavy-duty \_\_\_\_\_
- Medium-duty \_\_\_\_\_
- Light-duty \_\_\_\_\_
- Unimproved dirt \_\_\_\_\_

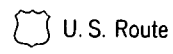

**MATTSON, MISS.**  
SE/4 CLARKSDALE 15' QUADRANGLE