

87-D

GW10131

Mattson

1/81 WTO

Recorded by DRB

Date 4/28/83

U.S. GEOLOGICAL SURVEY
WATER RESOURCES DIVISION
MISSISSIPPI DISTRICT
WELL RECORD

Well No. N-78

E-Log No. _____

County COAHOMA

Site ID 3.4.0.0.4.0.0.9.0.3.5.5.4.0.1 R=0* T=A* 2=W*

Data reliab. 3=C* Report. agency 4=USGS* Dist. 6=28* 7=28* Co. 8=0.2.7*

Lat. _____ Long. 9=3.4.0.0.4.0.* 10=0.9.0.3.5.5.4.* Well No. 12=N.78.*

Location 13=SWNB, S 27 T 25 N, R 04 W.* Alt. 16=150.*

Hyd. Unit (OWDC) 20= Date 21=0.4.1.2.8.1.1.9.8.3.*

Well use 23=U.* Water Use 24=U.* Hole depth 27= Well depth 28=1.1.0.*

WL 30=3.0.* Date 31=0.4.1.2.8.1.1.9.8.3.* Source 33=5.*

Status 273= Project No. 5=

R=158* T=A* Date 159#0.4.1.2.8.1.1.9.8.3.* Owner No. _____

Owner 161# U.N. KNOWN
Williams MS Farm, Inc.

R=192* T=A* Date 193# Temp. 196#00010* 197=

R=192* T=A* Date 193# Cond. 196#00095* 197=

R=192* T=A* Date 193# pH 196#00400* 197=

R=58* T=A* 59# 1* Date 60=0.4.1.2.8.1.1.9.8.3.* Remarks _____

Drlg. 63= Name _____ Method 65=R.* Finish 66=S.*

R=76* T=A* 59# 1*

Top csng. 77# 0.* Bot. csng. 78= Diam. 79# 1.2.*

R=76* T=A* 59# 1*

Top csng. 77# Bot. csng. 78= Diam. 79#

R=82* T=A* 59# 1* Top 83# Bottom 84=

Type 85= Diam. 87= Size 88=

R=82* T=A* 59# 1* Top 83# Bottom 84=

Type 85= Diam. 87= Size 88=

R= T=A* 147# 1* Q 150= Q/S 272=

134 flows 146 pumped

LIFT

R=42* T= A * Lift type 43# T* Intake 44= * Power type 45= *

Date 38= 04/28/1983* H.P. 46= *

LOGS

R=198* T= A * Log 199# * Top 200= * Bot 201= *
R=198* T= A * Log 199# * Top 200= * Bot 201= *
R=189* T= A * E Log No. 190# * 191= M I S S D I S T *

ANAL.

R=114* T= A * Year 115# * 117= * 120= *

AQUIFERS

R=90* T= A * 256# 1 * Top 91= * Bot 92= *
Unit ID 93= 112 MRVA * Name of Unit
R=90* T= A * 256# 1 * Top 91= * Bot 92= *
Unit ID 93= * Name of Unit

HYDRAULICS

R=98* T= A * 99# 1 * Unit tested 100= * 103= *
R=105* T= A * 99# 1 * Test No. 106# *
107= * Transmissivity (gal/d)/ft
108= * Hydraul. cond. (gal/d)/ft²
110= * Storage coeff. Boundaries

R=121* T= A * Yr Begin 122# 1983 * Network 258# *

Water Level Data Collection (1)

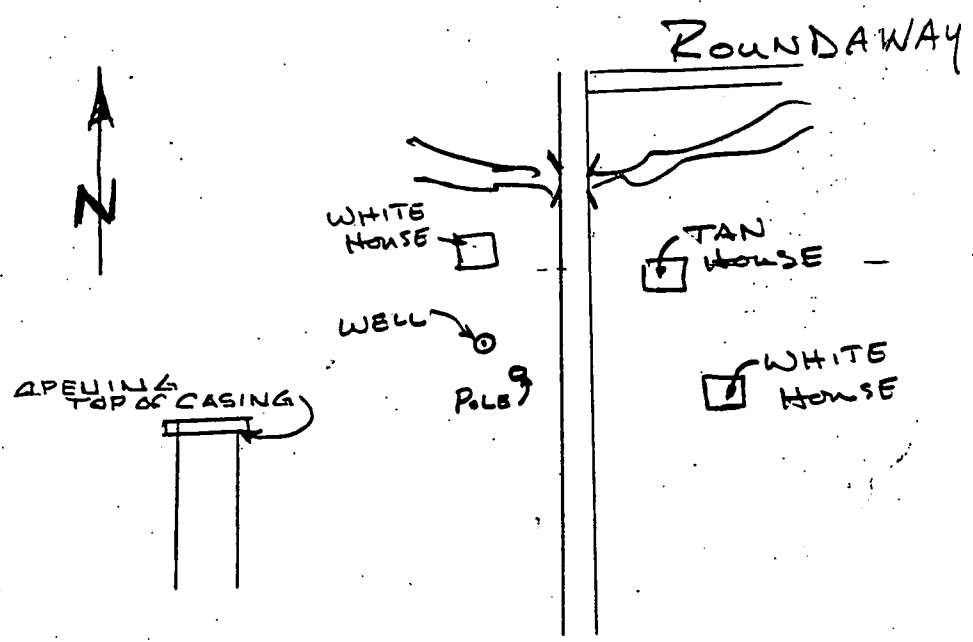

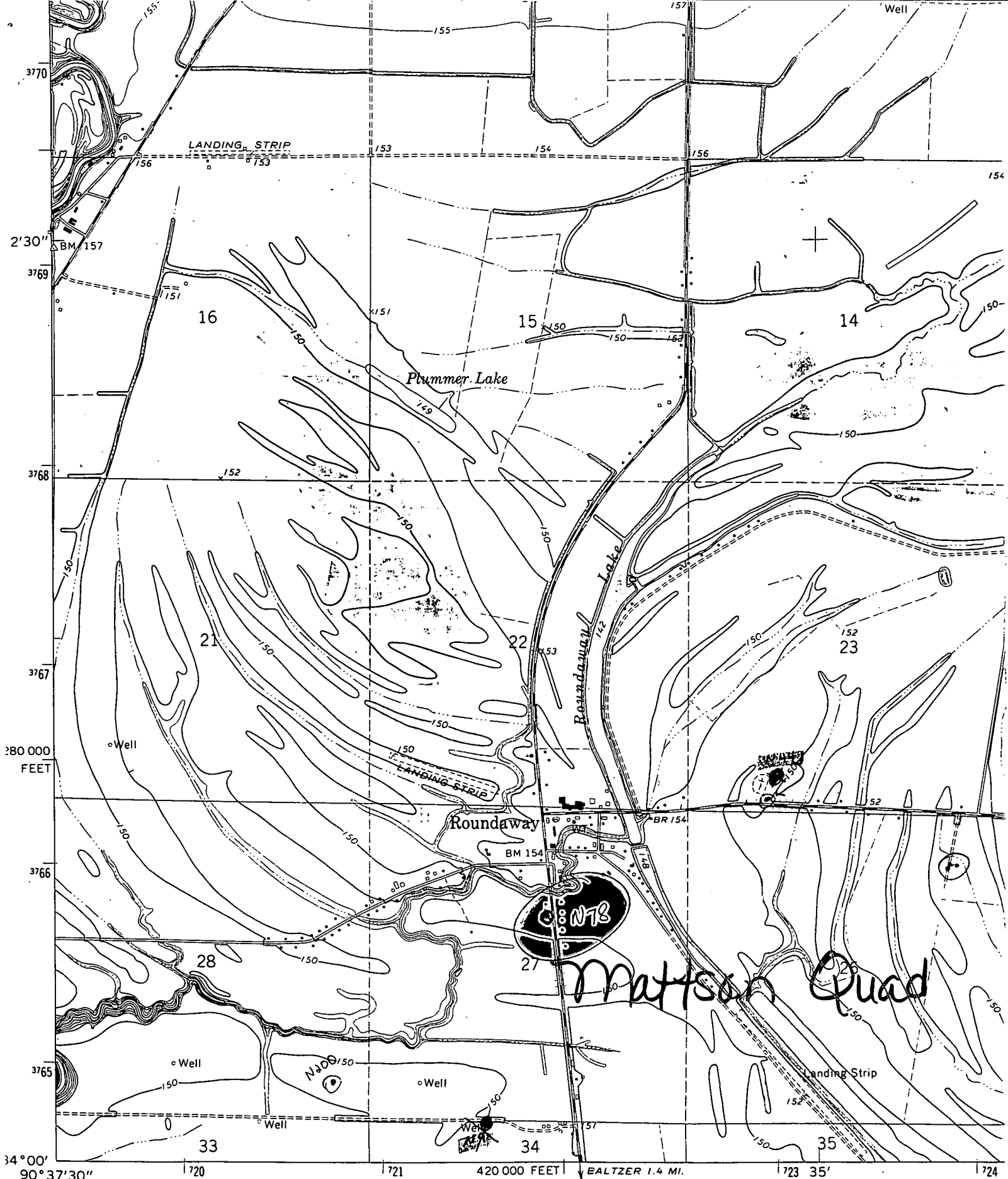

Mapped, edited, and published by the Geological Survey
 Control by USGS and USC&GS
 Planimetry by photogrammetric methods from aerial photographs
 taken 1965. Topography by planetable surveys 1966-67
 Polyconic projection. 1927 North American datum
 10,000-foot grid based on Mississippi coordinate system, west zone
 1000-meter Universal Transverse Mercator grid ticks,

1
 1000
 1
 E

GN
 MN
 5 1/2°
 1° 22' / 24 MILS 98 MILS