

1/81 WTO

GW0459)

Mattson

Recorded by

DMS

U.S. GEOLOGICAL SURVEY  
WATER RESOURCES DIVISION  
MISSISSIPPI DISTRICT  
WELL RECORD

Well No.

N77

Date

1-5-83

Block No.

County

Carroll

Site ID

340355290334701

R=0\*

T=A\*

2=6\*

GEN. SITE DATA

Data reliab.

3=C\*<sup>C</sup>U

Report. agency

4=USGS\*

Dist.

6=28\*

7=28\*

Co.

8=027\*

Lat.

Long.

9=340355\*

10=0903347\*

Well No.

12=N077\*

Location

13=NWSE S 01 T 25 N R 09 W\*

Alt.

16=155 (156.2)

Hyd. Unit (OWDC)

20=

Date

21=01/05/1983\*

Well use

23=W\*

Water Use

24=I\*

Hole depth

27=

Well depth

115.

WL

30=27.\*

Date

31=01/05/1983\*

Source

33=S-

Status

273=

Project No.

OWNER

R=158\*

T=A\*

Date

159#01/05/1983\*

Owner No.

Owner

161#~~UNKN~~

Terry Dulaney Dulaney Brothers Farm

FIELD QW

R=192\*

T=A\*

Date

193#

Temp.

196#00010\*

R=192\*

T=A\*

Date

193#

Cond.

196#00095\*

R=192\*

T=A\*

Date

193#

pH

196#00400\*

CONSTR.

R=58\*

T=A\*

Date

60#01/05/1983\*

Remarks

Drlg.

63=

Name

Method

R\*

Finish

66=S-

CASING

R=76\*

T=A\*

Date

59#1\*

Top csng.

77# 0.\*

Bot. csng.

78=

Diam.

79# 1.2.

R=76\*

T=A\*

Date

59#1\*

Top csng

77#

Bot. csng

78=

Diam.

79#

OPENINGS

R=82\*

T=A\*

Date

59#1\*

Top

83#

Diam.

84=

Type

85=

Diam.

87=

Size

88=

R=82\*

T=A\*

Date

59#1\*

Top

83#

Diam.

84=

Type

85=

Diam.

87=

Size

88=

YIELD

R=146\*

T=A\*

Date

147# 1\*

Q

150=

Q/S

272=

134 flows 146 pumped

**LIFT**  
 R=42\* T= A \* Lift type 43# T\* Intake 44= \* Power type 45= \*

Date 38= 01/05/1983\* H.P. 46= \*

---

**LOGS**  
 R=198\* T= A \* Log 199# \* Top 200= \* Bot 201= \*  
 R=198\* T= A \* Log 199# \* Top 200= \* Bot 201= \*  
 R=189\* T= A \* E Log No. 190# \* 191= M I S S I S T \*

---

**ANAL.**  
 R=114\* T= A \* Year 115# \* 117= \* 120= \*

---

**AQUIFERS**  
 87  
 Unit ID 93= 112ARVA \* Name of Unit  
 R=90\* T= A \* 256# 1 \* Top 91= \* Bot 92= \*  
 Unit ID 93= \* Name of Unit

---

**HYDRAULICS**  
 R=98\* T= A \* 99# 1 \* Unit tested 100= \* 103= \*  
 R=105\* T= A \* 99# 1 \* Test No. 106# \*  
 107= \* Transmissivity (gal/d)/ft  
 108= \* Hydraul. cond. (gal/d)/ft<sup>2</sup>  
 110= \* Storage coeff. Boundaries

---

R=121\* T= \* Yr Begin 122# \* Network 258# \*

Water Level Data Collection (1)

1-5-82  
 WL = 27.37  
 MP = top of casing @ LSD  
 Surveyed 6/8/83  
 to top of casing.  
 EIV = 157.49

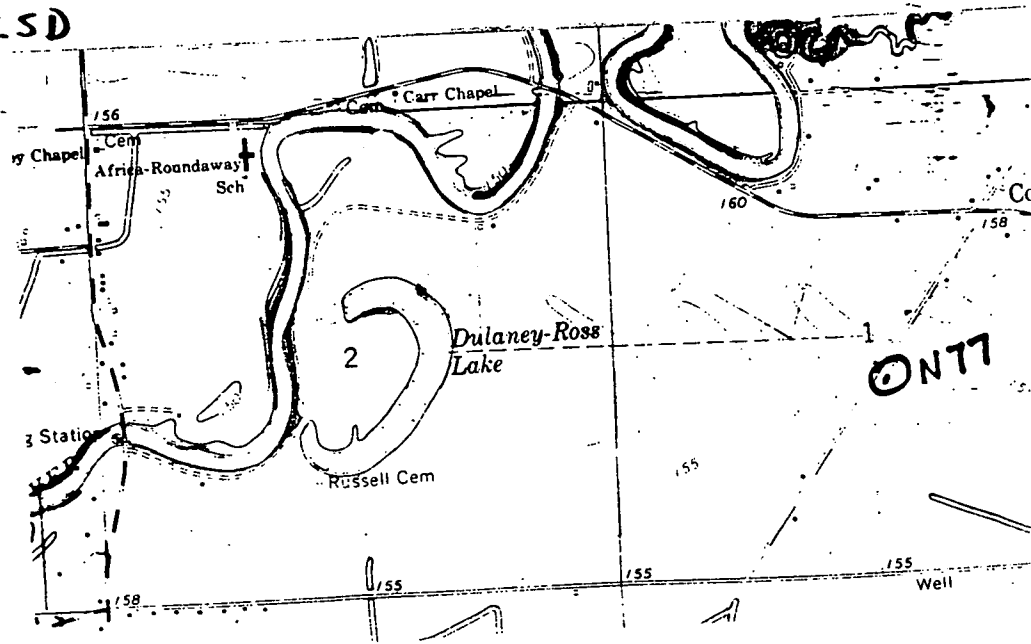

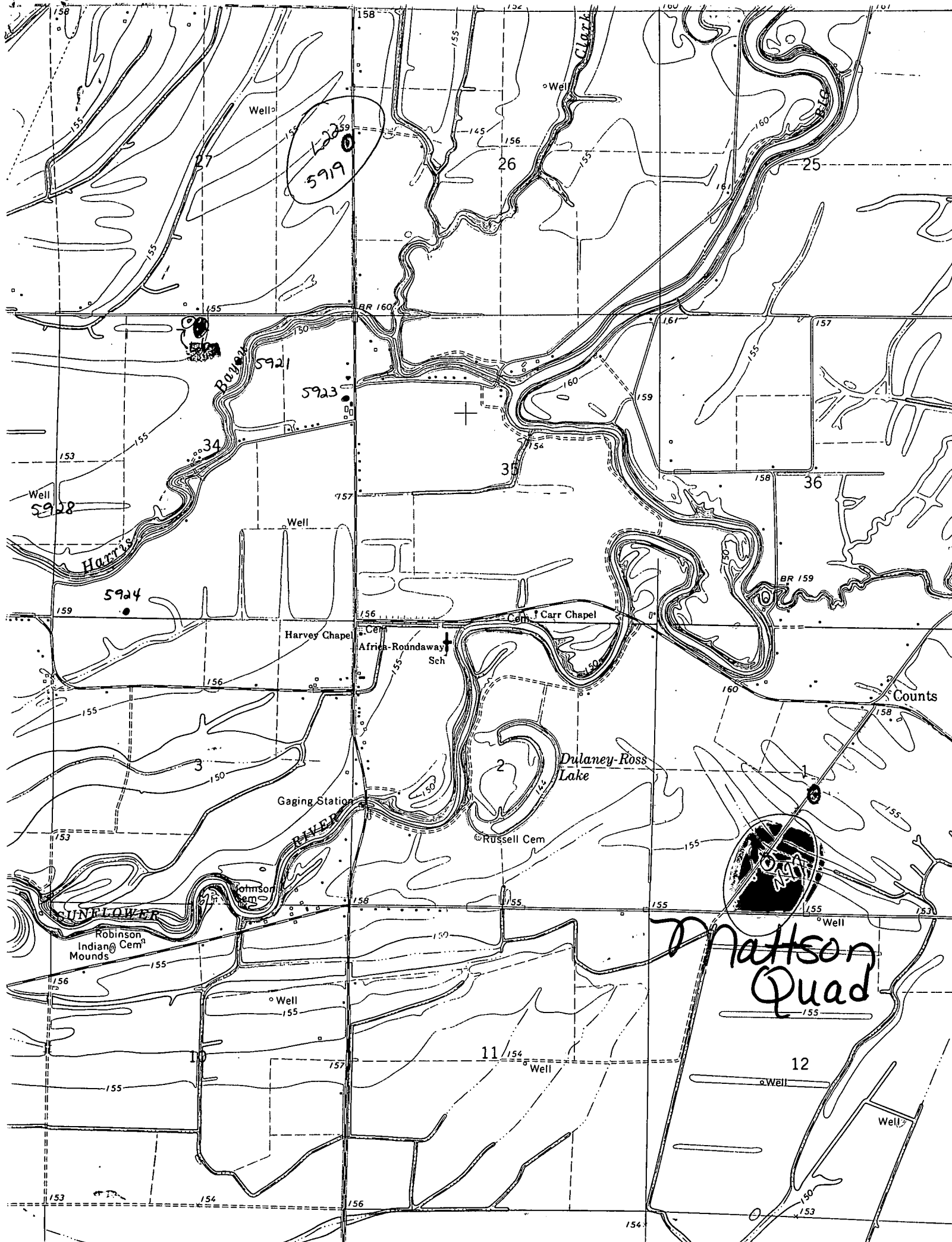

5919

5928

Mattson Quad

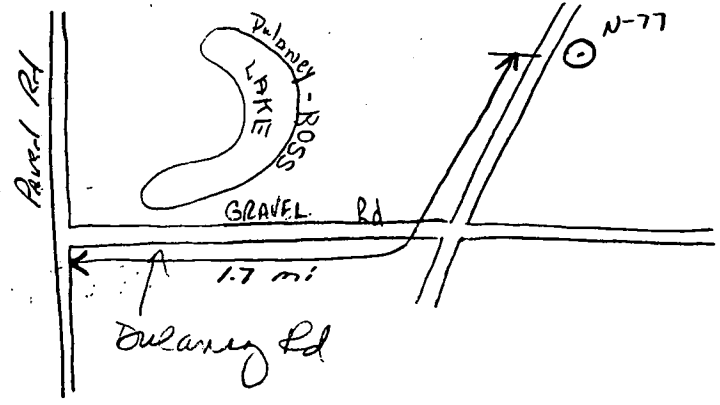

18.071 = 1.14  
MILES PER DAY  
1.1 = 1.25.81