

6/78 WTO

270

Mattson

Recorded by

DJT

U.S. GEOLOGICAL SURVEY
WATER RESOURCES DIVISION
MISSISSIPPI DISTRICT
WELL RECORD

TRANSMITTED FOR ADP.
MATTSON

Well No.

N42

E-Log No.

33

County

CAHOMA

Site ID

3 4 0 3 3 6 0 9 0 3 5 3 7 0 1
5 19

R=0*

T=A *

2=W*

MATTSON
870

Data reliab.

3=C*^CU

Report. agency

4=USGS*

Dist.

6=28*

7=28*

Co.

8=0 2 7 *

Lat.

Long./

9=3 4 0 3 3 6 *

10=0 9 0 3 5 3 7 *

Well No.

12=N 0 4 2 *

Location

13=SESE S 0 3 T 25N R 0 4 W *

Alt.

16=143 *

Hyd. Unit (OWDC)

20=

Date

21=0 2 1 1 1 1 9 8 0 *

Well use

23=W *

Water Use

24=H *

Hole depth

27=7 6 0 . *

Well depth

28=6 3 9 . *

WL

30=5 3 . *

Date

31=1 3 1 0 7 1 1 9 8 0 *

Source

33=D *

Status

273 = *

Project No.

5=SPRT *

158
22
129

R=158*

T=A *

Date

159# 1 3 1 0 7 1 1 9 8 0 *

Owner No.

Well #1

Owner

161=DULANBY FARMS *

WL=24.85 10/2/89

11/25/80
WLLMP=29.92
MP-top of casing 1.6'
WLLSD 25.92

R=192*

T=A *

Date

193# / / / / / *

Temp.

196#00010*

197= . . *

R=192*

T=A *

Date

193# / / / / / *

Cond.

196#00095*

197= . . *

R=192*

T=A *

Date

193# / / / / / *

pH

196#00400*

197= . . *

R=58*

T=A *

59# 1 *

Date

60=1 3 1 0 7 1 1 4 7 8 0 *

Remarks

Drig.

63=2 6 4 *

Name

Berryman

Method

65=H *

Finish

66=S *

R=76*

T=A *

59# 1 *

4" x 2 1/2" drill pipe

Top csgn.

77# 7 . *

Bot. csgn.

78=2 1 0 . *

Diam.

79# 4 . *

R=76*

T=A *

59# 1 *

Top csgn

77# 2 1 0 . *

Bot. csgn.

78=6 0 9 . *

Diam.

79# 2 . 5 *

R=82*

T=A *

59# 1 *

Top

83# 6 0 9 . *

Bottom

84=6 3 9 . *

Type

85=C *

Diam.

87=2 . 5 *

Size

88= . . *

R=82*

T=A *

59# 1 *

Top

83# . . . *

Bottom

84= . . . *

Type

85= . . *

Diam.

87= . . . *

Size

88= . . . *

YIELD

R=146 *

T=A *

147# 1 *

Q

150=1 0 0 . *

Q/S

272= . . . *

134 flows 146 pumped

LIFT

R=42* T= A * Lift type 43# S I * Intake 44= * Power type 45= E *

Date 38= 03/07/1980 * H.P. 46= 5 *

LOGS

R=198* T= A * Log 199# E * Top 200= 20.0 * Bot 201= 76.0 *

R=198* T= A * Log 199# D * Top 200= 0.0 * Bot 201= 76.0 *

R=189* T= A * E Log No. 190# 033 * 191= M I S S D I S T *

ANAL.

R=114* T= A * Year 115# * Type 120= *

AQUIFERS

R=90* T= A * 256# 1 * Top 91= 500.0 * Bot 92= 640.0 *

Unit ID 93= 12AS.P.R.T. * Name of Unit SPARTA

R=90* T= A * 256# 1 * Top 91= * Bot 92= *

Unit ID 93= * Name of Unit

WELL

R=98* T= A * 99# 1 * Unit tested 100= * 103= *

R=105* T= A * 99# 1 * Test No. 106# *

107= * Transmissivity (gal/d)/ft

108= * Hydraulic cond. (gal/d)/ft²

110= * Storage coeff. Boundaries

R=121* T= A * Yr Begin 122# 1980 * Network 258= *

Water Level Data Collection (1)

11/25/80
2892
10124/89
24.85

description of formations encountered	from	to
Clay	0	20
Sand	20	60
Sand & Gravel	60	220
Clay	220	280
Clay & Str. sand	280	300
Shale	300	340
Sand & Str. shale	340	360
le Clay	360	400
Shale	400	430
Sand	430	450
Shale & Str. sand	450	500
Sand	500	640
Sandy shale	640	660
Sand	660	680
Shale	680	760

DATA SHEET-VERIFICATION CHECKLIST

COUNTY COAHOMA

MATTSON QUAD

WELL OWNER DULANEY FARMS (WELL #1)

CHECKED

U.S.G.S. NO. N-42

JWH

B.O.H. NO. _____

OLWR NO. _____

LOCATION:

MAP SE, SW, SE, SE S 3, T 25 N, R 4 W

JWH

GPS _____

ELEV. (MSL) 158'

JWH

W.L. (L.S.) (1) - 38.2' 6-28-95

JWH

(2) - 38.2'

JWH

HEAD (MSL) 119.8'

JWH

SCREENED INTERVAL 609'-639' (LS) / -451' - 481' (MSL)

JWH

AQUIFER VERIFIED SPARTA

JWH

PREVIOUS W.L. -24.85' (10/24/89) | -28.92' (11/25/80) | -23' (3/7/80)

JWH

DATA ENTERED _____

Coahoma
 No 42
 3-7-80

500-695'

MISSISSIPPI
 BOARD OF WATER COMMISSIONERS
 416 North State Street
 Jackson, Mississippi 39201

E Log
 CODED

WATER WELL DRILLERS LOG

March 7 19 80 Bruce Berryman - Coahoma
 date well completed firm name county well located
 Greenwood.

LANDOWNER: Dulaney Farms Rt. 2. Box 140 Clarksdale. MS 38614 (mailing address)	description of formations encountered	from	to
WELL LOCATION: sec. 3 T. 25 N R. E S 4 W 6 miles N.E of Clarksdale (distance) (direction) (nearest town) WELL PURPOSE: Home (home, irrigation, municipal, industrial) WELL COMPLETION DATA: (1) diameter (inches) 4" x 2 1/2" (2) total depth (feet) 639' (3) static water level (feet) 23 below above top of ground. (4) casing 2 1/2" blk Galv - 398 (material) (depth) (size) if telescope see back. (5) screen 30' 609' (length) (depth to top) 2 1/2" .010 Stainless steel (size) (material) (6) pump 5 h.p. 100 (HP) (yield gpm) Electric (type power) (7) electric log Yes (yes or no) MS Geological Survey. (organization running log) (8) how well bottom plugged B.P.V.	Clay	0	20
	Sand	20	60
	Sand & Gravel	60	220
	Clay	220	280
	Clay & Str. sand	280	300
	Shale	300	340
	Sand & Str. shale	340	360
	Clay	360	400
	Shale	400	430
	Sand	430	450
	Shale & Str. sand	450	500
	Sand	500	640
	Sandy shale	640	660
	Sand	660	680
	Shale	680	760

CODED

DEPT. OF NATURAL RESOURCES
 BUREAU OF LAND & WATER RESOURCES

NOV 12 1980

RECEIVED

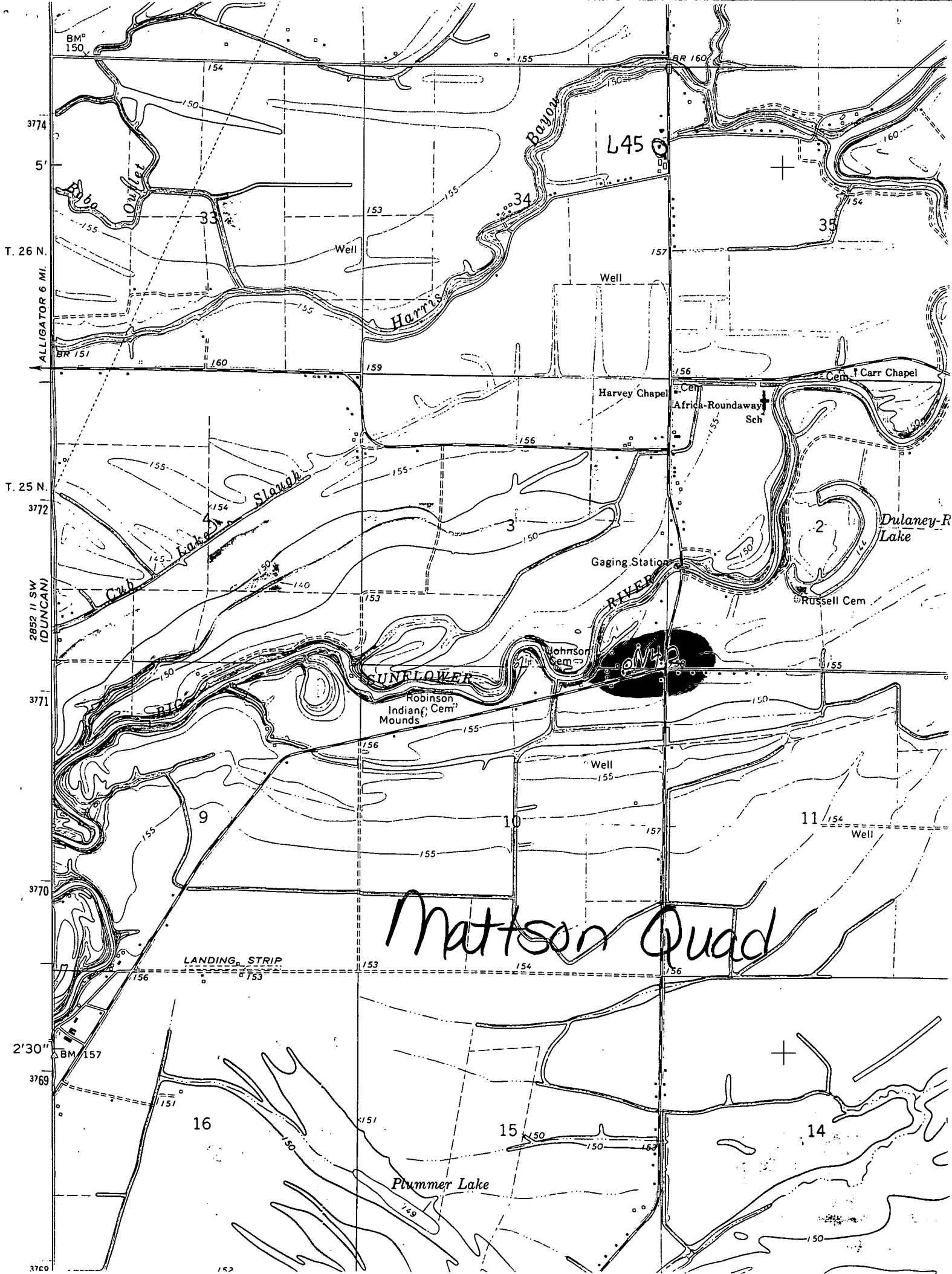

Mattson Quad