

FORM 9-1642 (1-68)

Well No. N9

WELL SCHEDULE

PUNCHED

U. S. DEPT. OF THE INTERIOR

GEOLOGICAL SURVEY

WATER RESOURCES DIVISION
NOV 7 1972

MASTER CARD

Record by JCM Source of data BOWC Date 6-72 Map _____

State 28 County Coahoma (or town) 14

Latitude: 34° 5' 47" N Longitude: 09° 03' 56" W Sequential number: 1

Lat-long accuracy: 5° S, R 4 Sec 34 NE, SE, NW

Local well number: N009 3425N04W Other number: _____ B & M

Local use: 064 Owner or name: JOE R WEEKS Address: Clarksdale

Ownership: County, Fed Gov't, (M) City, Corp or Co, Private, State Agency, Water Dist _____ 10

Use of water: (A) Air cond, Bottling, Comm, Dewater, Power, Fire, Dom, Irr, Med, Ind, P S, Rec, (S) Stock, Instt, Unused, Reppressure, Recharge, Desal-P S, Desal-other, Other _____ 2

Use of well: (A) Anode, Drain, Seismic, Heat Res, Obs, Oil-gas, Recharge, Test, Unused, Withdraw, Waste, Destroyed. (W) _____ W

DATA AVAILABLE: Well data Freq. W/L meas: Field aquifer char.

Hyd. lab. data: _____

Qual. water data; type: _____

Freq. sampling: _____ Pumpage inventory: _____

Aperture cards: _____

Log data: D

WELL-DESCRIPTION CARD

SAME AS ON MASTER CARD Depth well: _____ ft 112 Meas. rept accuracy _____ 3

Depth cased: _____ ft 62 Casing type: STEEL Diam. in 16

Finish: porous concrete, (perf.), (screen), gravel w. gallery, end, (H) open perf., (S) screen, sd. pt., (W) shored, open hole, (X) other _____ S

Method drilled: (A) air bored, (B) cable, (C) dug, (D) hyd jetted, (H) air reverse, (J) percuss, (P) rotary, (R) driven, (T) drive wash, (V) other _____ H

Date drilled: 972 Pump intake setting: _____ ft _____

Driller: Singer-Layne name address _____

Lift (type): (A) air, (B) bucket, (C) cent, (J) multiple, (L) multiple, (M) none, (N) piston, (P) rot, (R) submerg, (S) turb, (T) other _____ T Deep _____ Shallow _____

Power (type): (nat) diesel, (LP) gas, gasoline, hand, gas, wind; H.P. 50 Trans. or meter no. 150

Descrip. MP 150 above ft below LSD, Alt. MP _____

Alt. LSD: _____ Accuracy: _____ 146

Water Level: _____ ft above below MP; _____ ft above below LSD Accuracy: _____ 24

Date meas: 572 Yield: _____ gpm 2400 Method determined _____

Drawdown: _____ ft Accuracy: _____ Pumping period _____ hrs _____

QUALITY OF WATER DATA: Iron _____ ppm Sulfate _____ ppm Chloride _____ ppm Hard. _____ ppm

Sp. Conduct _____ K x 10⁶ Temp. _____ °F Date sampled _____

Taste, color, etc. _____

30
- 0.53
- 0

Well No. N9

Latitude-longitude N
S
d m s d m s

HYDROGEOLOGIC DISTRICT: **033114**

SAME AS ON MASTER CARD

Physiographic Province: _____

Section: **03**

Drainage Basin: **E**

Subbasin: **115H**

Topo of well site: (D) depression, stream channel, dunes, flat, hilltop, sink, swamp, (E) offshore, pediment, hillside, terrace, undulating, valley flat (F) (H) (K) (L) (P) (S) (T) (U) (V)

MAJOR AQUIFER: system _____ series **OG** aquifer, formation, group **MIA**

Lithology: _____ Origin: **2** Aquifer Thickness: **88** ft

Length of well open to: _____ ft **50** Depth to top of: _____ ft **24**

MINOR AQUIFER: system _____ series _____ aquifer, formation, group _____

Lithology: _____ Origin: _____ Aquifer Thickness: _____ ft

Length of well open to: _____ ft _____ Depth to top of: _____ ft _____

Intervals Screened: **16" ARMO**

Depth to consolidated rock: _____ ft _____ Source of data: _____

Depth to basement: _____ ft _____ Source of data: _____

Surficial material: _____ Infiltration characteristics: _____

Coefficient Trans: _____ gpd/ft _____ Coefficient Storage: _____

Coefficient Perm: _____ gpd/ft²; Spec cap: _____ gpm/ft; Number of geologic cards: _____

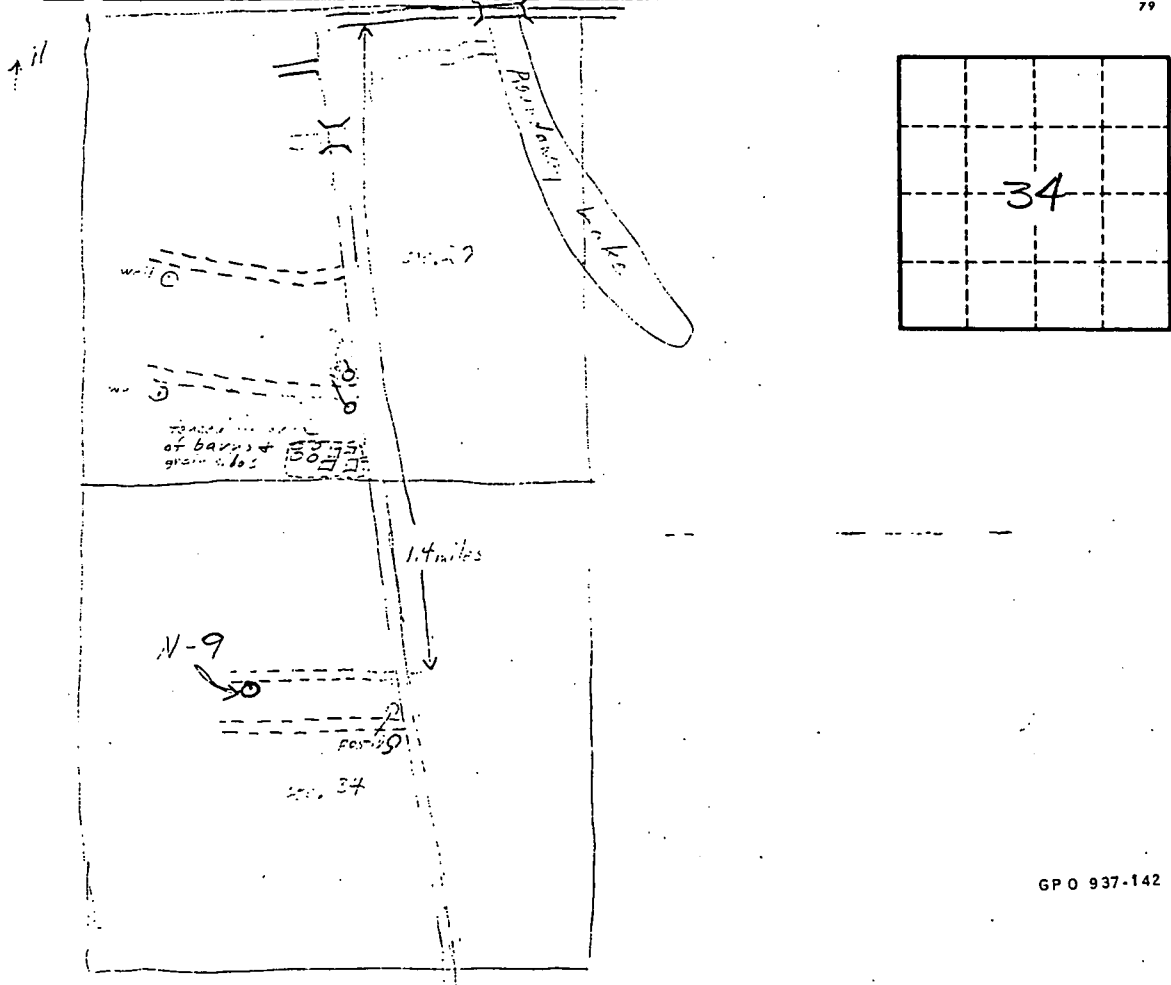

COAHOMA
N9
5-25-72

MISSISSIPPI
 BOARD OF WATER COMMISSIONERS
 416 North State Street
 Jackson, Mississippi 39201

CODED

C14602-3817

WATER WELL DRILLERS LOG

May 25, 1972 SINGER-Layne Central Division Coahoma
 date well completed firm name county well located

LANDOWNER: Joe R. Weeks	description of formations encountered	from	to
Clarksdale, Mississippi			
(mailing address)	Fine sand	24	30
	Sand, med. coarse	30	49
	Coarse sand	49	85
	Coarse sand & pea gravel	85	93
	Coarse sand & gravel	93	108
WELL LOCATION:	Coarse sand & big gravel	108	112
sec. 34 T. 25 N R. 4 W			
_____ miles _____ of Roundaway			
(distance) (direction) (nearest town)			

WELL PURPOSE: Irrigation
 (home, irrigation, municipal, industrial)

- WELL COMPLETION DATA:
- (1) diameter (inches) 16"
 - (2) total depth (feet) 112'
 - (3) static water level (feet) 24' 6" below top of ground
 - (4) casing steel, 67' (material), (depth)
16" (size) if telescope see back.
 - (5) screen 50', 112' (length), (depth to top)
16" (size), Armco (material)
 - (6) pump 50 (HP), 2400 (yield gpm)
engine (type power)
 - (7) electric log no (yes or no)
 _____ (organization running log)
 - (8) how well bottom plugged plate

CODED

JUN 21 1972

MISS. BD. OF
 WATER COM.

DRILLERS REMARKS: _____

GEOLOGICAL SURVEY

90° 37' 30"
34° 00'

720000m.E.

721

CLARKSDALE 15 MI. ↑ 722

723 35'

724

BALTZER QUAD

764000m.N.

T. 25 N.

T. 24 N.

3762

3761

3760

3759

57' 30"



COAHOMA CO
SUNFLOWER CO

Mt Olive Ch
Cem

Baltzer

Baltzer

RESTRICTED

CAMP NO 8