

TRANSMITTED FOR ADP

Coded By Q 8/88
Checked By _____
Entered By _____
Date _____

U.S. GEOLOGICAL SURVEY
WATER RESOURCES DIVISION
MISSISSIPPI DISTRICT

Well No. M29
E-Log No. 45
County COAHOMA
Agency _____

WELL RECORD

Agency Code U S G S	Site Id 14314015141019103101451011	Project No. 51
Station Name 12 MATTISIOINI IGUNI WTR SYS	Latitude 9-34-10 N 15-14 W	Longitude 10-09-10 W 13-10-4 E
Lat/Long Ac. 11 S F T M	Dist 6-28	State 7-28
County 8-012171	Land Net 13 S E N W S I 2 1 8 M Z I 6 N A R I 3 B I W X	
Location Map 14 MATTISIOINI	Altitude 16 11621	Met/Meas 17 A L M
Accuracy 18 15.1	Hydrologic Unit 20-08030210212	
Agency Use 803 A I O	Date Inventoried 711 / / / / /	Station Type Y
Data Type 804		

Instru. 805	Remarks 806	Relia. 3 C L M U	<input checked="" type="checkbox"/> 26
Date of Construction 21-08 / 11-01 / 11-19-88	Well Use 23 W	Water Use 24 P	Primary Aquifer 714 1 1 2 1 4 M U W X
Hole Depth 27 111912	Well Depth 28 11178	Water Level 30 12171	Water Level Date 31-08 / 10-12 / 11-19-89
Method 34 1	Status 37 1	Source 33 D	

CONSTRUCTION DATA

R=58	T=A	723#1	Construction Date 60-08 / 11-15 / 11-19-88	Contractor 63-413151	Name POWELL	Method 65 A	Finish 66 S
------	-----	-------	--	--------------------------------	-----------------------	-----------------------	-----------------------

CONSTRUCTION CASING DATA

R=76	T=A	725#1	59#1	Top/Casing 77 1 1 1 1	Bot/Casing 78 1 1 1 1	Diameter 79 1 1 1
R=76	T=A	725#2	59#1	Top/Casing 77 1 1 1 1	Bot/Casing 78 1 1 1 1	Diameter 79 1 1 1

CONSTRUCTION OPENINGS DATA

R=82	T=A	726#2	59#1	Top/Depth 83 1 1 1 1	Bot/Depth 84 1 1 1 1	Diameter 87 1 1 1	Type 85 S	Length 89 1 1 1	Width 88 1 1 1
R=82	T=A	726#2	59#1	Top/Depth 83 1 1 1 1	Bot/Depth 84 1 1 1 1	Diameter 87 1 1 1	Type 85 1	Length 89 1 1 1	Width 88 1 1 1

CONSTRUCTION LIFT DATA

R=42	T=A	254#1	Lift Type 43 C	Date 38-08 / 11-15 / 11-19-88	Intake 44 1 1 1 1
Power 45 E	H.P. 46 1 5 1 1	Serial No. 49 1 1 1 1 1 1 1 1 1 1 1			

MISCELLANEOUS OWNER DATA

R=158	T=A	718#1	Date of Ownership 159-08 / 11-15 / 11-19-88	Owner Name MR. FLOWERS
161 MATTISIOINI IGUNI WTR SYS				

MISCELLANEOUS OTHER ID DATA

R=189	T=A	736#1	E-Log No. 190-01451	Assigner 191 M I S S I D I S T
-------	-----	-------	-------------------------------	--

MISCELLANEOUS QM DATA

R=	T=	Well #	Date of Measurement	Aquifer Sampled	Par. Code	Value
192	A	738#1	193408 / 1021 / 1191819 *	195-1214 m u w x 1 *	196#00010	1974231401 *
192	A	738#2	1934 / / / / / / / / *	195- / / / / / / / / *	196#00095	1974 / / / / / *
192	A	738#3	193408 / 1021 / 1191819 *	195-1214 m u w x 1 *	196#00400	197471491 *

MISCELLANEOUS LOGS DATA

R=	T=	Well #	Log Type	Beg. Depth	End Depth
198	A	739#1	199#E *	200-1316 *	201-1119121 *
198	A	739#1	199# / *	200- / / / / / *	201- / / / / / *

MISCELLANEOUS NETWORK DATA

R=	T=	Well #	Network Type	Beg. Year	End Year
114	A	730#1	706- / *	1154 / / / / *	1164 / / / / *
R=	T=	Well #	Analysis	Agency Source	Freq.
121	A	730#1	120- / *	1174 / / / / *	118- / *

MISCELLANEOUS REMARKS DATA

R=	T=	Well #	Date of Remarks	Remarks
183	A	311#1	184- / / / / / / / / *	185- *

DISCHARGE DATA

R=	T=	Well #	Date	Value	Unit	Value
146	A	147#1	148408 / 1151 / 1191818 *	703- (P) *	150- / / / / / *	272- / / / / / *

GEOHYDROLOGIC DATA

R=	T=	Well #	Depth Top	Depth Bot.	Unit Id
90	A	721#1	91-1113101 *	92-1118101 *	93-1214 m u w x 1 *

HYDRAULIC DATA

R=	T=	Well #	Unit Tested	Value	Unit
98	A	790#1	100- / / / / / / / / *	103- / *	

Owner Harry Flowers

pH = 7.9
 Fe = .15
 Mn = .018
 TDS = 381

DEPARTMENT OF ENVIRONMENTAL QUALITY - OLWR
PUBLIC SUPPLY WELLS PROJECT

GPS LOG

USER NAME(S): _____ DATE: 9-6-96
UNIT DEQ #: _____ FILE #: A090616B
HEALTH DEPT: #: 140048-01 ELEV. 165
USGS #: M-28 OLWR #: ?
OWNER: Mattson Gin Wtr Assoc
LOCATION: NW, NE, SE S 28 T 26 R 3W COUNTY: Coahoma
LOCATION DESCRIPTION: _____
CASING DIA: _____ PUMP TYPE & SIZE: _____
GPS FIELD LOCATION: LAT. 34.05.825 LONG. 90.30.725
GPS CORRECTED LOCATION: LAT. 34.09773580 LONG. 90.51244052
REMARKS: Mattson quad

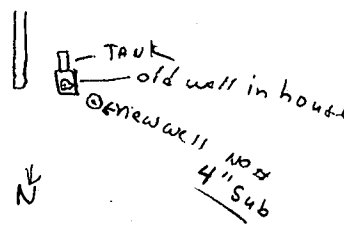

MATTSON QUADRANGLE
 MISSISSIPPI-COAHOMA CO.
 7.5 MINUTE SERIES (TOPOGRAPHIC)
 SE/4 CLARKSDALE 15' QUADRANGLE

2952 III NW
 (SABINO)

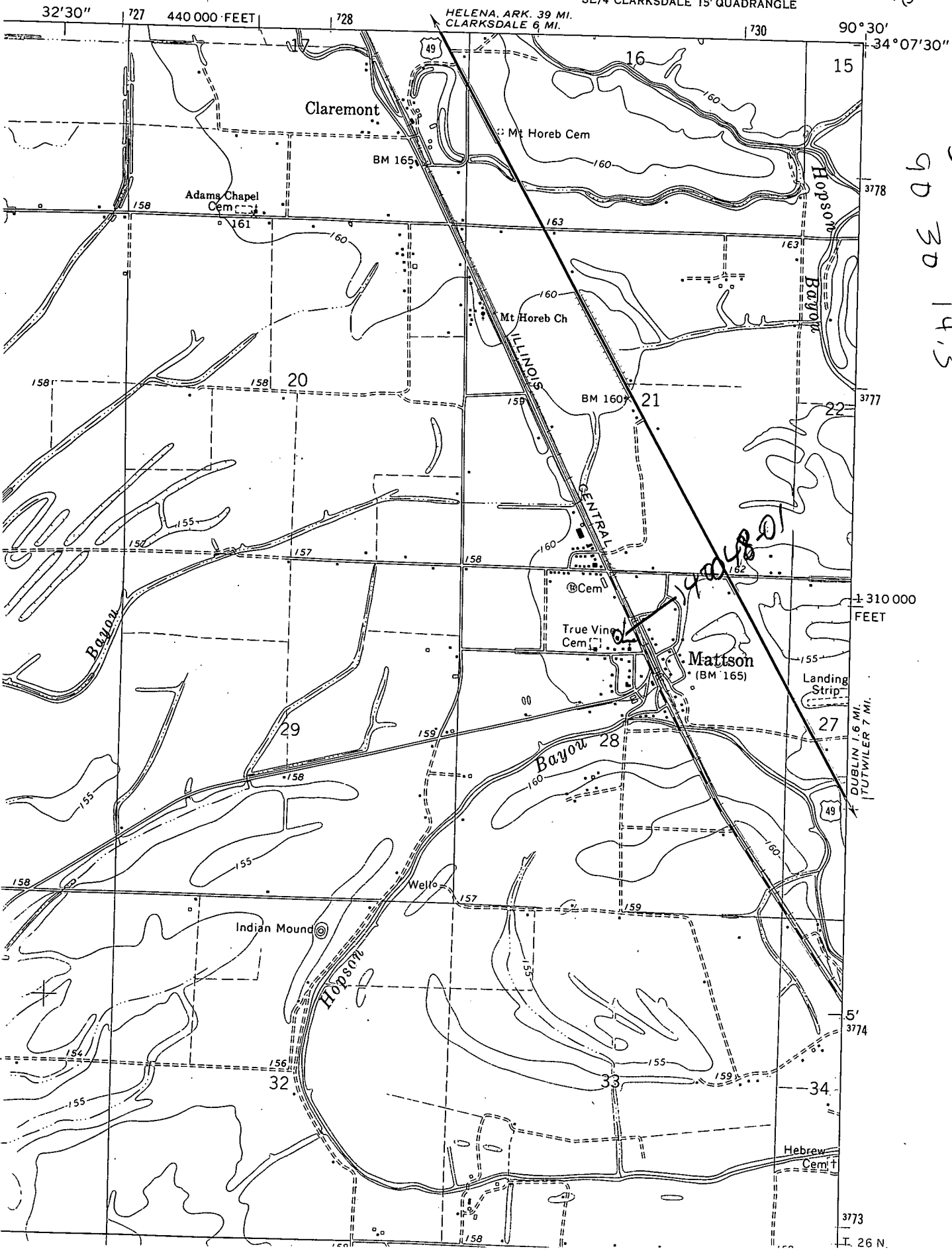

00
 3429
 9D 3D 14.3

10480

± 310 000
 FEET

DUBLIN 1.6 MI.
 TUTWILER 7 MI.

3773
 T. 26 N.