

GW9692 Warksdale

TRANSMITTED FOR ADP

1/81 WTO
Recorded by RAM / J.H.H.
Date 9-15-82

U.S. GEOLOGICAL SURVEY
WATER RESOURCES DIVISION
MISSISSIPPI DISTRICT
WELL RECORD

Well No. L611
E-Log No. 21
County Coahoma

Elev. 157

Site ID 340807090355201 R=0* T=A* 2=W*

Data reliab. 3=C* Report. agency 4-USGS* Dist. 6=28* 7=28* Co. 8=027*

Lat. 9=34.0807* Long. 10=0903552* Well No. 12=L061*

Location 13=SESW 10 T 26 N R 04 W* Alt. 16=157.*

Hyd. Unit (OWDC) 20= Date 21=0911511982*

Well use 23=W* Water Use 24=T* Hole depth 27= Well depth 28=110.*

WL 30=27.* Date 31=0911511982* Source 33=5*

Status 273= Project No. 5=

R=158* T=A* Date 159#0911511982* Owner No. ?

Owner 161#MARYLAND PLANTING
Owner from permit: Williams MS Farms, Inc.

R=192* T=A* Date 193# Temp. 196#00010* 197=

R=192* T=A* Date 193# Cond. 196#00095* 197=

R=192* T=A* Date 193# pH 196#00400* 197=

R=58* T=A* 59#1* Date 60=0110111982* Remarks

Drlg. 63= Name Method 65=R* Finish 66=S*

R=76* T=A* 59#1*

Top csgn. 77# 0.* Bot. csgn. 78= Diam. 79# 8.*

R=76* T=A* 59#1*

Top csgn. 77# Bot. csgn. 78= Diam. 79#

R=82* T=A* 59#1* Top 83# Bottom 84=

Type 85= Diam. 87= Size 88=

R=82* T=A* 59#1* Top 83# Bottom 84=

Type 85= Diam. 87= Size 88=

R= T=A* 147# 1* Q 150= Q/S 272=

134 flows 146 pumped

GEN. SITE DATA
OWNER
FIELD OP
CONSTR.
CASING
OPENINGS
YIELD

LIFT

R=42* T= A * Lift type 43# 7* Intake 44= Power type 45= Date 38= 09/15/1982* H.P. 46=

LOGS

R=198* T= A * Log 199# Top 200= Bot 201= R=198* T= A * Log 199# Top 200= Bot 201= R=189* T= A * E Log No. 190# 191= M I S S D I S T *

ANAL.

R=114* T= A * Year 115# 117= 120=

AQUIFERS

R=90* T= A * 256# 1 * Top 91= Bot 92= Unit ID 93= 112MRVA * Name of Unit R=90* T= A * 256# 1 * Top 91= Bot 92= Unit ID 93= Name of Unit

HYDRAULICS

R=98* T= A * 99# 1 * Unit tested 100= 103= R=105* T= A * 99# 1 * Test No. 106# 107= Transmissivity (gal/d)/ft 108= Hydraul. cond. (gal/d)/ft^2 110= Storage coeff. Boundaries

R=121* T= A * Yr Begin 122# 1982 * Network 258#

Water Level Data Collection (1) to Bellevue

322 - 4 wells

8" casing

Turbine pump

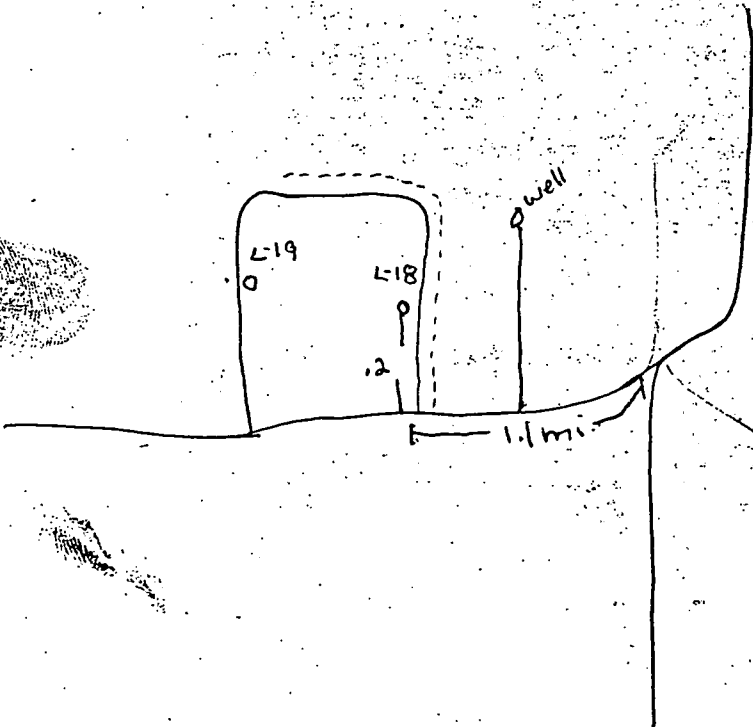

mp .25'
Hdding at 40.00'
cat 12.57'
27.43
mp 25'
27.18'

Es = (+130.57)
129.82

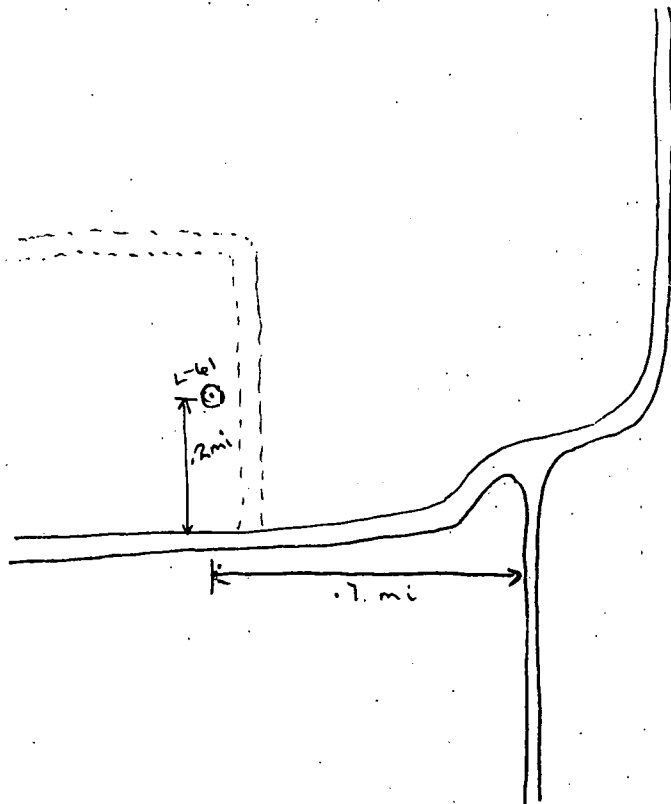

1-1-55
S.A. Johnson

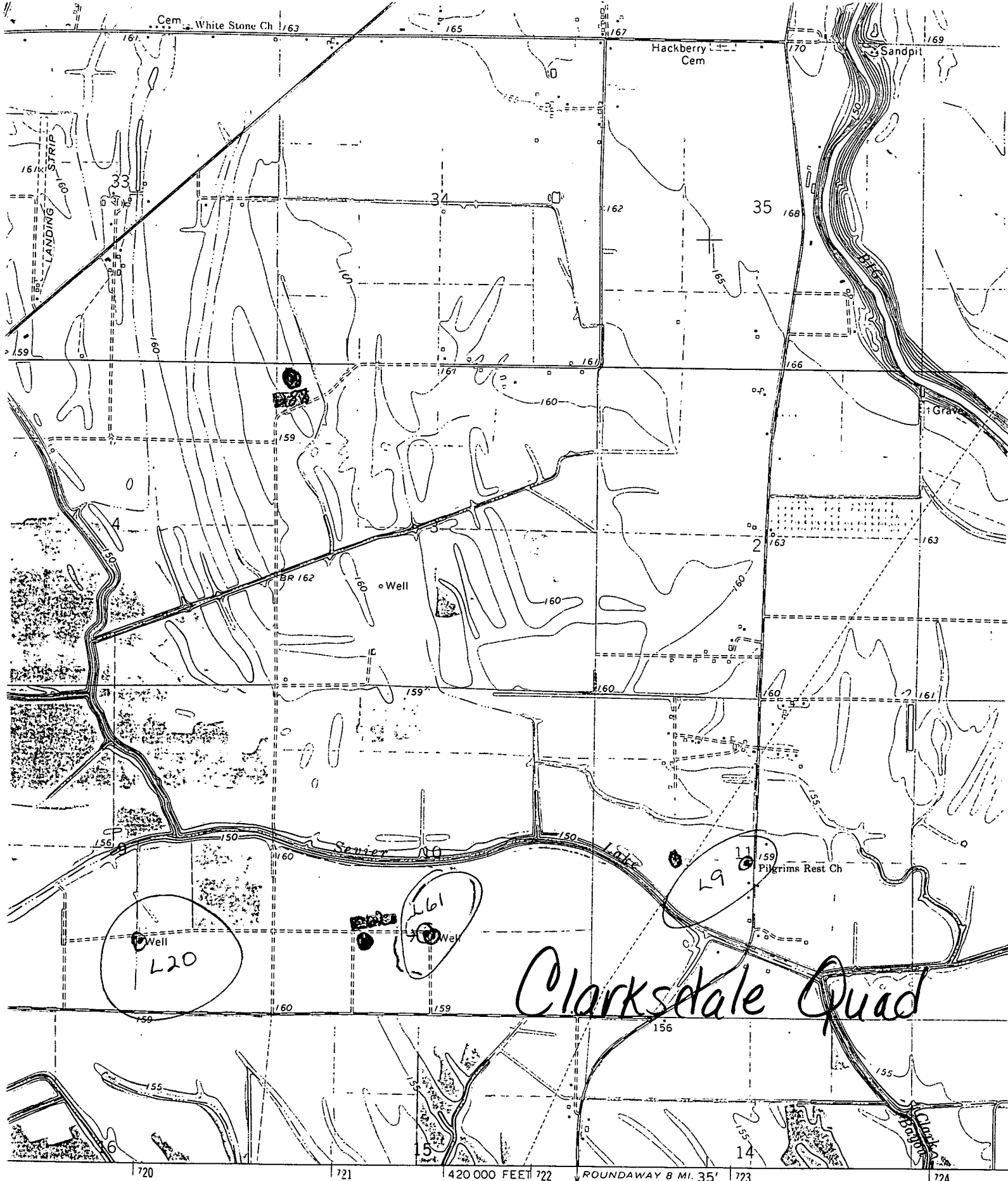

edited, and published by the Geological Survey

USGS and USC&GS

by photogrammetric methods from aerial photographs

5. Topography by planetable surveys 1967

projection. 1927 North American datum
 of grid based on Mississippi coordinate system, west zone
 er Universal Transverse Mercator grid ticks,

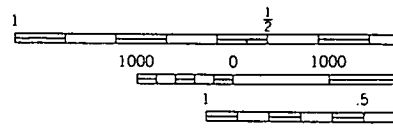
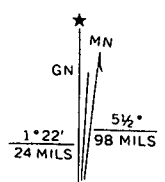

COI
D