

WELL SCHEDULE

PUNCHED

U. S. DEPT. OF THE INTERIOR

GEOLOGICAL SURVEY

WATER RESOURCES DIVISION

DEC 21 1973

MASTER CARD

Record by J.S. Source of data FOWC Date 5/70 Map \_\_\_\_\_  
 State 28 County (or town) Cochama 1:4  
 Latitude: 34° 05' 45" N Longitude: 099° 03' 35" W Sequential number: 1  
 Lat-long accuracy: 3 T. 26 S. R. 4 Sec 27 SE 4 NE 4  
 Local well number: L022AD2726N104W Other number: \_\_\_\_\_ B & M  
 Local use: 068 Owner of name: Andy Parr  
 Owner or name: VIASCOIT Address: Rt 2, Clarkdale  
 Ownership: County, Fed Gov't, City, Corp or Co, Private, State Agency, Water Dist \_\_\_\_\_ W

Use of Air cond, Bottling, Comm, Dewater, Power, Fire, Dom, Irr, Mad, Ind, P S, Rec, \_\_\_\_\_  
 water: (S) (T) (U) (V) (W) (X) (Y) (Z) \_\_\_\_\_ I  
 Stock, Instit, Unused, Repressure, Recharge, Desal-P S, Desal-other, Other \_\_\_\_\_

Use of (A) (D) (G) (H) (I) (P) (R) (T) (U) (V) (X) (Z) \_\_\_\_\_  
 well: Anode, Drain, Seismic, Heat Res, Obs, Oil-gas, Recharge, Test, Unused, Withdraw, Waste, Destroyed. \_\_\_\_\_ W

DATA AVAILABLE: Well data  Freq. W/L meas:  Field aquifer char.   
 Hyd. lab. data: \_\_\_\_\_  
 Qual. water data; type: \_\_\_\_\_  
 Freq. sampling: \_\_\_\_\_ Pumpage inventory: yes  no  period: \_\_\_\_\_  
 Aperture cards: \_\_\_\_\_ yes  no   
 Log data: \_\_\_\_\_ D

water level  
9-15-70  
MLP

30.0  
-1.14  
-1.10  
27.76

WELL-DESCRIPTION CARD

SAME AS ON MASTER CARD Depth well: \_\_\_\_\_ ft Meas. \_\_\_\_\_  
 Depth cased: \_\_\_\_\_ ft Casing type: Pipe Diam. \_\_\_\_\_ in  
 Finish: (C) porous concrete, (F) gravel w. (G) gravel w. (H) horiz. gallery, (I) open perf., (S) screen, (T) sd. pt., (W) shored, (X) open hole, (Z) other \_\_\_\_\_ S  
 Method: (A) air rot, (B) bored, (C) cable, (D) dug, (H) hyd jetted, (J) air rot., (P) percussion, (R) rotary, (T) reverse, (V) trenching, (W) driven, (Z) drive wash, other \_\_\_\_\_ H  
 Date Drilled: 9-7-70 Pump intake setting: \_\_\_\_\_ ft  
 Driller: \_\_\_\_\_ name \_\_\_\_\_ address \_\_\_\_\_  
 Lift (type): (A) air, (B) bucket, (C) cent, (J) jet, (L) multiple, (M) multiple, (N) none, (P) piston, (R) rot, (S) submerg, (T) turb, other \_\_\_\_\_ Deep  Shallow   
 Power (type): diesel, elec, gas, gasoline, hand, gas, wind; H.P. Tractor Trans. or meter no. \_\_\_\_\_  
 Descrip. MP \_\_\_\_\_ above \_\_\_\_\_ ft below LSD, Alt. MP \_\_\_\_\_

this is an open casing 35' from edge of road.  
new 12" well is 50' from edge of road.

Alt. LSD: \_\_\_\_\_ Accuracy: \_\_\_\_\_  
 Water Level 19 ft above below MP; Ft below LSD \_\_\_\_\_ Accuracy: \_\_\_\_\_  
 Date meas: 4-7-70 Yield: \_\_\_\_\_ gpm Method determined \_\_\_\_\_  
 Drawdown: \_\_\_\_\_ ft Accuracy: \_\_\_\_\_ Pumping period \_\_\_\_\_ hrs  
 QUALITY OF WATER DATA: Iron \_\_\_\_\_ ppm Sulfate \_\_\_\_\_ ppm Chloride \_\_\_\_\_ ppm Hard. \_\_\_\_\_ ppm  
 Sp. Conduct \_\_\_\_\_ K x 10<sup>6</sup> Temp. \_\_\_\_\_ °F Data sampled \_\_\_\_\_  
 Taste, color, etc. \_\_\_\_\_

15  
12

Well No.

L 22

Well No. L 22

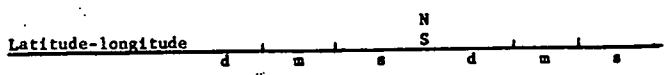

### HYDROGEOLOGIC CARD

SAME AS ON MASTER CARD      Physiographic Province: \_\_\_\_\_      Section: 0.3

E Drainage Basin: 1.5.4      Subbasin: 24

Topo of well site: (D) depression, stream channel, dunes, flat, hilltop, sink, swamp,      (K) (L)      27

(Q) (P) (S) (T) (U) (V) offshore, pediment, hillside, terrace, undulating, valley flat

MAJOR AQUIFER: system \_\_\_\_\_ series 0.6      aquifer, formation, group MIA

Lithology: R      Origin: 2      Aquifer Thickness: 90 ft

Length of well open to: \_\_\_\_\_ ft      4.8      Depth to top of: \_\_\_\_\_ ft      2.1

MINOR AQUIFER: system \_\_\_\_\_ series \_\_\_\_\_      aquifer, formation, group \_\_\_\_\_

Lithology: \_\_\_\_\_      Origin: \_\_\_\_\_      Aquifer Thickness: \_\_\_\_\_ ft

Length of well open to: \_\_\_\_\_ ft      \_\_\_\_\_      Depth to top of: \_\_\_\_\_ ft      \_\_\_\_\_

Intervals Screened: 6" Doerr.

Depth to consolidated rock: \_\_\_\_\_ ft      \_\_\_\_\_      Source of data: \_\_\_\_\_

Depth to basement: \_\_\_\_\_ ft      \_\_\_\_\_      Source of data: \_\_\_\_\_

Surficial material: \_\_\_\_\_      Infiltration characteristics: \_\_\_\_\_

Coefficient Trans: \_\_\_\_\_ gpd/ft      \_\_\_\_\_      Coefficient Storage: \_\_\_\_\_

Coefficient Perm: \_\_\_\_\_ gpd/ft<sup>2</sup>; Spec cap: \_\_\_\_\_      gpm/ft; Number of geologic cards: \_\_\_\_\_

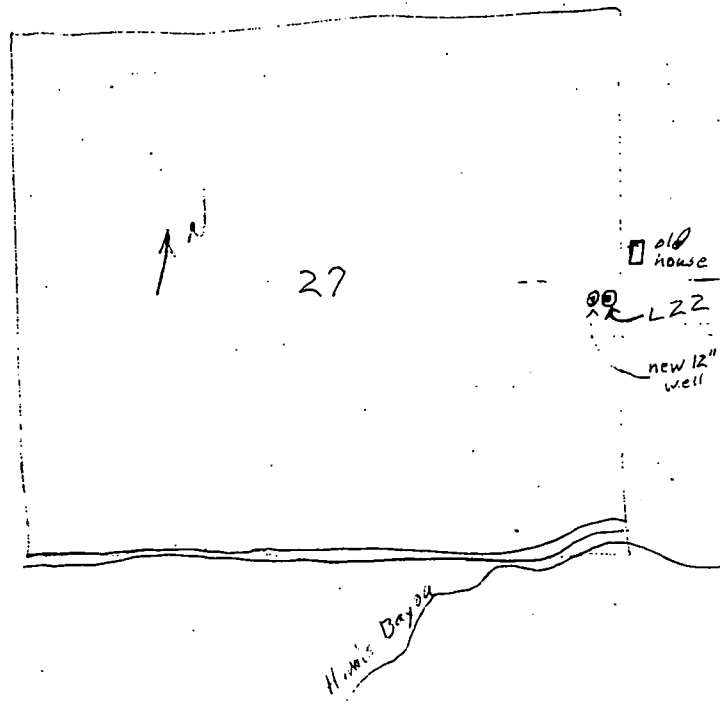
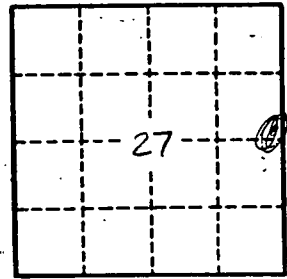

Well No.

L 22

~~60577-?~~  
NE/SE, Sec. 27, T26N, R4W

Elev. 157

Coahoma

L22

4-20-70

MISSISSIPPI  
BOARD OF WATER COMMISSIONERS  
416 North State Street  
Jackson, Mississippi 39201

**CODED**

WATER WELL DRILLERS LOG

4-20-70 date well completed  
19 Five County Farmers firm name  
Coahoma county well located

LANDOWNER: <u>Meat Pt.</u>	description of formations encountered	from	to
<u>Andy Carr</u>			
<u>Rt 3, Clarkdale, Miss.</u> (mailing address)	<u>Clay</u>		<u>21</u>
	<u>Sand</u>	<u>21</u>	<u>47</u>
	<u>Sand + gravel</u>	<u>47</u>	<u>53</u>
	<u>Sand</u>	<u>53</u>	<u>60</u>
	<u>Sand, gravel - Wood</u>	<u>60</u>	<u>66</u>
	<u>Sand + gravel</u>	<u>66</u>	<u>111</u>
WELL LOCATION: sec. <u>27</u> T- <u>26</u> S R- <u>4</u> E <u>068</u> <u>7</u> miles <u>South</u> of <u>Clarksdale</u> (distance) (direction) (nearest town)			
WELL PURPOSE: <u>irrigation</u> (home, irrigation, municipal, industrial)			
WELL COMPLETION DATA: (1) diameter (inches) <u>6</u> (2) total depth (feet) <u>111</u> (3) static water level (feet) <u>19</u> below above top of ground. (4) casing <u>Pipe</u> , <u>63</u> (material) (depth) <u>6"</u> (size) If telescope see back. (5) screen <u>48</u> , <u>63</u> (length) (depth to top) <u>6</u> (size) <u>Screen</u> (material) (6) pump <u>1/2 hp</u> , <u>1300</u> (HP) (yield gpm) <u>Proctor</u> (type power) (7) electric log <u>no</u> (yes or no) (organization running log) (8) how well bottom plugged <u>Wellhead</u>			
DRILLERS REMARKS:			

**CODED**

MAY 11 1970

MISS. BD. OF  
STATE COMMISSIONERS

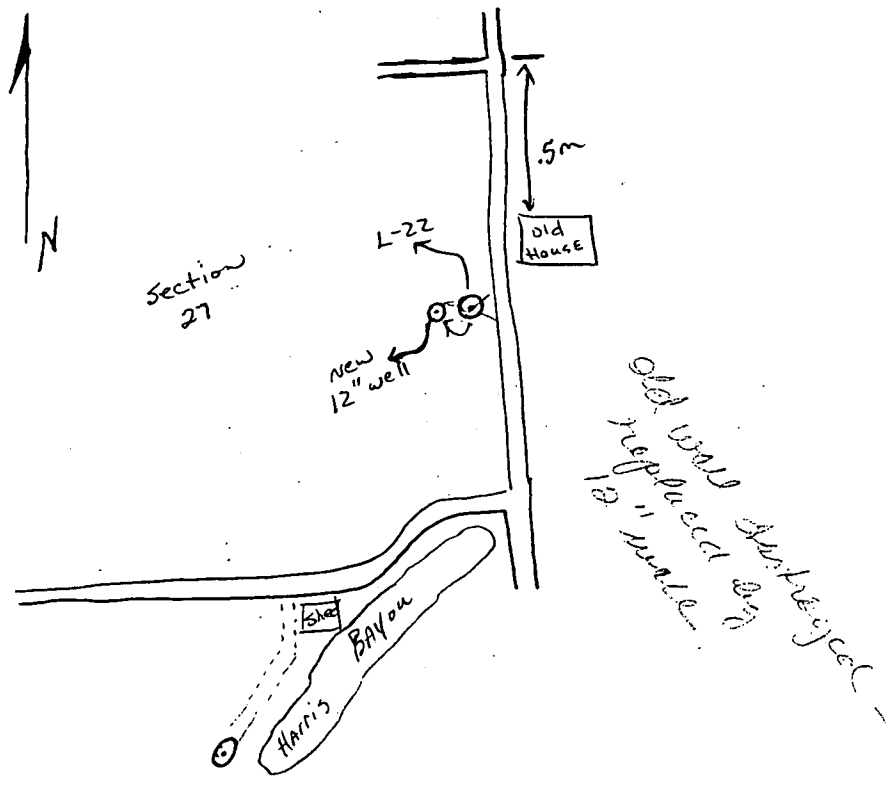

3778000m.N.

3777

4.2 MI. TO U.S. 61

3775

3774

5'

T. 26 N.

BR 151

T. 25 N.

3772

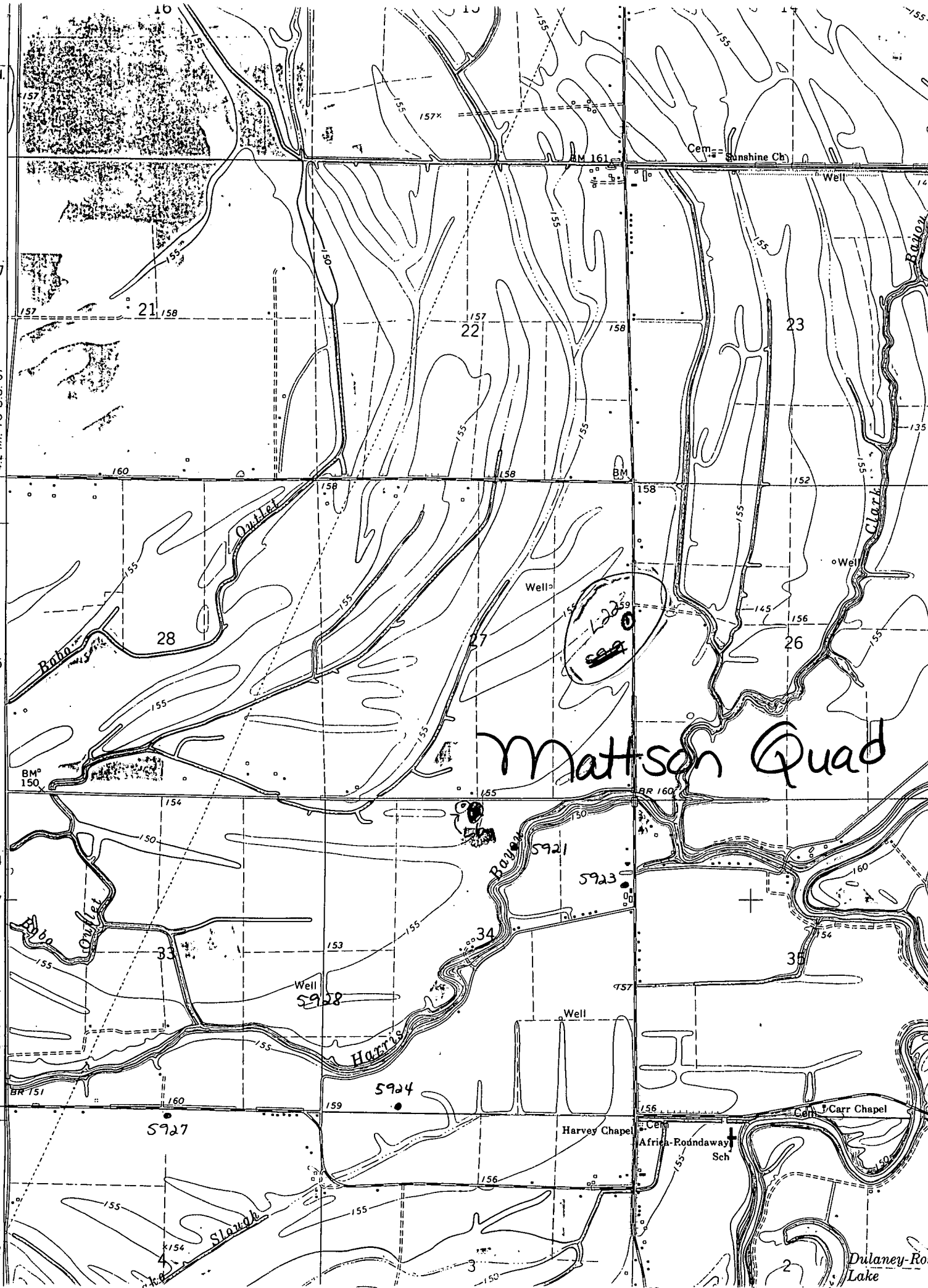

Mattson Quad

5921

5923

34

Well 5928

5924

5927

Harvey Chapel

Cem Africa-Roundaway Sch

Well

Cem Carr Chapel

Dulaney-Ross Lake