

WELL SCHEDULE

U. S. DEPT. OF THE INTERIOR

GEOLOGICAL SURVEY

WATER RESOURCES DIVISION

PUNCHED
OCT 30 1973

MASTER CARD

Record by EJL Source of data Date 7-11 Map

State County (or town) Cochise 14

Latitude: 34 05 12 N Longitude: 09 03 01 Sequential number: 1

Lat-long accuracy: 2 26 4 E Sec 34 , NE NE NW

Local well number: L006AB3421V04W Other number:

Local use: 068 Owner or name:

Owner or name: AUDY CARR Address:

Ownership: County, Fed Gov't, City, Corp or Co, Private, State Agency, Water Dist.

Use of Air cond, Bottling, Comm, Dewater, Power, Fire, Dom, Irr, Med, Ind, P S, Rec, water:

Use of Anode, Drain, Seismic, Heat Res, Obs, Oil-gas, Recharge, Test, Unused, Withdraw, Waste, Destroyed. well:

DATA AVAILABLE: Well data Freq. W/L meas.: Field aquifer char.

Hyd. lab. data:

Qual. water data; type:

Freq. sampling: Pumpage inventory: yes, period:

Pressure cards: yes

Log data: D

WELL-DESCRIPTION CARD

SAME AS ON MASTER CARD Depth well: ft 110 Meas. rept accuracy

Depth cased; (first perf.) ft 100 Casing type: ; Diam. in

Finish: porous concrete, gravel w. (perf.), gravel w. (screen), horiz. gallery, open end, perf., screen, sd. pt., shored, open hole, other

Method Drilled: air bored, cable, dug, hyd jetted, air rot., reverse percussion, rotary, driven, drive wash, other

Date Drilled: 1-23 Pump intake setting: ft

Driller: Tim County Trenching Assoc. address

Lift (type): air, bucket, cent, jet, multiple, (cent.) (turb.) none, piston, rot, submerg, turb, other Deep Shallow

Power (type): diesel, elec, gas, gasoline, hand, gas, wind; H.P. 70 Trans. or meter no. U

Descrip. MP ft above below LSD, Alt. MP

Alt. LSD: Accuracy: (source)

Water Level: ft above below MP; Ft below LSD 27 Accuracy:

Date meas: 5-25 Yield: gpm Method determined

Drawdown: ft Accuracy: Pumping period hrs

QUALITY OF WATER DATA: Iron ppm Sulfate ppm Chloride ppm Hard. ppm

Sp. Conduct K x 10 Temp. °F Date sampled

Taste, color, etc.

Latitude-longitude _____ N
S
d m s d m s

HYDROGEOLOGIC CARD

SAME AS ON MASTER CARD

Physiographic Province: 173 Section: _____

Drainage Basin: 15 Subbasin: _____

Topo of well site: (D) depression, stream channel, dunes, flat, hilltop, sink, swamp, (E) offshore, pediment, hillside, terrace, undulating, valley flat
(C) (F) (H) (K) (L)
(P) (S) (T) (U) (V)

MAJOR AQUIFER: system _____ series 173 aquifer, formation, group 174

Lithology: _____ Origin: _____ Aquifer Thickness: _____ ft

Length of well open to: _____ ft Depth to top of: _____ ft

MINOR AQUIFER: system _____ series _____ aquifer, formation, group _____

Lithology: _____ Origin: _____ Aquifer Thickness: _____ ft

Length of well open to: _____ ft Depth to top of: _____ ft

Intervals Screened: _____

Depth to consolidated rock: _____ ft Source of data: _____

Depth to basement: _____ ft Source of data: _____

Surficial material: _____ Infiltration characteristics: _____

Coefficient Trans: _____ gpd/ft Coefficient Storage: _____

Coefficient Perm: _____ gpd/ft²; Spec cap: _____ gpm/ft; Number of geologic cards: _____

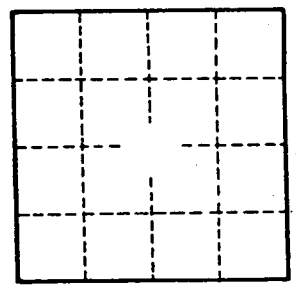

Well No.

COAHOMA MISSISSIPPI BOARD OF WATER COMMISSIONERS

L 6

6-17-63

WATER WELL DRILLERS LOG

CODED

Date: 6-17, 1963, Driller: Five County Farm county Coahoma
(Name)

		Description & Color of Materials Sand, Clay, Red Clay, Shell, etc.	Thick- ness Feet	Depth Feet
(1) Owner of Land: <u>Geedy Carr</u> (Name)				
<u>Chickadee Miss</u> (Address)		<u>Gumbo</u>	<u>0 1/2</u>	
(2) Location: <u>1/4</u> , <u>1/4</u> , Sec. <u>23</u> T <u>26</u> R <u>4</u> ,		<u>FINE SAND + GUMBO</u>	<u>1 1/2</u>	<u>27 1/2</u>
<u>5</u> miles <u>South</u> of <u>Chickadee</u> (distance) (direction) (Nearest Town)		<u>BLUE MUD</u>	<u>27 1/2</u>	<u>50</u>
(3) Topography: <input checked="" type="checkbox"/> (Hilly) <input type="checkbox"/> (Flat) <input type="checkbox"/> (Level)		<u>SAND, ROCK, +</u>		
(4) Purpose of Well: <u>Irrigation</u> (Domestic, Irrigation, Municipal, Industrial, Other)		<u>GRAVEL</u>	<u>50</u>	<u>110</u>

CODED

Information upon completion of well:

- (1) Diameter 14 inches.
- (2) Total Depth 110 feet.
- (3) Water Level 21' feet below top of ground.
- (4) Cased to 60', Size 14"
- (5) Screen: Size 48', Length 16
- (6) Were any formations sealed against pollution?
_____ yes, 2 no.

If YES depth of formation _____

Why _____

Drillers Remarks: AD

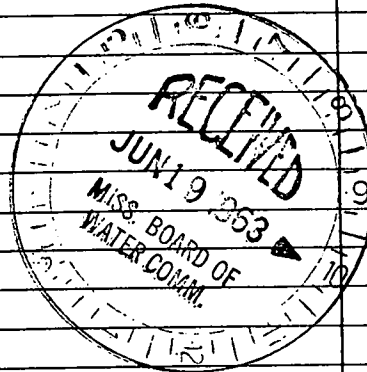

Well No.

(Use Back Side)

Mail this copy to Board of Water Commissioners 429 Miss. St. Jackson, Miss

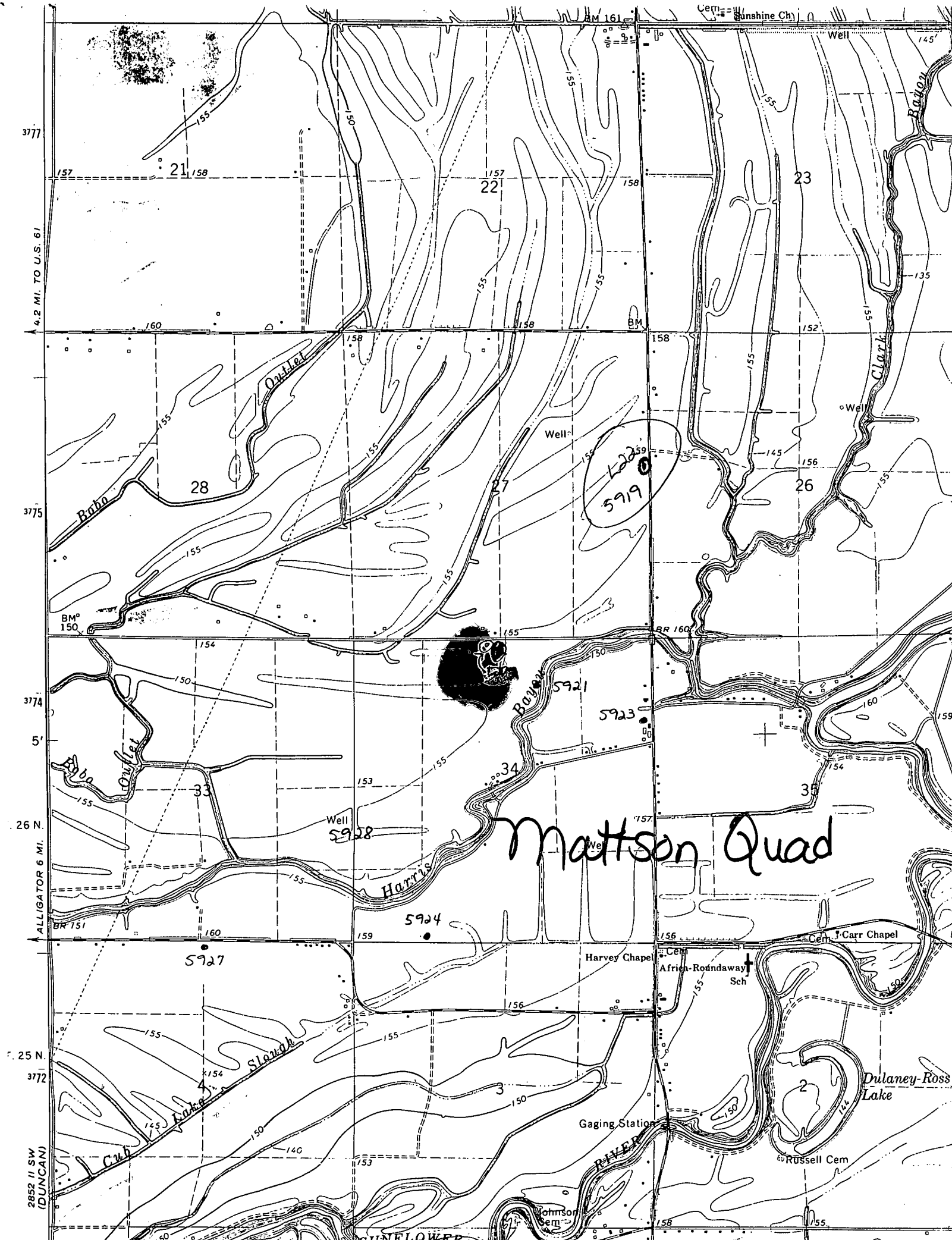

3777
4.2 MI. TO U.S. 61

3775

3774

26 N.

ALLIGATOR 6 MI.

25 N.

3772
2852 II SW (DUNCAN)

Mattson Quad

BM 161
Sunshine Ch
Well

157 21 158

157 22

23

28

27

26

5921

5923

Well
5928

33

34

35

5924

5927

Harvey Chapel

Africa-Roundaway Sch

Carr Chapel

Slough

Gaging Station

Dulaney-Ross Lake

Russell Cem

Johnson Cem

SUNFLOWER