

9-185  
(October 1950)

UNITED STATES  
DEPARTMENT OF THE INTERIOR  
GEOLOGICAL SURVEY  
WATER RESOURCES DIVISION

WELL SCHEDULE

Date 4/17/60, 19\_\_\_\_ Field No. \_\_\_\_\_  
Record by B. E. Watson Office No. L3  
Source of data B. P. Rose clerk

1. Location: State Miss County Coshona

Map Clarkdale 26  
SW 1/4 SW 1/4 sec. 5 T 29 N 4 E  
S R 2 W

2. Owner: Texas Gas Trans Co. #2 Address Clarkdale sta

Tenant C. Dale Comp. Sta. Address \_\_\_\_\_

Driller Robert Rattiff Address Greenville

3. Topography \_\_\_\_\_

4. Elevation 160 ft. above topo  
\_\_\_\_\_ ft. below \_\_\_\_\_

5. Type: Dug, drilled, driven, bored, jetted Jan 1956

6. Depth: Rept. 760 ft. Meas. \_\_\_\_\_ ft.

7. Casing: Diam. 6 in., to \_\_\_\_\_ in., Type \_\_\_\_\_  
Depth \_\_\_\_\_ ft., Finish \_\_\_\_\_

8. Chief Aquifer \_\_\_\_\_ From \_\_\_\_\_ ft. to \_\_\_\_\_ ft.  
Others \_\_\_\_\_

9. Water level 20 ft. rept. mas 1956 above  
\_\_\_\_\_ below \_\_\_\_\_  
\_\_\_\_\_ which is \_\_\_\_\_ ft. above  
\_\_\_\_\_ below surface

10. Pump: Type Lucas turbine Capacity \_\_\_\_\_ G. M.

Power: Kind \_\_\_\_\_ Horsepower 20

11. Yield: Flow \_\_\_\_\_ G. M., Pump 428 or 30 G. M., Meas., Rept. Est. \_\_\_\_\_

Drawdown 27.9 ft. after \_\_\_\_\_ hours pumping \_\_\_\_\_ G. M.

12. Use: Dom. Stock, PS., RR., Ind. Irr., Obs. \_\_\_\_\_

Adequacy, permanence \_\_\_\_\_

13. Quality \_\_\_\_\_ Temp 70 °F.

Taste, odor, color \_\_\_\_\_ Sample Yes \_\_\_\_\_ No \_\_\_\_\_

Unfit for \_\_\_\_\_

14. Remarks: (Log, Analyses, etc.) Specific yield 16.6 gal/ft

5000 gal automatic tank in storage

750 gal automatic tank in storage

8500 gal automatic tank in storage

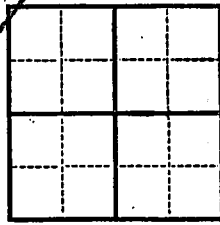

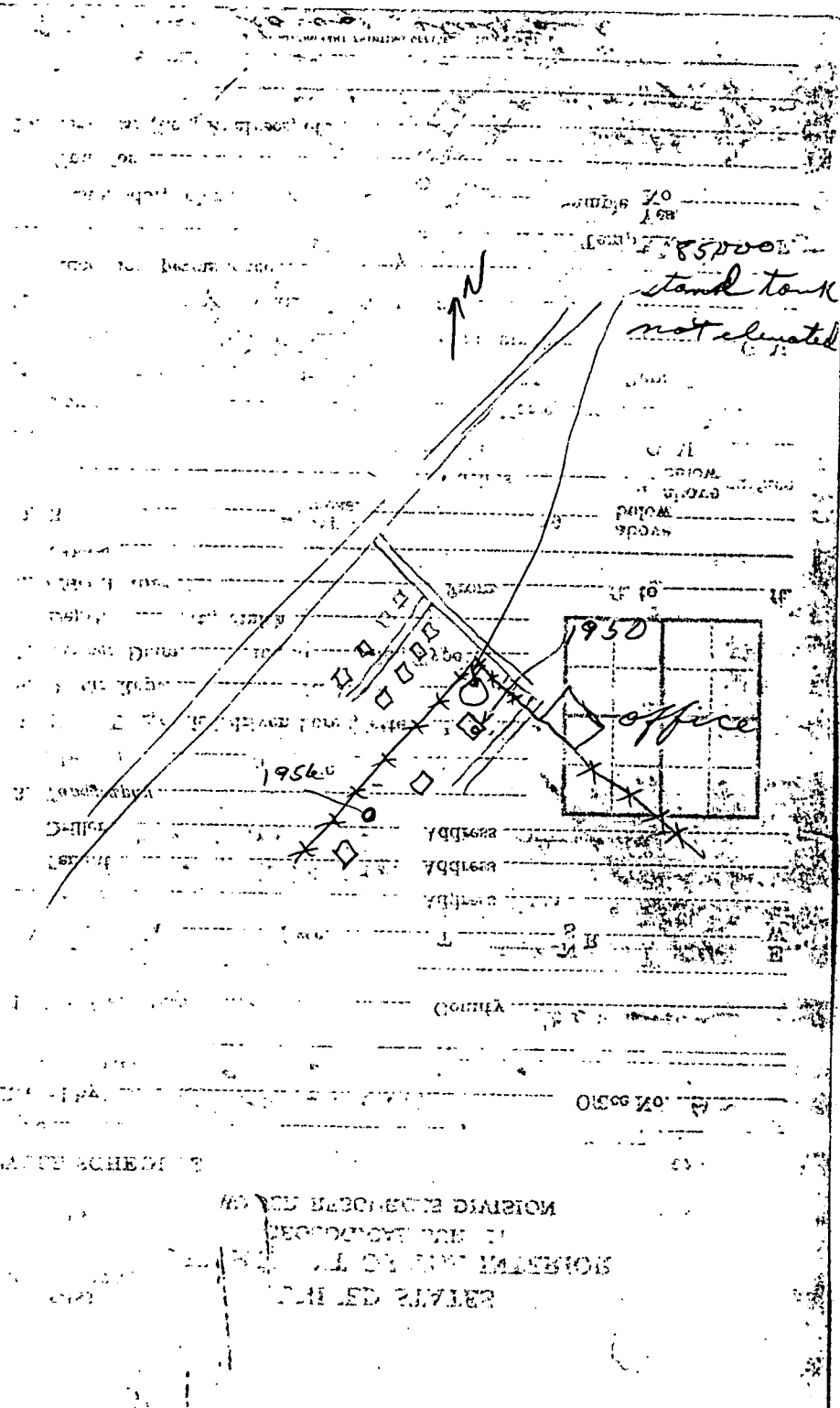

stand tank  
not elevated



1956

RECORDS DIVISION  
OFFICE OF THE COMMISSIONER OF THE GENERAL LAND OFFICE

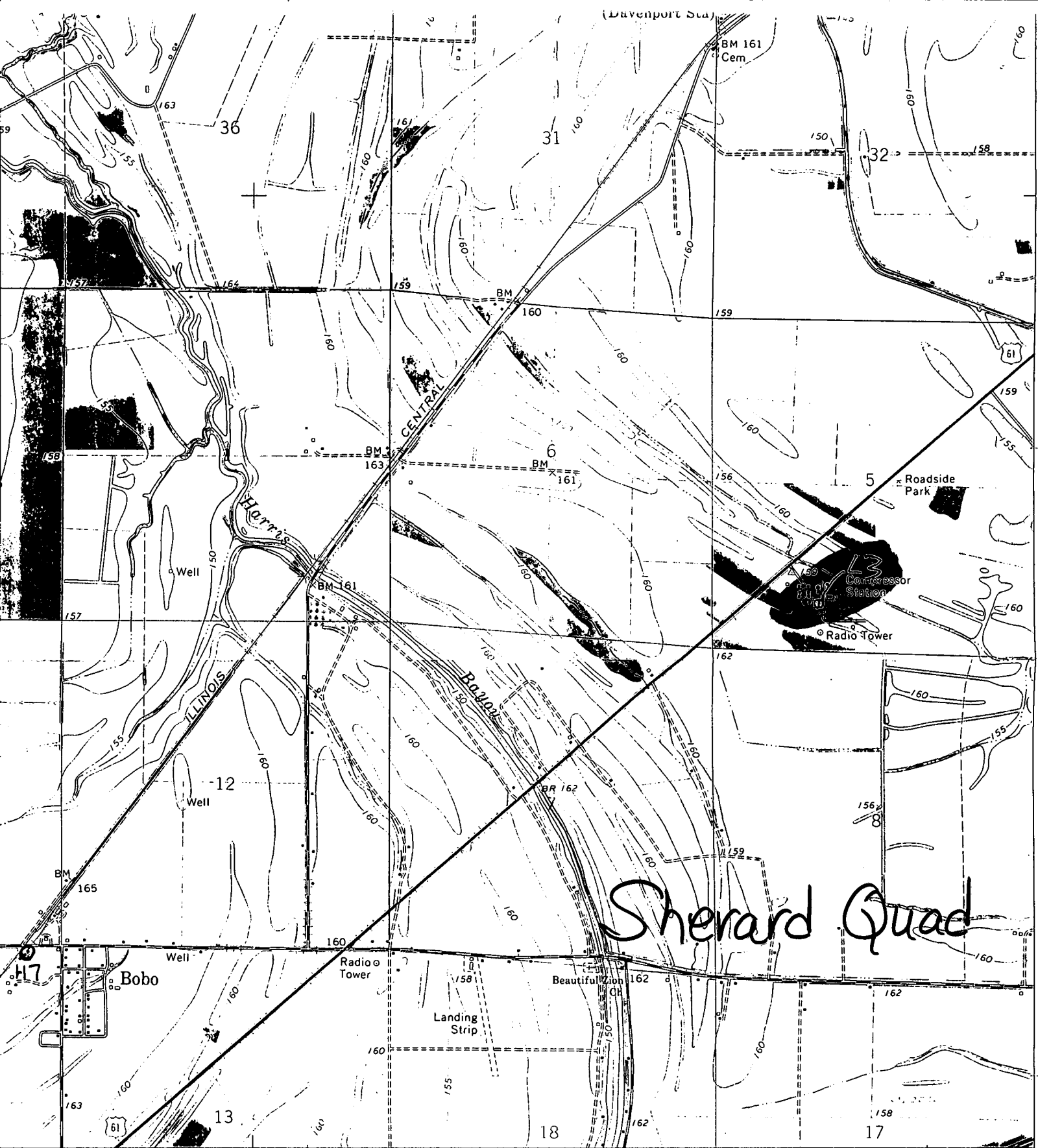

DUNCAN 7 MI. CLEVELAND 27 MI. 715 40' R. 5 W. R. 4 W. 717000m.E. INTERIOR—GEOLOGICAL SURVEY, WASHINGTON, D.C.—1968 90°37'

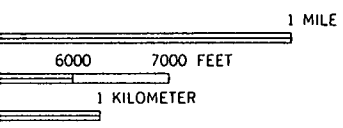

ROAD CLASSIFICATION

- Heavy-duty —————
- Medium-duty —————
- Light-duty —————
- Unimproved dirt - - - - -
- U. S. Route (shield symbol)
- State Route (circle symbol)

SHERARD, MISS.