

**WELL SCHEDULE**  
**OFFICE OF LAND AND WATER RESOURCES**

Fips 27

Well No. K-500

Log No. \_\_\_\_\_

Recorded by: LN Data Source: Charlotte Date: 6-27-97

County: Coahoma Permit No.: GW7497 DOH No.: \_\_\_\_\_

1/4: NW, NE 1/4: NW 1/4: SW Sec.: 33 TWN: 27N RNG: 3W

Quad: Clarksdale Elevation: 162

Plotted on quad?: \_\_\_\_\_ In field? \_\_\_\_\_ From drillers log? \_\_\_\_\_ From permit? \_\_\_\_\_

Latitude: \_\_\_\_\_ Longitude: \_\_\_\_\_ GPS? \_\_\_\_\_ From quad? \_\_\_\_\_

Primary Aquifer: MRVA Secondary Aquifer: \_\_\_\_\_

Use: \_\_\_\_\_ Well status: \_\_\_\_\_

Owner: R. Parolli + B. Barbieri

Address: \_\_\_\_\_

Telephone: \_\_\_\_\_ Local Well Name: \_\_\_\_\_

Date drilled: 5-1-87 Driller: Powell Irrigation

Well depth: 100 Well diameter: 10 Pump type: -

Power type: - Pump capacity: 1,000

Screen interval(msl): 102' - 62' (land surface): 60' - 100'

Type of logs: \_\_\_\_\_ Log interval: \_\_\_\_\_

Initial water level(l/s): \_\_\_\_\_ Date: \_\_\_\_\_

Measuring point description: \_\_\_\_\_

---

Water Quality Data? \_\_\_\_\_ Source: \_\_\_\_\_ Reliability: \_\_\_\_\_

Water Level Data? \_\_\_\_\_ Source: \_\_\_\_\_ Reliability: \_\_\_\_\_

Pump Test Data? \_\_\_\_\_ Source: \_\_\_\_\_ Reliability: \_\_\_\_\_

Water Use Data? \_\_\_\_\_ Source: \_\_\_\_\_ Reliability: \_\_\_\_\_

---

Water level data

---

This area for location map and notes

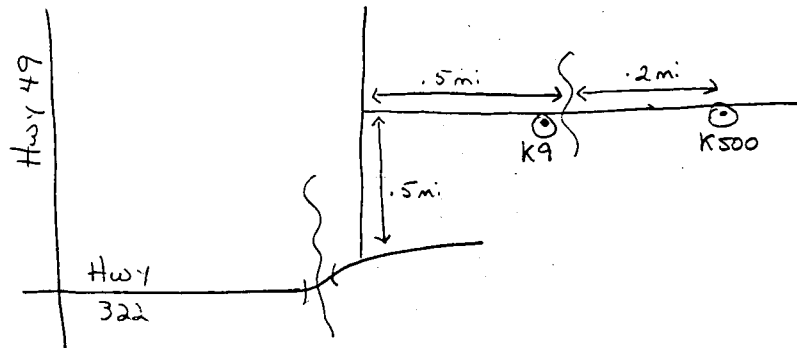

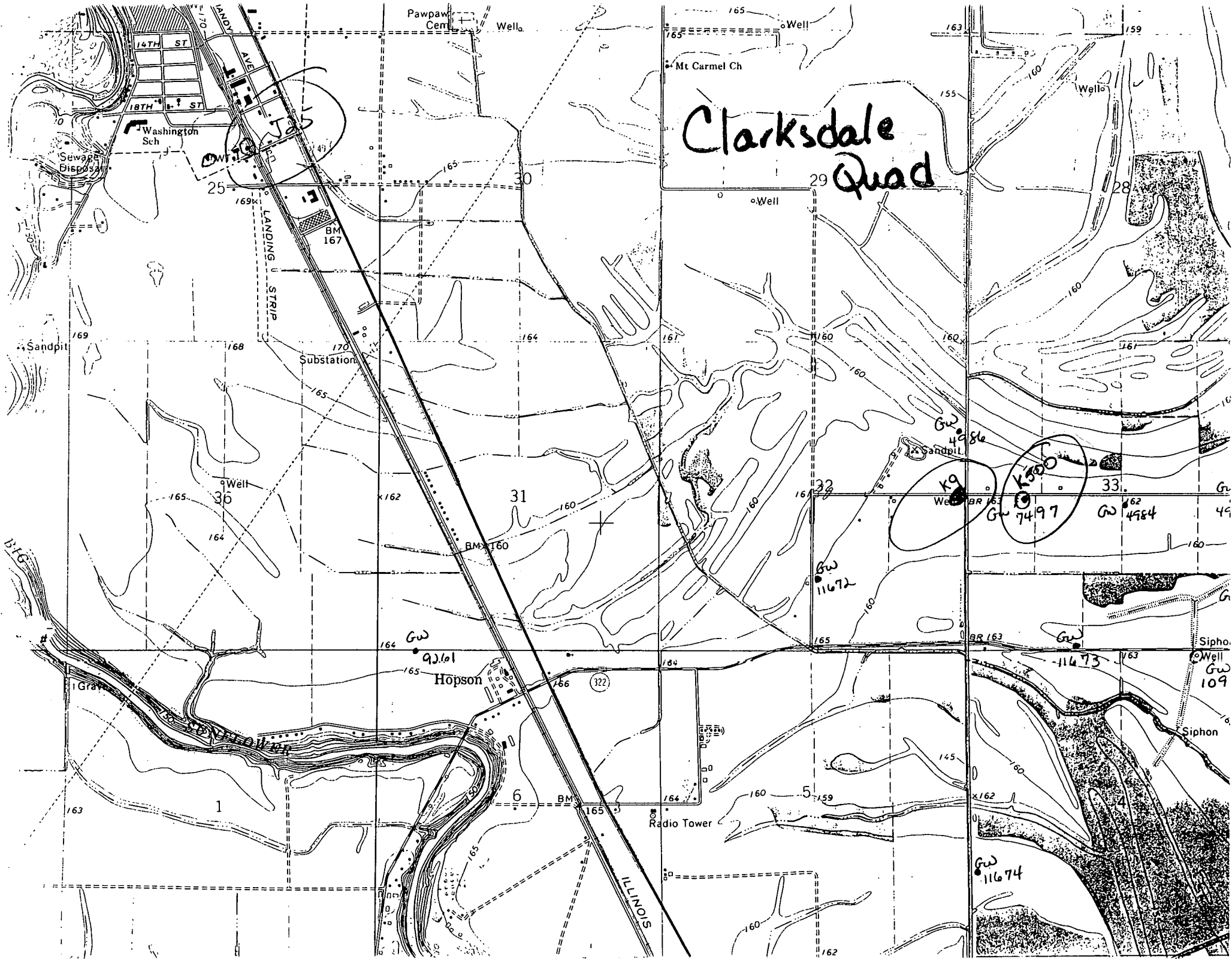

# Clarksdale Quad

K500  
K9

Gw  
11674

Gw  
7497

Gw  
4984

Gw  
11672

Gw  
11673

Siphon  
Well  
Gw  
109

Pawpaw Cent  
Wells

Well  
Mt Carmel Ch

Wells

Washington Sch

Sewage Disposal

BM  
167

Substation

BM  
160

Gw  
9201

Hopson

Radio Tower

BM  
165

Siphon

14TH ST

18TH ST

LANDING STRIP

ILLINOIS

BIG

Gr

1

31

32

33

6

5

29

28

25

35

165

164

165

164

163

163

163

163

163

163

163

170

165

165

165

165

165

165

165

165

165

165

165

165

165

165

165

162

162

162

162

162

162

162

162

162

162

162

162

162

160

160

160

160

160

160

160

160

160

160

160

160

160

160

160

160

160

160

160

160

160

160

160

160

160

160

160

160

160

160

160

160

160

160

160

160

160

160

160

160

160

160

160

160

160

160

160

160

160

160

160

160

160

160

160

160

160

160

160

160

160

160

160

160

160

160

160

160

160

160

160

160

160

160

160

160

160

160

160

160

160

160

160

160

160

160

160

160

160

160

160

160

160

160

160

160

160

160

160

160

160

160

160

160

160

160

160

160

160

160

160

160

160

160

160

160

160

160

160

160

160

160

160

160

160

160

160

160

160

160

160

160

160

160

160

160

160

160

160

160

160

160

160