

9-185.
(October 1950)

UNITED STATES
DEPARTMENT OF THE INTERIOR
GEOLOGICAL SURVEY
WATER RESOURCES DIVISION

Cdale 3.6 SE
21/10
11/10
25.00

WELL SCHEDULE

Date _____, 19____ Field No. _____

Record by _____ Office No. K9

Source of data _____

1. Location: State _____ County Coahoma

Map Clarksdale Quad Topson - East
NE 1/4 SE 1/4 sec. 32 T 27 N R 3 E
W

2. Owner: J. R. Clanton Address _____

Tenant _____ Address _____

Driller J. Counties Address _____

3. Topography _____

4. Elevation 162 ^{ft.} above _____ below _____

5. Type: Dug, Reverse drilled, driven, bored, jetted _____ 1955 ^{Summer}

6. Depth: Rept. 114 ft. Meas. _____ ft.

7. Casing: Diam. 8 in., to 6 in. Type _____

Depth 85 ft., Finish 30' Brass wrapped

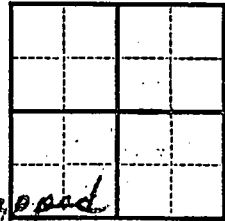

8. Chief Aquifer _____ From _____ ft. to _____ ft.

Others 20.00 4/6/56

9. Water level 15 ft. ^{Rept.} meas. Summer 1955 ^{above} _____ ^{below} _____

Top of casing which is 1.5 ft. ^{above} E
W ^{below} surface

10. Pump: Type Denno's Turb. Capacity _____ G. M.

Power: Kind Belt drive Horsepower _____

11. Yield: Flow _____ G. M., Pump 600 G. M., Meas. 6/55 ^{Rept. Est.}

Drawdown _____ ft. after _____ hours pumping _____ G. M.

12. Use: Dom., Stock, PS., RR., Ind. Irr. Obs. Road crops

Adequacy, permanence _____

13. Quality _____ Temp _____ °F.

Taste, odor, color _____ Sample Yes
No

Unfit for _____

14. Remarks: (Log, Analyses, etc.) 8" 4 Stage

UNITED STATES
DEPARTMENT OF THE INTERIOR
GEOLOGICAL SURVEY
WATER RESOURCES DIVISION

5/13/65

22.00
1.34

29.00
27.60

21.66
1.00

6.00

WL 20.66 3-24-65
MP TOP LOSING
1.0' above WSE

21.60

BEE

Am
QPR

30
1.5
28.5
6
22.5

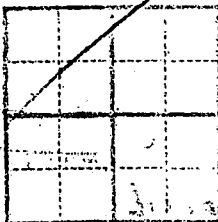

11-10-65

3. Chief Engineer From _____
4. District Engineer _____
5. District Engineer _____
6. District Engineer _____
7. District Engineer _____
8. District Engineer _____
9. District Engineer _____
10. District Engineer _____
11. District Engineer _____
12. District Engineer _____
13. District Engineer _____
14. District Engineer _____

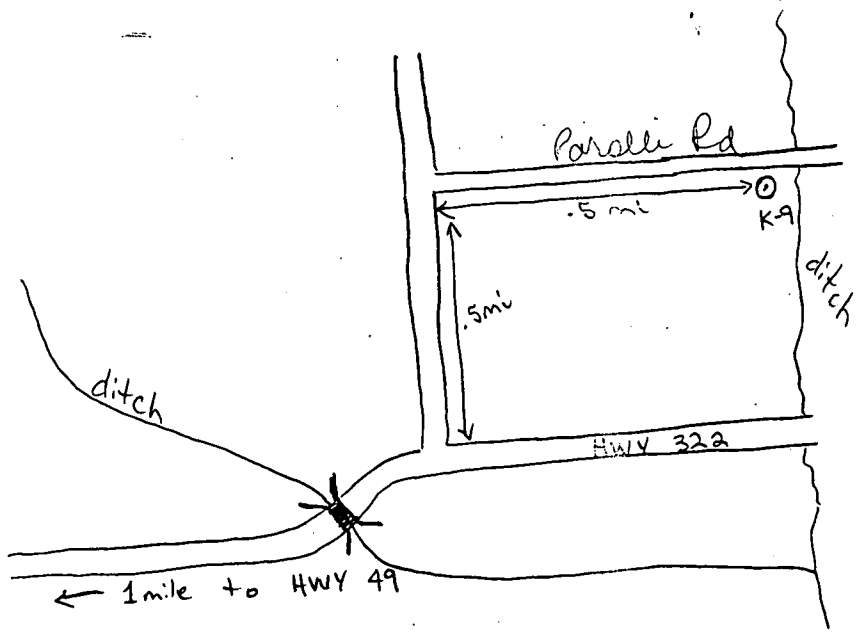

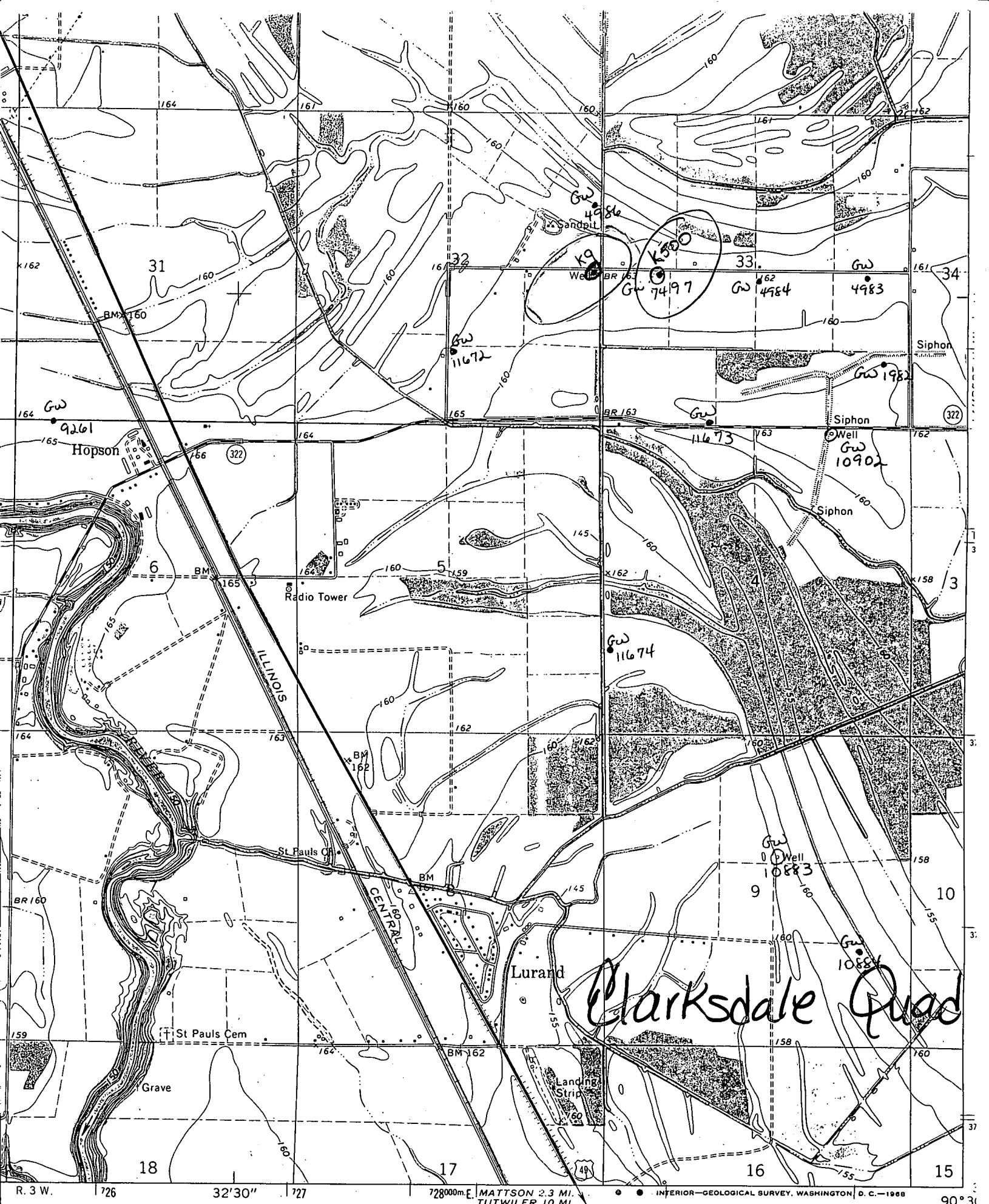

Clarksdale Quad

R. 3 W. 726 32'30" 727 728000m.E. MATTSON 2.3 MI. TUTWILER 10 MI. INFERIOR—GEOLOGICAL SURVEY, WASHINGTON, D. C.—1968 90° 31'

