

WELL SCHEDULE

U. S. DEPT. OF THE INTERIOR

GEOLOGICAL SURVEY

WATER RESOURCES DIVISION

PUNCHED

DEC 21 1973

WL Data

11/30/88

WL=22.57

MASTER CARD

Record by JCM Source of data BOWC Date 1-73 Map _____

State 28 County (or town) Coahoma Sequential number: 14

Latitude: 34 10 15 N Longitude: 09 03 62 W Sequential number: 1

Lat-long accuracy: 3 T 27 S, R 4 E 37 S W SW NW

Local well number: J 08 7 C B 34 Z 7 N 0 4 W Other number: _____

Local use: 020 Owner or name: _____

Owner or name: V F W Address: Clarkdale

Ownership: County, Fed Gov't, City, Corp or Co, Private, State Agency, Water Dist _____ P

Use of water: (A) Air cond, Bottling, Comm, Dewater, Power, Fire, Dom, Irr, Med, Ind, P S, Rec, (S) Stock, Instit, Unused, Repressure, Recharge, Desal-P S, Desal-other, Other club house H

Use of well: (A) Anode, Drain, Seismic, Heat Res, Obs, Oil gas, Recharge, Test, Unused, Withdraw, Waste, Destroyed. W

DATA AVAILABLE: Well data Freq. W/L meas.: Field aquifer char.

Hyd. lab. data: _____

Qual. water data; type: _____

Freq. sampling: _____ Pumpage inventory: yes no; period: _____

Aperture cards: _____ yes no

Log data: _____ D

WELL-DESCRIPTION CARD

SAME AS ON MASTER CARD Depth well: _____ ft 1268 Meas. rept accuracy 3

Depth cased: _____ ft 1248 Casing type: Blk Steel Diam. 4x2 in 4

Finish: (C) porous concrete, (F) gravel w. (perf.), (G) gravel w. (screen), (H) horiz. gallery, (O) open end, (P) perf., (S) screen, (T) sd. pt., (W) shored, (X) open hole, (Z) other S

Method Drilled: (A) air rot., (B) bored, (C) cable, (D) aug, (H) hyd, (J) jetted, (P) air rot., (R) reverse percuss, (T) rotary, (V) trenching, (W) driven, (Z) drive wash, other H

Date Drilled: 9 7 2 Pump intake setting: _____ ft _____

Driller: Bailey

Lift (type): (A) air, (B) bucket, (C) cent, (D) jet, (L) multiple, (M) multiple, (N) none, (P) piston, (R) rot, (S) submerg, (T) turb, other. Deep Shallow

Power (type): diesel, elec, gas, gasoline, hand, gas, wind; H.P. 1 Trans. or meter no. S

Descrip. MP _____ ft above below LSD, Alt. MP _____

Alt. LSD: _____ Accuracy: _____

Water Level: _____ ft above below MP; _____ ft below LSD Accuracy: _____

Date meas: 5 6 7 Yield: _____ gpm 20 Method determined _____

Drawdown: _____ ft Accuracy: _____ Pumping period _____ hrs _____

QUALITY OF WATER DATA: Iron _____ ppm Sulfate _____ ppm Chloride _____ ppm Hard. _____ ppm

Sp. Conduct _____ K x 10⁶ Temp. _____ °F Date sampled _____

Taste, color, etc. _____

30
19.50
10.50
9.50

Well No. 587

Well No. _____

Latitude-longitude _____
d m s N S d m s

PUNCHED

HYDROGEOLOGIC CARD

18 19 20 21
SAME AS ON MASTER CARD Province: 03 Section: _____

22 23 24 25 26
E Drainage Basin: 154 Subbasin: _____

27
Topo of well site: (D) depression, stream channel, dunes, flat, hilltop, sink, swamp, (E) offshore, pediment, hillside, terrace, undulating, valley flat (F) (G) (H) (I) (J) (K) (L) (M) (N) (O) (P) (Q) (R) (S) (T) (U) (V) _____

28 29 30 31
MAJOR AQUIFER: system _____ series TE aquifer, formation, group MW

32 33 34
Lithology: R Origin: 2 Aquifer Thickness: _____ ft

35 36 37 38 39 40 41 42 43
Length of well open to: _____ ft 20 Depth to top of: 1216 ft A22

44 45 46 47
MINOR AQUIFER: system _____ series _____ aquifer, formation, group _____

48 49 50
Lithology: _____ Origin: _____ Aquifer Thickness: _____ ft

51 52 53 54 55 56 57 58 59
Length of well open to: _____ ft _____ Depth to top of: _____ ft _____

60 61 62
Intervals Screened: 2" SS

63 64
Depth to consolidated rock: _____ ft _____ Source of data: _____

65 66 67 68
Depth to basement: _____ ft _____ Source of data: _____

69 70 71 72
Surficial material: _____ Infiltration characteristics: _____

73 74 75 76 77 78
Coefficient Trans: _____ gpd/ft _____ Coefficient Storage: _____

79
Coefficient Perm: _____ gpd/ft²; Spec cap: _____ gpm/ft; Number of geologic cards: _____

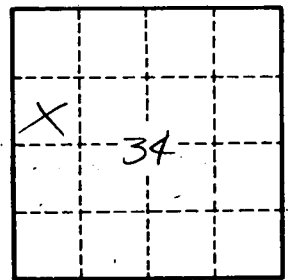
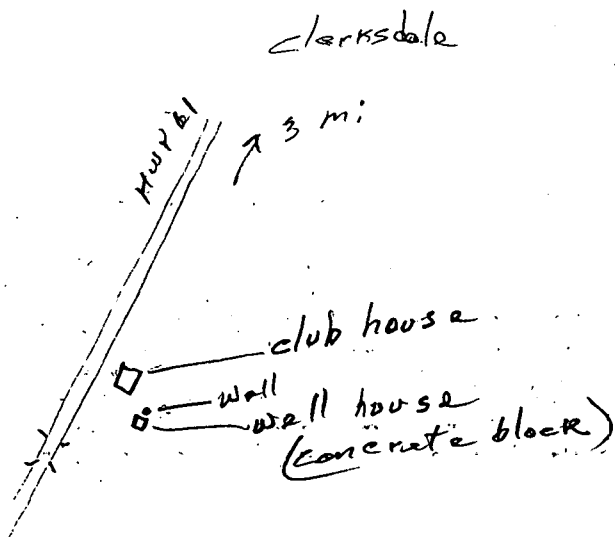

Well No. 587