

WELL SCHEDULE

U. S. DEPT. OF THE INTERIOR

GEOLOGICAL SURVEY

WATER RESOURCES DIVISION

PUNCHED
DEC 21 1973

MASTER CARD

Record by B.D. Source of data Bowc Date 10-70 Map _____

State: 28 County Coahoma 74

Latitude: 34^{deg} 10^{min} 12^{sec} N Longitude: 09^{deg} 03^{min} 50^{sec} W Sequential number: 1

Lat-long accuracy: 3 T 27 S, R 4 Sec 35 S, 56 W, SW, NW

Local well number: J067CB3527N04W Other number: _____ B & M

Local use: 068 Owner or name: _____

Owner or name: CHARLES MONTY Address: Clarksdale, Ms.

Ownership: County, Fed Gov't, (M) City, Corp or Co, Private, (S) State Agency, Water Dist _____ P

Use of water: (A) Air cond, Bottling, Comm, Dewater, Power, Fire, Dom, Irr, Med, Ind, P S, Rec, (S) Stock, Instat, Unused, Repressure, Recharge, Desal-P S, Desal-other, Other _____ H

Use of well: (A) Anode, Drain, Seismic, Heat Res, Obs, Oil-gas, Recharge, Test, Unused, Withdraw, Waste, Destroyed, (D) _____ W

DATA AVAILABLE: Well data Freq. W/L meas.: Field aquifer char. _____

Hyd. lab. data: _____

Qual. water data; type: _____

Freq. sampling: _____ Pumpage inventory: _____ period: _____

Aperture cards: _____

Log data: _____ D

WELL-DESCRIPTION CARD

SAME AS ON MASTER CARD Depth well: _____ ft 1269 Meas. rept _____ 3

Depth cased; (first perf.) _____ ft 1239 Casing type: Galer.; Diam. 4X3 in _____ 4

Finish: porous concrete, gravel w. (perf.), (G) gravel w. (screen), (H) horiz. open gallery, end, (F) other _____ 5

Method: (A) air bored, (C) cable, (D) dug, (H) jetted, (J) air reverse, (P) percuss, (R) rotary, (T) driven, (V) wash, (W) other _____ H

Date Drilled: 970 Pump intake setting: _____ ft _____

Driller: Fico Co. Farmers address _____

Lift (type): (A) air, (B) bucket, (C) cent, (J) jet, (L) multiple, (M) multiple, (N) none, (P) piston, (R) rot, (S) submerg, (T) turb, other _____ Deep _____ Shallow _____ 40

Power (type): diesel, elec, nat gas, gasoline, hand, gas, wind; H.P. _____ 2 Trans. or meter no. _____ 7

Descrip. MP _____ ft above _____ below LSD, Alt. MP _____

Alt. LSD: _____ Accuracy: (source) _____ 47

Water Level: 8 ft above below MP; Ft below LSD _____ 8 Accuracy: _____ D

Date meas: 970 Yield: _____ gpm _____ 45 Method determined _____ 61

Drawdown: _____ ft _____ Accuracy: _____ Pumping period _____ hrs _____ 68

QUALITY OF WATER DATA: Iron _____ ppm Sulfate _____ ppm Chloride _____ ppm Hard. _____ ppm

Sp. Conduct _____ K x 10⁶ Temp. _____ °F Date sampled _____ 79

Taste, color, etc. _____

Well No. J 67

Well No. J

PUNCHED
HYDROGEOLOGIC CARD

Latitude-longitude

N

S

SAME AS ON MASTER CARD

Physiographic Province: _____

03

Section: _____

D

Drainage Basin: _____

15H

Subbasin: _____

Topo of well site: (D) depression, stream channel, dunes, flat, hilltop, sink, swamp, (E) offshore, pediment, hillside, terrace, undulating, valley flat

MAJOR AQUIFER:

system _____

series _____

J.E

aquifer, formation, group _____

M.W

Lithology: _____

U.S

Origin: _____

2

Aquifer Thickness: _____

72

ft

Length of well open to: _____ ft

30

Depth to top of: _____ ft

119

MINOR AQUIFER:

system _____

series _____

aquifer, formation, group _____

Lithology: _____

Origin: _____

Aquifer Thickness: _____

ft

Length of well open to: _____ ft

Depth to top of: _____ ft

Intervals Screened: _____

3'S.S.

Depth to consolidated rock: _____ ft

Source of data: _____

Depth to basement: _____ ft

Source of data: _____

Surficial material: _____

Infiltration characteristics: _____

Coefficient Trans: _____

gpd/ft _____

Coefficient Storage: _____

Coefficient Perm: _____

gpd/ft²; Spec cap: _____

gpm/ft; Number of geologic cards: _____

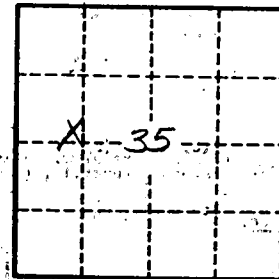
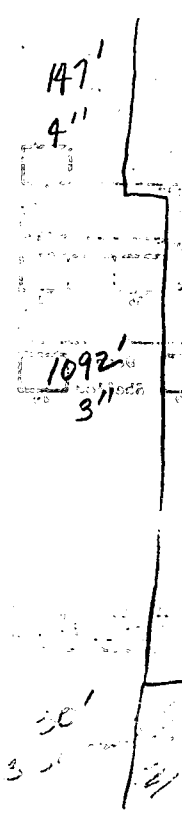

Well No.

J 67