

WELL SCHEDULE
OFFICE OF LAND AND WATER RESOURCES

Fips 27
Well No. J-25
Log No. _____

Recorded by: LN Data Source: Charlotte Date: 6-27-97

County: Coahoma Permit No.: GW 4965 DOH No.: _____

1/4: SW 1/4: SW 1/4: NE Sec.: ~~25~~ 25 TWN: 27N RNG: 4W

Quad: Clarksdale Elevation: 170

Plotted on quad?: _____ In field? _____ From drillers log? _____ From permit? _____

Latitude: _____ Longitude: _____ GPS? _____ From quad? _____

Primary Aquifer: MRVA Secondary Aquifer: _____

Use: _____ Well status: _____

Owner: City of Clarksdale

Address: _____

Telephone: _____ Local Well Name: _____

Date drilled: _____ Driller: _____

Well depth: _____ Well diameter: _____ Pump type: _____

Power type: _____ Pump capacity: _____

Screen interval(msl): _____ (land surface): _____

Type of logs: _____ Log interval: _____

Initial water level(l/s): _____ Date: _____

Measuring point description: _____

Water Quality Data? _____ Source: _____ Reliability: _____

Water Level Data? _____ Source: _____ Reliability: _____

Pump Test Data? _____ Source: _____ Reliability: _____

Water Use Data? _____ Source: _____ Reliability: _____

Water level data

This area for location map and notes

COAHOMA
J 25
2-25-63

MISSISSIPPI BOARD OF WATER COMMISSIONERS
GW 4965
WATER WELL DRILLERS LOG

Elev. 170

CODED

Date: 2-25-, 1963, Driller: Layne - Central Co. County Coahoma
(Name) well #5

(1) Owner of Land:	Description & Color of Materials Sand, Clay, Red Clay, Shell, etc.	Thick- ness Feet	Depth Feet
<u>City of</u>	<u>clay</u>	<u>0-26</u>	
<u>Clarksdale, Miss.</u>	<u>sand</u>	<u>26-48</u>	
(Address)	<u>sand + gravel</u>	<u>48-106</u>	
(2) Location: <u>SW 1/4, NE 1/4, Sec. 25 T22R7E</u>	<u>Rock</u>	<u>106-111</u>	
_____ miles _____ of _____	<u>sand + gravel</u>	<u>111-115</u>	
(distance) (direction) (Nearest Town)	<u>Rock sand</u>		
(3) Topography: _____	<u>+ gravel</u>	<u>115-124</u>	
(Hilly) (Flat) (Level)	<u>sand gravel</u>	<u>124-143</u>	
(4) Purpose of Well: <u>municipal</u>	<u>clay</u>	<u>143-153</u>	
(Domestic Irrigation Municipal, Industrial, Other)			

Information upon completion of well:

- (1) Diameter 36 inches.
- (2) Total Depth 146 feet.
- (3) Water Level 28' feet below top of ground.
- (4) Cased to 86', Size 26"
- (5) Screen: Size 16", Length 50'
- (6) Were any formations sealed against pollution?
X yes, _____ no.

If YES depth of formation _____

Why Required

Drillers Remarks: _____

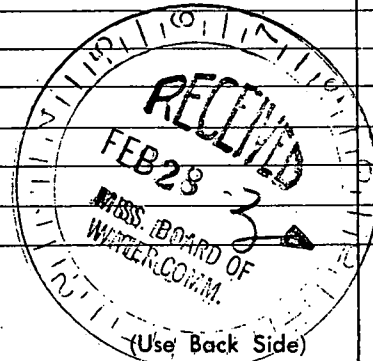

Well No. _____

Mail this copy to Board of Water Commissioners 429 Miss. St. Jackson, Miss.

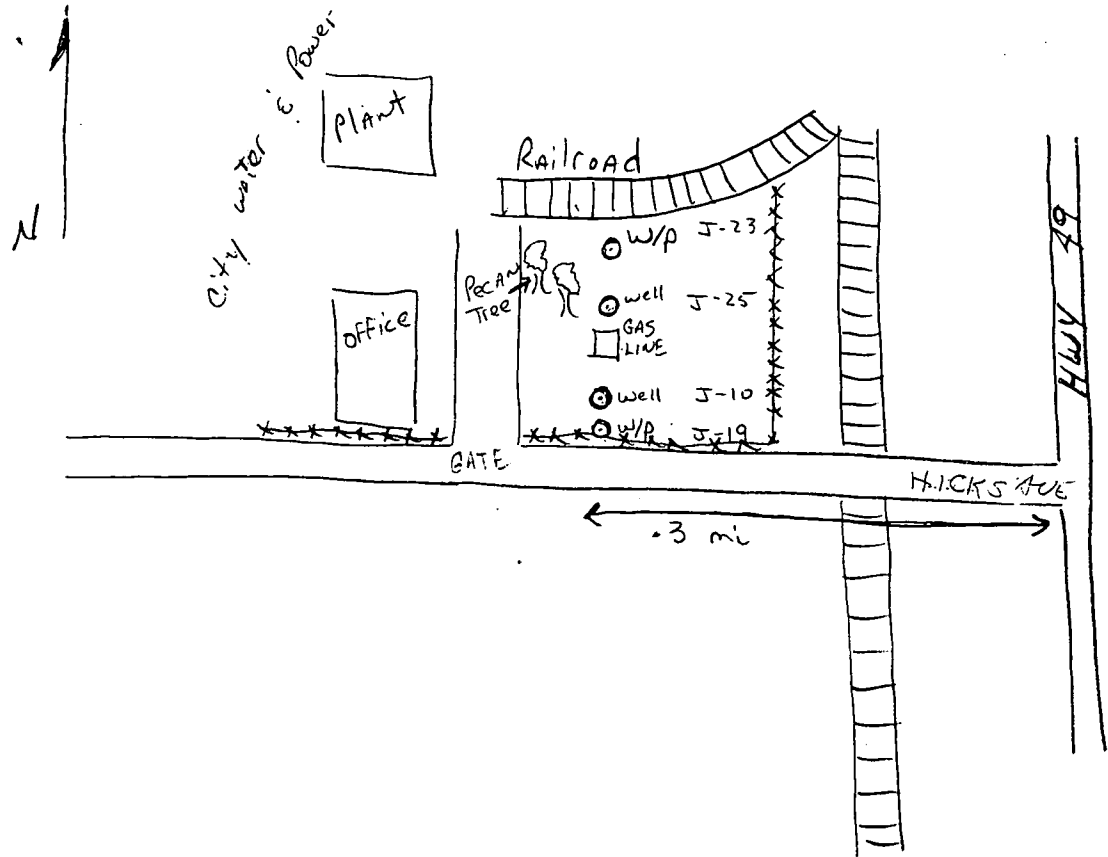

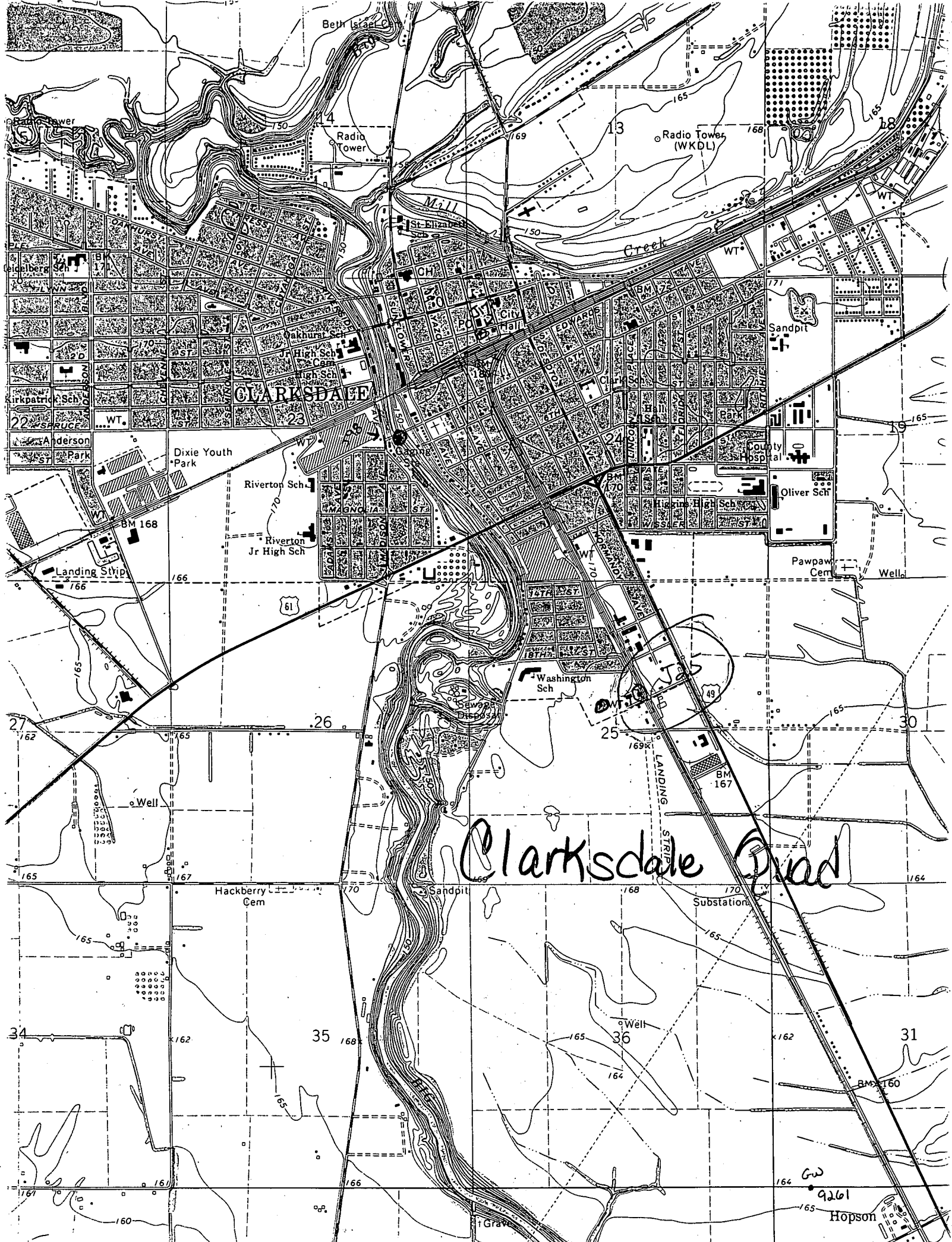

CLARKSDALE

Clarksville Quad

Beth Israel

Radio Tower

Radio Tower (WKDL)

St. Elizabeth

Creek

Jr High Sch

High Sch

Dixie Youth Park

Riverton Sch

Riverton Jr High Sch

Washington Sch

Sandpit

County Hospital

Oliver Sch

Pawpaw Cem

Well

Well

Hackberry Cem

Sandpit

Substation

Well

GW

9261

Hopson