

9-185
(October 1950)

UNITED STATES *Clade 3.2 NW*
DEPARTMENT OF THE INTERIOR
GEOLOGICAL SURVEY
WATER RESOURCES DIVISION

WELL SCHEDULE

Date _____, 19____ Field No. _____

Record by _____ Office No. J5

Source of data _____

1. Location: State Miss County Cochosma

Map Clarksdale Quad W. of Clade

SW $\frac{1}{4}$ SW $\frac{1}{4}$ sec. 9 T. 27 R. 4 EW

2. Owner: Rich Land Plantation Address Cochosma Co.

Tenant E. L. Anderson Jr. Address Clarksdale

Driller Leque Central Address _____

3. Topography _____

4. Elevation _____ ft. above
_____ ft. below

5. Type: Dug, Grilled driven, Bored, jetted 7 1955

6. Depth: Rept. 118 1/4 ft. Meas. _____ ft.

7. Casing: Diam. 16 in., to 17 in., Type _____

Depth 68 ft., Finish 53' Screen



8. Chief Aquifer _____ From _____ ft. to _____ ft.

Others _____

9. Water level 23' 8" rept April 1955 above
_____ ft. below

which is 1.0 ft. above surface

10. Pump: Type L. Turb. Capacity _____ G. M.

Power: Kind Elec. Horsepower 40

11. Yield: Flow _____ G. M., Pump 2/25 G. M., Meas. Rept Est. 4/55

Drawdown _____ ft. after _____ hours pumping _____ G. M.

12. Use: Dom., Stock, PS., RR., Ind., Irr., Obs. _____

Adequacy, permanence _____

13. Quality _____ Temp. _____ °F.

Taste, odor, color _____ Sample Yes
_____ No

Unfit for _____

14. Remarks: (Log, Analyses, etc.) Bot. on clay (Blue)

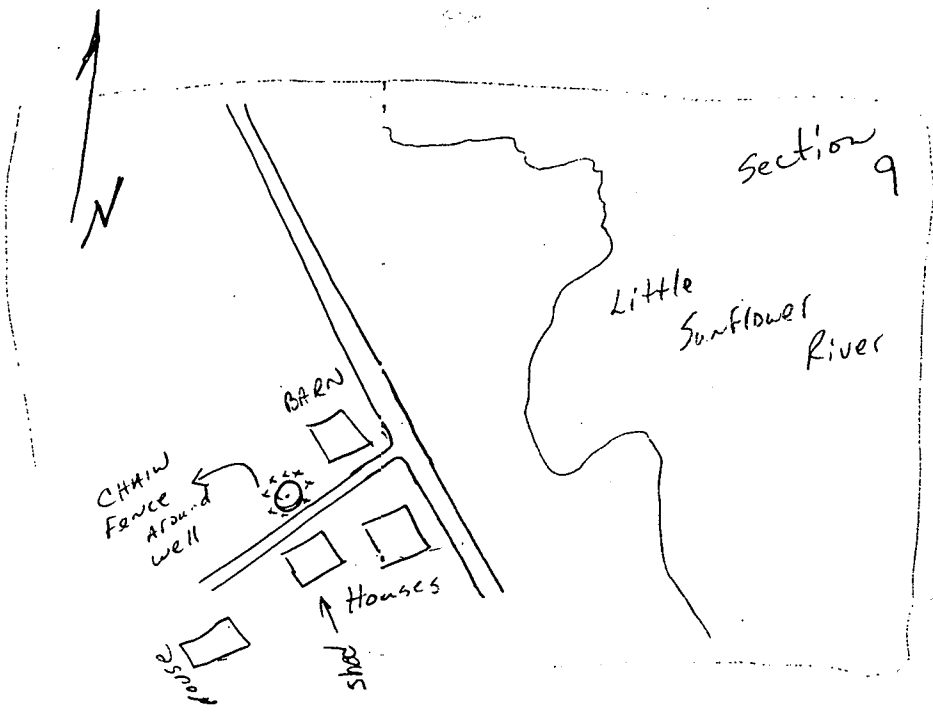

WINNER - E.L. ANDERSON

Well No. _____

Latitude-longitude _____
 N S
 d m s d m s

HYDROGEOLOGIC CARD

SAME AS ON MASTER CARD Province: 013 Section: _____

Drainage Basin: 1257 Subbasin: _____

Topo of well site: (D) (C) (E) (P) (H) (K) (L) _____
 (S) (T) (U) (V) _____
 offshore, pediment, hillside, terrace, undulating, valley flat

MAJOR AQUIFER: _____ system _____ series _____ aquifer, formation, group _____
 Lithology: _____ Origin: _____ Aquifer Thickness: _____ ft
 Length of well open to: _____ ft Depth to top of: _____ ft

MINOR AQUIFER: _____ system _____ series _____ aquifer, formation, group _____
 Lithology: _____ Origin: _____ Aquifer Thickness: _____ ft
 Length of well open to: _____ ft Depth to top of: _____ ft

Intervals Screened: 62-125 = 55' to 12"

Depth to consolidated rock: _____ ft Source of data: _____
 Depth to basement: _____ ft Source of data: _____
 Surficial material: _____ Infiltration characteristics: _____
 Coefficient Trans: _____ gpd/ft Coefficient Storage: _____
 Coefficient Perm: _____ gpd/ft; Spec cap: _____ gpm/ft; Number of geologic cards: _____

IRRIGATION WELL 16" x 12"

4-16-81 JKA

$W.L. = 30 - 3.04 - 0.5 = 26.46$

WELL HAS NO PUMP
 OPEN HOLE

9-16-82
 U.S.G.S Recorder
 on well

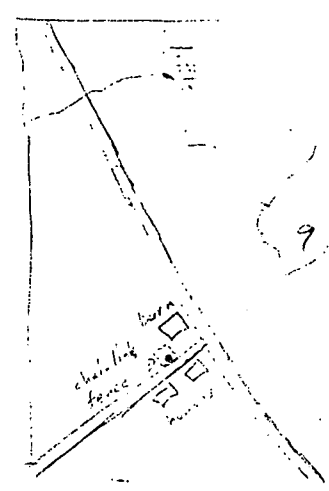
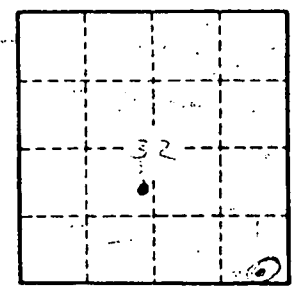

measured thru gap
 between base of
 recorder + top of
 pipe

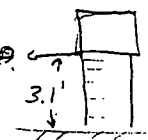

Recorder removed -
 well being pumped
 gc
 6/30/88

11.7.82
W.L. = 27.63

Observation Well

County COAHOMA
Well No. J5

Owner's Name E. L. ANDERSON

Location SW NE SW Sec. 9 27N 4W
(town)

(miles and direction from center of town)

Other description

Depth 118 Diameter 16" Date drilled

Formation MS RIVER ALLUVIUM

Elev. of lsd 172' Recorder Type No.

M.P. 3.40 Recorder Floor at 3.40 ft ^{above}/_{below} lsd. Date

M.P. at ft ^{above}/_{below} lsd. Date

M.P. at ft ^{above}/_{below} lsd. Date

Special Digital Rec. on well installed 5/81

Water Level 27' (1981)
Sketch of location Sketch of well head

Chain Link
fence around
well.

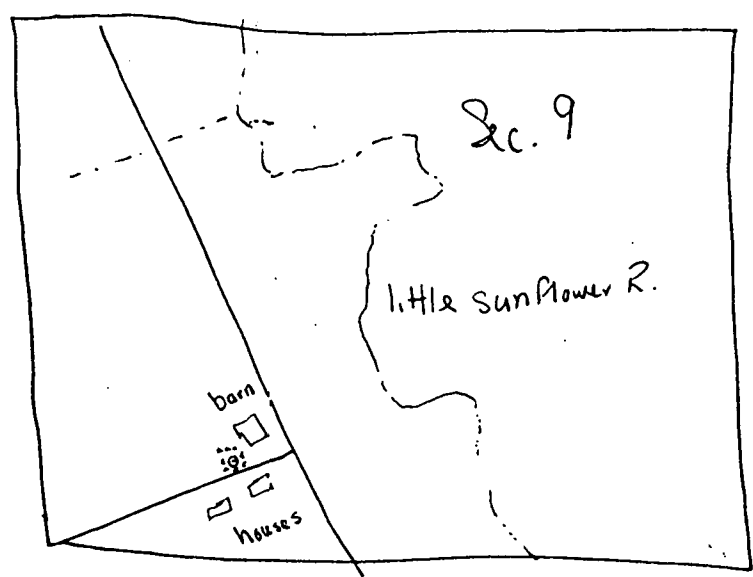

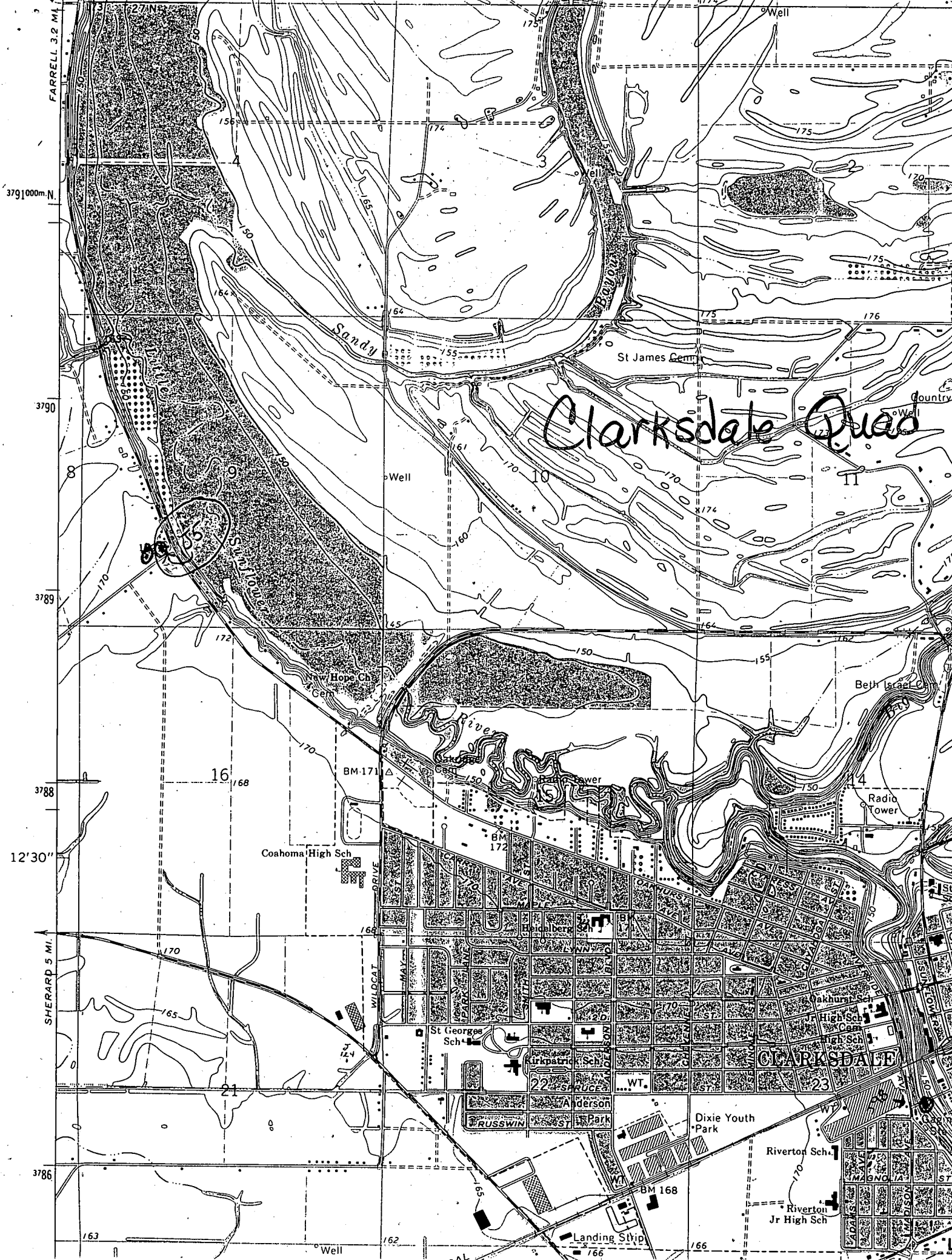

Clarksdale Quad

CLARKSDALE