

871

Sherard

6/78 WTO

Recorded by WTS

Date 11/26/79

U.S. GEOLOGICAL SURVEY
WATER RESOURCES DIVISION
MISSISSIPPI DISTRICT
WELL RECORD

TRANSMITTED FOR ADP
4/80

Well No. H36
E-Log No. _____
County Cochosoma

624-6501

Site ID 3 4 1 1 0 8 0 9 0 4 3 2 0 0 1 R=0* T=A* 2=W* **SHERARD 87A**

Data reliab. 3=X* U Report. agency 4=USGS* Dist. 6=28* 7=28* Co. 8=027*

Lat. _____ Long. 9=3 4 1 1 0 8* 10=0 9 0 4 3 2 0* Well No. 12=H 0 3 6*

Location 13=SE NW S 2 8 T 2 7 N R 0 5 W* Alt. 16=1 6 4*

Hyd. Unit (OWDC) 20= _____ Date 21=1 1 1 2 1 9 7 9*

Well use 23=W* Water Use 24=H* Hole depth 27=5 6 0* Well depth 28=5 2 5*

30=2 0* Date 31=1 1 1 2 1 9 7 9* Source 33=D*

Status 273= _____ Project No. 5=S P R T*

R=158* T=A* Date 159#1 1 1 2 1 9 7 9* Owner No. _____

Owner 161=O S C A R C O N N E L L*

10/24/89

R=192* T=A* Date 193# _____ Temp. 196#00010* 197# _____

R=192* T=A* Date 193# _____ Cond. 196#00095* 197# _____

R=192* T=A* Date 193# _____ pH 196#00400* 197# _____

R=58* T=A* 59#1* Date 60=1 1 1 2 1 9 7 9* Remarks _____

Drlg. 63=0 6 8* Name Five G Method 65=H* Finish 66=S*

R=76* T=A* 59#1*

Top csgn. 77# 0* Bot. csgn. 78=1 4 0* Diam. 79# 4*

R=76* T=A* 59#1*

Top csgn. 77# 1 4 0* Bot. csgn. 78=4 9 5* Diam. 79# 2*

R=82* T=A* 59#1* Top 83# 4 9 5* Bottom 84=5 2 5*

Type 85=S* Diam. 87=2* Size 88= _____*

R=82* T=A* 59#1* Top 83# _____* Bottom 84= _____*

Type 85= _____* Diam. 87= _____* Size 88= _____*

R=1 4 6* T=A* 147# 1* Q 150=2 5* Q/S 272= _____*

134 flows 146 pumped

GEN. SITE DATA

OWNER

FIELD QW

CONSTR.

CASING

OPENINGS

YIELD

R=42* T= A * Lift type 43# S* Intake 44= * Power type 45= E*

Date 38= 11/12/1979* H.P. 46= 1.5*

LIFT

R=198* T= A * Log 199# D* Top 200= 0.* Bot 201= 560.*

R=198* T= A * Log 199# * Top 200= * Bot 201= *

R=189* T= A * E Log No. 190# * 191= M I S S D I S T *

LOGS

R=114* T= A * Year 115# * Type 120= *

R=90* T= A * 256# 1 * Top 91= 495.* Bot 92= 525.*

Unit ID 93= 124SPRT * Name of Unit

R=90* T= A * 256# 1 * Top 91= * Bot 92= *

Unit ID 93= * Name of Unit

ANAL. EQUIPERS

R=90* T= A * 99# 1 * Unit tested 100= * 103= *

R=90* T= A * 99# 1 * Test No. 106# *

Transmissivity (gal/d)/ft

Hydraul. cond. (gal/d)/ft²

Storage coeff. Boundaries

R= A * Yr Begin 122# 1979 * Network 258= *

Well Data Collection (1)

of formations tested	from	to
Blown sand	0	10
Coars. sand	10	22
sand & silt	22	44
Blue mud	44	160
Coars. white sand	160	495
Blue mud	495	525
	526	560

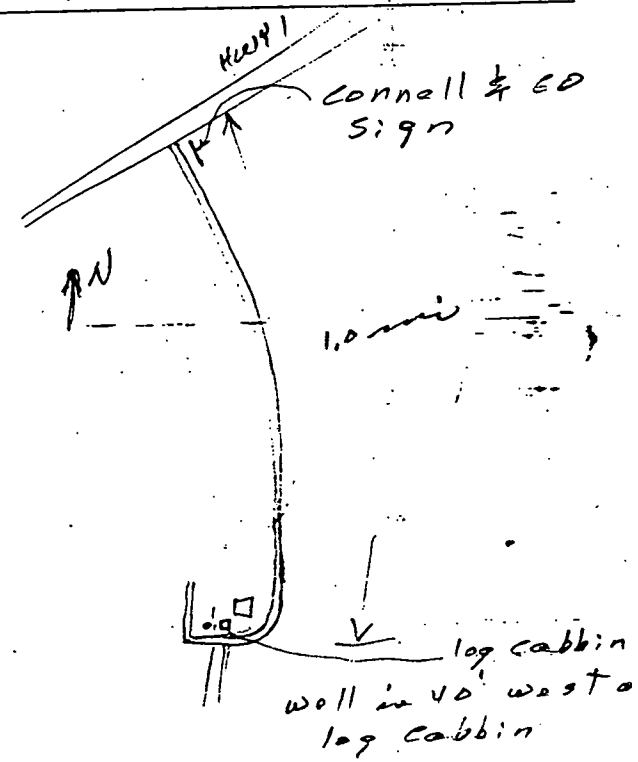

DATA SHEET-VERIFICATION CHECKLIST

COUNTY COAHOMA

SHERARD QUAD

WELL OWNER OSCAR CONNELL

CHECKED

U.S.G.S. NO. H-36

JHJ

B.O.H. NO. _____

OLWR NO. _____

LOCATION:

MAP NE, NW, NE, SW S 28, T 27 N, R 5 W

JHJ

GPS _____

ELEV. (MSL) 164'

JHJ

W.L. (L.S.) (1) - 21.4' 6-28-95

JHJ

(2) - 21.4'

JHJ

HEAD (MSL) 142.6'

JHJ

SCREENED INTERVAL 495' - 525' (LS) / - 331' - - 361' (MSL)

JHJ

AQUIFER VERIFIED SPARTA

JHJ

PREVIOUS W.L. - 24.82' (10/24/89) / - 22.35' (12/10/80) / - 20' (11/12/79)

JHJ

DATA ENTERED _____

Cook County
 A-36
 11-12-1979

MISSISSIPPI
 BOARD OF WATER COMMISSIONERS
 416 North State Street
 Jackson, Mississippi 39201

CODED

WATER WELL DRILLERS LOG

11-12 date well completed 1979 Five Co. Farms, Inc. firm name Cook County county well located

LANDOWNER: Oscar Cornell
 Shepard Mine

description of formations encountered	from	to
Top soil	0	10
Brown sand	10	22
Coarse sand	22	48
sand & silt	48	160
Blue mud	160	495
Coarse white sand	495	525
Blue mud	526	560

(mailing address)
 WELL LOCATION:
 sec. 28 T. 31 N. R. 5 E. S. 5 W.
 2 miles south of Shepard
 (distance) (direction) (nearest town)

WELL PURPOSE:
 (home, irrigation, municipal, industrial)

- WELL COMPLETION DATA:
- diameter (inches) 4.82
 - total depth (feet) 525
 - static water level (feet) 20 below top of ground
 - casing P.V.C. 495 (material) (depth)
 4.82" if telescope see back. (size)
 - screen 30' 495 (length) (depth to top)
 2" P.V.C. (size) (material)
 - pump 1/2 1500 gph (HP) (yield gpm)
 Electric (type power)
 - electric log NO (yes or no)
- (organization running log)
- (8) how well bottom plugged Backwash

DEPT. OF NATURAL RESOURCES
 BUREAU OF LAND & WATER RESOURCES

NOV 19 1979

RECEIVED

DRILLERS REMARKS:

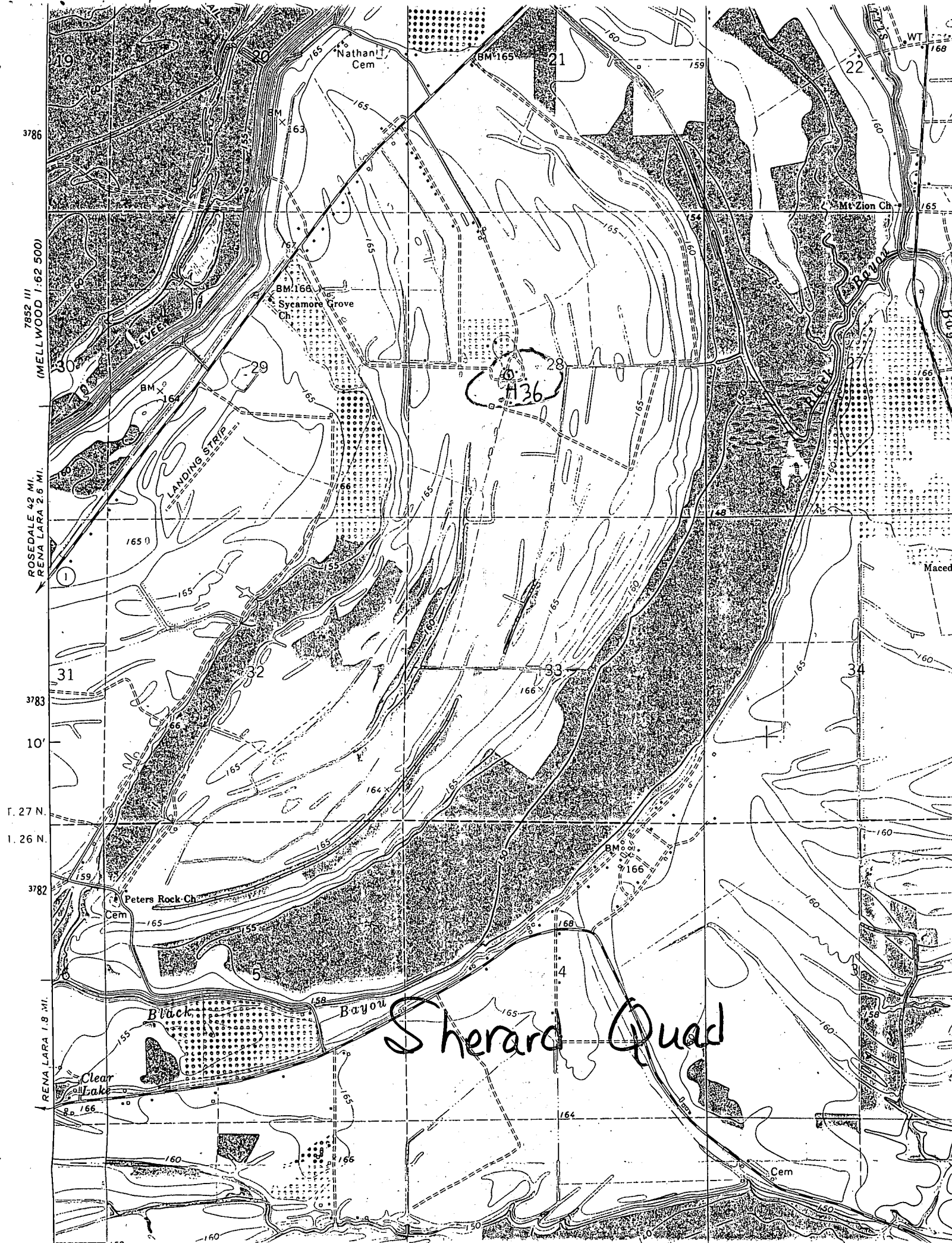

7852 III
(MELLWOOD 1:62 500)
ROSEDALE 4.2 MI.
RENA LARA 2.6 MI.

3786
3783
10'
T. 27 N.
1. 26 N.
3782

RENA LARA 1.8 MI.

Sherard Quad

Nathan Cem

Sycamore Grove Ch

Mt Zion Ch

LANDING STRIP

Peters Rock Ch

Black Bayou

Clear Lake

136

Cem

Macedon

WT