

Kera kara
GW05676

FORM 9-1642
(1-68)

Well No. H8

WELL SCHEDULE

PUNCHED

U. S. DEPT. OF THE INTERIOR

GEOLOGICAL SURVEY

WATER RESOURCES DIVISION

NOV 7 1972

MASTER CARD

Record by JCM Source of data BOWC Date 6-72 Map _____

State 28 County Coahoma (or town) 14

Latitude: 34 12 38 N Longitude: 09 04 51 0 Sequential number: 1

Lat-long accuracy: 5 T 26 S. R. 5 Sec 18 NW, INW, NW, SE

Local well number: H008 1826N05W Other number: _____ B & H

Local use: 068 Owner or name: C. E. PRESLEY Address: Clarksdale

Ownership: County, Fed Gov't, City, Corp or Co, Private, State Agency, Water Dist _____ P

Use of water: (A) Air cond, Bottling, Comm, Dewater, Power, Fire, Dom, Irr, Med, Ind, P S, Rec, (S) Stock, Instit, Unused, Repressure, Recharge, Desal-P S, Desal-other, Other _____ I

Use of well: (A) Anode, Drain, Seismic, Heat Res, Obs, Oil-gas, Recharge, Test, Unused, Withdraw, Waste, Destroyed, (D) _____ W

DATA AVAILABLE: Well data Freq. W/L meas.: Field aquifer char. _____

Hyd. lab. data: _____

Qual. water data; type: _____

Freq. sampling: _____ Pumpage inventory: _____

Aperture cards: _____

Log data: _____ D

WELL-DESCRIPTION CARD

SAME AS ON MASTER CARD Depth well: _____ ft 118 Meas. _____ 3

Depth cased: _____ ft 70 Casing type: Steel ; Diam. _____ in 14

Finish: (C) porous concrete, (F) gravel w. (G) gravel w. (H) horiz. open perf., (I) screen, (J) sd. pt., (K) shored, (L) open hole, (M) other _____ S

Method Drilled: (A) air rot., (B) bored, (C) cable, (D) dug, (E) hyd rot., (F) jetted, (G) air percussion, (H) reverse, (I) trenching, (J) driven, (K) drive wash, (L) other _____ H

Date Drilled: 9-7-72 Pump intake setting: _____ ft _____

Driller: Five County name _____ address _____

Lift (type): (A) air, (B) bucket, (C) cent., (D) jet, (E) multiple, (F) multiple, (G) none, (H) piston, (I) rot., (J) submerg., (K) turb., (L) other _____ 7 Deep _____ Shallow _____

Power (type): (A) diesel, (B) elec, (C) gas, (D) gasoline, (E) hand, (F) gas, (G) wind, (H) H.P. _____ Trans. or meter no. _____

Descrip. MP _____ ft above _____ below LSD, Alt. MP _____

Alt. LSD: _____ Accuracy: _____

Water Level _____ ft above _____ below MP; _____ ft below LSD _____ Accuracy: _____

Date meas.: 6-7-72 Yield: _____ gpm _____ Method determined _____

Drawdown: _____ ft _____ Accuracy: _____ Pumping period _____ hrs _____

QUALITY OF WATER DATA: Iron _____ ppm Sulfate _____ ppm Chloride _____ ppm Hard. _____ ppm

Sp. Conduct _____ K x 10⁶ _____ Temp. _____ °F _____ Date sampled _____

Taste, color, etc. _____

Well No.

H8

HYDROGEOLOGIC MAP

SAMPLING POINT NO. **0322409** Physiographic Province: _____ Section: **03**
 Drainage Basin: **15H** Subbasin: _____

Topo of well site: (D) depression, stream channel, dunes, flat, hilltop, sink, swamp, (C) _____, (E) _____, (F) _____, (R) _____, (K) _____, (L) _____
 (Ø) offshore, pediment, hillside, terrace, undulating, valley flat (P) _____, (S) _____, (T) _____, (U) _____, (V) _____

MAJOR AQUIFER: _____ system _____ series **06** _____ aquifer, formation, group **MA**

Lithology: _____ Origin: **2** Aquifer Thickness: **65** ft

Length of well open to: _____ ft **48** Depth to top of: _____ ft **53**

MINOR AQUIFER: _____ system _____ series _____ aquifer, formation, group _____

Lithology: _____ Origin: _____ Aquifer Thickness: _____ ft

Length of well open to: _____ ft _____ Depth to top of: _____ ft _____

Intervals Screened: **14" DOERR**

Depth to consolidated rock: _____ ft _____ Source of data: _____

Depth to basement: _____ ft _____ Source of data: _____

Surficial material: _____ Infiltration characteristics: _____

Coefficient Trans: _____ gpd/ft Coefficient Storage: _____

Coefficient Perm: _____ gpd/ft²; Spec cap: _____ gpm/ft; Number of geologic cards: _____

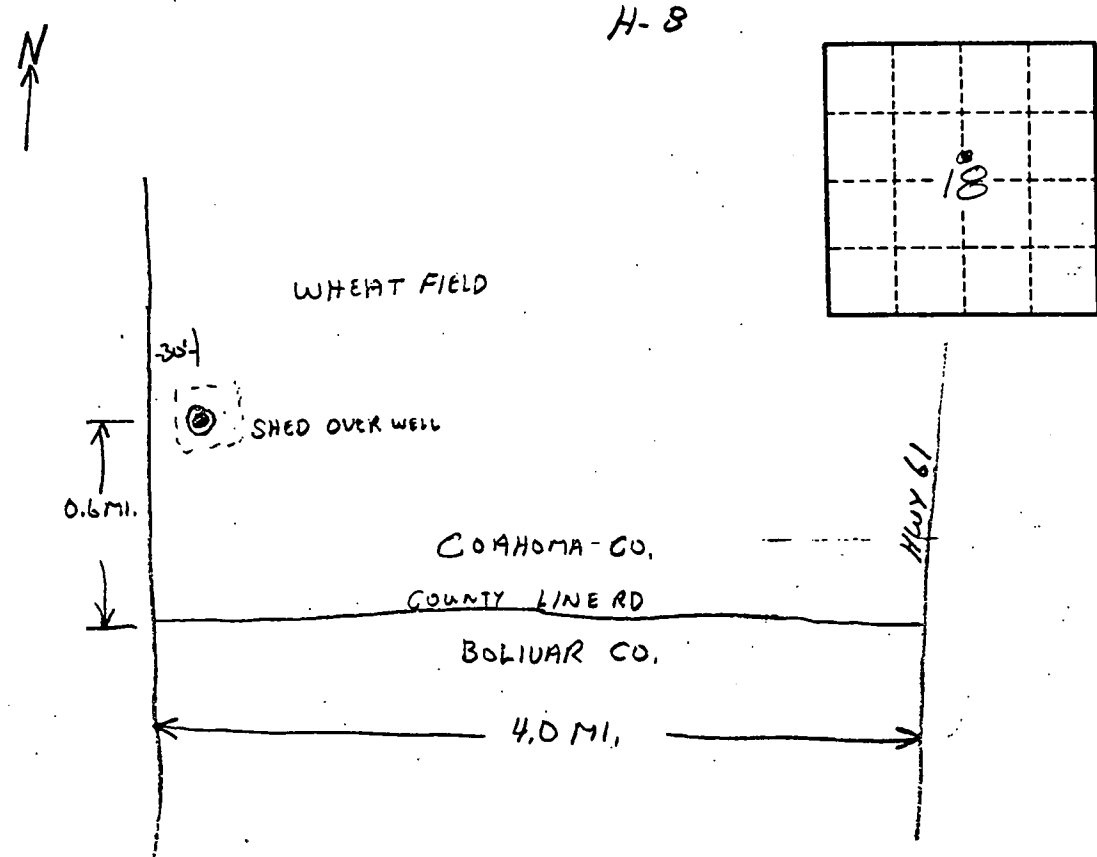

COAHOMA
H8
6-12-72

MISSISSIPPI
 BOARD OF WATER COMMISSIONERS
 416 North State Street
 Jackson, Mississippi 39201

WATER WELL DRILLERS LOG **CODED**

6-12 1972 FIVE COUNTY FARMERS ASSN COAHOMA
 date well completed firm name county well located

LANDOWNER: CE PRESLEY

638 CATALPA ST.

CLARKSDALE MISS.
 (mailing address)

WELL LOCATION:

sec. 18 T 26 (N) R 5 (E)
3 1/2 miles EAST of HILLHOUSE
 (distance) (direction) (nearest town)

WELL PURPOSE: IRRIGATION
 (home, irrigation, municipal, industrial)

WELL COMPLETION DATA:

- (1) diameter (inches) 14"
- (2) total depth (feet) 118'
- (3) static water level (feet) 12' below above top of ground.
- (4) casing SCHEDULE 40 70'
 (material) (depth)
14" If telescope see back.
 (size)
- (5) screen 48' 70'
 (length) (depth to top)
14" DOERR
 (size) (material)
- (6) pump 12" TURBINE
 (HP) (yield gpm)
INDUSTRIAL ENGINE
 (type power)
- (7) electric log No
 (yes or no)

(organization running log)

(8) how well bottom plugged WELDED

description of formations encountered

from to

CLAY	0	14
SAND	14	46
CLAY	46	53
SAND: CLAY	53	66
SAND: <u>GRAVEL</u>	66	118

CODED

JUN 15 1972

DRILLERS REMARKS:

MISS. BD. OF
 WATER COMM.

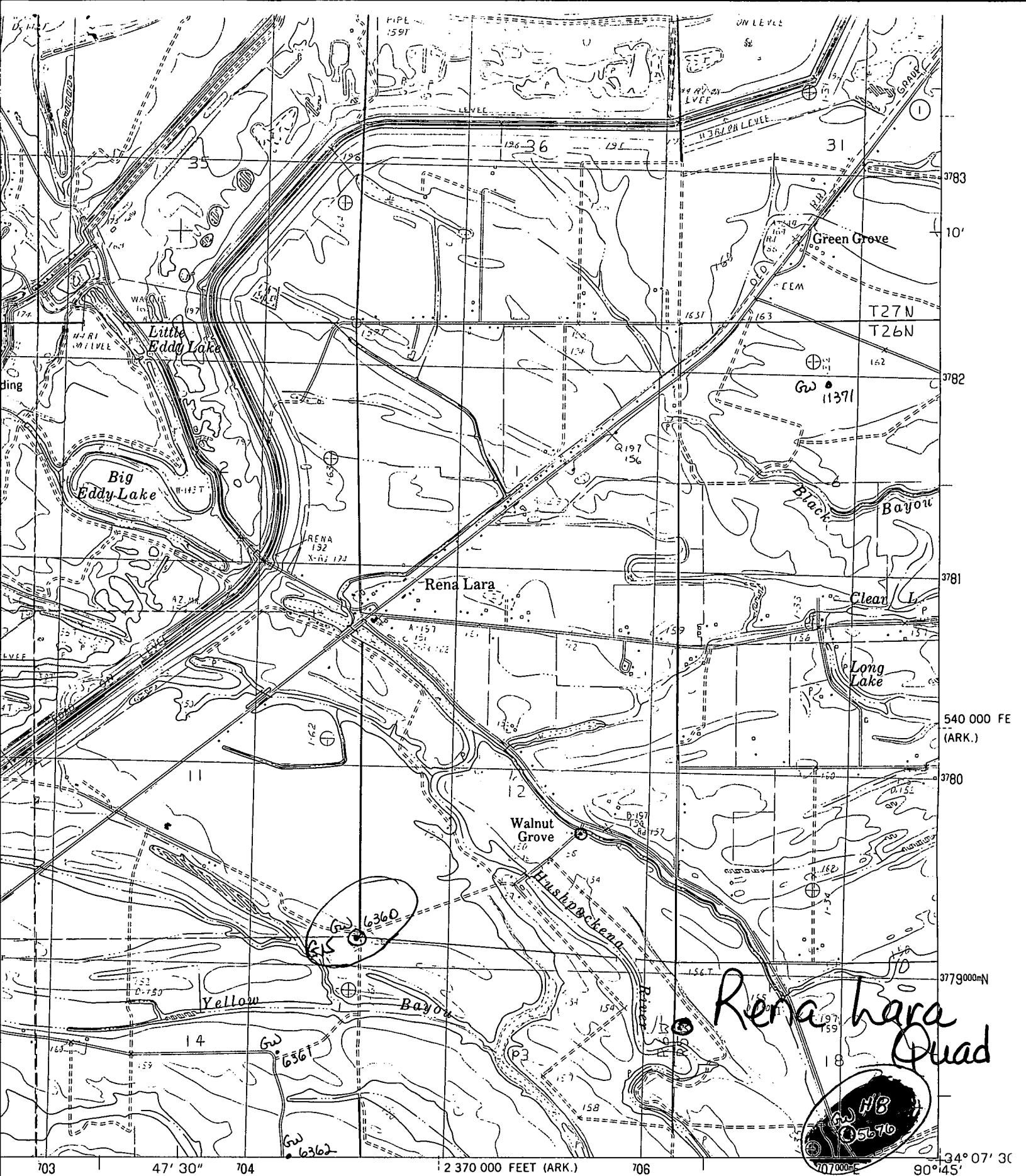

INTERIOR—GEOLOGICAL SURVEY, RESTON, VIRGINIA—1982

ROAD LEGEND

- Improved Road
- Unimproved Road
- Trail
- Interstate Route
- U.S. Route
- State Route

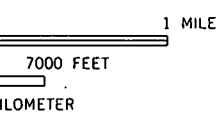

34° 07' 30"
90° 45' (DUNCAN)