

GW 6228

Friars Point

1/81 WTO

Recorded by JHH

U.S. GEOLOGICAL SURVEY  
WATER RESOURCES DIVISION  
MISSISSIPPI DISTRICT

Well No. E-200 <sup>37</sup>

Date 9/16/82

E-Log No. \_\_\_\_\_

County Coshama

<sup>67C</sup> WELL RECORD  
FRIARS POINT QUAD Elev. 157'

Site ID 341548090374601 R=0\* T=A\* 2=W\*

GEN. SITE DATA

Data reliab. 3=C\* Report. agency 4=USGS\* Dist. 6=28\* 7=28\* Co. 8=027\*

Lat. \_\_\_\_\_ Long. 9=341548\* 10=0903746\* Well No. 12=E037\*

Location 13=SWSE S29 T28 N R04 W\* Alt. 16=157\*

Hyd. Unit (OWDC) 20= Date 21=0911611982\*

Well use 23=W\* Water Use 24=I\* Hole depth 27= Well depth 28=110\*

WL 30=12\* Date 31=0911611982\* Source 33=S\*

Status 273= Project No. 5=

OWNER

R=158\* T=A\* Date 159#0110111982\* Owner No. \_\_\_\_\_

Owner 161# W. C. S. T. O. V. A. L. L. \*

Owner from permit: Belmont, Inc

FIELD QW

R=192\* T=A\* Date 193# Temp. 196#00010\* 197=

R=192\* T=A\* Date 193# Cond. 196#00095\* 197=

R=192\* T=A\* Date 193# pH 196#00400\* 197=

CONSTR.

R=58\* T=A\* 59#1\* Date 60=0110111982\* Remarks \_\_\_\_\_

Drlg. 63= Name \_\_\_\_\_ Method 65=R\* Finish 66=S\*

CASING

R=76\* T=A\* 59#1\*

Top csgn. 77# 0\* Bot. csgn. 78= Diam. 79# 6\*

R=76\* T=A\* 59#1\*

Top csgn. 77# Bot. csgn. 78= Diam. 79#

OPENINGS

R=82\* T=A\* 59#1\* Top 83# Bottom 84=

Type 85= Diam. 87= Size 88=

R=82\* T=A\* 59#1\* Top 83# Bottom 84=

Type 85= Diam. 87= Size 88=

YIELD

R= T=A\* 147# 1\* Q 150= Q/S 272=

134 flows 146 pumped

LIFT

R=42\* T= A \* Lift type 43# T\* Intake 44= \* Power type 45= \*

Date 38= 09/16/1982\* H.P. 46= \*

LOGS

R=198\* T= A \* Log 199# \* Top 200= \* Bot 201= \*

R=198\* T= A \* Log 199# \* Top 200= \* Bot 201= \*

R=189\* T= A \* E Log No. 190# \* 191= M I S S D I S T \*

ANAL.

R=114\* T= A \* Year 115# \* 117# \* 120# \*

AQUIFERS

R=90\* T= A \* 256# 1 \* Top 91= \* Bot 92= \*

Unit ID 93= 1.12 MRVA \* Name of Unit \_\_\_\_\_

R=90\* T= A \* 256# 1 \* Top 91= \* Bot 92= \*

Unit ID 93= \* Name of Unit \_\_\_\_\_

HYDRAULICS

R=98\* T= A \* 99# 1 \* Unit tested 100= \* 103= \*

R=105\* T= A \* 99# 1 \* Test No. 106# \*

107= \* Transmissivity (gal/d)/ft \_\_\_\_\_

108= \* Hydraul. cond. (gal/d)/ft<sup>2</sup> \_\_\_\_\_

110= \* Storage coeff. Boundaries \_\_\_\_\_

R=121\* T= A \* Yr Begin 122# 1982 \* Network 258# \*

Water Level Data Collection (1)

Irrigation well - 6" diam

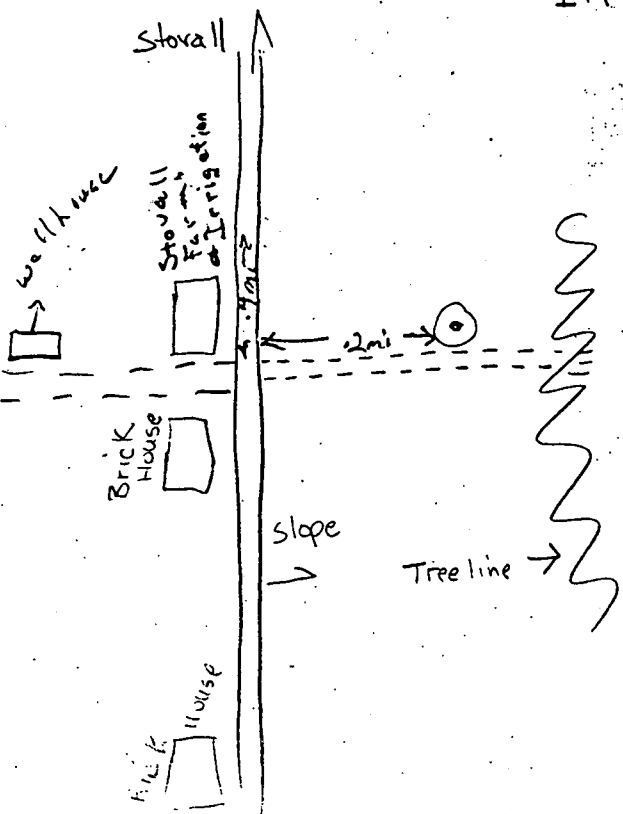

Held 32.50  
cut H<sub>2</sub>O 16.80  
15.70 ✓  
mp. 3.60'  
12.10

$E_s = (+ 244.90 - 144.50)$

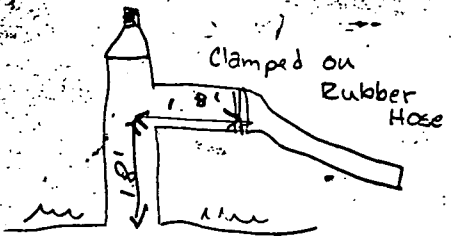

we unclamped hose and measure through ditch pipe

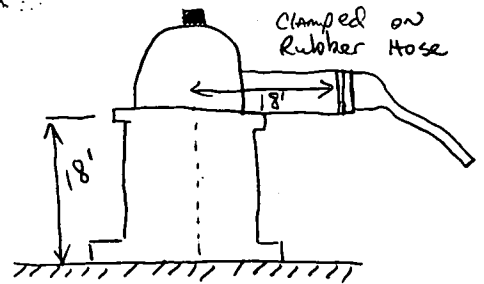
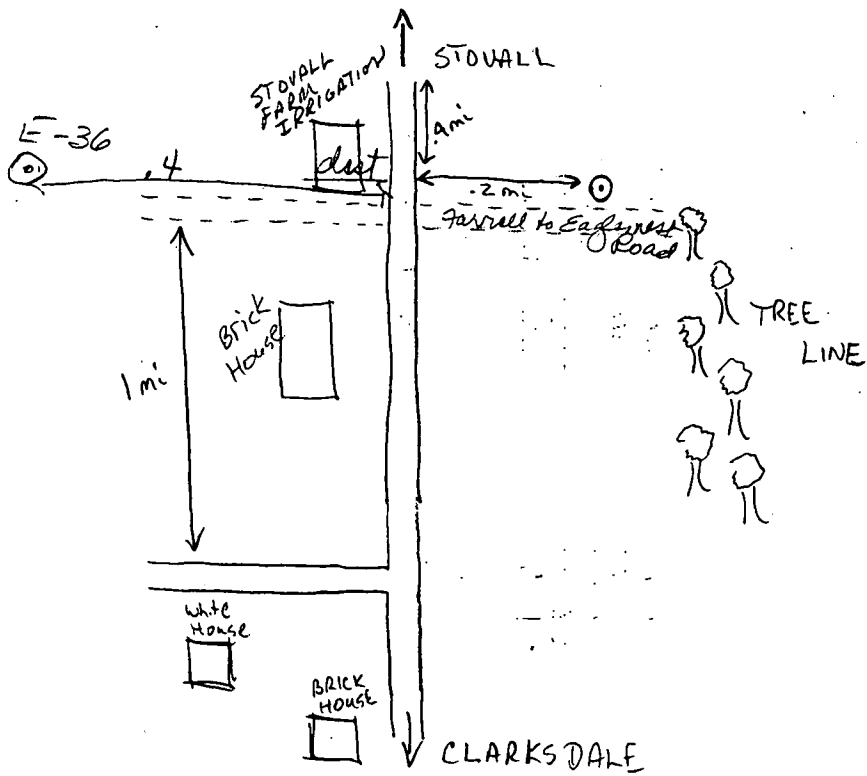

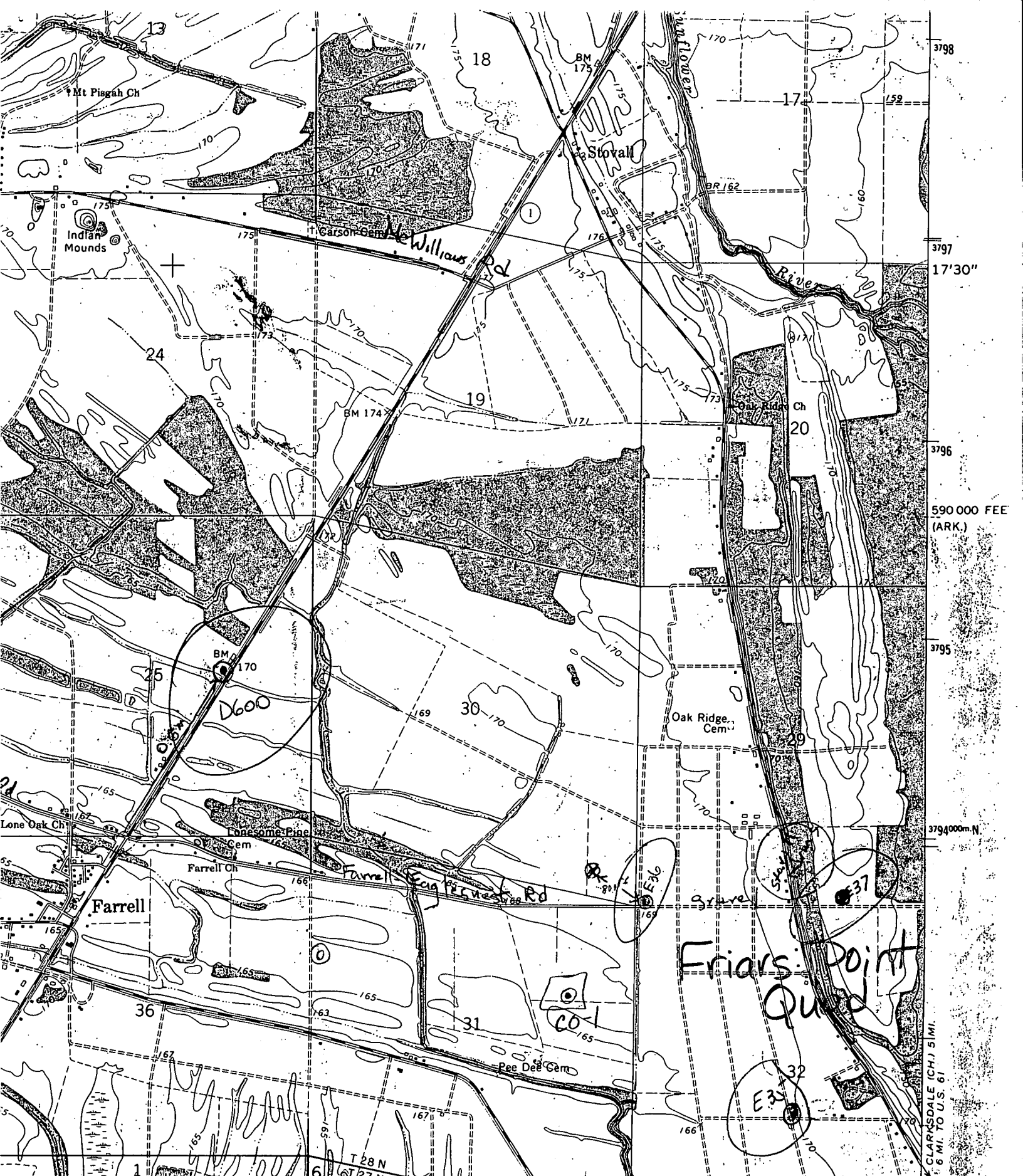

400 000 FEET (ARK.) 40' 715000m E. R. 5 W. R. 4 W. CLARKSDALE (CH.) 6 MI. 7 MI. TO U.S. 61

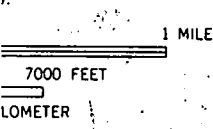

ROAD CLASSIFICATION  
 Medium-duty \_\_\_\_\_ Light-duty \_\_\_\_\_  
 Unimproved dirt =====

3798  
 3797  
 17'30"  
 3796  
 590 000 FEE (ARK.)  
 3795  
 3794000m N.  
 34° 15'  
 90° 37' 30"

2833 1' CLARKSDALE 1,62 500

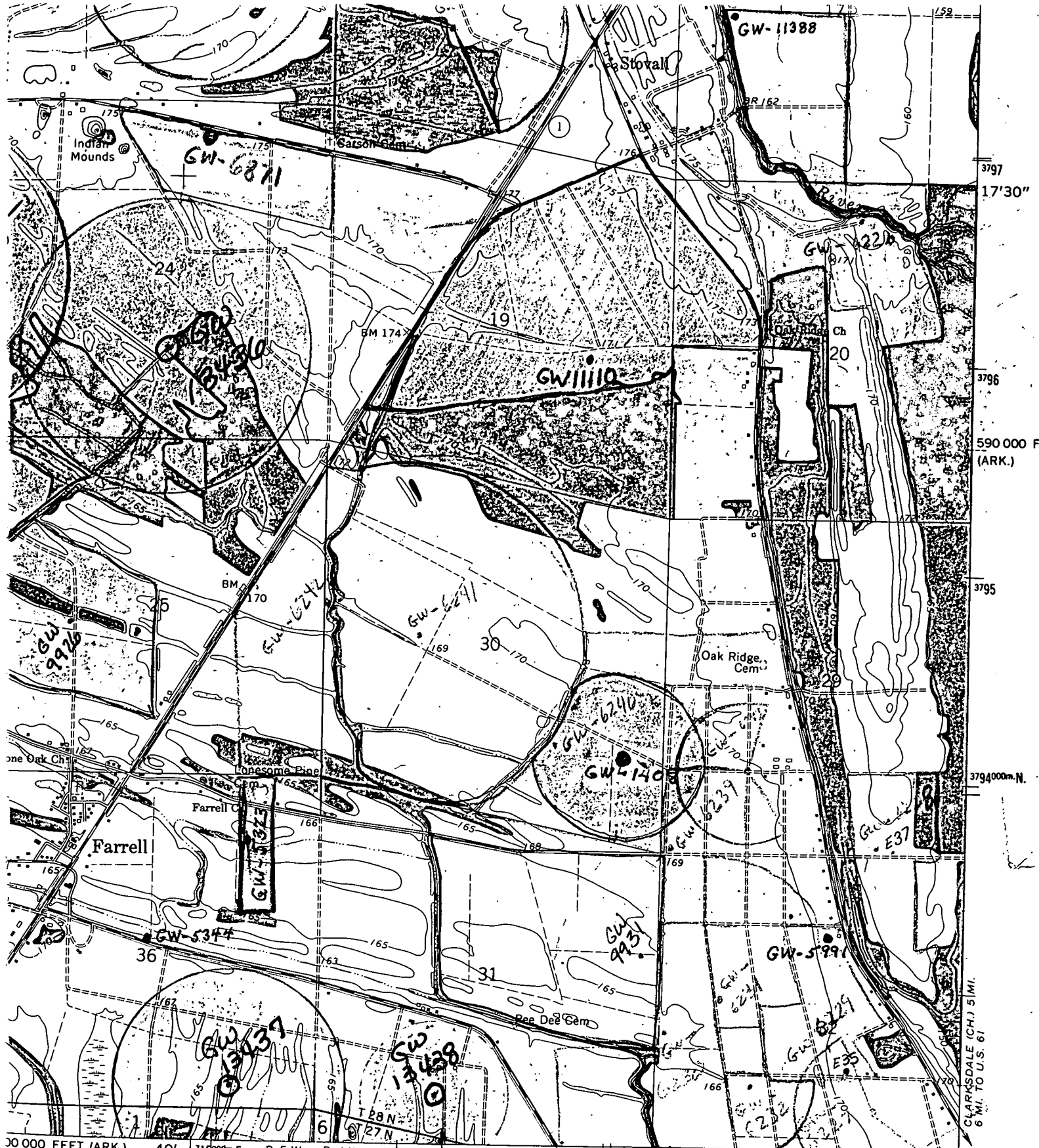

30 000 FEET (ARK.) 40' 715000m.E. R. 5 W. R. 4 W. CLARKSDALE (CH.) 6 MI. 7 MI. TO U.S. 61 INTERIOR- GEOLOGICAL SURVEY, WASHINGTON, D. C. - 1965 34° 15' 90° 37' 30"

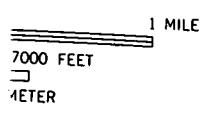

*con. Sherrard Quad*  
*con. Sherrard Quad*

ROAD CLASSIFICATION  
 Medium-duty ..... Light-duty .....  
 Unimproved dirt .....  
 ○ State-Route



FRIARS POINT, MISS.-ARK. 2852 CLARKSDALE (CH.) 5 MI. 6 MI. TO U.S. 61