

POINT TRANSMITTED FOR ADP
ELEV - 167

1/81 WTO

Recorded by RAM/JH
Date 9-16-82

U.S. GEOLOGICAL SURVEY
WATER RESOURCES DIVISION
MISSISSIPPI DISTRICT
WELL RECORD

Well No. D-381
E-Log No. _____
County Coahoma

Site ID 341542090410001 R=0* T=A* 2=W*

Data reliab. 3=C* Report. agency 4=USGS* Dist. 6=28* 7=28* Co. 8=02.7*

Lat. _____ Long. 9=341537* 10=0904104* Well No. 12=10037*

Location 13=SE NW S 35 T 28 N R 05 W Alt. 16=167.*

Hyd. Unit (OWDC) 20= _____ Date 21=0911611982*

Well use 23=W* Water Use 24=I* Hole depth 27= _____ Well depth 28=110.*

WL 30=17.* Date 31=0911611982* Source 33=S*

Status 273= _____ Project No. 5= _____

MP = HOLE IN CASING AT BOTTOM = .2"

R=158* T=A* Date 159# 0911611982* Owner No. _____

Owner 161# UNKNOWN

GEN. SITE DATA

OWNER

FIELD QW

CONSTR.

CASING

OPENINGS

YIELD

R=192* T=A* Date 193# _____ Temp. 196#00010* 197= _____
R=192* T=A* Date 193# _____ Cond. 196#00095* 197= _____
R=192* T=A* Date 193# _____ pH 196#00400* 197= _____

R=58* T=A* 59# 1* Date 60=0911611982* Remarks _____
Drlg. 63= _____ Name _____ Method 65=R* Finish 66=S*

R=76* T=A* 59# 1* Top csng. 77# 0.* Bot. csng. 78= _____ Diam. 79# 18.*

R=76* T=A* 59# 1* Top csng. 77# _____ Bot. csng. 78= _____ Diam. 79# _____

R=82* T=A* 59# 1* Top 83# _____ Bottom 84= _____

Type 85= _____ Diam. 87= _____ Size 88= _____

R=82* T=A* 59# 1* Top 83# _____ Bottom 84= _____

Type 85= _____ Diam. 87= _____ Size 88= _____

R= _____ T=A* 147# 1* Q 150= _____ Q/S 272= _____

134 flows 146 pumped

LIFT

R=42* T= A * Lift type 43# T* Intake 44= * Power type 45= D*
 Date 38= 09/16/1982* H.F. 46= 5.0.*

LOGS

R=198* T= A * Log 199# * Top 200= * Bot 201= *
 R=198* T= A * Log 199# * Top 200= * Bot 201= *
 R=189* T= A * E Log No. 190# * 191= M I S S D I S T *

ANAL.

R=114* T= A * Year 115# * 117= * 120= *

AQUIFERS

R=90* T= A * 256# 1 * Top 91= * Bot 92= *
 Unit ID 93= 112 MRVA * Name of Unit
 R=90* T= A * 256# 1 * Top 91= * Bot 92= *
 Unit ID 93= * Name of Unit

HYDRAULICS

R=98* T= A * 99# 1 * Unit tested 100= * 103= *
 R=105* T= A * 99# 1 * Test No. 106# *
 107= * Transmissivity (gal/d)/ft
 108= * Hydraul. cond. (gal/d)/ft²
 110= * Storage coeff. Boundaries

R=121* T= A * Yr Begin 122# 1982 * Network 258# *

Water Level Data Collection (1)

Holloshaft Turb. irr. pump
 50 HP Desid
 Casing 18" dia.

RAM/JH
 Held 45.00'
 28.27' 9-16-82
 16.73 ✓
 120
 16.53

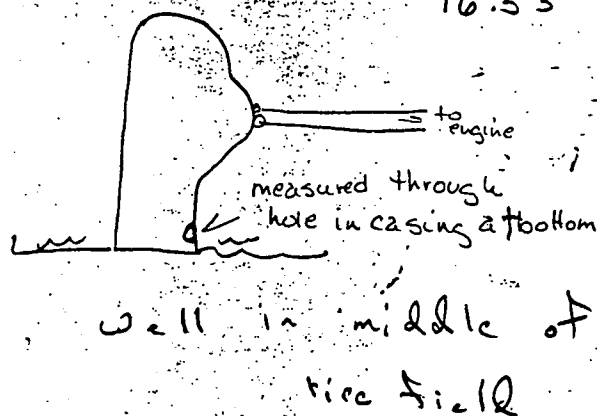
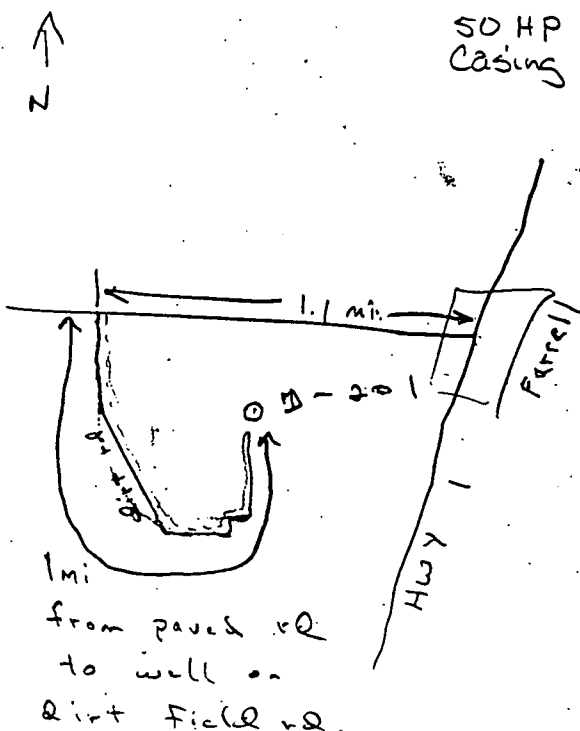

Es=(+150.47')

Well No D38
County COAHOMA

[illegible]

