

6/78 WTO

Recorded by MLP

Date 7-17-80

Rice Irrigation

TRANSMITTED FOR ADP

U.S. GEOLOGICAL SURVEY

WATER RESOURCES DIVISION

MISSISSIPPI DISTRICT

WELL RECORD

Well No. D-16

E-Log No. _____

County COAHOMA

#16

Site ID 5 19 R=0* T=A* 2=W* Coahoma

Data reliab. 3=C*^C Report. agency 4=USGS* Dist. 6=28* 7=28* Co. 8= _____

Lat. _____ Long. 9= _____ 10= _____ Well No. 12= _____

Location 13= NW SW S 23 T 28 N R 05 W * Alt. 16= 172 *

Hyd. Unit (OWDC) 20= _____ Date 21= 09/1/61/1980 *

Well use 23= _____ Water Use 24= I * Hole depth 27= _____ Well depth 28= _____

WL 30= 16 * Date 31= 09/1/71/1980 * Source 33= _____

Status 273= _____ Project No. 5= _____

R=158* T=A* Date 159# 1/1 * Owner No. _____

Owner 161= _____

R=192* T=A* Date 193# _____ * Temp. 196#00010* 197= _____ *

R=192* T=A* Date 193# _____ * Cond. 196#00095* 197= _____ *

R=192* T=A* Date 193# _____ * pH 196#00400* 197= _____ *

R=58* T=A* 59#1* Date 60= _____ * Remarks _____

Drilg. 63= _____ * Name _____ Method 65= _____ * Finish 66= _____ *

R=76* T=A* 59#1*

Top csng. 77# _____ * Bot. csng. 78= _____ * Diam. 79# _____ *

R=76* T=A* 59#1*

Top csng 77# _____ * Bot. csng. 78= _____ * Diam. 79# _____ *

R=82* T=A* 59#1* Top 83# _____ * Bottom 84= _____ *

Type 85= _____ * Diam. 87= _____ * Size 88= _____ *

R=82* T=A* 59#1* Top 83# _____ * Bottom 84= _____ *

Type 85= _____ * Diam. 87= _____ * Size 88= _____ *

YIELD R= _____ * T=A* 147# 1 * Q 150= _____ * Q/S 272= _____ *

134 flows 146 pumped

GEN. SITE DATA

OWNER

FIELD

CONSTR.

CASING

OPENINGS

YIELD

20.0
-2.16
-1.5
16.34
172
16.34
15.5

LIFT
 R=42* T= A * Lift type 43# * Intake 44= * Power type 45= *
 Date 38= / / * H.P. 46= *

LOGS
 R=198* T= A * Log 199# * Top 200= * Bot 201= *
 R=198* T= A * Log 199# * Top 200= * Bot 201= *
 R=189* T= A * E. Log No. 190# * 191= M I S S D I S T *

ANAL.
 R=114* T= A * Year 115# * Type 120= *

AQUIFERS
 R=90* T= A * 256# 1 * Top 91= * Bot 92= *
 Unit ID 93= * Name of Unit _____
 R=90* T= A * 256# 1 * Top 91= * Bot 92= *
 Unit ID 93= * Name of Unit _____

HYDRAULICS
 R=98* T= A * 99# 1 * Unit tested 100= * 103= *
 R=105* T= A * 99# 1 * Test No. 106# *
 107= * Transmissivity (gal/d)/ft _____
 108= * Hydraul. cond. (gal/d)/ft² _____
 110= * Storage coeff. Boundaries _____

R=121* T= * Yr Begin 122# * Network 258= *

Water Level Data Collection (1)

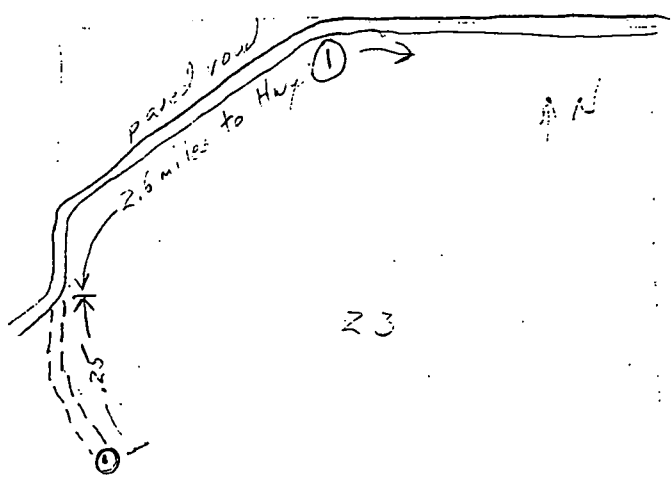

COAHOMA MISSISSIPPI BOARD OF WATER COMMISSIONERS

D 16

10-30-62

WATER WELL DRILLERS LOG

CODED

Date: 10/30, 1962, Driller: FIVE COUNTY FARMERS ASS'N County Coahoma

		Description & Color of Materials Sand, Clay, Red Clay, Shell, etc.	Thick- ness Feet	Depth Feet
(1) Owner of Land:	<u>John Peliquin</u> (Name)			
	<u>Stovall, Miss</u> (Address)	<u>Clay</u>	<u>40</u>	<u>40</u>
(2) Location:	<u>23 1/4</u> Sec. <u>23</u> <u>1/4</u> <u>W</u> (distance) (direction) (Nearest Town)	<u>Fine Sand</u>	<u>12</u>	<u>52</u>
		<u>Coarse Sand P. Hard</u>	<u>57</u>	<u>107</u>
(3) Topography:	(Hilly) (Flat) <input checked="" type="checkbox"/> (Level)			
(4) Purpose of Well:	<u>Irrigation</u> (Domestic Irrigation, Municipal, Industrial, Other)			

Information upon completion of well:

- (1) Diameter 16 inches.
- (2) Total Depth 107 feet.
- (3) Water Level 16 feet below top of ground.
- (4) Cased to 59, Size 16"
- (5) Screen: Size 12", Length 48"
- (6) Were any formations sealed against pollution?
 yes, no.

If YES depth of formation _____

Why _____

Drillers Remarks:

2800 G.P.M.

CODED

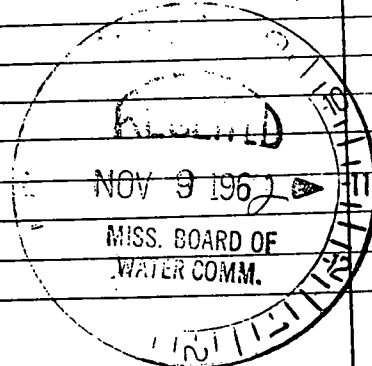

(Use Back Side)

Well No.

Mail this copy to Board of Water Commissioners 429 Miss. St. Jackson, Miss

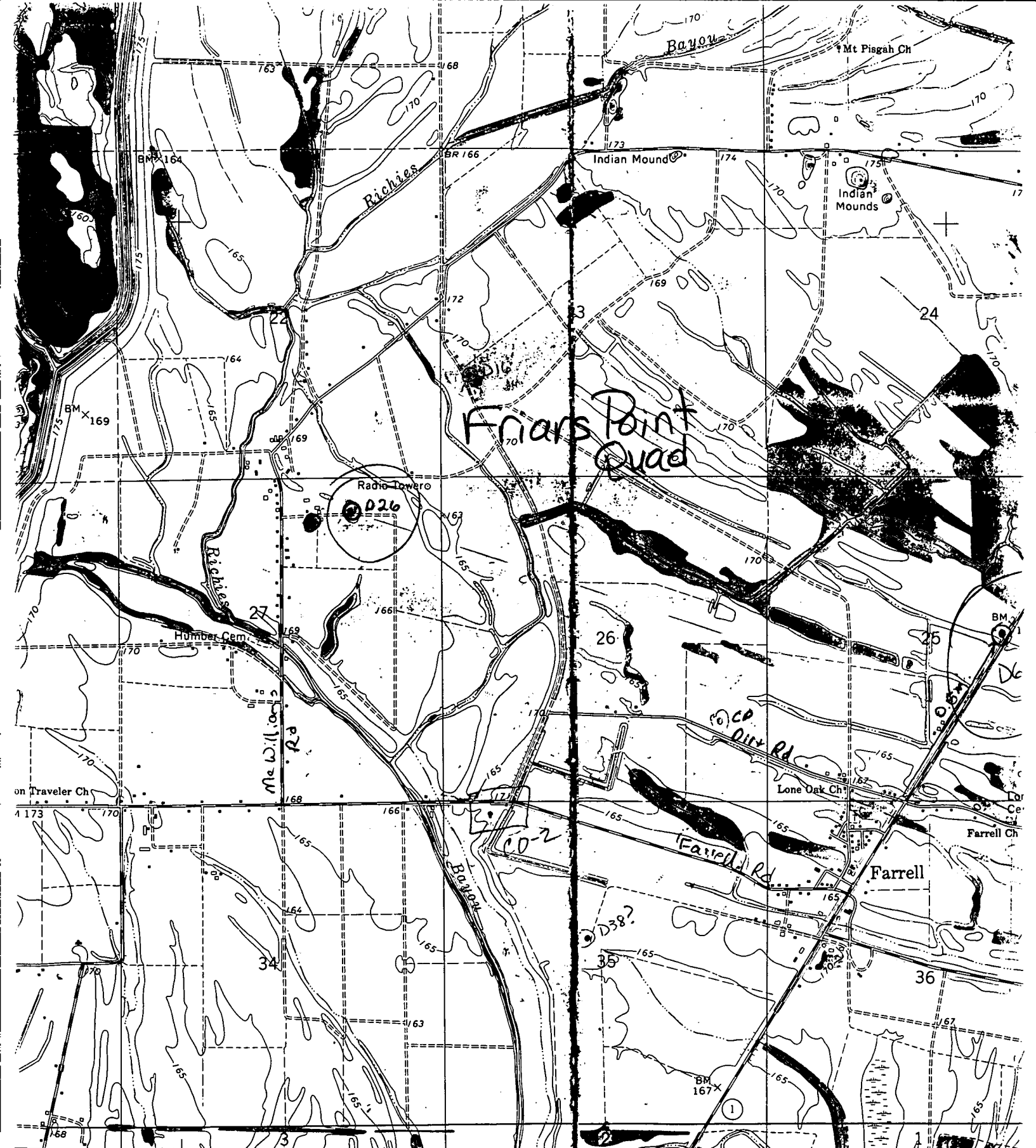

Friars Point Quad

