

WELL SCHEDULE

U. S. DEPT. OF THE INTERIOR

GEOLOGICAL SURVEY

WATER RESOURCES DIVISION

PUNCHED
OCT 30 1973

MASTER CARD

Record by GTD BEE Source of data Bowc Date 3-30-65 Map _____

State 28 County Coahoma (or town) 14

Latitude: 34 17 35 N Longitude: 090 40 40 Sequential number: 1

Lat-long accuracy: 3 T S, R W, Sec _____, _____, _____, _____ B & M

Local well number: D006AA2328NO5W Other number: _____

Local use: _____ Owner or name: _____

Owner or name: JOHN PELEGRI Address: _____

Ownership: (C) County, (F) Fed Gov't, (M) City, (N) Corp or Co, (P) Private, (S) State Agency, (W) Water Dist P

Use of water: (A) Air cond, (B) Bottling, (C) Comm, (D) Dewater, (E) Power, (F) Fire, (H) Dom, (I) Irr, (M) Med, (N) P S, (P) Rec, (S) Stock, (T) Inatit, (U) Unused, (V) Recharge, (W) Recharge, (X) Desal-P S, (Y) Desal-other, (Z) Other Low crop E

Use of well: (A) Anode, (D) Drain, (G) Seismic, (H) Heat Res, (I) Obs, (P) Oil-gas, (R) Recharge, (T) Test, (U) Unused, (W) Withdraw, (X) Waste, (Z) Destroyed. W

DATA AVAILABLE: Well data Freq. W/L meas.: Field aquifer char.

Hyd. lab. data: _____

Qual. water data; type: _____

Freq. sampling: Pumpage inventory: no, period: _____ yes

Aperture cards: _____ yes

Log data: D

WELL-DESCRIPTION CARD

SAME AS ON MASTER CARD Depth well: 99 ft Meas. rept accuracy 6

Depth cased: (first perf.) _____ ft Casing type: _____; Diam. in _____

Finish: (C) porous concrete, (F) gravel w. (perf.), (G) gravel w. (screen), (H) horiz. gallery, (I) open end, (J) open perf., (K) screen, (L) sd. pt., (M) shored, (N) open hole, (O) other S

Method: (A) air bored, (B) cable, (C) dug, (D) hyd, (E) jetted, (F) air reverse, (G) trenching, (H) driven, (I) drive wash, (J) other H

Date Drilled: 963 Pump intake setting: _____ ft

Driller: _____ name _____ address _____

Lift (type): (A) air, (B) bucket, (C) cent, (D) jet, (E) multiple, (F) multiple, (G) none, (H) piston, (I) rot, (J) submerg, (K) turb, (L) other T Deep Shallow

Power (type): (A) diesel, (B) elec, (C) gas, (D) gasoline, (E) hand, (F) gas, (G) wind, (H) H.P. 3 Trans. or meter no. _____

Descrip. MP _____ ft above _____ below LSD, Alt. MP _____

Alt. LSD: _____ Accuracy: (source) _____

Water Level: _____ ft above _____ below MP; _____ ft above _____ below LSD Accuracy: _____

Date meas: 1063 Yield: _____ gpm Method determined _____

Drawdown: _____ ft Accuracy: _____ Pumping period _____ hrs

QUALITY OF WATER DATA: Iron _____ ppm Sulfate _____ ppm Chloride _____ ppm Hard. _____ ppm

Sp. Conduct _____ K x 10 6 Temp. _____ °F Date sampled _____

Taste, color, etc. _____

Well No. D6

HYDROGEOLOGIC CARD

SAME AS ON MASTER CARD Physiographic Province: _____ 03 Section: _____
 Drainage Basin: 15H Subbasin: _____

(D) (C) (E) (F) (H) (K) (L)
 Topo of depression, stream channel, dunes, flat, hilltop, sink, swamp,
 well site: (O) (P) (S) (T) (U) (V) _____
 offshore, pediment, hillside, terrace, undulating, valley flat _____

MAJOR AQUIFER: _____ system _____ series OG _____ aquifer, formation, group MA

Lithology: _____ Origin: _____ 5R 2 Aquifer Thickness: _____ ft
 Length of well open to: _____ ft 48 Depth to top of: _____ ft 17

MINOR AQUIFER: _____ system _____ series _____ aquifer, formation, group _____
 Lithology: _____ Origin: _____ Aquifer Thickness: _____ ft

Length of well open to: _____ ft _____ Depth to top of: _____ ft _____

Intervals Screened:

Depth to consolidated rock: _____ ft _____ Source of data: _____

Depth to basement: _____ ft _____ Source of data: _____

Surficial material: _____ Infiltration characteristics: _____

Coefficient Trans: _____ gpd/ft _____ Coefficient Storage: _____

Coefficient Perm: _____ gpd/ft²; Spec cap: _____ gpm/ft; Number of geologic cards: _____

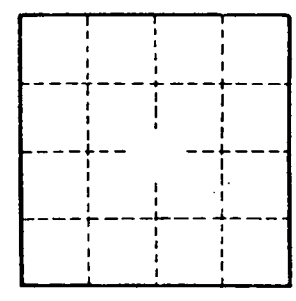
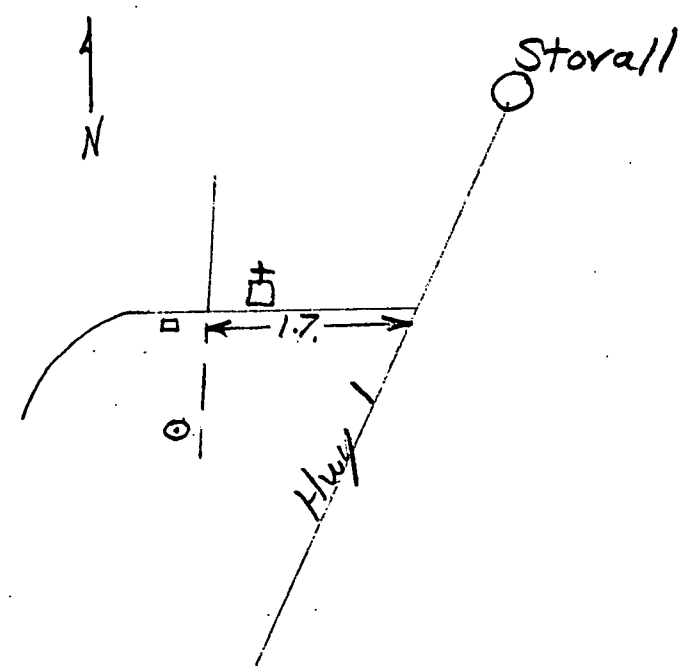

Well No. _____

D6