

WRD Exp. (GW)
April 1966

GW12867
DOH #14003-01

Well No. C27

WELL SCHEDULE

Elog #14

U. S. DEPT. OF THE INTERIOR

GEOLOGICAL SURVEY

WATER RESOURCES DIVISION

MASTER CARD

Record by WTR Source of data MSG Date 5/69 Map _____

State 28 County (or town) Coahoma 14

Latitude: 34° 22' 00" N Longitude: 09° 03' 15" W Sequential number: 1

Lat-long accuracy: 2 T. 290 S, R 3 E Sec 20, SE $\frac{1}{4}$, NE $\frac{1}{4}$, SE $\frac{1}{4}$

Local well number: C027AD2029N03W Other number: _____ B & M

Local use: 021014 Owner or name: Coahoma Utilities Assoc. Inc.

Owner or name: COAHOMA W. A. Address: _____

Ownership: County, Fed Gov't, City, Corp or Co, Private, State Agency, Water Dist _____ N

Use of water: (A) Air cond, Bottling, Comm, Dewater, Power, Fire, Dom, Irr, Med, Ind, P S, Rec, (S) Stock, Instit, Unused, Repressure, Recharge, Desal-P S, Desal-other, Other _____ P

Use of well: (A) Anode, Drain, Seismic, Heat Res, Obs, Oil-gas, Recharge, Test, Unused, Withdraw, Waste, Destroyed _____ W

DATA AVAILABLE: Well data Freq. W/L meas.: Field aquifer char. _____

Hyd. lab. data: _____

Qual. water data; type: _____ 3/71

Freq. sampling: Pumpage inventory: no, period: _____

Aperture cards: _____

Log data: Elog 174 - 1225' VE

WELL-DESCRIPTION CARD

SAME AS ON MASTER CARD Depth well: _____ ft 1075 Meas. accuracy _____ 3

Depth cased: _____ ft 1035 Casing type: _____; Diam. 8x4 in _____ 8

Finish: (C) porous concrete, (F) gravel w. concrete, (G) gravel w. (screen), (H) horiz. open end, (Ø) open perfor., (S) screen, (T) sd. pt., (W) shored, (X) open hole, (Z) other _____ S

Method: (A) air rot, (B) bored, (C) cable, (D) dug, (H) hyd. rot., (J) jetted, (P) air percussion, (R) reverse, (T) trenching, (V) driven, (W) drive wash, (Z) other _____ H

Date Drilled: 5/21/69 964 Pump intake setting: _____ ft _____

Driller: HERNDON - HOMAN

Lift (type): (A) air, (B) bucket, (C) cent., (J) jet, (L) multiple, (M) multiple, (N) none, (P) piston, (R) rot, (S) submerg, (T) turb, (Z) other _____ T Deep _____ Shallow

Power (type): nat, diesel, elec, gas, gasoline, hand, gas, wind; LP, H.P. _____ 20 V Trans. or meter no. _____

Descrip. MP _____ ft above _____ below LSD, Alt. MP _____

Alt. LSD: _____ 175 Accuracy: (source) _____ topo

Water Level: _____ ft (below) MP; _____ ft below LSD _____ 8 Accuracy: _____

Date meas: _____ 274 Yield: @ 30' gpm _____ 150 Method determined _____

Drawdown: 2 gpm / ft _____ Accuracy: _____ Pumping period _____ hrs _____

QUALITY OF WATER DATA: Iron _____ ppm Sulfate _____ ppm Chloride _____ ppm Hard. _____ ppm

Sp. Conduct _____ 650 K x 10⁶ _____ 4 Temp. _____ °F _____ 220 Date sampled _____ 371

Taste, color, etc. _____

C 41

Yes

NOV 20 1974

WL Lake

11/30/88

QCL-12.75

15H

PUNCHED AND VERIFIED
ROLLA COMPUTATION BRANCH

Well No.

p- 20 f- 2.1

GW14030021
C-27

RECEIVED

JUL 13 1990
fee paid
Department of Natural Resources
Bureau of Land & Water Resources

FORM BLW-AP-1
(rev. 10/88)

The box below is for office use only. MUWX

Issued: <u>10-9-90</u>	Expires: <u>10-9-2000</u>	Fee Paid: <input checked="" type="checkbox"/>	Permit No. <u>60-12867</u>
Lat. <u>34-21-57</u>	Long. <u>90-31-20</u>	Elev. <u>171'</u>	USGS No.
Quad. <u>COAHOMA</u>	Dist.		Basin No. <u>0B030204</u>
STAC			Dam Inv. No.
			Dam appl. No.

Dept. of Natural Resources, Bureau of Land and Water Resources, P.O. Box 10631, Jackson, MS 39289-0631

APPLICATION FOR PERMIT TO DIVERT OR WITHDRAW FOR BENEFICIAL USE THE PUBLIC WATERS OF THE STATE OF MISSISSIPPI

This application is for (circle one) GROUNDWATER SURFACE WATER

Beneficial Use (circle one or more): Irrigation Fish Culture Municipal Rural Water Association Industrial
Recreator Institutional (Examples: Church, School) Commercial (Examples: Hotel, Restaurant) Livestock Stand-y
Fire Protection Flood Protection Other: _____

LANDOWNER:

Town Of Coahoma Water Department 64-0681127

(Name) _____ (S/S or Tax ID No.)

P.O. Box 103

(Address) _____

Coahoma MS 38617 (601) 337-2709

(City) _____ (State and Zip) _____ (Telephone Number)

APPLICANT, AGENT, OR LESSEE (If different from Landowner):

(Name) _____ (S/S or Tax ID No.)

(City) _____ (State and Zip) _____ (Telephone Number)

Location of diversion/withdrawal point (A suitable location map must accompany this application):

SE SE 20 29N 3W Coahoma

Volume of water diverted/withdrawn (Choose "a", "b", "c", or "d" ["d" is for units other than those shown in "a", "b", or "c"]):

- (a) _____ acre-feet per year at a maximum rate of _____ gallons per minute
- (b) 0.05 million gallons per day at a maximum rate of 160 gallons per minute
- (c) _____ acre feet of storage at normal pool
- (d) _____ per _____ at a maximum rate of _____

Construction of proposed work will begin on (date) Oct. 3, 19 89 and will be completed by (date) Oct. 3, 19 89

Water will be used from (month) January to (month) December each year.

Give the land to which this application pertains have any source(s) of water other than that for which you are now applying (circle one):
yes no If yes, describe the nature and extent of any additional supply and, if applicable, list permit number.

SECTION A (to be completed if application is for surface water source)

- Source of water is from _____ which drains into _____ which drains into _____ which drains into _____
- Description of pump/diversion works:
 - (a) Pump (size and type): _____ Power Unit (size and type): _____
 - Lift: _____ feet Maximum capacity: _____ gallons per minute.
 - (b) Name of storage reservoir: _____ Dam height: _____ (ft.)

(Continued on back)

SECTION B. (to be completed if application is for groundwater source)

1. Source of water is Meridian aquifer
2. Description of proposed water well:
- (a) DEPTH OF WELL: 1075 feet. DRILLER (name): Herndon
- (b) SURFACE CASING: Length: 300 feet. Diameter: 8 inches. Type: Steel
- (c) SCREEN: Length: 40 feet. Diameter: 4 inches. Type: Stainless Steel, Louvered
- (d) PUMP: Type: Vertical Turbine. Size: 8". Capacity: 160 gallons per minute.
Number of stages: 11 Setting depth: 130 feet.
- (e) POWER UNIT: Type: Vertical Electric Motor. Size: 20 horsepower.
- (f) TYPE OF COMPLETION: _____

WATER USE DATA:

If for IRRIGATION, FISH CULTURE or any other areal use, show the number of acres to which water will be applied in the appropriate 40-acre block(s). Acreage must be shown on accompanying location map.

TOWN-SHIP	RANGE	SECTION	NE1/4				NW1/4				SW1/4				SE1/4				TOTAL	
			NE1/4	NW1/4	SW1/4	SE1/4	NE1/4	NW1/4	SW1/4	SE1/4	NE1/4	NW1/4	SW1/4	SE1/4	NE1/4	NW1/4	SW1/4	SE1/4		

1. IRRIGATION: List the number of acres of each crop to be irrigated: Rice _____; Cotton _____; Soybeans _____; Corn _____; Pasture _____; Truck _____; Wheat _____; Oats _____; Grain sorghum _____; Other (specify) _____ acres

2. FISH CULTURE: Explain how water will be used: _____
How often will reservoir(s) be emptied and refilled? _____

3. MUNICIPAL or WATER ASSOCIATION

Choose "a" or "b". (a) The number of people served is _____. (b) The number of connections/customers is _____
What is the estimated average daily consumption during periods of maximum use at the end of each five-year period during the next twenty years?

<u>.0576</u>	<u>1995</u>	<u>.0192</u>	<u>2000</u>	<u>.0192</u>	<u>200</u>	<u>.0192</u>	<u>20</u>
(Volume)	(Year)	(Volume)	(Year)	(Volume)	(Year)	(Volume)	(Year)

4. INDUSTRIAL: If water is to be released into a watercourse, indicate the amount released each year:
Rate of release _____; Location of release point in reference to diversion/withdrawal point _____; Explain any change in quality of water to be released: _____
N DES Permit No. _____
Explain how water will be used: _____

How much groundwater will be used for once-through non-contact cooling? _____

5. RECREATION: Explain how water will be used: _____

6. OTHER use: Explain in detail: _____

REMARKS: _____

List below the person to be contacted for additional information if required:

W. J. Jones, Mayor
(Name)
Post Office Box 103
(Address)
Coahoma, MS 38617
(City, State, Zip)
601-337-2709 or 601-358-4496
(Telephone)

The accompanying map is hereby declared a part of this application. The TEN DOLLAR (\$10.00) permit fee is enclosed herewith.

Alice Smith, Clerk
(Signature)
Waynes Orr, Chancery Clerk
by: Waynes Orr, Chancery Clerk
Waynes Orr, Chancery Clerk

Subscribed and sworn to before me this _____ day of _____

DEPARTMENT OF ENVIRONMENTAL QUALITY - OLWR
PUBLIC SUPPLY WELLS PROJECT

GPS LOG

USER NAME(S): GRANTHAM DATE: 5-7-97
UNIT DEQ #: _____ FILE #: B050716A
HEALTH DEPT. #: 140003-01 ELEV. 175
USGS #: C-97 OLWR #: MS-GW-12867
OWNER: Town of Coahoma
LOCATION: SE, NE, SE S 20 T 29R 3W COUNTY: Coahoma
LOCATION DESCRIPTION: Street Parallel to St on E side of RR
CASING DIA: 8" PUMP TYPE & SIZE: destroyed Plugged
GPS FIELD LOCATION: LAT. 34.22013 LONG. 90.3119.0
GPS CORRECTED LOCATION: LAT. 34.367036 LONG. 90.52197485
REMARKS: Well destroyed + cemented -

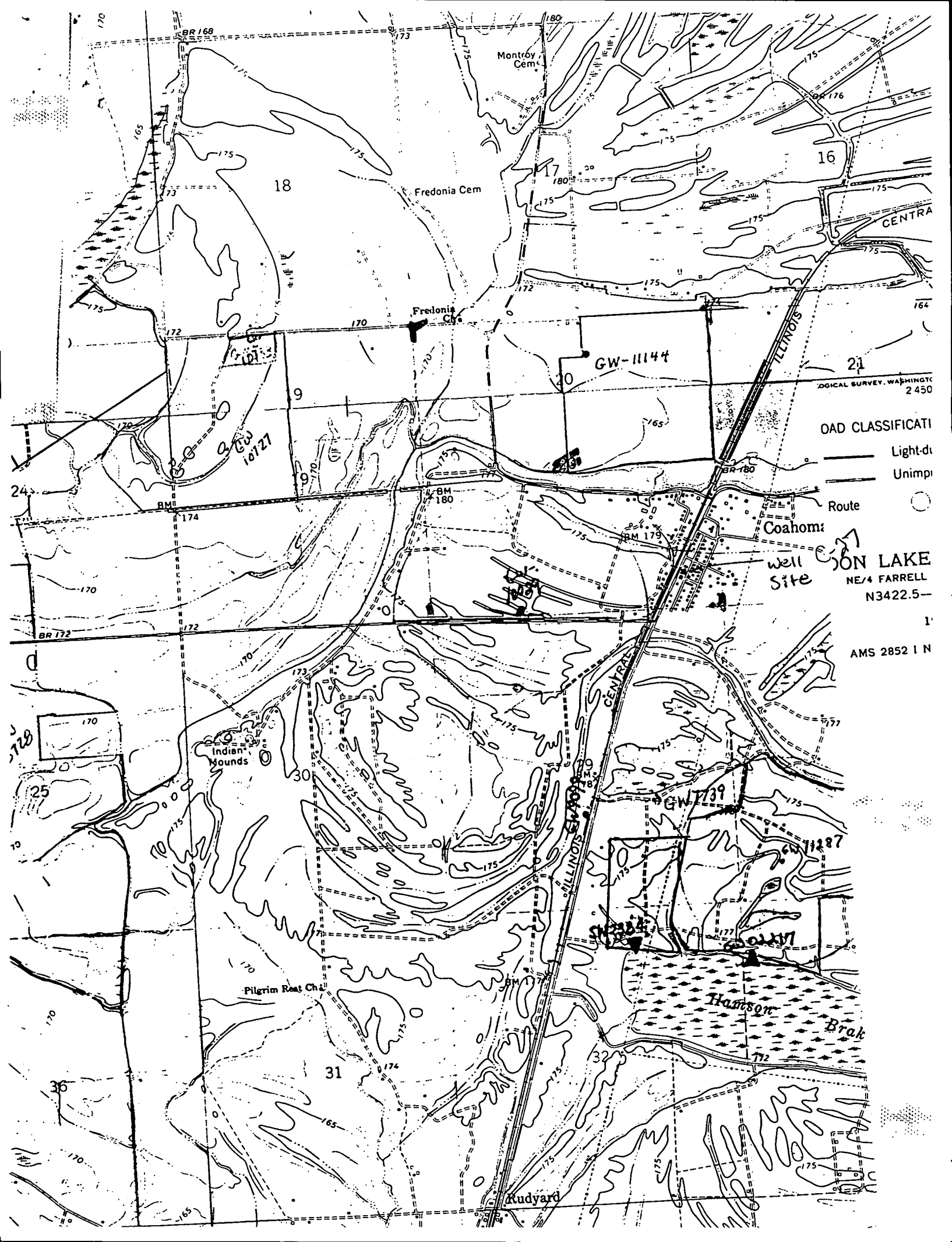

BR 168

Monroy Cem

Fredonia Cem

Fredonia Ch

GW-11144

GW 10127

LOGICAL SURVEY, WASHINGTON
2450

ROAD CLASSIFICATION

- Light-d
- Unimp
- Route

Coahom

well site

SON LAKE
NE/4 FARRELL
N3422.5-

AMS 2852 1 N

Indian Mounds

Pilgrim Rest Ch

Hanson

Brak

Rudyard

128

25

30

36

31

32

36

170

175

173

175

172

170

174

170

172

170

172

170

170

170

170

170

170

170

170

170

170

173

175

173

175

172

170

174

170

172

170

172

170

170

170

170

170

170

170

170

170

170

173

175

173

175

172

170

174

170

172

170

172

170

170

170

170

170

170

170

170

170

170

173

175

173

175

172

170

174

170

172

170

172

170

170

170

170

170

170

170

170

170

170

173

175

173

175

172

170

174

170

172

170

172

170

170

170

170

170

170

170

170

170

170

173

175

173

175

172

170

174

170

172

170

172

170

170

170

170

170

170

170

170

170

170

173

175

173

175

172

170

174

170

172

170

172

170

170

170

170

170

170

170

170

170

170

173

175

173

175

172

170

174

170

172

170

172

170

170

170

170

170

170

170

170

170

170

173

175

173

175

172

170

174

170

172

170

172

170

170

170

170

170

170

170

170

170

170

173

175

173

175

172

170

174

170

172

170

172

170

170

170

170

170

170

170

170

170

170

173

175

173

175

172

170

174

170

172

170

172

170

170

170

170

170

170

170

170

170

170

173

175

173

175

172

170

174

170

172

170

172

170

170

170

170

170

170

170

170

170

170

173

175

173

175

172

170

174

170

172

170

172

170

170

170

170

170

170

170

170

170

170

173

175

173

175

172

170

174

170

172

170

172

170

170

170

170

170

170

170

170

170

170

173

175

173

175

172

170

174

170

172

170

172

170