

67c

Well No. B 20

WELL SCHEDULE

U. S. DEPT. OF THE INTERIOR GEOLOGICAL SURVEY WATER RESOURCES DIVISION

342145090381201

090381201

E-log #15

MASTER CARD

Record by JEF Source of data Bowc Date 2/6/70 Map FRIARS POINT 67c  
State 34-21-45 1 28 County COAHOMIA CO. 14  
Latitude: 34 22 18 N Longitude: 090 38 22 Sequential number: 1  
Lat-long accuracy: 2 29 4 20 W 1/2 NW SW  
Local well number: B 0 - 0 B E 20 29 N D 4 W Other number: #3  
Local use: 1015 Owner or name: FRIARS POINT Address: Town of Friars P

Ownership: County, Fed Gov't, City, Corp or Co, Private, State Agency, Water Dist 7  
Use of water: (S) (T) (U) (V) (W) (X) (Y) (Z) 7  
Use of well: (A) (D) (G) (H) (I) (J) (K) (L) (M) (N) (O) (P) (R) (S) (T) (U) (V) (W) (X) (Y) (Z) 7  
DATA AVAILABLE: Well data 7 Freq. W/L meas.: 7 Field aquifer char. 7  
Hyd. lab. data: 7  
Qual. water data; type: USGS 3/71  
Freq. sampling: 7 Pumpage inventory: 7  
Aperture cards: 7  
Log data: C Log - 180' - 1440' DE

WELL-DESCRIPTION CARD

SAME AS ON MASTER CARD Depth well: 815 ft Meas. rept. accuracy 3  
Depth cased: 754 ft Casing type: STEEL; Diam. 8 1/2 in  
Finish: (C) porous concrete, (F) gravel w. concrete, (G) gravel w. (screen), (H) horiz. gallery, (I) open end, (J) open perf., (K) screen, (L) sd. pt., (M) shored, (N) open hole, (O) other 5  
Method Drilled: (A) air rot., (B) bored, (C) cable, (D) dug, (E) hyd jetted, (F) air rot., (G) percussion, (H) rotary, (I) reverse, (J) trenching, (K) driven, (L) drive wash, (M) other 7  
Date Drilled: 7 7 70 Pump intake setting: 36 ft  
Driller: 125/6  
Lift (type): (A) air, (B) bucket, (C) cent., (D) jet, (E) multiple, (F) multiple, (G) none, (H) piston, (I) rot., (J) submerg, (K) turb., (L) other 7 Deep 7 Shallow 40  
Power (type): (A) diesel, (B) elec, (C) gas, (D) gasoline, (E) hand, (F) gas, (G) wind, (H) H.P. 20 7 Trans. or meter no. 7  
Descrip. MP 175 ft above below LSD, Alt. MP 175 Accuracy: (source) Topo 7  
Water Level 37 ft above below MP; Ft. below LSD 37 Accuracy: 7 D  
Date meas.: 2 7 0 Yield: 406 gpm Method determined 7  
Drawdown: 7 ft Accuracy: 7 Pumping period 7 hrs 7  
QUALITY OF WATER DATA: Iron 7 ppm Sulfate 7 ppm Chloride 7 ppm Hard. 7 ppm  
Sp. Conduct 1000 K x 10<sup>6</sup> 4 Temp. 21 °F 21 0 Date sampled 3/10/71 3 7 1  
Taste, color, etc. 7

PUNCHED and VERIFIED  
ROLLA COMMUNICATIONS

Well No.

125/6  
WLL MP - 29  
117  
13  
10/20/89  
40.40

Well No. B 20

Latitude-longitude \_\_\_\_\_

HYDROGEOLOGIC CARD

Physiographic Province: 3E Section: \_\_\_\_\_  
SAME AS ON MASTER CARD  
Drainage Basin: E Subbasin: 1151F  
Topo of well site: (D) depression, stream channel, dunes, flat, hilltop, sink, swamp, (E) (P) (R) (K) (L) (S) (T) (U) (V) offshore, pediment, hillside, terrace, undulating, valley flat  
MAJOR AQUIFER: system \_\_\_\_\_ series TE aquifer, formation, group SS  
Lithology: \_\_\_\_\_ Origin: 2 Aquifer Thickness: 63+ ft  
Length of well open to: 57 ft Depth to top of: 754 ft  
MINOR AQUIFER: system \_\_\_\_\_ series \_\_\_\_\_ aquifer, formation, group \_\_\_\_\_  
Lithology: \_\_\_\_\_ Origin: \_\_\_\_\_ Aquifer Thickness: \_\_\_\_\_ ft  
Length of well open to: \_\_\_\_\_ ft Depth to top of: \_\_\_\_\_ ft  
Intervals Screened: 6" STAINLESS  
Depth to consolidated rock: \_\_\_\_\_ ft Source of data: \_\_\_\_\_  
Depth to basement: \_\_\_\_\_ ft Source of data: \_\_\_\_\_  
Surficial material: \_\_\_\_\_ Infiltration characteristics: \_\_\_\_\_  
Coefficient Trans: \_\_\_\_\_ gpd/ft Coefficient Storage: \_\_\_\_\_  
Coefficient Perm: \_\_\_\_\_ gpd/ft<sup>2</sup>; Spec cap: \_\_\_\_\_ gpm/ft; Number of geologic cards: \_\_\_\_\_

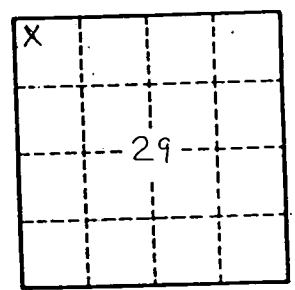
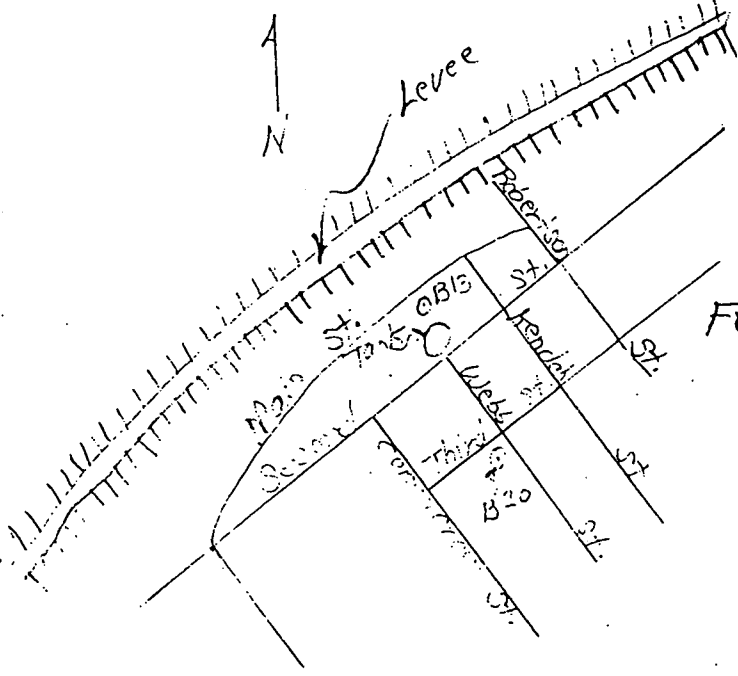

Friars Point

pumping test by driller  
6-4-1970  
static water level = -33'  
specific capacity = 20 gpm/ft. of d.d.

UP-DATED \_\_\_\_\_

COAHOMA  
BZO  
3-5-10

MISSISSIPPI  
BOARD OF WATER COMMISSIONERS  
416 North State Street  
Jackson, Mississippi 39201

11-1-15  
**CODED**

WATER WELL DRILLERS LOG

3-5 1920 Kendox Home Well Supply Coahoma  
date well completed firm name County well located

LANDOWNER	description of formations encountered	from	to
Town of Friars Point	Brown Loam	0	10
Friars Point, Miss	Grey Clay	10	20
(mailing address)	Sand	20	90
WELL LOCATION	Gravel	90	120
sec. 29 T. 29 N. R. 4 E	Sand	120	160
(distance) (direction) (nearest town)	Green Gumbo	160	330
WELL PURPOSE: Municipal	Sand	330	336
(home, irrigation, municipal, industrial)	Lime Rock	336	375
WELL COMPLETION DATA:	Sand	375	500
(1) diameter (inches) 8" x 6"	Gumbo	500	515
(2) total depth (feet) 817'	Sand	515	600
(3) static water level (feet) 37 below top of ground	Gumbo	600	620
(4) casing Steel 754' (material) (depth)	Sand	620	716
8" (size) If telescope see back.	Gumbo	716	750
(5) screen 61' (length) (depth to top)	Sand	750	795
6" Stainless Ribbed (size) (material)	Gumbo	795	799
(6) pump 30 (HP) 406 (yield gpm)			
Electric (type power)			
(7) electric log yes (yes or no)			
USGS (organization running log)			
(8) how well bottom plugged B/w valve			
DRILLERS REMARKS:			

**CODED**



**RECEIVED**

**APPLICATION FOR PERMIT TO DIVERT OR WITHDRAW  
FOR BENEFICIAL USE THE PUBLIC WATERS OF THE STATE OF MISSISSIPPI**

MAY 1 2000

DEPARTMENT OF ENVIRONMENTAL QUALITY, OFFICE OF LAND AND WATER RESOURCES

P.O. BOX 10631, JACKSON, MS 39289-0631; (601) 961-5202

Dept. of Environmental Quality  
Office of Land & Water Resources

This box is for office use only.

FORM OLWR-AP-2 (REV. 9/94)

Issued: <u>11-27-90</u>	Expires:	Fee Paid:	Permit No.
Lat. <u>342211</u>	Long. <u>903819</u>	Elev. <u>173</u>	USGS No. <u>B20</u>
Quad. <u>FRIARS POINT</u>	ASCS Farm No.	STAC.	MSDOH No. <u>140004-01</u>
Aquifer: <u>WNTC</u>	Tract No.		Basin No.
Remarks:			Dam Inv. No.

THIS APPLICATION IS FOR (Circle one):  NEW PERMIT  RENEWAL PERMIT NO. GW-13045

THIS APPLICATION IS FOR (Circle one):  GROUNDWATER - COMPLETE A,B,E  
 SURFACE WATER - COMPLETE A,C,D,E

BENEFICIAL USE (Circle one or more): 1) Public Supply  Municipal, Rural Water, or Private Water 2) Irrigation  
3) Industrial 4) Fish Culture 5) Recreation 6) Institutional (eg. Church, School) 7) Commercial (eg. Hotel, Casino, Restaurant) 8) Fire Protection 9) Livestock 10) Flood Protection 11) Other: \_\_\_\_\_

**SECTION A** (to be completed by ALL APPLICANTS)

LANDOWNER: Town Of Friars Point, Mississippi (Well #1) 64-6010669  
(Name) (SSN or Tax ID No.)

P O box 185 700 Second Street  
(Address)

Friars Point, Ms 38631 ( 662 ) 383-2233  
(City) (State & Zip) (Telephone No.)

APPLICANT, AGENT, OR LESSEE (if different from Landowner):

\_\_\_\_\_  
(Name) (SSN or Tax ID No.)

\_\_\_\_\_  
(Address)

\_\_\_\_\_  
(City) (State & Zip) (Telephone)

Location of diversion/withdrawal point (A suitable map with location marked must accompany this application):

NW 1/4 of the SW 1/4 of Section 20, Township 29N, Range 4W, County Coahoma

Does the land to which this application pertains have any source(s) of water other than that for which you are now applying (circle one)? YES  NO If yes, describe the nature and amount of any additional supply and, if applicable, list permit number. \_\_\_\_\_

**SECTION B** (to be completed for GROUNDWATER SOURCE)

1. AQUIFER: \_\_\_\_\_ MISSISSIPPI DEPARTMENT OF HEALTH NO.: \_\_\_\_\_

2. Proposed work will begin on \_\_\_\_\_, 19\_\_\_\_, and will be completed by 2/6, 19 70.

If well has already been drilled, when was well completed (date)? 2/6, 19 70. Under whose name was well originally drilled (if known)? \_\_\_\_\_

3. Description of proposed or completed well:

- (a) DEPTH OF WELL: 815' feet. DRILLER: Herndon Well Company
- (b) SURFACE CASING: Length: 754 feet; Diameter 8 inches; Type Steel Pipe (Welded)
- (c) SCREEN: Length 61 feet; Diameter 6 inches; Type Stainless Steel wire
- (d) PUMP: Type Turbine; Size 8"; Capacity 400 gallons per minute; Setting depth 100 feet
- (e) POWER UNIT: Type Vertical Electric Motor; Size 30 horsepower

4. PERMITTED VOLUME :

- (a) \_\_\_\_\_ acre-feet per year at a maximum rate of \_\_\_\_\_ gallons per minute
- (b) 0.11 million gallons per day at a maximum rate of 400 gallons per minute

085  
083 M<sup>3</sup> 5/25/00  
**(CONTINUED ON BACK)**  
400  
Aquifer change

**SECTION C** (to be completed for SURFACE WATER SOURCE)

- Source of water is from \_\_\_\_\_ which drains into \_\_\_\_\_  
which drains into \_\_\_\_\_  
(major stream or river)
- Description of pump/diversion works:  
Pump (size & type): \_\_\_\_\_ Power Unit (size & type): \_\_\_\_\_  
Lift: \_\_\_\_\_ feet Maximum capacity: \_\_\_\_\_ gallons per minute
- \_\_\_\_\_ acre-feet per year at a maximum rate of \_\_\_\_\_ gallons per minute

**SECTION D** (to be completed for SURFACE WATER IMPOUNDMENTS (DAMS) on continuously flowing streams)

- Name of storage reservoir: \_\_\_\_\_ Dam Height: \_\_\_\_\_ feet
- Surface area at normal pool: \_\_\_\_\_ Storage capacity at normal pool: \_\_\_\_\_ acre-feet

**SECTION E WATER USE DATA (ALL APPLICATIONS - complete section related to beneficial use)**

- IRRIGATION:** List the number of acres of each crop to be irrigated: Rice \_\_\_\_\_; Cotton \_\_\_\_\_; Oats \_\_\_\_\_; Corn \_\_\_\_\_; Soybeans \_\_\_\_\_; Pasture \_\_\_\_\_; Truck \_\_\_\_\_; Wheat \_\_\_\_\_; Grain Sorghum \_\_\_\_\_; Other (specify) \_\_\_\_\_ Acres \_\_\_\_\_  
A. Method of Irrigation (circle one) - Center Pivot Flood Furrow  
B. Land Condition (circle one) - Precision Land Formed Smoothed  
C. ASCS Farm No. \_\_\_\_\_ Tract No. \_\_\_\_\_
- FISH CULTURE:** Explain how water will be used: \_\_\_\_\_  
How often will reservoir (s) be emptied and refilled? \_\_\_\_\_
- MUNICIPAL WATER ASSOCIATION, or PRIVATE WATER SYSTEM**  
Chose "a" or "b" (a) The number of people served is \_\_\_\_\_ or (b) The number of connections is 565  
What is the estimated average daily consumption during periods of maximum use at the end of each five-year period during the next twenty (20) years?  

<u>0.156</u>	<u>2000</u>	<u>0.156</u>	<u>2005</u>	<u>0</u>	<u>2010</u>	<u>0</u>	<u>2015</u>
(Volume)	(Year)	(Volume)	(Year)	(Volume)	(Year)	(Volume)	(Year)
- INDUSTRIAL:** If the water is to be released into a watercourse, indicate the amount released each year \_\_\_\_\_  
Rate of release \_\_\_\_\_; NPDES Permit No. 0140004  
Explain any changes in quality of water to be released: \_\_\_\_\_  
Explain how water will be used: \_\_\_\_\_  
How much groundwater will be used for once-through non-contact cooling? \_\_\_\_\_
- RECREATION:** Explain how water will be used: \_\_\_\_\_
- OTHER USE:** Explain in detail (if needed, attach another page): \_\_\_\_\_
- REMARKS:** \_\_\_\_\_

List below the person to be contacted for additional information if required.

Albert Douglas  
(Name)  
P O box 185 700 Second Street  
(Address)  
Friars Point, MS 38631  
(City, State, Zip)  
662-383-2233 or 662-383-2383  
(Telephone)

The accompanying map is hereby declared a part of this application. For irrigation and fish culture use, an ASCS photograph is required. The TEN DOLLAR (\$10.00) permit fee is enclosed herewith.

Albert Douglas  
(Signature)  
Friars Point Coahoma  
MS  
Subscribed and sworn to before me this 12th day of May, 2000, at Coahoma County of MS  
My commission expires July 1, 2000  
Catherine Mills  
Notary Public.

DEPARTMENT OF ENVIRONMENTAL QUALITY - OLWR  
PUBLIC SUPPLY WELLS PROJECT

GPS LOG

USER NAME(S): Grantham DATE: 5-7-97  
UNIT DEQ #: \_\_\_\_\_ FILE #: B050715C  
HEALTH DEPT. #: 140004-01 ELEV. 178  
USGS #: B-020 OLWR #: MS-6W-13045  
OWNER: Town of Friars Point  
LOCATION: SW, NW, SW S 20 T 29N R 04W COUNTY: Coahoma  
LOCATION DESCRIPTION: Corner of 3<sup>rd</sup> + Webb St  
CASING DIA: 8" PUMP TYPE & SIZE: \_\_\_\_\_  
GPS FIELD LOCATION: LAT. 34 22 11.8 LONG. 90 38 19.3  
GPS CORRECTED LOCATION: LAT. 34.370002 LONG. 90.63870680  
REMARKS: FRIARS Point Quad.  
\_\_\_\_\_  
\_\_\_\_\_  
\_\_\_\_\_  
\_\_\_\_\_

# GPS

B-020 / GW-13045  
FRIARS POINT QUADRANGLE  
MISSISSIPPI-ARKANSAS  
7.5 MINUTE SERIES (TOPOGRAPHIC)  
SW/4 FARRELL 15' QUADRANGLE

2852' NE  
(MOON LAKE)

