

Coded By RRR 6/96 U.S. GEOLOGICAL SURVEY
 Checked By JPA 04/14/98 WATER RESOURCES DIVISION
 Entered By JPA MISSISSIPPI DISTRICT
 Date 3/98

E-Log No. 55 Well No. A 25
 County COT HOM A
673
68A

WELL RECORD

Agency Code U1S1C1S Site Id 1-3427150902829011 Project No. 5

Station Name 12 A10121ST LULA Latitude 9-34271145 Longitude 10-019102181291

Lat./Long. Ac. 11-SETH Disc 6-25 State 7-29 County 8-0217 NENELand Net 13-S1E1SW1S1231T130WR103W2

Location Map 14-LULA Altitude 16-11831 Merc/Meas 17-A L Accuracy 18-5 Hydrologic Unit 20-080362041

Agency Use 903-A I Date Inventoried 7/11 Station Type 4 Data Type 804

Instr. 905 Remarks 906 Relia. 3-GLMU 2-X

Date of Construction 21-01/11/1996 Well Use 23-W Water Use 24-P Primary Aquifer 714-124MUNA Hole Depth 27-10713

Well Depth 29-1055 Water Level 30-120 Water Level Date 31-07/11/1996 Method 34- Status 37- Source 33-D

CONSTRUCTION DATA

Construction Date 60-07/11/1996 Contractor 63-0011 Method 65-H Finish 66-6

CONSTRUCTION CASING DATA

R	T	Top/Casing	Bot/Casing	Diameter
725#1	59#1	77	78	79
725#2	59#1	77	78	79

CONSTRUCTION OPENINGS DATA

R	T	Top/Depth	Bot/Depth	Diameter	Type	Length	Width
726#1	59#1	83	84	87	85-S	89	88
726#2	59#1	83	84	87	85	89	88

CONSTRUCTION LIFT DATA

Power 45-E H.P. 46-AIC Serial No. 49

Lift Type 43 Date 38-07/11/1996 Intake 44-11501

MISCELLANEOUS OWNER DATA

Date of Ownership 159-07/11/1996 Owner Name 161-LULA

MISCELLANEOUS OTHER ID DATA

E-Log No. 190-0515 Assigner 191-M I S S I O I S I

TH #2

MISCELLANEOUS QM DATA

R=192	T=A	738#1	Date of Measurement	1934 / / .	Aquifer Sampled	195# .	Temp	196#00010	Value	197# .
R=192	T=A	738#2	Date of Measurement	1934 / / .	Aquifer Sampled	195# .	So Cond	196#00095	Value	197# .
R=192	T=A	738#3	Date of Measurement	1934 / / .	Aquifer Sampled	195# .	pH	196#00400	Value	197# .

MISCELLANEOUS LOGS DATA

R=198	T=A	739#1	Log Type	199# .	Sec. Depth	200# .	End Depth	201# .
R=198	T=A	739#1	Log Type	199# .	Sec. Depth	200# .	End Depth	201# .

MISCELLANEOUS NETWORK DATA 706 = QW WL WD *

R=114	T=A	730#1	Sec. Year	115# .	End Year	116# .	Agency Source	120#A7	117# .	Freq.	119# .
R=121	T=A	730#2	Sec. Year	115# .	End Year	116# .	Agency Source	117# .	Freq.	119# .	

MISCELLANEOUS REMARKS DATA

R=183	T=A	311#1	Date of Remarks	184# / / .	Remarks	185# .
-------	-----	-------	-----------------	----------------------------	---------	------------------------

DISCHARGE DATA

R=146	T=A	Pump/Flow	147#1	Date	148# 07/15/1996	Type	703# (P)	Discharge	150# 500 .	So. Capacity	272# 8 5
-------	-----	-----------	-------	------	-----------------	------	----------	-----------	----------------	--------------	--------------

GEOHYDROLOGIC DATA

R=90	T=A	721#1	Depth Top	91# 965 .	Depth Bot.	92# 1060 .	Unit Id	93# 124MIMIXI .	304#
------	-----	-------	-----------	---------------	------------	----------------	---------	---------------------	------

HYDRAULIC DATA

R=98	T=A	790#1	Unit Tested	100# .	103# .
------	-----	-------	-------------	------------------------	----------

NR. BACKBLDNG & EXISTING well

(60' of 20" surface casing)

DEPARTMENT OF ENVIRONMENTAL QUALITY - OLWR
PUBLIC SUPPLY WELLS PROJECT

GPS LOG

USER NAME(S): Grantham DATE: 5-7-97
UNIT DEQ #: _____ FILE #: BDS0715A
HEALTH DEPT. #: 140005-03 ELEV. 180
USGS #: ~~A17~~ A25 OLWR #: MS-GW-14988
OWNER: Town of Lula
LOCATION: NW SW SE s 13 T. 30N R. 03W COUNTY: Coahoma
LOCATION DESCRIPTION: _____
CASING DIA: _____ PUMP TYPE & SIZE: _____
GPS FIELD LOCATION: LAT. 34.2714.9 LONG. 90.28329
GPS CORRECTED LOCATION: LAT. 34.454108 LONG. 90.47578857
REMARKS: New well
Lula Quad

The box below is for office use only.

MWUX

Issued: <u>9-12-95</u>	Expires: <u>9-12-2005</u>	Fee Paid	<input checked="" type="checkbox"/>	Permit No. <u>GW-14988</u>
Lat. <u>34-27-15</u>	Long. <u>90-28-30</u>	Elev. <u>100</u>		USGS No.
Quad <u>Lula</u>	Dist.			Basin No. <u>08030204</u>
STAC				Dam Inv. No.
				Dam appl. No.

Dept. of Natural Resources, Bureau of Land and Water Resources, P.O. Box 10631, Jackson, MS 39289-0631

**APPLICATION FOR PERMIT TO DIVERT OR WITHDRAW FOR BENEFICIAL USE
THE PUBLIC WATERS OF THE STATE OF MISSISSIPPI**

JUL 27 1995

This application is for (circle one): GROUNDWATER SURFACE WATER

Beneficial Use (circle one or more): Irrigation Fish Culture Municipal Rural Water Professional Water Resources
Recreation Institutional (Examples: Church, School) Commercial (Examples: Hotel, Restaurant) Livestock Standby
Fire Protection Flood Protection Other: _____

LANDOWNER:

Town of Lula (Name) 64-0636319 (S/S or Tax ID No.)
P. O. Box 326 (Address)
Lula (City) MS 38644-0326 (State and Zip) (601) 337-4579 (Telephone Number)

APPLICANT, AGENT, OR LESSEE (If different from Landowner):

Same as Above (Name) _____ (S/S or Tax ID No.)

(Address)

(City) _____ (State and Zip) _____ (Telephone Number)

Location of diversion/withdrawal point (A suitable location map must accompany this application):

SW 1/4 of the SW 1/4 of Section 23, Township 30N, Range 12W, County Coahoma

Volume of water diverted/withdrawn (Choose "a", "b", "c", or "d" ["d" is for units other than those shown in "a", "b", or "c"]):

(a) _____ acre-feet per year at a maximum rate of _____ gallons per minute
(b) 0.51 million gallons per day at a maximum rate of 500 gallons per minute
(c) _____ acre feet of storage at normal pool
(d) _____ per _____ at a maximum rate of _____

Construction of proposed work will begin on (date) September, 19 95 and will be completed by (date) March, 19 96.

Water will be used from (month) January to (month) January each year.

Does the land to which this application pertains have any source(s) of water other than that for which you are now applying (circle one)?
YES NO If yes, describe the nature and amount of any additional supply and, if applicable, list permit numbers.

Existing Well No. 1 and Well No. 2 which will be abandoned. Well No. 1 was installed in 1924 and is not in use. Existing well No. 2 was installed in 1968 and has a capacity of 200gpm.

SECTION A (to be completed if application is for surface water source) Well #3 - GW 5715

- Source of water is from _____ which drains into _____ which drains into _____ which drains into _____
- Description of pump/diversion works:
 - Pump (size and type): _____ Power Unit (size and type): _____
Lift: _____ feet Maximum capacity: _____ gallons per minute.
 - Name of storage reservoir: _____ Dam height: _____ feet.
Surface area at normal pool: _____ acres. Storage capacity at normal pool: _____ acre-feet.

SECTION B (to be completed if application is for groundwater source)

- Source of water is the Meridian, Upper Wilcox aquifer.
- Description of proposed water well:
 - DEPTH OF WELL: 1070 feet. DRILLER (name): Advertised for bids
 - SURFACE CASING: Length: 1010 feet. Diameter: 14 inches. Type: Steel
 - SCREEN: Length: 60 feet. Diameter: 8 inches. Type: Stainless Steel Wire Wrap
 - PUMP: Type: Water Lubricated. Size: 9". Capacity: 500 gallons per minute.
Number of stages: 5 Settling depth: 120 feet.
 - POWER UNIT: Type: Electric Motor. Size: 40 horsepower.
 - TYPE OF COMPLETION: Gravel Wall

WATER USE DATA:

If for IRRIGATION, FISH CULTURE or any other areal use, show the number of acres to which water will be applied in the appropriate 40-acre block(s). Acreage must be shown on accompanying location map.

TOWN-SHIP	RANGE	SECTION	NE1/4				NW1/4				SW1/4				SE1/4				TOTALS
			NE1/4	NW1/4	SW1/4	SE1/4	NE1/4	NW1/4	SW1/4	SE1/4	NE1/4	NW1/4	SW1/4	SE1/4	NE1/4	NW1/4	SW1/4	SE1/4	

1. IRRIGATION: List the number of acres of each crop to be irrigated: Rice _____; Cotton _____; Soybeans _____; Corn _____; Pasture _____; Truck _____; Wheat _____; Oats _____; Grain sorghum _____; Other (specify) _____ Acres _____

2. FISH CULTURE: Explain how water will be used: _____
How often will reservoir(s) be emptied and refilled? _____

3. MUNICIPAL or WATER ASSOCIATION
Choose "a" or "b". (a) The number of people served is 2000. (b) The number of connections/customers is _____
What is the estimated average daily consumption during periods of maximum use at the end of each five-year period during the next twenty years? 0.180 MGD 2001; 0.187 MGD 2006; 0.193 MGD 2011; 0.200 MGD 2016
(Volume) (Year) (Volume) (Year) (Volume) (Year)

4. INDUSTRIAL: If water is to be released into a watercourse, indicate the amount released each year _____
Rate of release _____; Location of release point in reference to diversion/withdrawal point _____
_____ Explain any change in quality of water to be released: _____ NPDES Permit No. _____
Explain how water will be used: _____
How much groundwater will be used for once-through non-contact cooling? _____

5. RECREATION: Explain how water will be used: _____

6. OTHER use: Explain in detail: _____

REMARKS: _____

List below the person to be contacted for additional information if required:

James A. Mitchell, Jr., Mayor
(Name)
P. O. Box 326
(Address)
Lula, MS 38644-0326
(City, State, Zip)
601-337-2381
(Telephone)

The accompanying map is hereby declared a part of this application. The TEN DOLLAR (\$10.00) permit fee is enclosed herewith.
James A. Mitchell, Jr.
(Signature)

Subscribed and sworn to before me this 14th day of July, 1995 at Lula
County of Coahoma. My commission expires June 30, 1997
Walter K. Barber, Notary Public
Town Clerk

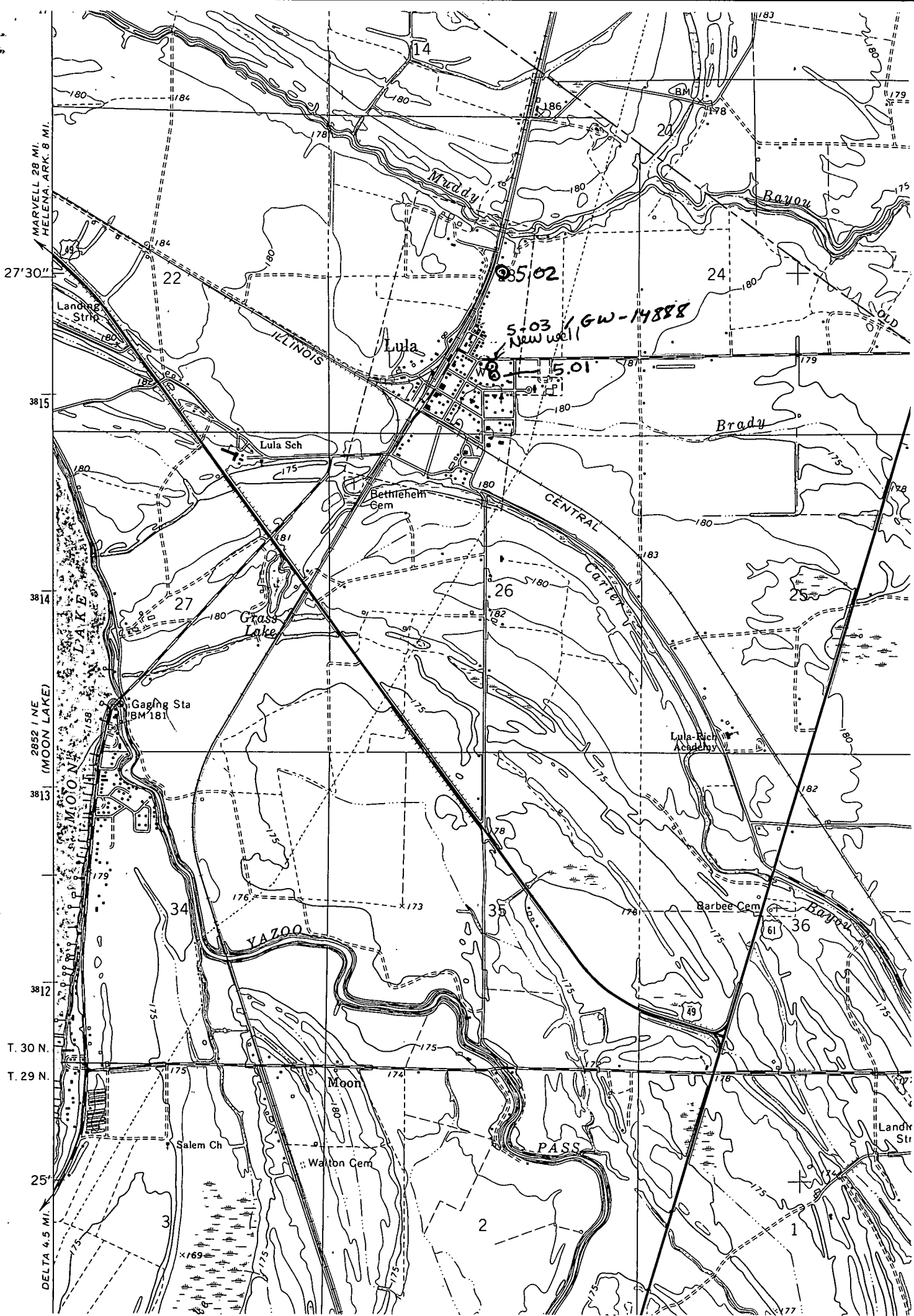

MARVELL 28 MI.
HELENA, ARK. 8 MI.

27°30'

38°15'

38°14'

38°13'

38°12'

T. 30 N.

T. 29 N.

25'

DELTA 4.5 MI.

S.03 / GW-14888
New well

S.01

26

25

Grass Lake

Lula Sch

Lula

Bettyhem Cem

Brady

Lula Rich Academy

Barbee Cem

Moon

Salem Ch

Walton Cem

Landr Str

Landing Strip

MOON LAKE

Gaging Sta
BM 181

MISSISSIPPI

YAZOO

CENTRAL

CATHEY

PASS

61

49

14

22

24

27

34

35

36

2

1

180

184

180

186

178

179

184

180

180

180

175

180

175

180

180

175

180

181

180

183

178

179

175

175

180

178

179

176

173

178

175

182

180

175

175

175

178

175

175

175

175

175

174

175

176

175

175

175

175

175

175

175

175

175

177