

9-185  
(October 1950)

UNITED STATES  
DEPARTMENT OF THE INTERIOR  
GEOLOGICAL SURVEY  
WATER RESOURCES DIVISION

WELL SCHEDULE

Date 3/19, 1957 Field No. \_\_\_\_\_  
Record by BE WASSON Office No. K-3  
Source of data LEWIS PORTER

1. Location: State MISS County CLAY  
Map \_\_\_\_\_  
SW  $\frac{1}{4}$  NW  $\frac{1}{4}$  sec. 8 T 19 N 16 E  
SW
2. Owner: LEWIS PORTER Address Rt 3 WEST POINT  
Tenant \_\_\_\_\_ Address \_\_\_\_\_  
Driller STAMMONS Address WEST POINT
3. Topography HILL
4. Elevation 255 ft. above MSL BAR  
below
5. Type: Dug, drilled, driven, bored, jetted \_\_\_\_\_ 19
6. Depth: Rept. 400 ft. Meas. \_\_\_\_\_ ft.
7. Casing: Diam. 4 in., to \_\_\_\_\_ in., Type \_\_\_\_\_  
Depth 60 ft., Finish \_\_\_\_\_
8. Chief Aquifer Ke From \_\_\_\_\_ ft. to \_\_\_\_\_ ft.  
Others \_\_\_\_\_
9. Water level -35 ft. rept. \_\_\_\_\_ 19 above  
meas. below  
which is \_\_\_\_\_ ft. above surface  
below
10. Pump: Type ROD Capacity \_\_\_\_\_ G. M.  
Power: Kind FRE Horsepower \_\_\_\_\_
11. Yield: Flow \_\_\_\_\_ G. M., Pump \_\_\_\_\_ G. M., Meas., Rept. Est.  
Drawdown \_\_\_\_\_ ft. after \_\_\_\_\_ hours pumping \_\_\_\_\_ G. M.
12. Use: Dom., Stock, PS., RR., Ind., Irr., Obs. TURKEYS  
Adequacy, permanence PLENTY
13. Quality GOOD Temp \_\_\_\_\_ °F.  
Taste, odor, color \_\_\_\_\_ Sample Yes  
No
- Unfit for \_\_\_\_\_
14. Remarks: (Log, Analyses, etc.) \_\_\_\_\_

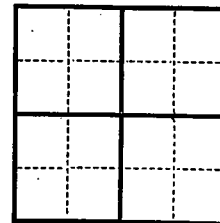

UNITED STATES  
DEPARTMENT OF THE INTERIOR  
GEOLOGICAL SURVEY  
WATER RESOURCES DIVISION

Form 750  
October 1950

WELL SCHEDULE

Field No. 19

Location of well  
Name of well

County and State

Section, Township, Range

Section, Township, Range

Section, Township, Range

Section, Township, Range

Section, Township, Range

Section, Township, Range

Section, Township, Range

Section, Township, Range

Section, Township, Range

Section, Township, Range

Section, Township, Range

Section, Township, Range

Section, Township, Range

Section, Township, Range

Section, Township, Range

Section, Township, Range

Section, Township, Range

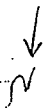
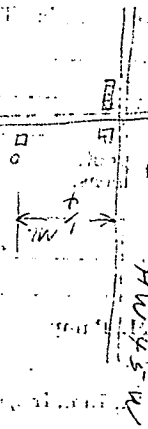
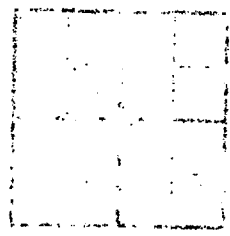



# West Point Quad

44 R 15 E R 16 E 40' ARTESIA 6 MI. BROOKSVILLE 20 MI. 347 88°

● INTERIOR—GEOLOGICAL SURVEY, RESTON, VIRGINIA—1987  
348000±E

### ROAD CLASSIFICATION

Primary highway, hard surface ..... Light-duty road, hard or improved surface .....

