

Planned
if necessary - climb through fence
GW01504
DOH # 130005-04

Waverly permitted

TRANSMITTED FOR ADP

Recorded by WTO
Date 8/13/85

U.S. GEOLOGICAL SURVEY
WATER RESOURCES DIVISION
MISSISSIPPI DISTRICT
WELL RECORD

Well No. J140
E-Log No. 72
County CLAY
QUAD: WAVERLY 135-0
GW-1504

GPS d 4/13/99 Mo/Att

Site ID 333545088355001 R=0* T=A* 2=W*

GEN. SITE DATA

Data reliab. 3=U* Report. agency 4=USGS* Dist. 6=28* 7=28* Co. 8=025*
Lat. 39
Long. / 9=333545* 10=0883550* Well No. 12=J140*
Location 13=SESE S 18 T 17 S R 08 E* Alt. 16=195.*
Hyd. Unit (OWDC) 20=03160104* Date 21=0512811985*
Well use 23=W* Water Use 24=P* Hole depth 27=409.* Well depth 28=407.*
WL 30=106.* Date 31=1110411985* Source 33=D*
Status 273=* Project No. 5=

OWNER

R=158* T=A* Date 159#1110411985* Owner No. #4
Owner 161#STRONG HILL WA

FIELD ON

R=192* T=A* Date 193# Temp. 196#00010* 197=
R=192* T=A* Date 193# Cond. 196#00095* 197=
R=192* T=A* Date 193# pH 196#00400* 197=

CONSTR.

R=58* T=A* 59#1* Date 60=1110411985* Remarks
Drig. 63=021* Name Herndon Method 65=H* Finish 66=G*

CASING

R=76* T=A* 59#1*
Top. csng. 77#0.* Bot. csng. 78=365.* Diam. 79#8.*
R=76* T=A* 59#1*
Top csng 77#322.* Bot. csng. 78=364.* Diam. 79#4.*

OPENINGS

R=82* T=A* 59#1* Top 83#364.* Bottom 84=407.*
Type 85=S* Diam. 87=4.* Size 88=
R=82* T=A* 59#1* Top 83# Bottom 84=
Type 85= Diam. 87= Size 88=

YIELD

R=146* T=A* 147#1* Q 150=175.* Q/S 272=
134 Flows 146 summed

12/6/90
 130.00
 -23.26
 106.74
 -4.30 mp
 102.44

LIFT
 R=42* T= A * Lift type 43# T* Intake 44= * Power type 45= E*
 Date 38= 11/04/1985* H.P. 46= 20.*

LOGS
 R=198* T= A * Log 199# E* Top 200= 5.* Bot 201= 398.*
 R=198* T= A * Log 199# D* Top 200= 0.* Bot 201= 409.*
 R=189* T= A * E Log No. 190# 072* 191= M I S S D I S T * mp 4' because of manmade hill

ANAL.
 R=114* T= A * Year 115# * 117= * 120= *

AQUIFERS
 R=90* T= A * 256# 1 * Top 91= * Bot 92= *
 Unit ID 93= 211 M C S N E T A W Name of Unit
 R=90* T= A * 256# 1 * Top 91= * Bot 92= *
 Unit ID 93= * Name of Unit

HYDRAULICS
 R=98* T= A * 99# 1 * Unit tested 100= * 103= *
 R=105* T= A * 99# 1 * Test No. 106# *
 107= * Transmissivity (gal/d)/ft
 108= * Hydraul. cond. (gal/d)/ft²
 110= * Storage coeff. Boundaries

R=121* T= * Yr Begin 122# * Network 258# *

Water Level Data Collection (1)

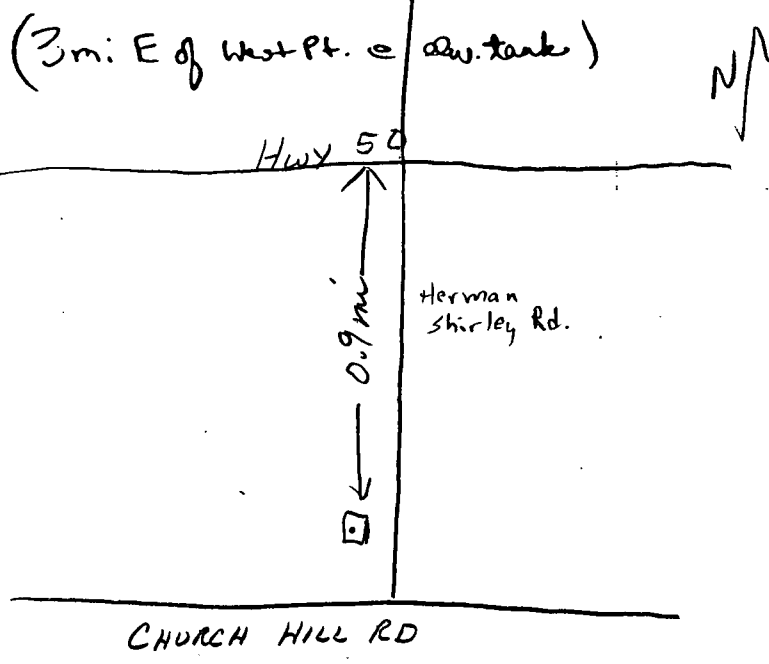

Clay	0	80
Rock	80	80 1/2
Clay	80 1/2	86
Sandy Clay	86	100
Clay	100	120
Rock	120	121 1/2
Sand	121 1/2	205
Good Sand	205	235
Clay	235	315
Sandy Clay	315	350
Sand	350	409

CLAY
 J140
 11-4-85
 Elev #72

MISSISSIPPI DEPARTMENT OF NATURAL RESOURCES

Bureau of Land and Water Resources

Southport Mall

P.O. Box 10631

Jackson, Mississippi 39209

WATER WELL DRILLERS LOG

CODED

GW
 01504

04 November 1985 Herndon Well & Supply, Inc. Clay
 date well completed firm name county well located

LANDOWNER: Strong Hill	description of formations encountered	from	to
Water Ass'n., Inc.			
Well No. 4	Clay	0	80
Route 6 West Point, MS	Rock	80	80½
(mailing address)	Clay	80½	86
WELL LOCATION:	Sandy Clay	86	100
sec. 18 T. 17 N S R. 8 E X X	Clay	100	120
3 miles East of West Pt.	Rock	120	121½
(distance) (direction) (nearest town)	Sand	121½	205
WELL PURPOSE: Municipal	Good Sand	205	235
(home, irrigation, municipal, industrial)	Clay	235	315
WELL COMPLETION DATA:	Sandy Clay	315	350
(1) diameter (inches) 8 x 4"	Sand	350	409
(2) total depth (feet) 407			
(3) static water level (feet) 106' 3" below top of ground			
(4) casing Steel, 365' (depth)			
8" (size) if telescope see back.			
(5) screen 43' 3" (length), 364' (depth to top)			
4" (size), SS Ribbed (material)			
(6) pump 20 (HP), 175 (yield gpm)			
Electric (type power)			
(7) electric log Yes (yes or no)			
Herndon Well & Supply (organization running log)			
(8) how well bottom plugged 4" BWV			

CODED

RECEIVED
 NOV - 7 1985

Department of Natural Resources
 Bureau of Land & Water Resources

DRILLERS REMARKS:

If well telescopes please sketch and show depths.

GROUND LEVEL

Top of Lap 4
322'
Top of Screen
360'
Bottom of Well
407'

If more than one screen,
show locations of each on sketch.

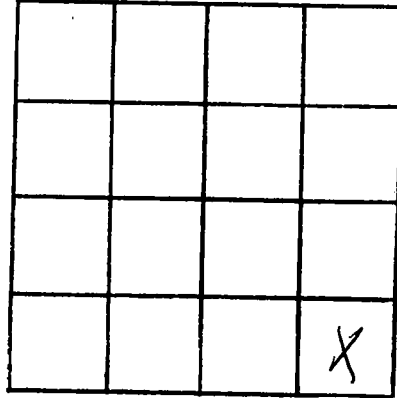

SECTION 17

Please indicate well location X.

ADDITIONAL INFORMATION

Multiple horizontal lines for additional information.

DEPARTMENT OF ENVIRONMENTAL QUALITY - OLWR
PUBLIC SUPPLY WELLS PROJECT

GPS LOG

USER NAME(S): MO/AH DATE: 4-13-99

UNIT DEQ #: _____ FILE #: B041317A

HEALTH DEPT. #: 130005-04 ELEV.: ~190+

USGS #: J140 OLWR #: GW01504

OWNER: STRONG Hill Water QUAD: Waverly

LOCATION: SESE SE S 18 T 17S R 7E COUNTY: CLAY

LOCATION DESCRIPTION: Well in sm. fenced AREA. ON HERMAN
Shirley Rd. on left side.

0.1 miles from Church Hill road

CASING DIAM: _____ PUMP TYPE AND SIZE: Sub.

GPS FIELD LOCATION: LAT: 33° 25' 39.4N LONG: 88 35 48.2W

GPS CORRECTED: LAT: 33.594299 LONG: 88.597095

REMARKS: TURN left off church hill rd. on to
HERMAN Shirley RD. Also, next to power
Lines

2148

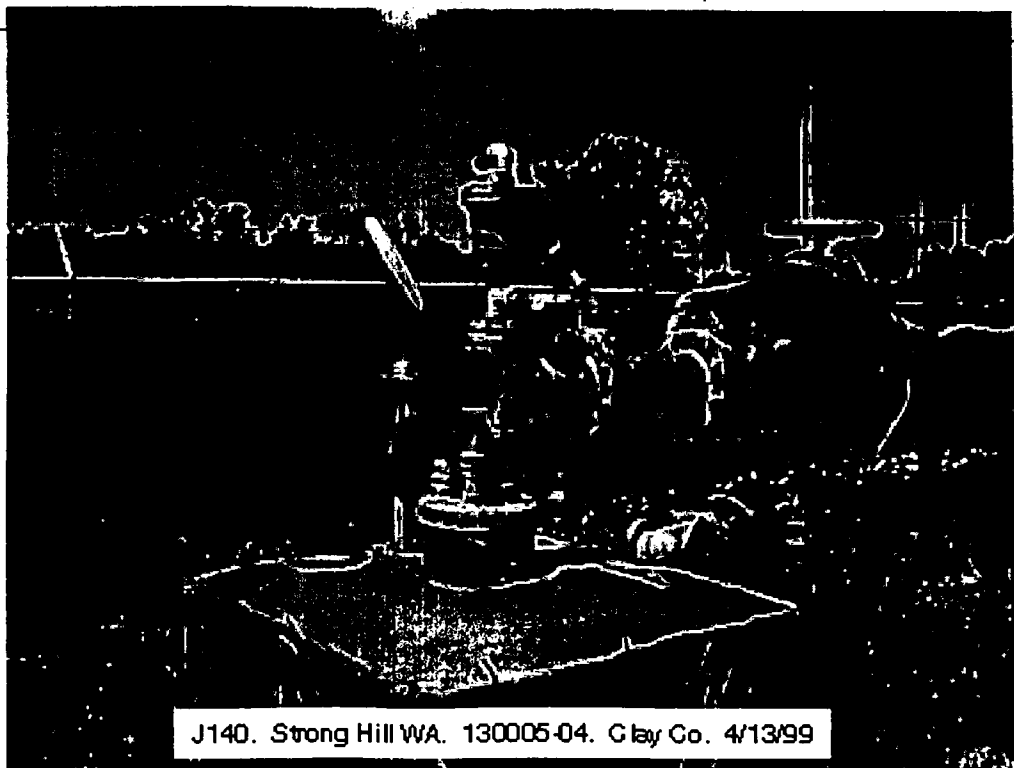

J140. Strong Hill WA. 130005-04. Clay Co. 4/13/99

DEPARTMENT OF THE INTERIOR
GEOLOGICAL SURVEY

88° 37' 30" R 6 E 350000mE R 7 E 351 352 353 35' 35

