

Placed - GWISOS DOH# 130005-03 *Crawl under gate - no pump house* Waverly Quad *permitted*

1/51 W/O  
Recorded by WTS  
Date \_\_\_\_\_  
U.S. GEOLOGICAL SURVEY  
WATER RESOURCES DIVISION  
MISSISSIPPI DISTRICT  
WELL RECORD  
Well No. J138  
E-Log No. 71  
County Clay

GPSd 4/13/99 AH/MO

Site ID 333545088350201 R=0\* T=A\* 2=W\* *GW-1505 QUAD: WAVERLY 135-D*

Data reliab. 3=U\* Report. agency 4=USGS\* Dist. 6=28\* 7=28\* Co. 8=025\*

Lat. \_\_\_\_\_ Long. 9=333545\* 10=0883502\* Well No. 12=J138\*

Location 13=SESE S17 T17S R07E\* Alt. 16=245\* *250' (1789) 256' (?)*

Hyd. Unit (OWDC) 20= Date 21=01/10/1985\*

Well use 23=W\* Water Use 24=P\* Hole depth 27=578\* Well depth 28=280\*

WL 30=142.\* Date 31=06/01/1985\* Source 33=D\*

Status 273= Project No. 5=

R=158\* T=A\* Date 159#06/01/1985\* Owner No. Well#3

Owner 161#STRONG HILL WA

R=192\* T=A\* Date 193# Temp. 196#00010\* 197=

R=192\* T=A\* Date 193# Cond. 196#00095\* 197=

R=192\* T=A\* Date 193# pH 196#00400\* 197=

R=58\* T=A\* 59#1\* Date 60=06/01/1985\* Remarks \_\_\_\_\_

Drig. 63=021\* Name Herndon Method 65=H\* Finish 66=G\*

R=76\* T=A\* 59#1\*  
Top csng. 77#0.\* Bot. csng. 78=240.\* Diam. 79#12.\*

R=76\* T=A\* 59#1\*  
Top csng 77#93.\* Bot. csng. 78=236.\* Diam. 79#6.\*

R=82\* T=A\* 59#1\* Top 83#236.\* Bottom 84=280.\*

Type 85=S\* Diam. 87=6.\* Size 88=

R=82\* T=A\* 59#1\* Top 83# Bottom 84=

Type 85= Diam. 87= Size 88=

YIELD R=146\* T=A\* 147#1\* Q 150=83.\* Q/S 272=

134 flows 146 pumped

GEN. SITE DATA

OWNER

FIELD OW

CONSTR.

CASING

OPENINGS

YIELD

12/6/90

176.00  
 29.50  
 146.50  
 -2.39 mp  
 144.11

**LIFT**

R=42\* T= A \* Lift type 43# T \* Intake 44# \* Power type 45# E \*

Date 38= 06/01/1985 \* H.P. 46= 10. \* \*

**LOGS**

R=198\* T= A \* Log 199# E \* Top 200= 12. \* Bot 201= 57.8. \* \*

R=198# T= A \* Log 199# D \* Top 200= 0. \* Bot 201= 419. \* \*

R=189\* T= A \* E Log No. 190# 071 \* 191= M I S S D I S T \*

**ANAL.**

R=114\* T= A \* Year 115# \* 117# \* 120# \*

**AQUIFERS**

R=90\* T= A \* 256# 1 \* Top 91= 170. \* Bot 92= \* \*

Unit ID 93= 211 M C S N \* Name of Unit

R=90\* T= A \* 256# 1 \* Top 91= \* Bot 92= \* \*

Unit ID 93= \* Name of Unit

**HYDRAULICS**

R=98\* T= A \* 99# 1 \* Unit tested 100# \* 103# \*

R=105\* T= A \* 99# 1 \* Test No. 106# \*

107# \* Transmissivity (gal/d)/ft

108# \* Hydraul. cond. (gal/d)/ft<sup>2</sup>

110# \* Storage coeff. Boundaries

R=121\* T= \* Yr Begin 122# \* Network 258# \*

Water Level Data Collection (1)

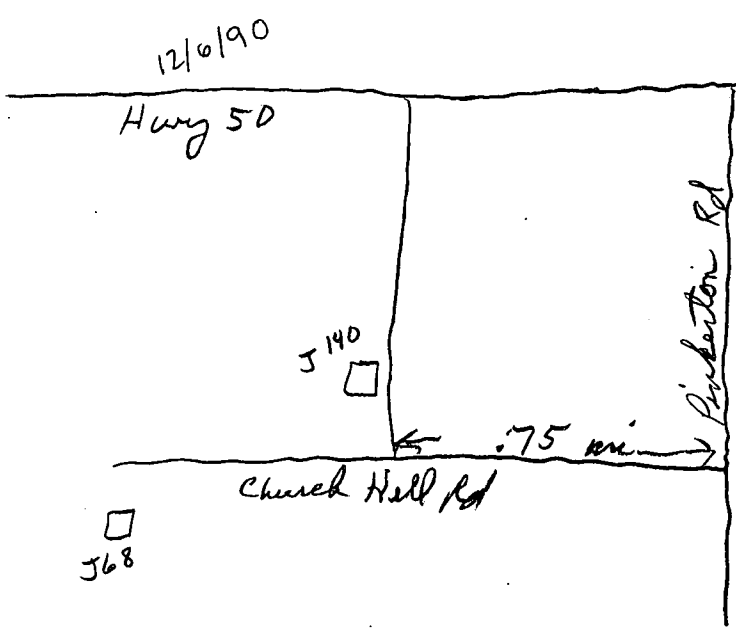

description of formations encountered	from	to
Sand	0	17
Blue Rock	17	19
Clay	19	145
Sandy Clay	145	164
Rock	164	167
Sandy Clay	167	170
Fine Sand	170	237
Coarse Sand	237	275
Rock	275	277
Sand	277	299
Sandy Clay	299	419
Tight Sand	419	

CLAY  
 J138  
 5/85  
 6201506

MISSISSIPPI DEPARTMENT OF NATURAL RESOURCES

Bureau of Land and Water Resources

Southport Mall

P.O. Box 10631

Jackson, Mississippi 39209

WATER WELL DRILLERS LOG

CODED

1985 Herndon Well & Supply, Inc. Clay  
 date well completed firm name county well located

LANDOWNER:	description of formations encountered	from	to
Strong Hill			
Water Association, Inc.			
Rt. 6, West Point, MS (mailing address)	Sand	0	17
	Blue Rock	17	19
	Clay	19	145
<b>WELL LOCATION:</b>	Sandy Clay	145	164
sec. 17 T17 XMX R. 07 E S	Rock	164	167
3 miles East of W. Point (distance) (direction) (nearest town)	Sandy Clay	167	170
	Fine Sand	170	237
<b>WELL PURPOSE:</b> Municipal (home, irrigation, municipal, industrial)	Coarse Sand	237	275
<b>WELL COMPLETION DATA:</b>	Rock	275	277
(1) diameter (Inches) 12 x 6"	Sand	277	299
(2) total depth (feet) 280'	Sandy Clay	299	419
(3) static water level (feet) 142' 4" below top of ground	Tight Sand	419	
(4) casing Steel, 240' (material) (depth) 12" (size) if telescope see back.			
(5) screen 44' 4", 237' (length) (depth to top) 6" SS Ribbed (size) (material)			
(6) pump 10 HP, 83 (yield gpm) electric (type power)			
(7) electric log yes (yes or no) US Geo. Survey (organization running log)			
(8) how well bottom plugged 6" BW Valve			
<b>DRILLERS REMARKS:</b>			

RECEIVED

JUN 11 1985

Department of Natural Resources  
 Bureau of Land & Water Resources

If well telescopes please sketch and show depths.

GROUND LEVEL

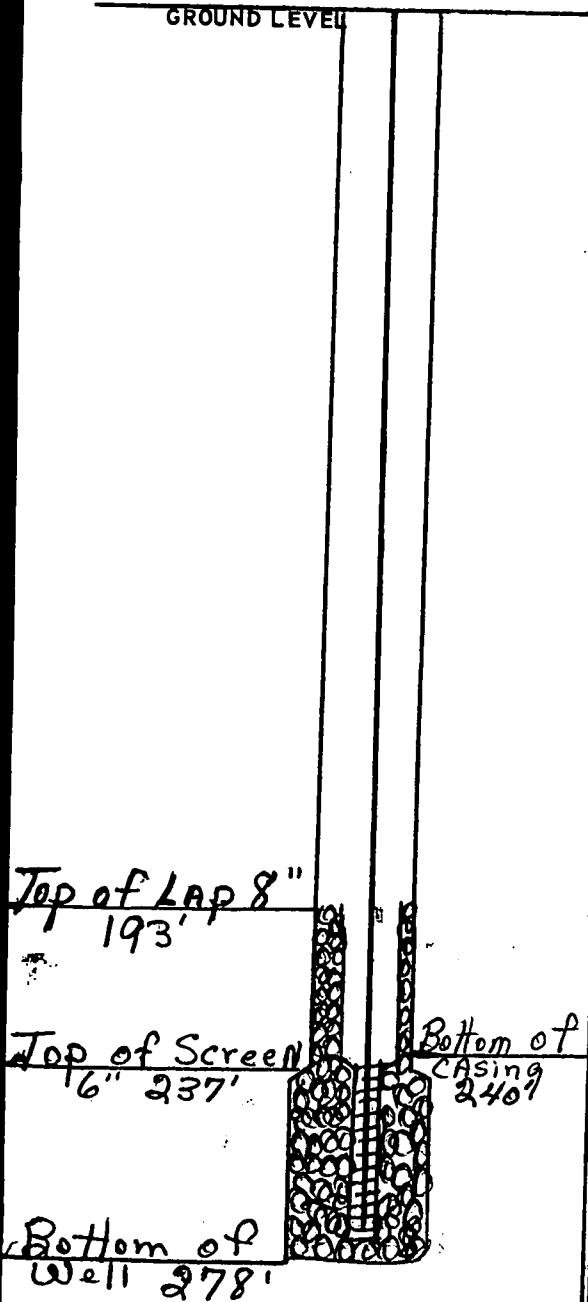

If more than one screen, show locations of each on sketch.

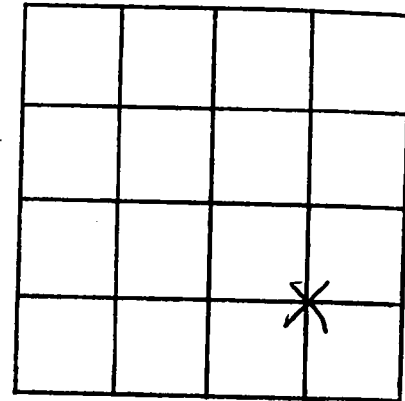

SECTION 17

Please indicate well location X.

ADDITIONAL INFORMATION

Multiple horizontal lines provided for entering additional information.

DEPARTMENT OF ENVIRONMENTAL QUALITY - OLWR  
PUBLIC SUPPLY WELLS PROJECT

GPS LOG

USER NAME(S): AH / mo DATE: 4-13-99

UNIT DEQ #: \_\_\_\_\_ FILE #: B041317B

HEALTH DEPT. #: ? 130005-03 No TAG \_\_\_\_\_ ELEV.: 250

USGS #: J138 OLWR #: GW01505

OWNER: Strong Hill water Ass QUAD: Waverly

LOCATION: SE SE S 17 T 17S R 7E COUNTY: Clay

LOCATION DESCRIPTION: By water<sup>Strong Hill</sup> Tower on Pinkerton Rd

CASING DIAM: 8" PUMP TYPE AND SIZE: Subm

GPS FIELD LOCATION: LAT: 33 35 46.7 N LONG: 88 35 05.6 W

GPS CORRECTED: LAT: 33.595520 LONG: 88.583672

REMARKS: .8 miles off of Hwy 50 on Pinkerton (no sign) (Gravel Rd)  
1.7 miles from west Point city limit sign

p149

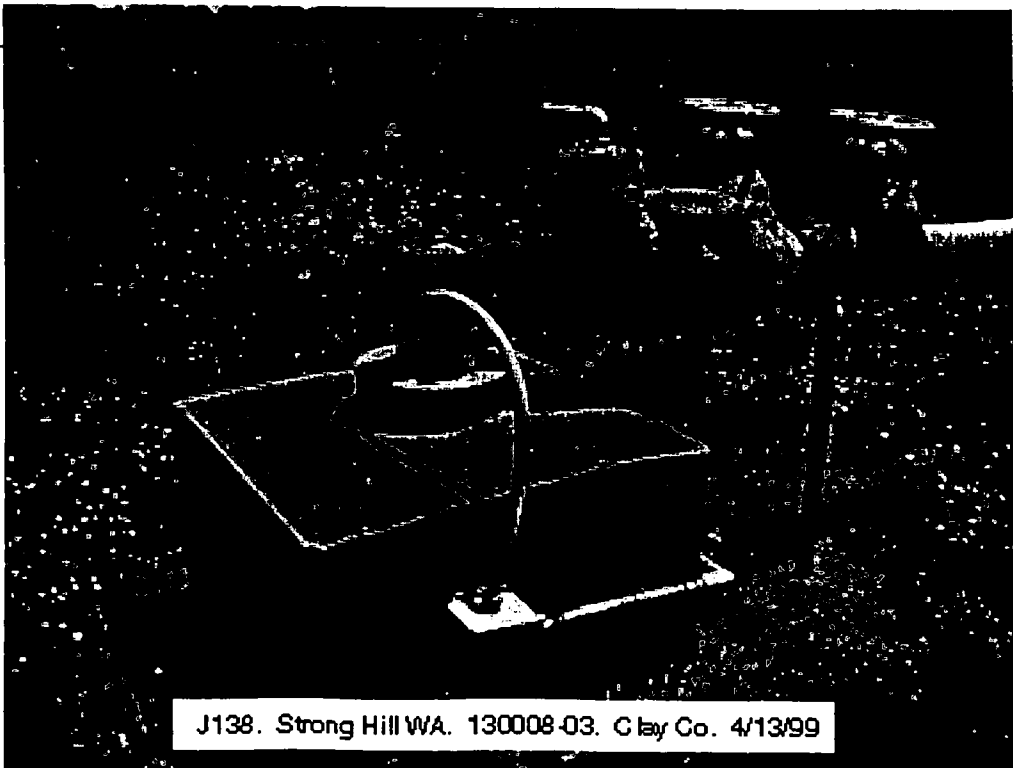

J138. Strong Hill WA. 130008-03. Clay Co. 4/13/99

1 OF THE INTERIOR  
GICAL SURVEY

50000mE

R 7 E 351

J-65

352

353 35'

354

